

TITLE: ROSEVELT ELEMENTARY SCHOOL ADDITION
 PROJECT NO. 52-12
 DATE: 11-16-53
 OFFICE OF SUPERINTENDENT OF SCHOOLS
 STATE OF CALIFORNIA
 DIVISION OF ARCHITECTURE
 STATE OF CALIFORNIA, DEPARTMENT OF PUBLIC WORKS
 DIVISION OF ARCHITECTURE
 PROJECT NO. 1130
 DIVISION OF ARCHITECTURE
 ARCHITECT: ERNEST L. MCCOY A.I.A. ARCHITECT
 2811 H STREET
 BAKERSFIELD
 CALIFORNIA
 CHECK AND VERIFY ALL DIMENSIONS AND CONDITIONS AT JOB SITE BEFORE PROCEEDING WITH THE WORK. REPORT ANY DISCREPANCIES TO THE ARCHITECT.
 ROSEVELT ELEM. SCHOOL ADDITION
 BAKERSFIELD CITY SCHOOL DISTRICT
 2324 VERDE ST.
 BAKERSFIELD
 CALIFORNIA
 JOB NO. 52-12
 DRAWN: E.L.M.
 CHECKED: [Signature]
 SHEET NO. 2 OF 4 SHEETS

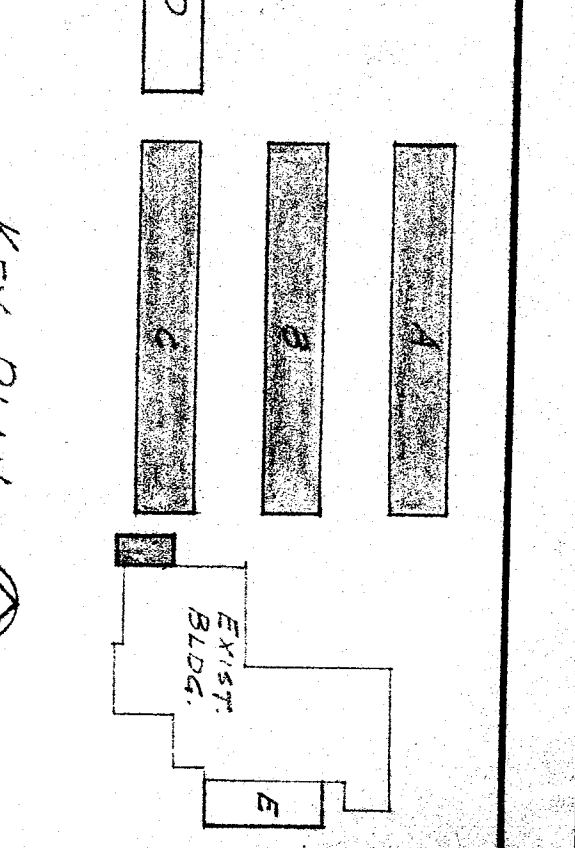
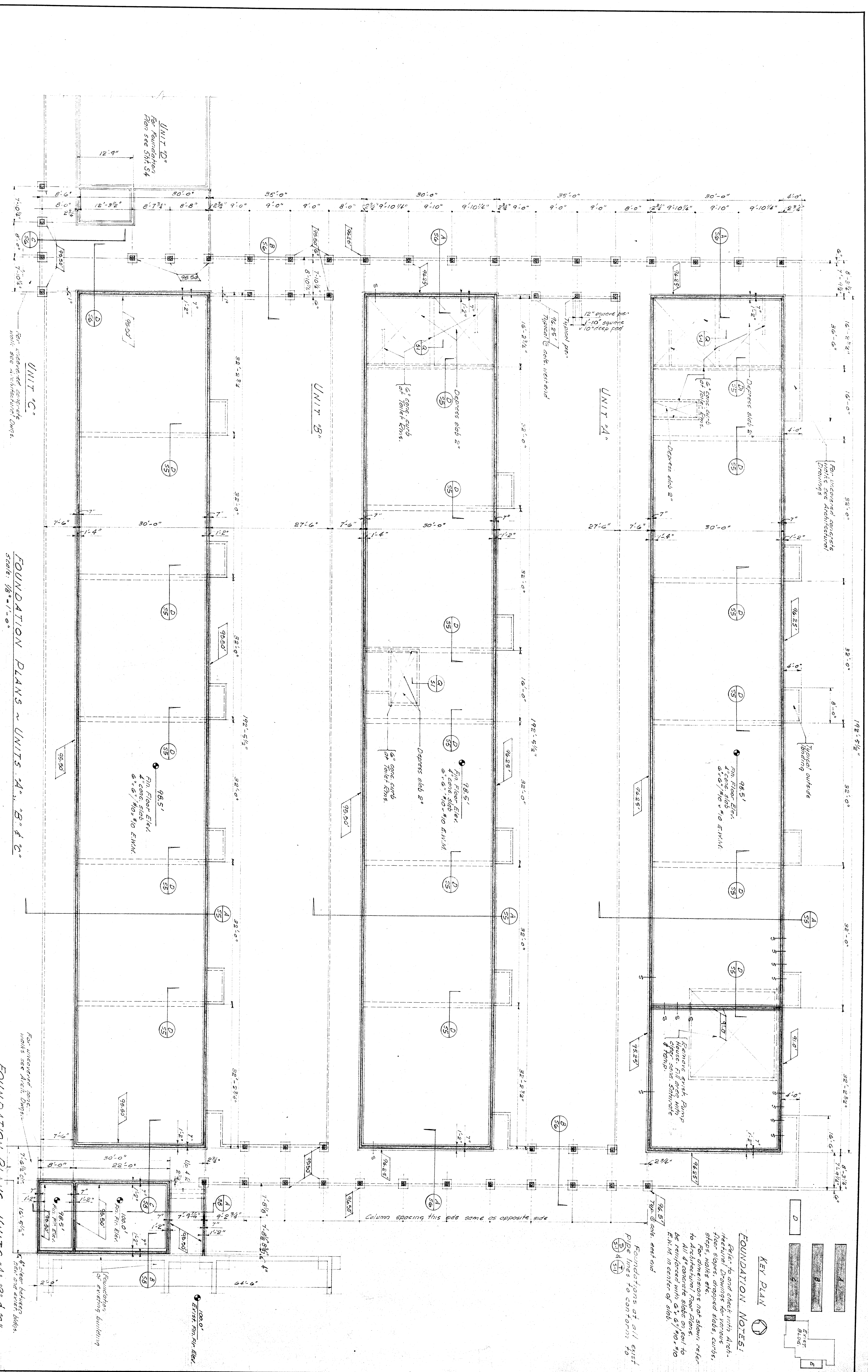

FOUNDATION NOTES:

- Refer to and check with Architectural Drawing for various floor slopes, dropped slabs, curbs, steps, walks etc.
- For dimensions not shown refer to Architectural Floor Plans.
- All 4" concrete slabs on soil to be reinforced with 6" x 6" No. 4 E.W.M.
- F.W.M. in center of slab.
- Typ. 6" conc. and end
- Foundations of all exist pipe lines to conform to [Symbol]

FOUNDATION PLANS - UNITS A, B & C

Scale: 1/8" = 1'-0"

FOUNDATION PLANS - UNITS A, B & C