

NO.	DESCRIPTION	DATE	BY

APPROVED BY  
 DATE

APPROVED BY  
 DATE

OFFICE OF ARCHITECTURE & CONSTRUCTION

ARCHITECT

MODULUX

ESOLER ELEM. SCHOOL  
 WILLIAM PENN. ELEM. SCHOOL  
 BAKERSFIELD CITY SCH. DIST.  
 CALIFORNIA  
 RELOCATABLE BUILDING  
 FLOOR PLAN - 30' x 30'

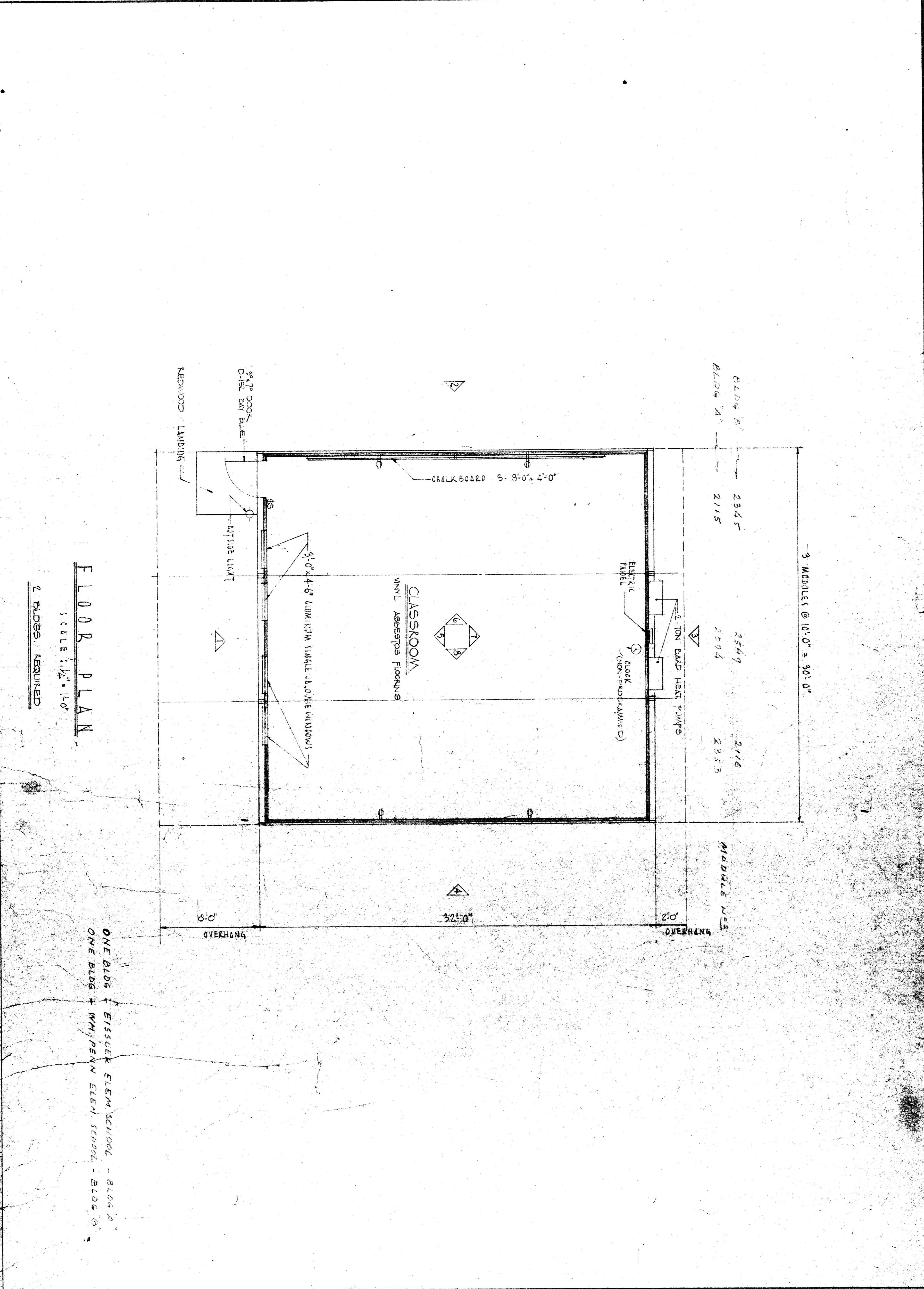

**FLOOR PLAN**  
 SCALE: 1/4" = 1'-0"  
 2 PAGES REQUIRED

ONE BLDG - EISSLER ELEM SCHOOL - 8706 S  
 ONE BLDG - WM. PENN. ELEM. SCHOOL - 8706 S

ITEM	MATERIAL & FINISH	COLOR	REMARKS
BASE	2 1/2" RISBER	BEIGE	TORSET
FLOOR	VINYL ASBESTOS	PACKUMENT	9" x 9" x 3/8" TILES
CEILING	ACROST-LUX	WHITE	UNIBOND - 400STG 101
INTERIOR WALLS	VINYL OVERLAD 1/2" PLATEX	JASON FERRE #305 C	
EXTERIOR SOIL	HOLLOW CORR. STEEL	D-152	
FRAME	LIGHT GAGE STEEL	FRONTA GREY #E-1	
EXTERIOR WALLS	WOOD FRAMED PLYWOOD PANELS OVERLAD W/ FIBERGLASS ON EXTERIOR FACE.	RAKIE BUFF #W-04	
EXTERIOR ROOFING	NOT REQUIRED		
EXTERIOR FOUNDATION	NEDWOOD	BY MODULUX	

ITEM	NO.	REMARKS
FIRE ALARM	BY SCHOOL DIST.	
FIRE EXT.	"	
OUTSIDE LIGHT	BY ARCHITECT	
LANDING	REMOVED BY SCHOOL DIST.	
DOOR	36"x72" HOLLOW CORR. STEEL	
WINDOWS	36"x48" ALUMINUM SINGLE JALOUSIE	
CHALKBOARD	3'-0" x 4'-0" FIXED (GREEN)	
WALL OUTLETS	ROUND TYPE	
WALL INSULATION	1/2" FIBREX	CENTLAD W/ VINYL
ROOF INSULATION	1 1/2" BUTTENS - FIBERGLASS BOARDS	
ROOF	3/4" STYROFOAM	
BLOCK	1	NO. 1-FLOOR FINISHED
HEAT	2	2-TON BAND HEAT PUMPS W/ A/C

GENERAL NOTES:

- FLOOR PLAN & ELEVATION CROSS REFERENCE SYMBOL