

56'-0"

8'-8"

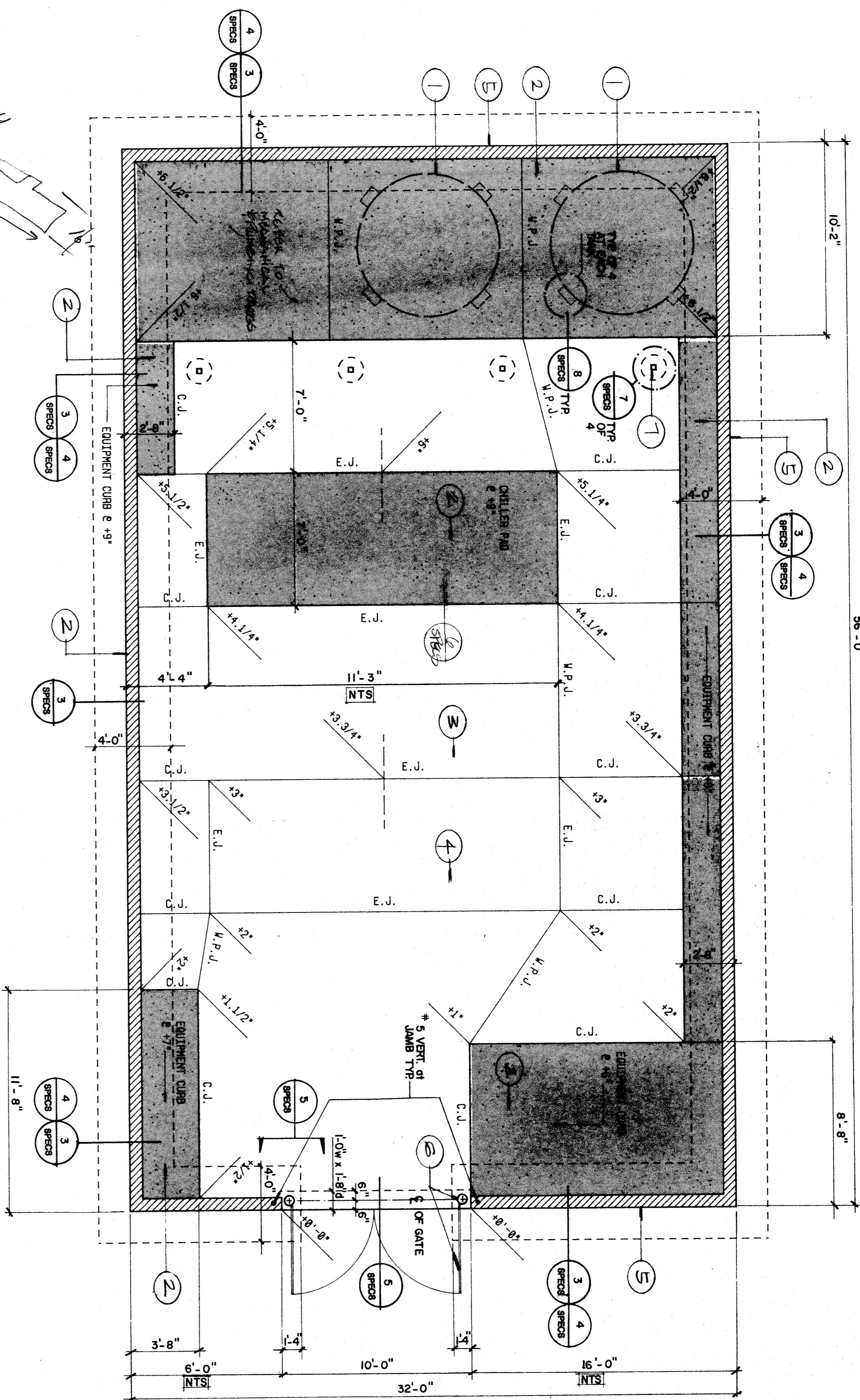

FOUNDATION/FLOOR PLAN - CHILLER ENCLOSURE

1/4" = 1'-0"



- LEGEND**
- B.F. - BOTTOM OF FOOTING
 - C.L. - CENTER LINE
 - W.P.L. - WEAKENED PLANE JOINT
 - E.L. - EQUIPMENT LEVEL
 - [Symbol] = NOT TO SCALE
- NOTES**
1. SEE SITE PLAN FOR DATUM SLAB ELEVATION.
 2. CENTER FOOTINGS UNDER WALLS UNLESS SPECIFICALLY DIMENSIONED OTHERWISE.
 3. COORDINATE LOCATION AND SIZE OF MECHANICAL AND ELECTRICAL EQUIPMENT.

GENERAL NOTES

1. TYPICAL DETAIL BAND GENERAL NOTES SHALL APPLY TO ALL CASES UNLESS SPECIFICALLY SHOWN OTHERWISE ON THE DRAWINGS. WHEN NO DETAIL IS SHOWN, THE CONTRACTOR SHALL BE RESPONSIBLE FOR PROVIDING THE DETAIL WITHIN THE PERMITS OF THE ARCHITECT.

2. THE INTERIOR OF THE DRAWINGS AND SPECIFICATIONS IS TO MODIFY THE CONTRACTOR'S RESPONSIBILITY TO PROVIDE THE CHILLER ENCLOSURE WITH THE CHILLER ENCLOSURE. THE CONTRACTOR SHALL BE RESPONSIBLE FOR PROVIDING THE CHILLER ENCLOSURE WITH THE CHILLER ENCLOSURE. THE CONTRACTOR SHALL BE RESPONSIBLE FOR PROVIDING THE CHILLER ENCLOSURE WITH THE CHILLER ENCLOSURE.

3. THE CONTRACTOR SHALL VERIFY ALL EXISTING CONDITIONS AND CONDITIONS THAT MAY AFFECT THE PROPOSED WORK. THE CONTRACTOR SHALL BE RESPONSIBLE FOR PROVIDING THE CHILLER ENCLOSURE WITH THE CHILLER ENCLOSURE. THE CONTRACTOR SHALL BE RESPONSIBLE FOR PROVIDING THE CHILLER ENCLOSURE WITH THE CHILLER ENCLOSURE.

4. CONCRETE INCLUDING SLABS ON GRADE

5. MINIMUM SLAB THICKNESS SHALL BE 4 INCHES @ 48 INCHES ON CENTER (O.C.) WITH 4 #4 BARS PER SQ. YD. CONCRETE BLOCK.

6. SHALL BE GRADE #4 ONSHED BARS WITH LIGHTWEIGHT AGGREGATES AND SHALL CONFORM TO ASTM C-616. MINIMUM COMPRESSIVE STRENGTH PER DAY:

7. MONITOR 2000 PSI

8. GROUT 2000 PSI

9. FILL ALL GROUT WITH GROUT USING LOW ALKALI PORTLAND CEMENT. THE CONTRACTOR SHALL BE RESPONSIBLE FOR PROVIDING THE CHILLER ENCLOSURE WITH THE CHILLER ENCLOSURE. THE CONTRACTOR SHALL BE RESPONSIBLE FOR PROVIDING THE CHILLER ENCLOSURE WITH THE CHILLER ENCLOSURE.

10. SHALL BE DEFORMED BARS CONFORMING TO ASTM A618, GRADE 60 FOR #4 AND LARGER AND GRADE 40 FOR #3 AND SMALLER. THE CONTRACTOR SHALL BE RESPONSIBLE FOR PROVIDING THE CHILLER ENCLOSURE WITH THE CHILLER ENCLOSURE. THE CONTRACTOR SHALL BE RESPONSIBLE FOR PROVIDING THE CHILLER ENCLOSURE WITH THE CHILLER ENCLOSURE.

11. STRUCTURAL STEEL

12. SHALL CONFORM TO THE FOLLOWING SPECIFICATIONS:

13. GRADE 50 A36 STEEL

14. GRADE 50 A36 STEEL

15. GRADE 50 A36 STEEL

16. GRADE 50 A36 STEEL

17. GRADE 50 A36 STEEL

18. GRADE 50 A36 STEEL

19. GRADE 50 A36 STEEL

20. GRADE 50 A36 STEEL

21. FABRICATION AND ERECTION SHALL CONFORM TO THE LATEST EDITION OF THE AISC SPECIFICATION. WELDING SHALL BE DONE BY THE ELECTRIC SHIELD METAL ARC PROCESS (SMAW) OR GAS METAL ARC CUTTING (GMAW) AND SHALL BE DONE IN ACCORDANCE WITH THE STRUCTURAL WELDING CODE (AWS D1.1). SHOP DRAWINGS & SETS SHALL BE SUBMITTED TO THE ARCHITECT FOR REVIEW AND APPROVAL. THE CONTRACTOR SHALL BE RESPONSIBLE FOR PROVIDING THE CHILLER ENCLOSURE WITH THE CHILLER ENCLOSURE. THE CONTRACTOR SHALL BE RESPONSIBLE FOR PROVIDING THE CHILLER ENCLOSURE WITH THE CHILLER ENCLOSURE.

22. ALL CONCRETE ANCHOR BOLTS OF THE ENCLOSURE SHALL HAVE (L.A.O. APPROVAL) AND SHALL HAVE 80 PERCENT OF THE BOLTS (ALTERNATE BOLTS IN ANY SHOP DRAWINGS) PROVED IN OCCUPANCY. THE CONTRACTOR SHALL BE RESPONSIBLE FOR PROVIDING THE CHILLER ENCLOSURE WITH THE CHILLER ENCLOSURE. THE CONTRACTOR SHALL BE RESPONSIBLE FOR PROVIDING THE CHILLER ENCLOSURE WITH THE CHILLER ENCLOSURE.

23. MATERIAL - TYPE/TEST

24. CONCRETE DIRECT PULL (NORMAL TENSION (LBS))

25. TORQUE (FT-LBS)

KEY NOTES AND CL

NOTES LISTED IN THE COLUMN WHICH ARE NOT INDICATED ON THE SHEET SHALL BE OBSERVED. COMPLETE MATCH AND REPAIR OF AREAS AND ADJACENT AREAS WHERE REMOVAL, DEMOLITION OR RECONSTRUCTION IS REQUIRED. THE CONTRACTOR SHALL BE RESPONSIBLE FOR PROVIDING THE CHILLER ENCLOSURE WITH THE CHILLER ENCLOSURE. THE CONTRACTOR SHALL BE RESPONSIBLE FOR PROVIDING THE CHILLER ENCLOSURE WITH THE CHILLER ENCLOSURE.

LEGEND

(M) - MECHANICAL

(E) - ELECTRICAL

(S) - STRUCTURAL

(C) - CONCRETE

(F) - FUTURE

(G) - GATE

(P) - PIPE SUPPORT

- 1. ICE STORAGE TANK (SEE MECHANICAL DRAWINGS)
- 2. CHILLER CURB # 48
- 3. CHILLER CURB # 48
- 4. FUTURE CHILLER SPACE
- 5. FUTURE CHILLER SPACE
- 6. GATE POST WEAIR TYPE 2
- 7. PIPE SUPPORT

TITLE 24 & 1974 UBC

DATE: 2/27/89

52439

Kendrick Design Group

architects • planners

2115 19th Street • Bakersfield, CA 93301 • (805) 322-1863

WILLIAM PENN SCHOOL MODERNIZATION

BAKERSFIELD CITY SCHOOL DISTRICT

BAKERSFIELD, CALIFORNIA

6/23/89

REVISIONS

Job number: 8711

sheet number: A-12