

WILLIAM PENN SCHOOL-SITE PLAN

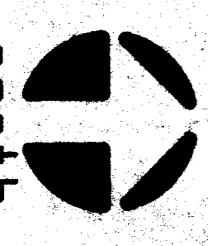

CHESTER LANE

SAN EMIDIO STREET

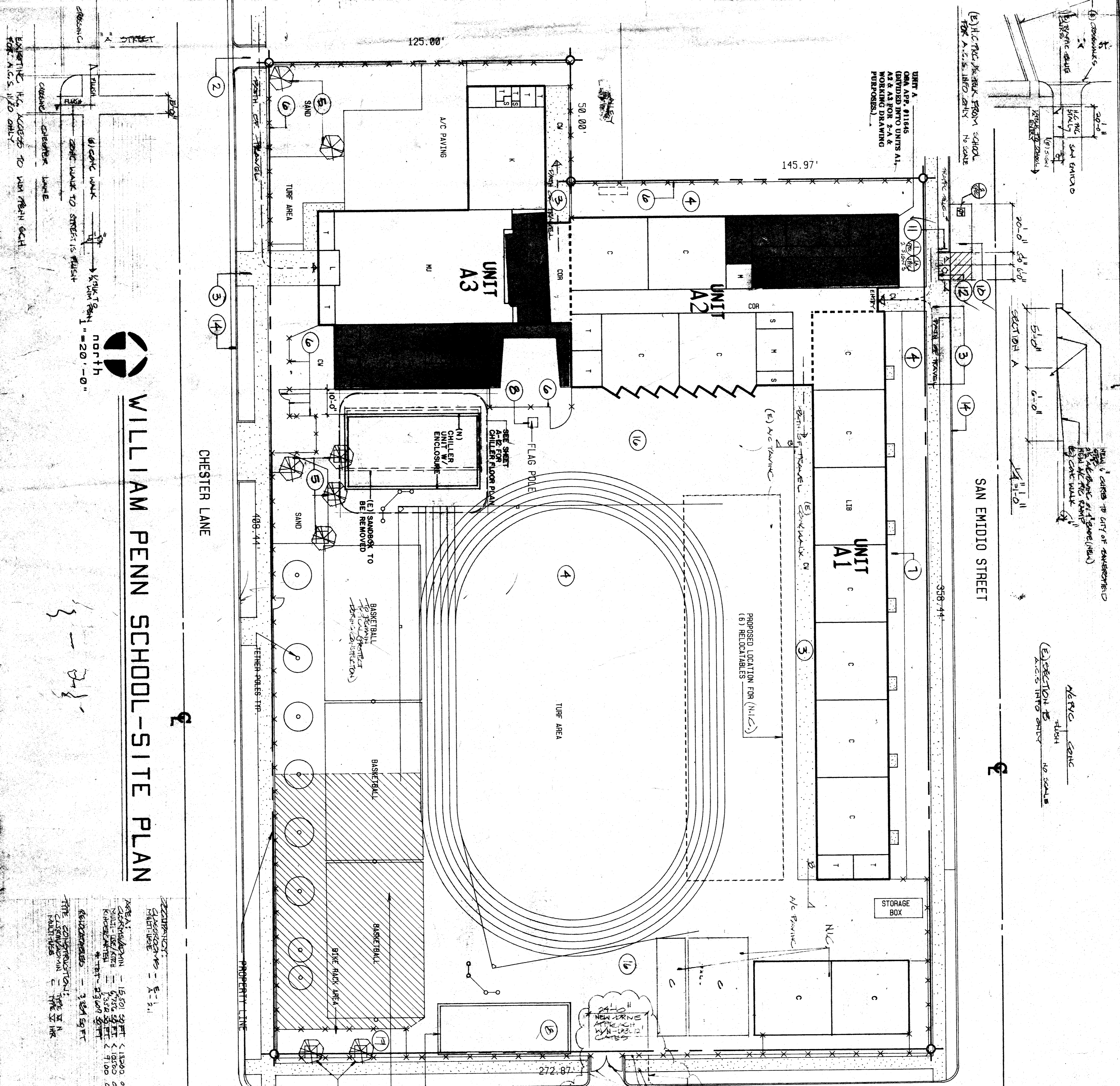

AREA 1: 15,500 SQ FT
 AREA 2: 15,500 SQ FT
 AREA 3: 15,500 SQ FT
 TOTAL: 46,500 SQ FT

NOTE: SHADED AREA IS NOT TO BE MODERNIZED.

ABREV.	DESCRIPTION
A	ADMINISTRATION
CL	CLASSROOM
C	CONFERENCE
CON	CORRIDOR
CH	COVERED WALKWAY
DW	DISH WASHING
F	FREEZER
K	KITCHEN
KIT	KITCHEN
L	LOBBY
LIB	LIBRARY
M	MECHANICAL
HU	MULTI-USE
P	PASSAGE
PL	PLATFORM
S	STORAGE
SE	SPECIAL EDUCATION
T	TOILET

LEGEND

- KEYNOTE
- DOOR NUMBER
- CABINET DESIGNATION
- BUILDING SECTION
- WALL SECTION SHEET NUMBER
- DETAILS OR PLAN ENLARGEMENT
- ROOM NUMBER
- INTERIOR ELEVATION SHEET NUMBER
- HEIGHT ELEVATION
- ACCESSORY-SEE ACCESSORY SCHEDULE
- FENCE

VICINITY MAP

(BAKERSFIELD, CALIFORNIA)

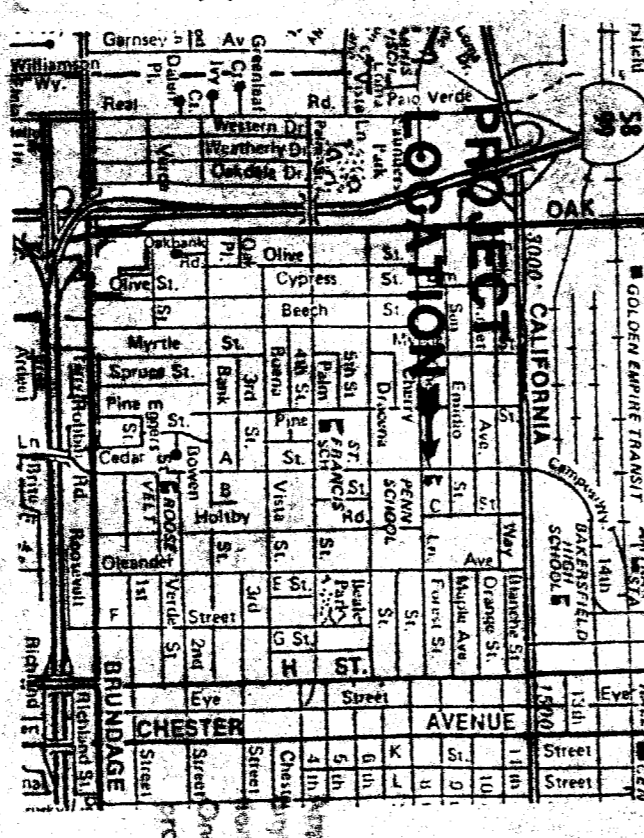

NO.	DESCRIPTION
1	ADDITIONAL WORK
2	REVISIONS
3	AS SHOWN - AS SHOWN, DETAILS
4	REVISIONS
5	REVISIONS
6	REVISIONS
7	REVISIONS
8	REVISIONS
9	REVISIONS
10	REVISIONS
11	REVISIONS
12	REVISIONS
13	REVISIONS
14	REVISIONS
15	REVISIONS
16	REVISIONS
17	REVISIONS
18	REVISIONS
19	REVISIONS
20	REVISIONS

APPROVED
 OFFICE OF STATE FIRE MARSHAL

52439 FEB 27 '90

FEB 27 1990

WILLIAM PENN SCHOOL MODERNIZATION
 BAKERSFIELD CITY SCHOOL DISTRICT
 BAKERSFIELD, CALIFORNIA

Architects - planners
 52439

NOTES: 1. THE SHADING INDICATES THE AREAS TO BE MODERNIZED. 2. THE UNSHADING INDICATES THE AREAS TO BE REMOVED. 3. THE DOTTED LINE INDICATES THE PROPOSED LOCATION FOR THE BASKETBALL COURT. 4. THE SOLID LINE INDICATES THE PROPOSED LOCATION FOR THE TURF AREA. 5. THE DASHED LINE INDICATES THE PROPOSED LOCATION FOR THE STORAGE BOX. 6. THE SOLID LINE WITH DOTS INDICATES THE PROPOSED LOCATION FOR THE FLAG POLE. 7. THE SOLID LINE WITH DOTS INDICATES THE PROPOSED LOCATION FOR THE SAND PIT. 8. THE SOLID LINE WITH DOTS INDICATES THE PROPOSED LOCATION FOR THE SAND PIT. 9. THE SOLID LINE WITH DOTS INDICATES THE PROPOSED LOCATION FOR THE SAND PIT. 10. THE SOLID LINE WITH DOTS INDICATES THE PROPOSED LOCATION FOR THE SAND PIT. 11. THE SOLID LINE WITH DOTS INDICATES THE PROPOSED LOCATION FOR THE SAND PIT. 12. THE SOLID LINE WITH DOTS INDICATES THE PROPOSED LOCATION FOR THE SAND PIT. 13. THE SOLID LINE WITH DOTS INDICATES THE PROPOSED LOCATION FOR THE SAND PIT. 14. THE SOLID LINE WITH DOTS INDICATES THE PROPOSED LOCATION FOR THE SAND PIT. 15. THE SOLID LINE WITH DOTS INDICATES THE PROPOSED LOCATION FOR THE SAND PIT. 16. THE SOLID LINE WITH DOTS INDICATES THE PROPOSED LOCATION FOR THE SAND PIT. 17. THE SOLID LINE WITH DOTS INDICATES THE PROPOSED LOCATION FOR THE SAND PIT. 18. THE SOLID LINE WITH DOTS INDICATES THE PROPOSED LOCATION FOR THE SAND PIT. 19. THE SOLID LINE WITH DOTS INDICATES THE PROPOSED LOCATION FOR THE SAND PIT. 20. THE SOLID LINE WITH DOTS INDICATES THE PROPOSED LOCATION FOR THE SAND PIT.