

OVERALL SITE PLAN ONE PORTABLE CLASSROOM

SCALE: 1" = 40'

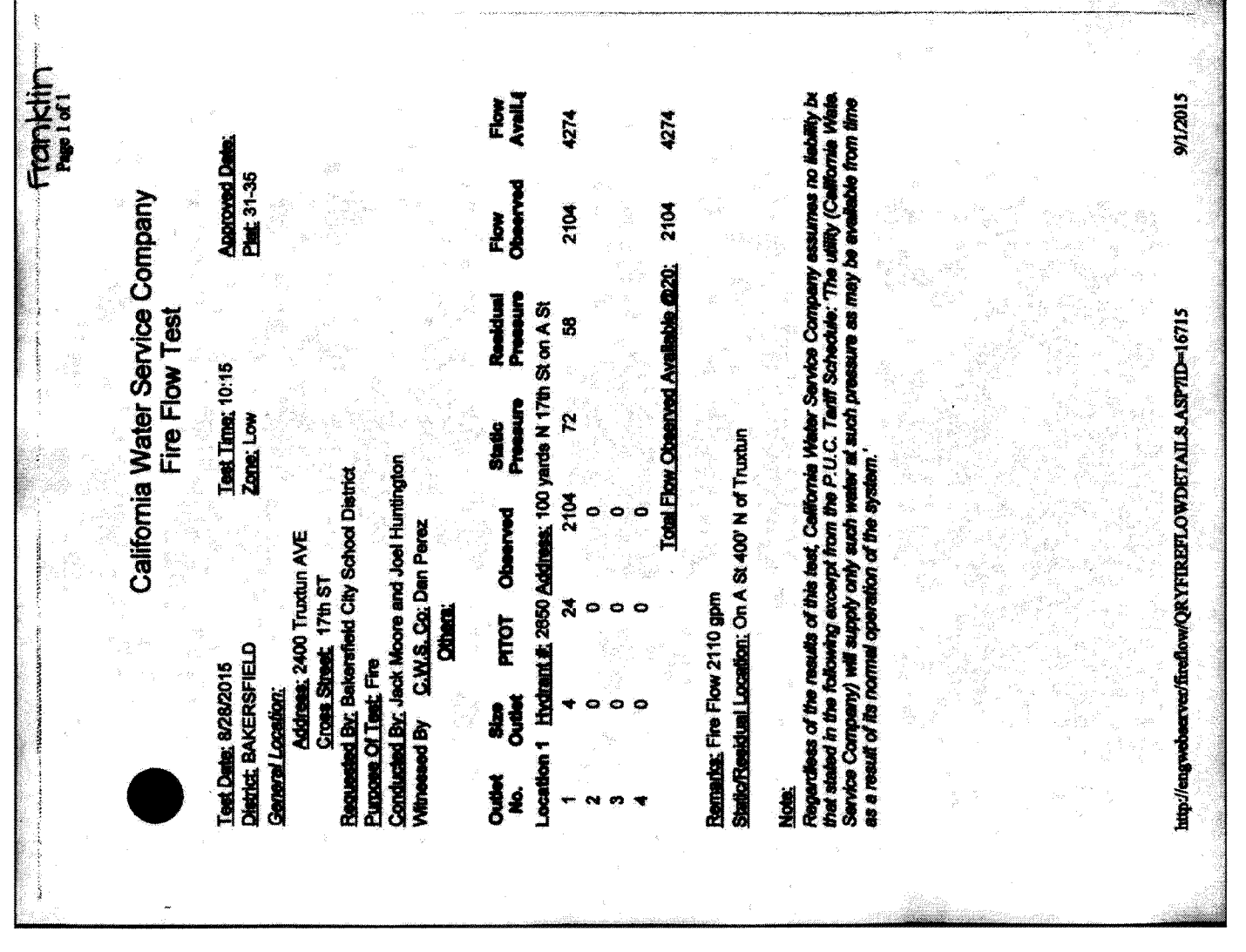
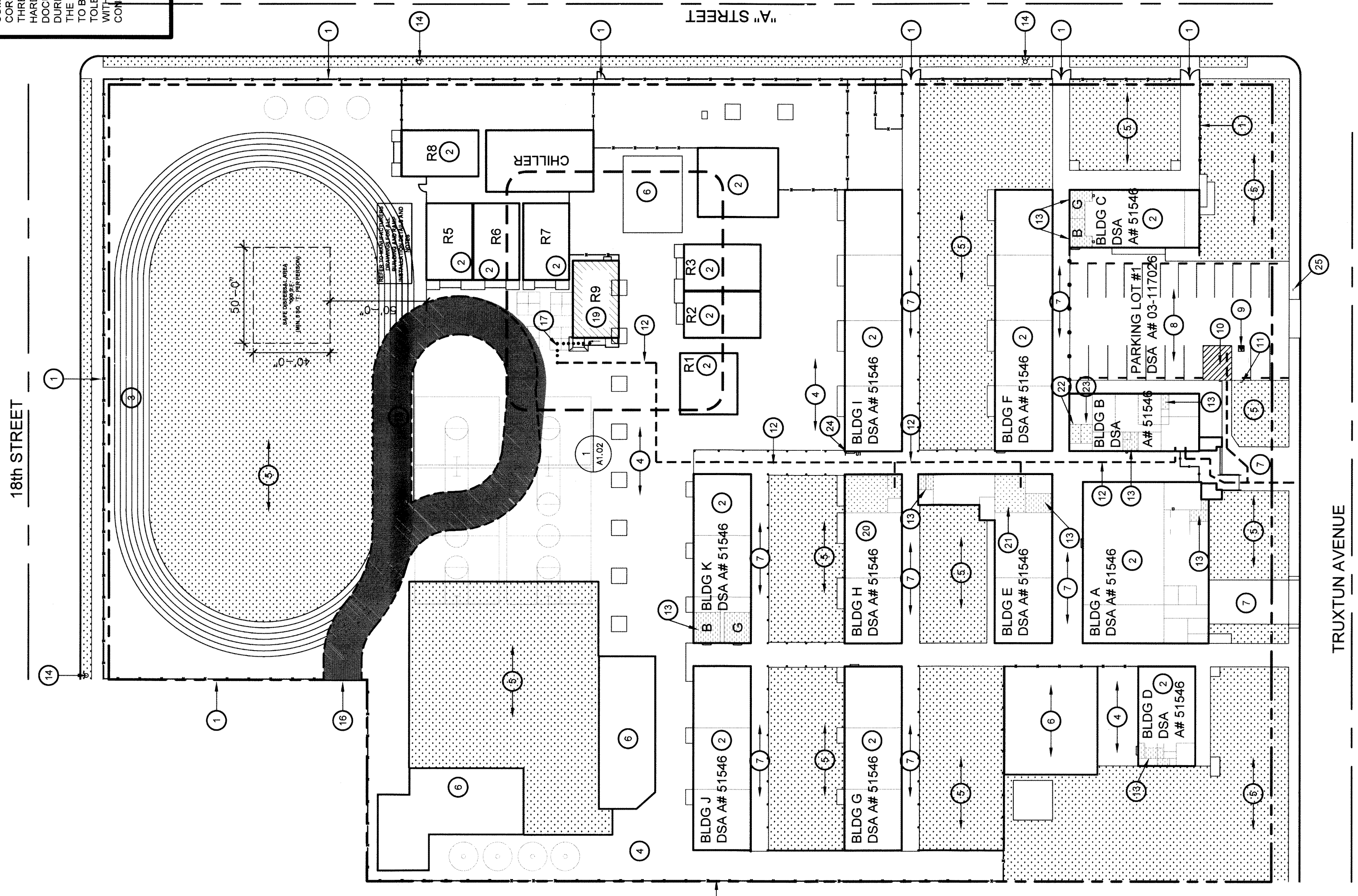

ACCESSIBILITY NOTES

THE PATH OF TRAVEL (P.O.T.) IDENTIFIED IN THESE DRAWINGS IS THE CURRENT PATH OF TRAVEL FOR THE CURRENT APPLICABLE CALIFORNIA BUILDING CODE ACCESSIBILITY PROVISIONS FOR PATH OF TRAVEL REQUIREMENTS FOR ALTERATIONS, ADDITIONS AND STRUCTURAL REPAIRS AS PART OF THE DESIGN OF THIS PROJECT. THE P.O.T. WAS EXAMINED AND ANY ELEMENTS, COMPONENTS OR PORTIONS OF THE P.O.T. IDENTIFIED AND 2) THE CORRECTIVE WORK NECESSARY TO BRING THEM INTO COMPLIANCE HAS BEEN INCLUDED WITHIN THE SCOPE OF THIS PROJECT'S WORK THROUGH DETAILS. DRAWINGS AND SPECIFICATIONS INCORPORATED INTO THESE DRAWINGS AND SPECIFICATIONS SHALL BE CONSIDERED AS CORRECTIVE WORK. THE P.O.T. SHALL NOT BE CORRECTED BY THIS PROJECT BASED ON VALUATION THRESHOLD LIMITATIONS OR A FINDING OF UNREASONABLE HARDSHIP ARE SO INDICATED IN THESE CONSTRUCTION DOCUMENTS. CONSTRUCTION, IF P.O.T. ITEMS WITHIN THE SCOPE OF THE PROJECT REPRESENTED AS CODE COMPLIANT ARE FOUND TO BE NONCONFORMING BEYOND REASONABLE CONSTRUCTION TOLERANCES, THEY SHALL BE BROUGHT INTO COMPLIANCE WITH THE CBC AS A PART OF THIS PROJECT BY MEANS OF A CONSTRUCTION CHANGE DOCUMENT.

- ARCHITECT HAS INSPECTED THE PATH OF TRAVEL (P.O.T.) AS INDICATED ON THE PLANS GENERAL WORK WHICH WOULD CAUSE IT TO BE A BARRIER-FREE ACCESSIBLE ROUTE.
- AT LEAST 48" IN WIDTH, OR AS APPROVED BY CODE
- FREE OF ABRUPT LEVEL CHANGES EXCEEDING 1/4" IF BEVELED AT 1:5 MAX SLOPE, OR VERTICAL LEVEL CHANGES EXCEEDING 1/4"
- WITH A FIRM, STABLE, AND SLIP RESISTANT WALKING SURFACE
- WITH A RUNNING SLOPE OF 1:20 (5%) OR LESS AND WITH A CROSS SLOPE OF 1:50 (2%) OR LESS OR A RAMP WITH A RUNNING SLOPE OF 1:12 (8.33%) AND A CROSS SLOPE OF 1:50 (2%) WITH APPROPRIATE REQUIREMENTS AS DETAILED WITHIN THIS SET OF DOCUMENTS.
- IS FREE OF OVERHEAD OBSTRUCTIONS WITHIN 80" ABOVE THE WALKING SURFACE
- IS FREE OF OBJECTS WHICH PROTRUDE MORE THAN 4" BETWEEN THE HEIGHTS OF 27" AND 80" ABOVE THE WALKING SURFACE

GENERAL NOTES

- GENERAL CONTRACTOR SHALL FIELD VERIFY ALL SITE CONDITIONS PRIOR TO BID. IF ANY DISCREPANCIES ARE FOUND, THE ARCHITECT SHALL BE NOTIFIED IN WRITING.
- CONTRACTOR SHALL BE RESPONSIBLE FOR THE CORRECTNESS OF LAYOUTS AND ESTABLISHED LOCATIONS OF BURIED UTILITY LINES. ANY UTILITIES REQUIRING RELOCATION SHALL BE THE CONTRACTOR'S RESPONSIBILITY. CONTACT APPLICABLE GOVERNING AGENCIES REGARDING ARRANGEMENT AND COORDINATION OF WORK.
- GENERAL CONTRACTOR WILL BE RESPONSIBLE FOR ANY COMPACTOR RETEST DUE TO INITIAL FAILURE.
- PROJECT INSPECTOR SHALL BE EMPLOYED BY THE OWNER, APPROVED BY THE RESPONSIBLE ARCHITECT AND DSA.
- A COPY OF TITLE 24, ALL PARTS APPLICABLE, TO BE KEPT AT THE JOB SITE AT ALL TIMES.
- ADDENDA SHALL BE SIGNED BY THE ARCHITECT (RESPONSIBLE IN CHARGE) AND APPROVED BY DSA.
- C.C.D.s SHALL BE SIGNED BY THE ARCHITECT (RESPONSIBLE IN CHARGE), OWNER AND APPROVED BY DSA.
- TESTING LAB SHALL BE EMPLOYED BY THE OWNER, APPROVED BY THE RESPONSIBLE ARCHITECT AND DSA.
- ALL WORK SURFACES DISTURBED OR DAMAGED BY THE CONSTRUCTION ACTIVITIES SHALL BE REPAIRED IN KIND, REFINISHED AND FINISHED TO MATCH ADJACENT SURFACES.
- NEW CONCRETE WALKS SHALL HAVE SLOPES NOT TO EXCEED 1 IN 20 IN THE DIRECTION OF PATH OF TRAVEL. PROVIDE CONTROL JOINTS (C.J.) AT 5'-0" O.C. MAX. AND PROVIDE MEDIUM ROOM FINISH ON ALL WALKS.
- ALL BUILDING AND ROOM NAMES INDICATED ON THESE CONSTRUCTION DOCUMENTS ARE NOT THE ACTUAL BUILDING OR ROOM NAMES. THE GENERAL CONTRACTOR SHALL BE RESPONSIBLE TO COORDINATE ALL REQUIRED SIGNAGE WITH THE OWNER/ARCHITECT PRIOR TO STARTING CONSTRUCTION.
- GENERAL CONTRACTOR WILL BE RESPONSIBLE TO COORDINATE RELOCATABLE BUILDING DELIVERY DATES TO THE SCHOOL SITE WITH THE MFG.
- THE GENERAL CONTRACTOR SHALL CONSTRUCT ALL NEW RELOCATABLE BUILDING FOUNDATIONS AS PER DRAWINGS AND SPECIFICATIONS.
- THE GENERAL CONTRACTOR SHALL BE RESPONSIBLE TO PROVIDE ALL HOOR-UPS TO THE RELOCATABLE BUILDING FOUNDATIONS. ALL HOOR-UPS SHALL BE COMPLETED BY THE MANUFACTURER.
- 5'-0" DEEP X 5'-0" WIDE MINIMUM LANDINGS AT DOORWAYS SHALL BE AS DETAILED AND SHALL HAVE SLOPES (IN ANY DIRECTION) OF NOT GREATER THAN 1/4". DOORWAYS.
- GENERALIST CONTRACTOR SHALL FIELD VERIFY THAT EXISTING PATH OF TRAVEL (P.O.T.) IS A MINIMUM OF 48" WIDE. THE CONTRACTOR SHALL NOTIFY THE ARCHITECT OF RECORD AND A REMEDY OR ALTERNATE P.O.T. WILL BE PROVIDED.
- THE MAXIMUM DROP BETWEEN FINISHED GRADES AND THE TOP OF THE P.O.T. SHOULD NOT EXCEED 4". IF IT DOES, PROVIDE THE NECESSARY WARNING CURB PER CBC SEC. 11B-303.5.

810 LOCAL FIRE AUTHORITY REVIEW

To facilitate the Division of the State Architect's (DSA) approval of the FireLife Safety portion of a project, DSA requires Local Fire Authority (LFA) review of certain elements as identified in this form. Use of this form for mandatory projects requires the LFA to complete the form and return it to the project. For informational information use only, the LFA may complete the form and return it to the project.

PROJECT INFORMATION

School District/Owner: Bakersfield City School District
 School Name/School: Franklin Elementary
 Project Address: 2400 Truxtun
 LFA Agency Name: Bakersfield Fire Department
 LFA Agency Address: 2400 Truxtun
 LFA Reviewer Name: Ernie Medina
 Email: emedina@bakersfieldfire.com
 Telephone Number: 661.326.3862
 Title: Fire Plans Examiner

I have reviewed and responded to the applicable items for this project as listed below.
 Note: Only sign this form when it is approved on the project. A loose form is not acceptable to DSA.
 LFA Reviewer's Signature: *Ernie Medina* Date: *11/17/2018*
 Reviewer Key: "M" = Not approved (complete section 9)
 "N" = Not applicable to the project
 "NA" = LFA needs not to review

| Item | Y | N | NA | NR |
|---|---|---|----|----|
| 1. Building Code (CBC), use of alternate fire alarm pull stations, per the California Building Code (CBC), use of alternate fire alarm pull stations and patient transport is required. | | | | X |
| 2. Access roads, fire lane markings, gates and gate openings are in accordance with Title 19, California Code of Regulations and the California Fire Code, Chapter 5. | | | | X |
| 3. Fire hydrant location and distribution complies with the California Fire Code (or see #4). | | | | X |
| 4. Fire hydrant location and distribution complies with the California Fire Code (or see #4). If the project is located in a hazard severity zone area? (CBC, Chapter 7A, Section 707A.1.) | | | | X |
| 5. Fire hydrant location and distribution complies with the California Fire Code (or see #4). If the project is located in a hazard severity zone area? (CBC, Chapter 7A, Section 707A.1.) | | | | X |
| 6. Fire hydrant location and distribution complies with the California Fire Code (or see #4). If the project is located in a hazard severity zone area? (CBC, Chapter 7A, Section 707A.1.) | | | | X |
| 7. Check type if "Yes": <input type="checkbox"/> High <input type="checkbox"/> Moderate <input type="checkbox"/> Very High <input type="checkbox"/> WFA (If one of these boxes is checked, the project design must meet the requirements of Chapter 7A.) | | | | |

Signature of School District Official: _____ Date: _____
 Print the School District Official's Name: _____
 The location(s) of the proposed post indicator valve and fire department connection meet the requirements of the jurisdiction.
 The location(s) of the meter clock valve assembly meet the requirements of this jurisdiction.
 Is the project located in a hazard severity zone area? (CBC, Chapter 7A, Section 707A.1.)
 Yes No
 Check type if "Yes":
 High Moderate Very High WFA
 (If one of these boxes is checked, the project design must meet the requirements of Chapter 7A.)
 COMMENTS (note delineations):
 8
 9

DSA 810 (Rev. 05-15-10) Page 1 of 1
 DIVISION OF THE STATE ARCHITECT DEPARTMENT OF GENERAL SERVICES STATE OF CALIFORNIA

LEGEND

INDICATES EXISTING BUILDING TO REMAIN (NO WORK)

INDICATES NEW PORTABLE BUILDING UNDER THIS APPLICATION

INDICATES EXISTING FIRE TRUCK ACCESS OVER AC PAVING

INDICATES EXISTING RESTROOM

UPGRADED PER DSA APP NO 03-117026

INDICATES EXISTING NON-ACCESSIBLE RESTROOM TO REMAIN, NO WORK

HALF-TONE DASHED LINE INDICATES EXISTING ACCESSIBLE PATH OF TRAVEL. THIS APPLICATION

OVERALL SITE PLAN

Project Name & Address: FRANKLIN ELEMENTARY SCHOOL, 2400 TRUXTUN BAKERSFIELD, CA

Issue Date: 07/15/16

Scale: 1" = 40'

Job No: 5229

Sheet No: A1.01

KEYNOTES

- EXISTING CHAIN LINK FENCE AND GATE TO REMAIN
- EXISTING BUILDING TO REMAIN, NO WORK
- EXISTING TRACK STRIPING TO REMAIN
- EXISTING A.C. PAVING TO REMAIN
- EXISTING TURF TO REMAIN, NO WORK
- EXISTING SAND BOX PLAY AREA TO REMAIN FINISH TO REMAIN
- EXISTING CONCRETE WALK WITH MEDIUM BROOM WORK
- EXISTING A.C. PAVED PARKING LOT TO REMAIN
- EXISTING VAN ACCESSIBLE PARKING STALL PER DSA APP. NO. 03-117026
- EXISTING TOW AWAY SIGN PER DSA APP. NO. 03-117026
- EXISTING ACCESSIBLE PARKING SIGNAGE PER DSA APP. NO. 03-117026
- EXISTING ACCESSIBLE PATH OF TRAVEL TO REMAIN, VERIFY IN FIELD
- EXISTING NON ACCESSIBLE RESTROOM
- EXISTING FIRE HYDRANT TO REMAIN
- EXISTING 20' WIDE FIRE TRUCK ACCESS LANE OVER EXISTING PAVING, APPROVED BY THE LOCAL JURISDICTION
- EXISTING 20' WIDE CHAIN LINK FIRE TRUCK ACCESS GATE.
- PROPOSED ACCESSIBLE PATH OF TRAVEL (P.O.T.) REFER TO ACCESSIBILITY NOTE, THIS SHEET
- NOT USED
- NEW MODULAR CLASSROOM ON WOOD FOUNDATION WITH METAL RAMPS INSTALLED PER MANUFACTURERS DRAWINGS
- EXISTING ACCESSIBLE BOYS RESTROOM PER DSA APP. NO. 03-117026
- EXISTING GIRLS RESTROOM PER DSA APP. NO. 03-117026
- EXISTING MEN'S RESTROOM PER DSA APP. NO. 03-117026
- EXISTING WOMEN'S RESTROOM PER DSA APP. NO. 03-117026
- EXISTING ACCESSIBLE DRINKING FOUNTAIN PER DSA APP. NO. 03-117026
- EXISTING SITE ENTRANCE SIGN PER DSA APP. NO. 03-117026

FLOOD ZONE INFO

FLOOD ZONE DESIGNATION: ZONE X (0.2%)

F.I.R.M. PANEL DESIGNATION: 06029C2282E

EFFECTIVE DATE OF F.I.R.M.: 09/26/2008

BASE FLOOD ELEVATION (BFE): -400 FT.

COMMUNITY ORDINANCE SECTION: BMC 15.74.040

PARKING CALCULATION

PARKING LOT #1, APP# 51546

TOTAL STALLS PROVIDED: 22

ACCESSIBLE STALLS REQUIRED PER CBC TABLE 11B-208.2: 1

VAN SPACES REQUIRED (1 PER 6 ADA): 1

ACCESSIBLE STALLS PROVIDED: 0 REGULAR, 1 VAN, 1 TOTAL

Ownership of Documents: The documents herein are the property of Integrated Design by SOMAM, Inc. Professional Service is the property of Integrated Design by SOMAM, Inc. No part of these documents may be reproduced or transmitted in any form or by any means, electronic, mechanical, photocopying, recording, or by any information storage and retrieval system, without written authorization from Integrated Design by SOMAM, Inc. © COPYRIGHT 2015

6011 N. Fresno, Suite 130 - Fresno, California 93710
 Phone (559) 436-0861 Fax (559) 436-0867 E-Mail: design@somam.com

www.integrateddesign.com

GENERAL NOTES

- GENERAL CONTRACTOR SHALL FIELD VERIFY ALL SITE CONDITIONS PRIOR TO BID. IF ANY DISCREPANCIES ARE FOUND, THE ARCHITECT SHALL BE NOTIFIED IN WRITING.
- CONTRACTOR SHALL BE RESPONSIBLE FOR THE CORRECTNESS OF LAYOUTS AND ESTABLISHED LOCATIONS OF BURIED UTILITY LINES. ANY UTILITIES REQUIRING RELOCATION SHALL BE THE CONTRACTOR'S RESPONSIBILITY. CONTACT APPLICABLE GOVERNING AGENCIES REGARDING ARRANGEMENT AND COORDINATION OF WORK.
- GENERAL CONTRACTOR WILL BE RESPONSIBLE FOR ANY COMPACTOR RETEST DUE TO INITIAL FAILURE.
- PROJECT INSPECTOR SHALL BE EMPLOYED BY THE OWNER, APPROVED BY THE RESPONSIBLE ARCHITECT AND DSA.
- A COPY OF TITLE 24, ALL PARTS APPLICABLE, TO BE KEPT AT THE JOB SITE AT ALL TIMES.
- ADDENDA SHALL BE SIGNED BY THE ARCHITECT (RESPONSIBLE IN CHARGE) AND APPROVED BY DSA.
- C.C.D.s SHALL BE SIGNED BY THE ARCHITECT (RESPONSIBLE IN CHARGE), OWNER AND APPROVED BY DSA.
- TESTING LAB SHALL BE EMPLOYED BY THE OWNER, APPROVED BY THE RESPONSIBLE ARCHITECT AND DSA.
- ALL WORK SURFACES DISTURBED OR DAMAGED BY THE CONSTRUCTION ACTIVITIES SHALL BE REPAIRED IN KIND, REFINISHED AND FINISHED TO MATCH ADJACENT SURFACES.
- NEW CONCRETE WALKS SHALL HAVE SLOPES NOT TO EXCEED 1 IN 20 IN THE DIRECTION OF PATH OF TRAVEL. PROVIDE CONTROL JOINTS (C.J.) AT 5'-0" O.C. MAX. AND PROVIDE MEDIUM ROOM FINISH ON ALL WALKS.
- ALL BUILDING AND ROOM NAMES INDICATED ON THESE CONSTRUCTION DOCUMENTS ARE NOT THE ACTUAL BUILDING OR ROOM NAMES. THE GENERAL CONTRACTOR SHALL BE RESPONSIBLE TO COORDINATE ALL REQUIRED SIGNAGE WITH THE OWNER/ARCHITECT PRIOR TO STARTING CONSTRUCTION.
- GENERAL CONTRACTOR WILL BE RESPONSIBLE TO COORDINATE RELOCATABLE BUILDING DELIVERY DATES TO THE SCHOOL SITE WITH THE MFG.
- THE GENERAL CONTRACTOR SHALL CONSTRUCT ALL NEW RELOCATABLE BUILDING FOUNDATIONS AS PER DRAWINGS AND SPECIFICATIONS.
- THE GENERAL CONTRACTOR SHALL BE RESPONSIBLE TO PROVIDE ALL HOOR-UPS TO THE RELOCATABLE BUILDING FOUNDATIONS. ALL HOOR-UPS SHALL BE COMPLETED BY THE MANUFACTURER.
- 5'-0" DEEP X 5'-0" WIDE MINIMUM LANDINGS AT DOORWAYS SHALL BE AS DETAILED AND SHALL HAVE SLOPES (IN ANY DIRECTION) OF NOT GREATER THAN 1/4". DOORWAYS.
- GENERALIST CONTRACTOR SHALL FIELD VERIFY THAT EXISTING PATH OF TRAVEL (P.O.T.) IS A MINIMUM OF 48" WIDE. THE CONTRACTOR SHALL NOTIFY THE ARCHITECT OF RECORD AND A REMEDY OR ALTERNATE P.O.T. WILL BE PROVIDED.
- THE MAXIMUM DROP BETWEEN FINISHED GRADES AND THE TOP OF THE P.O.T. SHOULD NOT EXCEED 4". IF IT DOES, PROVIDE THE NECESSARY WARNING CURB PER CBC SEC. 11B-303.5.