

DETAIL OF RECESSED LIGHT SUPERLUCKY
SCALE: 1/8" = 1'-0"

BOYER LIGHTS
RECESSED LIGHTS
WITH FLUORESCENT TUBES OR WHITE
INCANDESCENT BULBS. THE LIGHTS
ARE NATURAL IN COLOR AND OF THE
HIGHEST QUALITY. THEY ARE
DESIGNED TO BE INSTALLED IN
ANY TYPE OF RECESSED LIGHTING
FIXTURE. THE LIGHTS ARE
AVAILABLE IN A VARIETY OF
SIZES AND COLORS. CONTACT
BOYER LIGHTS FOR MORE
DETAILS.

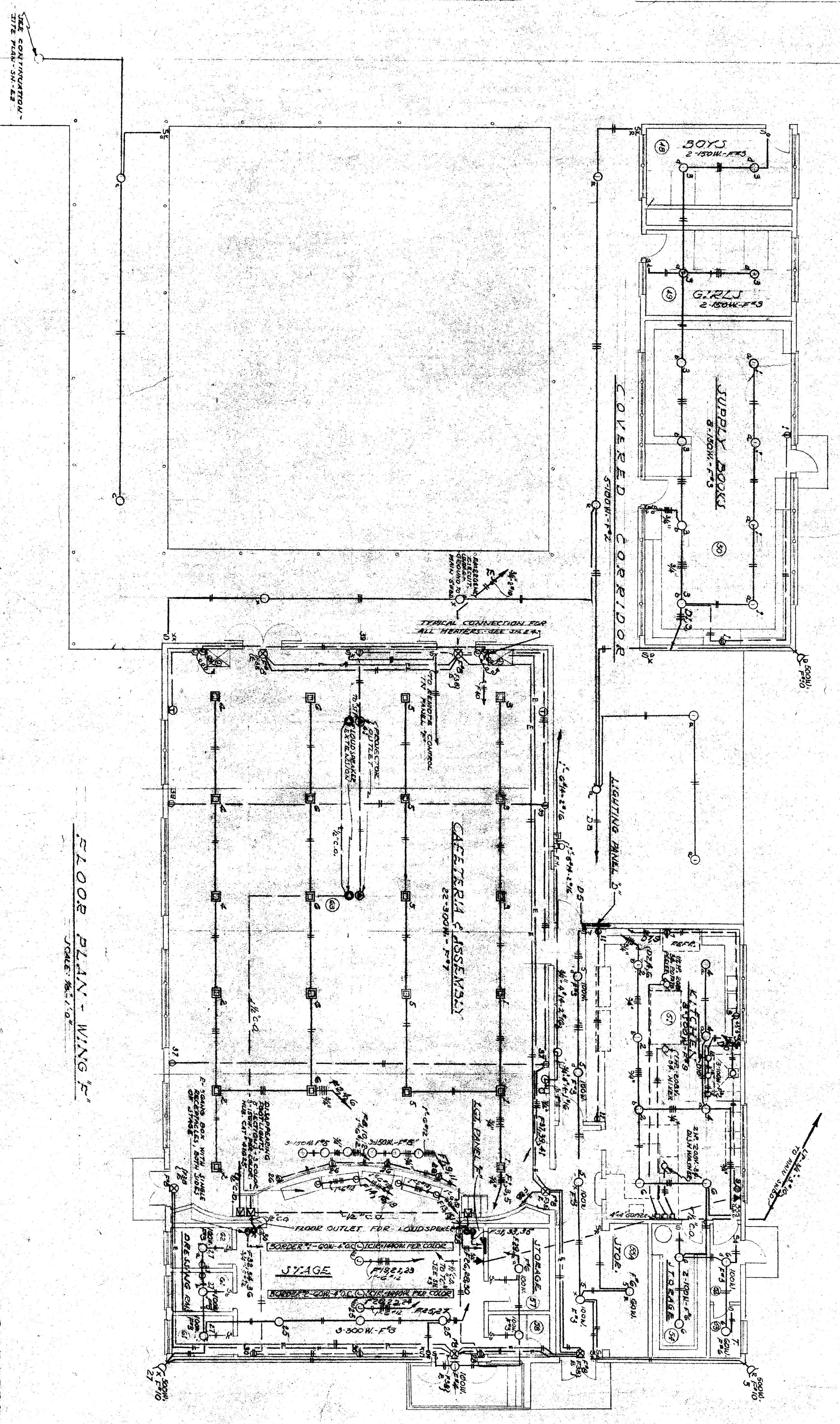

FLOOR PLAN - WING 'F'
SCALE: 1/8" = 1'-0"

HILBURG BYLER & HINGSTLER
MECHANICAL AND ELECTRICAL
ENGINEERS
287 SOUTH SPRING STREET
LOS ANGELES 12, CALIFORNIA

STATE OF CALIFORNIA
DEPARTMENT OF PUBLIC WORKS
DIVISION OF ARCHITECTURE
APPROVED
3 JUL 48
HARRY H. HARRIS
CHIEF ARCHITECT

BAKERFIELD CITY SCHOOLS
1600 K ST. BAKERFIELD CAL.
BOARD OF EDUCATION
4400 9th St. BAKERFIELD CAL.
SECRETARY

ELEMENTARY SCHOOL BUILDING
WAYCIDE & 7th STREETS
BAKERFIELD
ERNEST W. WATSON
ARCHITECT
185 MAY 24th
BAKERFIELD CALIFORNIA
166 19th ST.
BAKERFIELD CALIFORNIA

DATE
DRAWN BY
CHECKED BY
E7