

KEYNOTES

- 1 EXISTING WALL HINGE WATER CLOSET TO BE REMOVED. CAP PIPING BEHIND FINISH SURFACES.
- 2 EXISTING WALL HINGE WATER CLOSET TO BE REMOVED AND SCRUBBED CLEAN. ALSO REMOVE TRIM. SEE REMOVE DETAIL A/P-7.
- 3 EXISTING SINK TO BE REMOVED AND REPAIRED WITH NEW SINK. S-1 IN NEW COUNTERTOP. PROVIDE NEW DRAINAGE WITH NEW P-TRAP. TRAP ARM, WATER STOP AND SUPPLY. ALSO RECONNECT TO EXISTING PIPING IN WALL.
- 4 EXISTING FLOOR MOUNT URINAL TO BE REMOVED. CAP PIPING BEHIND FINISH SURFACES. SEE REMOVE DETAIL A/P-7.
- 5 EXISTING LAVATORY TO BE REMOVED AND SCRUBBED CLEAN. ALSO REMOVE TRIM. SEE REMOVE DETAIL A/P-7.
- 6 EXISTING SERVICE SINK TO BE REMOVED AND SCRUBBED CLEAN. SEE REMOVE DETAIL A/P-7.
- 7 EXISTING FLOOR DRAIN TO BE REMOVED AND REPLACED WITH NEW. SEE REMOVE DETAIL A/P-7.
- 8 EXISTING FURNACE TO BE REMOVED BY AIR CONDITIONING CONTRACTOR. PLUMBING CONTRACTOR TO DISCONNECT EXISTING GAS AND CAP ABOVE CEILING.
- 9 EXISTING EVAPORATIVE COOLER TO BE REMOVED BY AIR CONDITIONING CONTRACTOR. PLUMBING CONTRACTOR TO DISCONNECT EXISTING C.W. AND CAP ABOVE CEILING BEHIND FINISH SURFACES.

NOTE:
ALL KEY NOTE NUMBERS ON THIS SHEET REFER TO THE ITEMS ON THIS SHEET ONLY AND DO NOT APPLY TO THE NUMBERS SHOWN ELSEWHERE IN THIS SET OF PLANS.

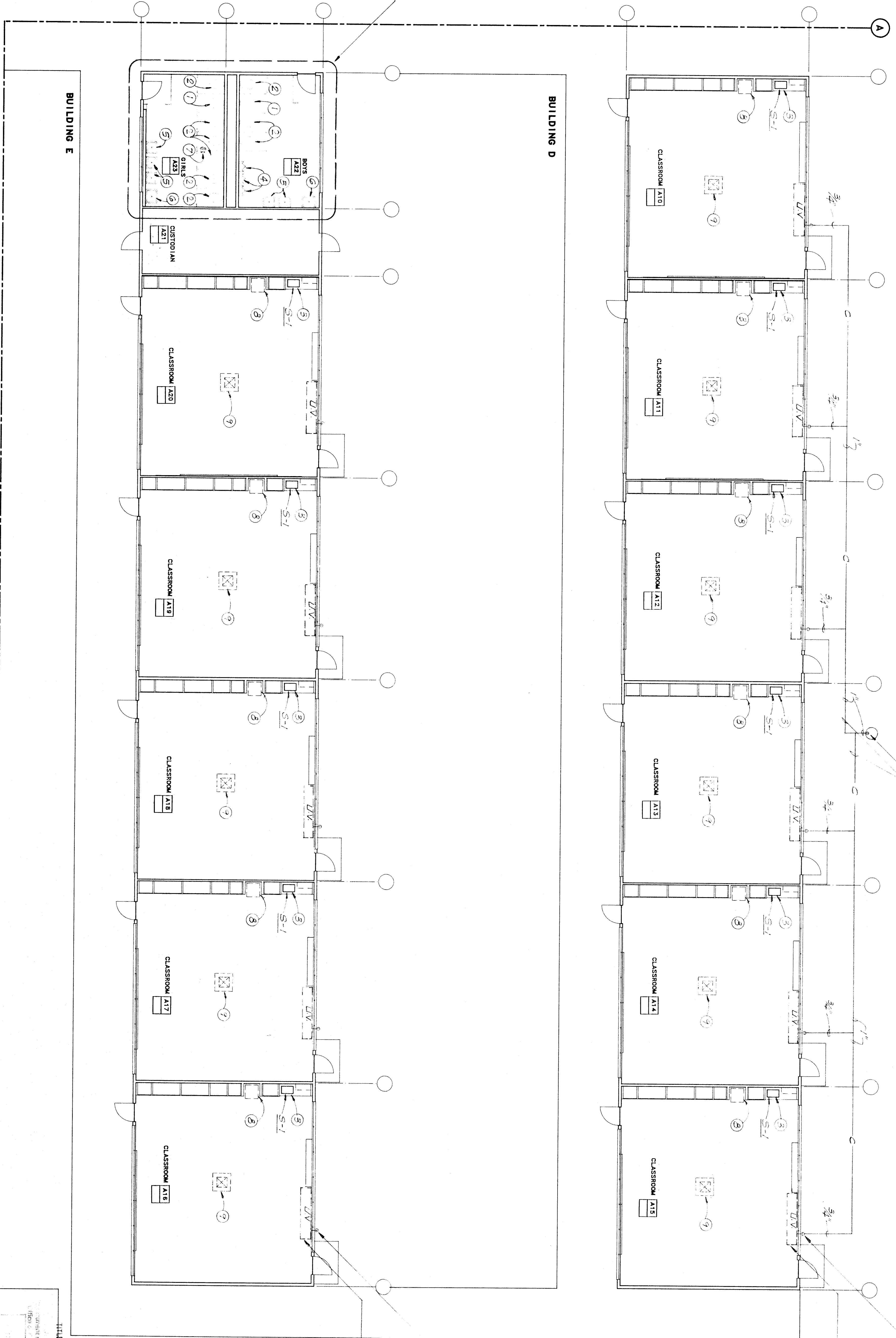

FOR PLUMBING REMOVE OF THIS AREA SEE DETAIL 1/P-7

DISCONNECT 1" COND. DRAIN TO DRYWELL. SEE DETAIL 1/P-2. PIPING SEE GRF

CONNECT 3/4" COND. DRAIN TO UNIT VENTILATOR & DROP DN ALONG OUTSIDE WALL TO BEL GR (SEE FOR CLASSROOMS IN BLDG. D)

CONNECT 3/4" COND. TO UNIT VENTILATOR & DISCHARGE TRAP W/AT. NEW 90° ELB. TRAP. EAT. NEW 1/2" SINK (BLDG. E)

UNIT VENTILATOR AT FLOOR BY AIR COND. CONTR. (BLDG. E)

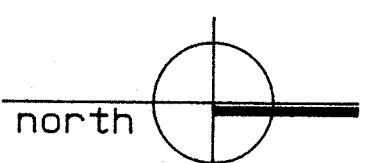

BUILDINGS D & E PLUMBING PLAN

DATE: 11/18/24
 DRAWN BY: M.T.
 CHECKED BY: G.MVE
 JOB NO.: T-22
 SHEET: P-4
 DATE: DEC 7 1990
 STATE OF CALIFORNIA
 PLUMBING BOARD

KLASSEN CORPORATION
 Architecture
 Planning
 Construction
 2021 Westwind Drive
 Bakersfield, CA 93301
 (805) 327-0875

WAYSIDE ELEMENTARY SCHOOL MODERNIZATION
 1000 MING AVENUE

DATE: 11/18/24
 ISSUED FOR: IZZAHM OALMA AMMUAL
 NOTING: OAL WANCHOROK

DATE: _____
 PREPARED BY: _____

WAYSIDE ELEMENTARY SCHOOL MODERNIZATION
 BAKERSFIELD CITY SCHOOL DISTRICT
 BAKERSFIELD, CALIFORNIA

Sheet title: **BUILDINGS D & E PLUMBING PLAN**

DATE: _____
 ISSUED FOR: IZZAHM OALMA AMMUAL
 NOTING: OAL WANCHOROK

KLASSEN CORPORATION
 Architecture
 Planning
 Construction
 2021 Westwind Drive
 Bakersfield, CA 93301
 (805) 327-0875

WAYSIDE ELEMENTARY SCHOOL MODERNIZATION
 BAKERSFIELD CITY SCHOOL DISTRICT
 BAKERSFIELD, CALIFORNIA

DATE: _____
 ISSUED FOR: IZZAHM OALMA AMMUAL
 NOTING: OAL WANCHOROK