

**13 TYPICAL CHAIN LINK FENCE AND GATES**  
A1.04 ADA100-01

**TYPICAL FENCE & GATE KEYNOTES**

- 1 4" O.D. GALVANIZED STEEL GATE POST (9.1 lb/ft)
- 2 2 7/8" O.D. GALVANIZED STEEL END OR CORNER POST (5.79 lb/ft)
- 3 2" O.D. GALVANIZED STEEL GATE FRAME (2.72 lb/ft)
- 4 1 5/8" O.D. GALVANIZED STEEL HORIZONTAL RAIL (2.27 lb/ft)
- 5 2"x2" MESH x 9 GAUGE GALVANIZED FENCE FABRIC WITH KNUCKLED TOP AND BOTTOM SELVAGE. FENCE FABRIC TO BE GALVANIZED BEFORE WEAVING (GBW)
- 6 1/4"x3/4" GALVANIZED STEEL STRETCHER BAR
- 7 GALVANIZED STEEL STRETCHER BAR TENSION BAND, MIN. OF 6 TENSION BANDS
- 8 9 GAUGE (0.148" DIA.) GALVANIZED STEEL TIE WIRES OR HOG RINGS AT 15" MAX. SPACING. MIN. 8 TIE WIRES PER EACH 10" HORIZONTAL RAIL
- 9 GALVANIZED ADJUSTABLE TURNBUCKLE FOR 3/8" DIA. TRUSS ROD
- 10 3/8" DIA. GALVANIZED STEEL ADJUSTABLE TRUSS ROD. TRUSS RODS REQUIRED FOR ALL GATE POST PANELS AND END OR CORNER POST PANELS
- 11 3/8"x6" GALVANIZED HOOK BOLT WITH NUT IMBEDDED IN MIDWAY BETWEEN POSTS
- 12 7 GAUGE (0.177" DIA.) GALVANIZED STEEL TENSION WIRE
- 13 RAINPROOF CAP
- 14 LOCKING HASP
- 15 180° GATE HINGE, TYP
- 16 12"Ø CONCRETE POST FOOTING (TYP.)
- 17 TRIM, LEVER HANDLE & RIM CYLINDER LOCK PER DISTRICT STANDARD 34" - 44"
- 18 16ga GATE GUARD
- 19 10" HIGH x GATE WIDTH, 16 ga POWDER-COATED METAL KICK PLATE, TYP BOTH SIDES OF GATE.

SCALE: N.T.S.

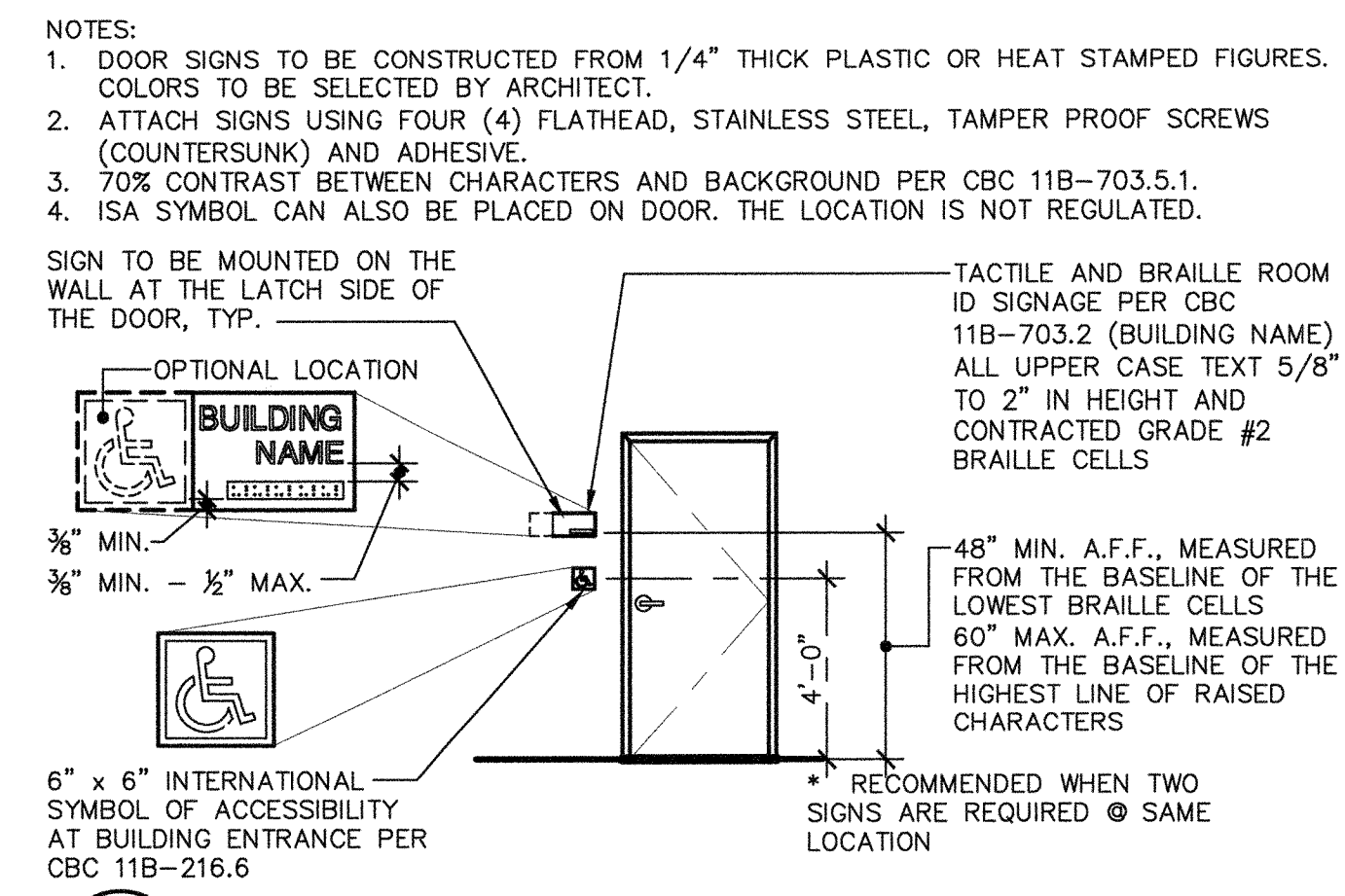

**1 BUILDING ENTRANCE/I.S.A. SIGNAGE**  
A1.04 ADA100-01

SCALE: 1" = 1'-0"

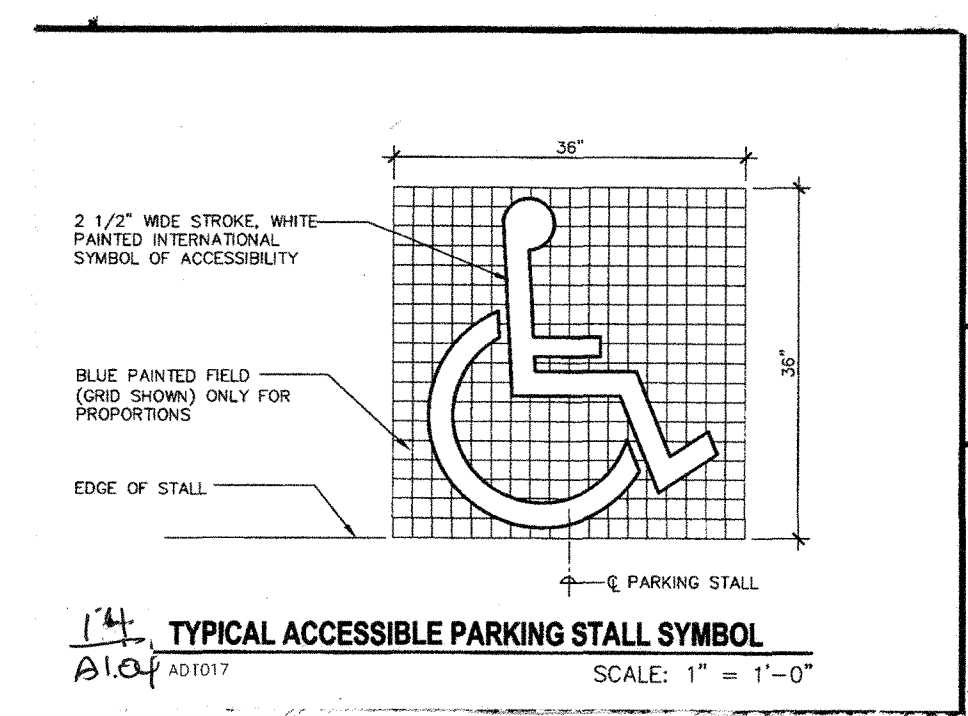

**14 TYPICAL ACCESSIBLE PARKING STALL SYMBOL**  
A1.04 AD100-07

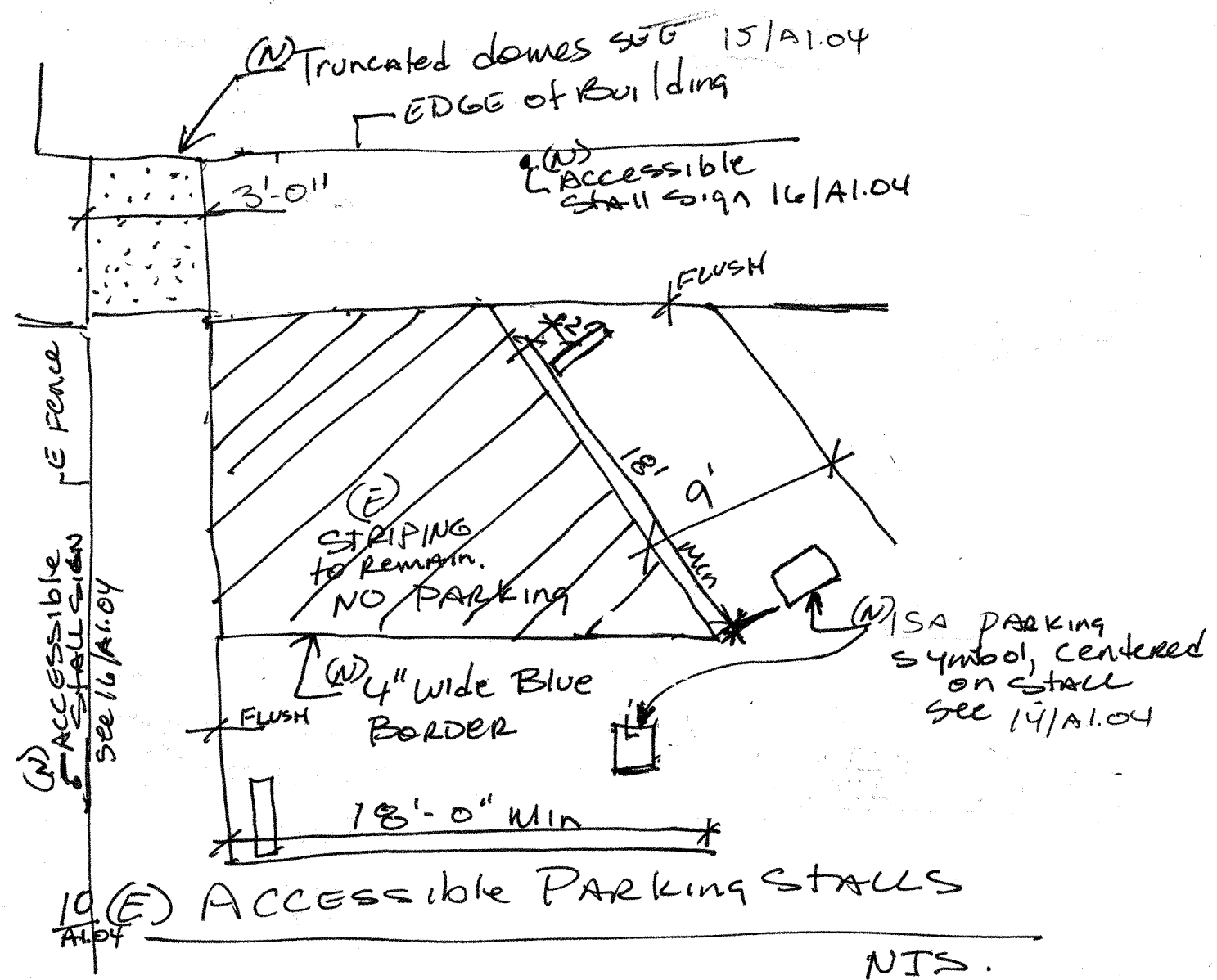

**10 (E) Accessible Parking Stalls**  
A1.04

N.T.S.

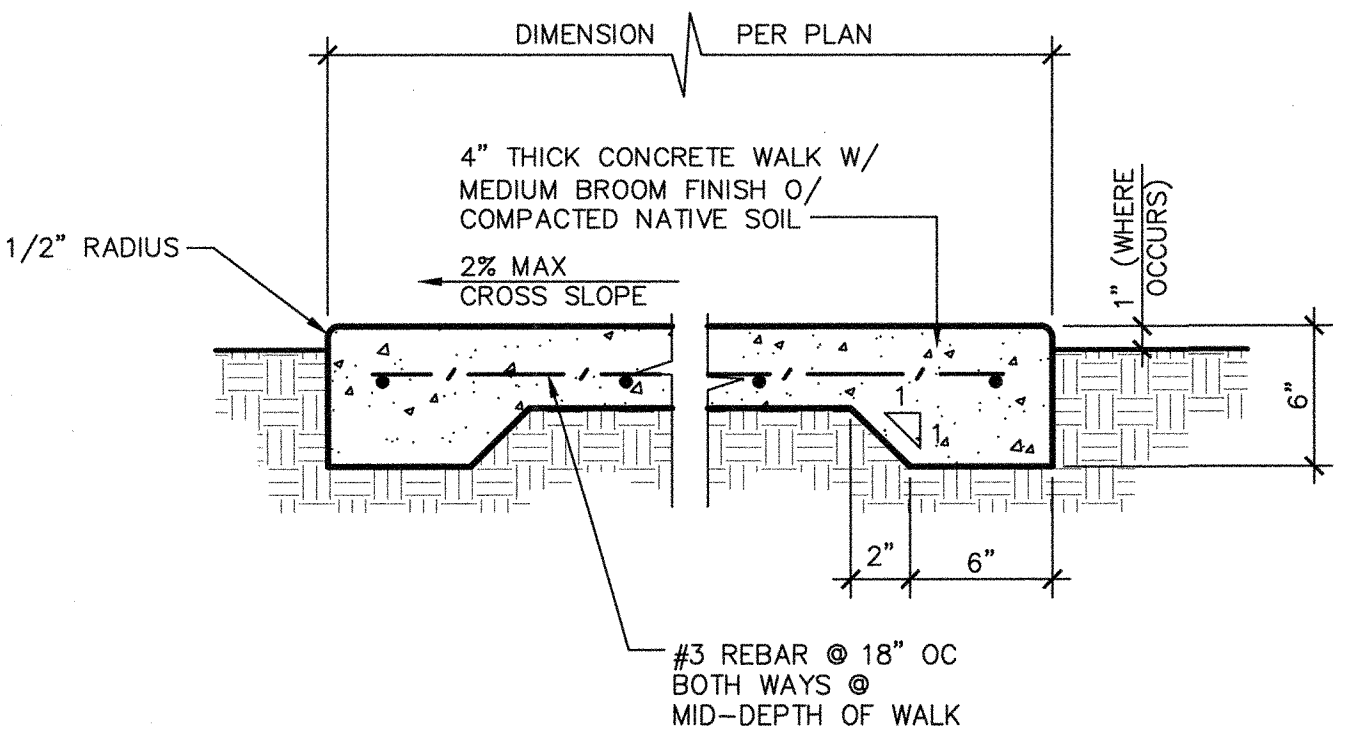

**6 TYPICAL CONCRETE WALK**  
A1.04 ADS100-03

SCALE: 1" = 1'-0"

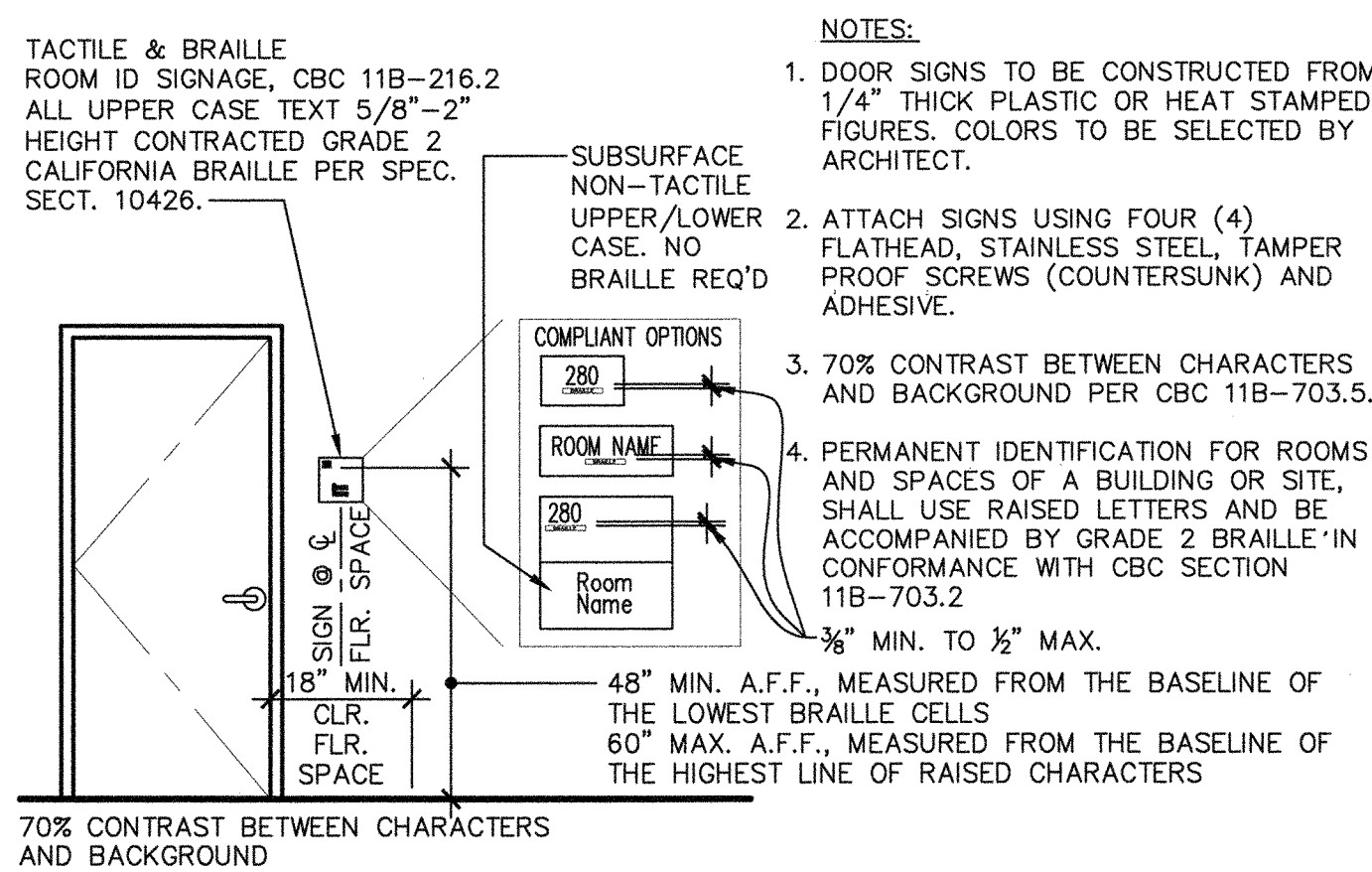

**2 ROOM ID SIGNAGE**  
A1.04 ADX100-01

SCALE: NO SCALE

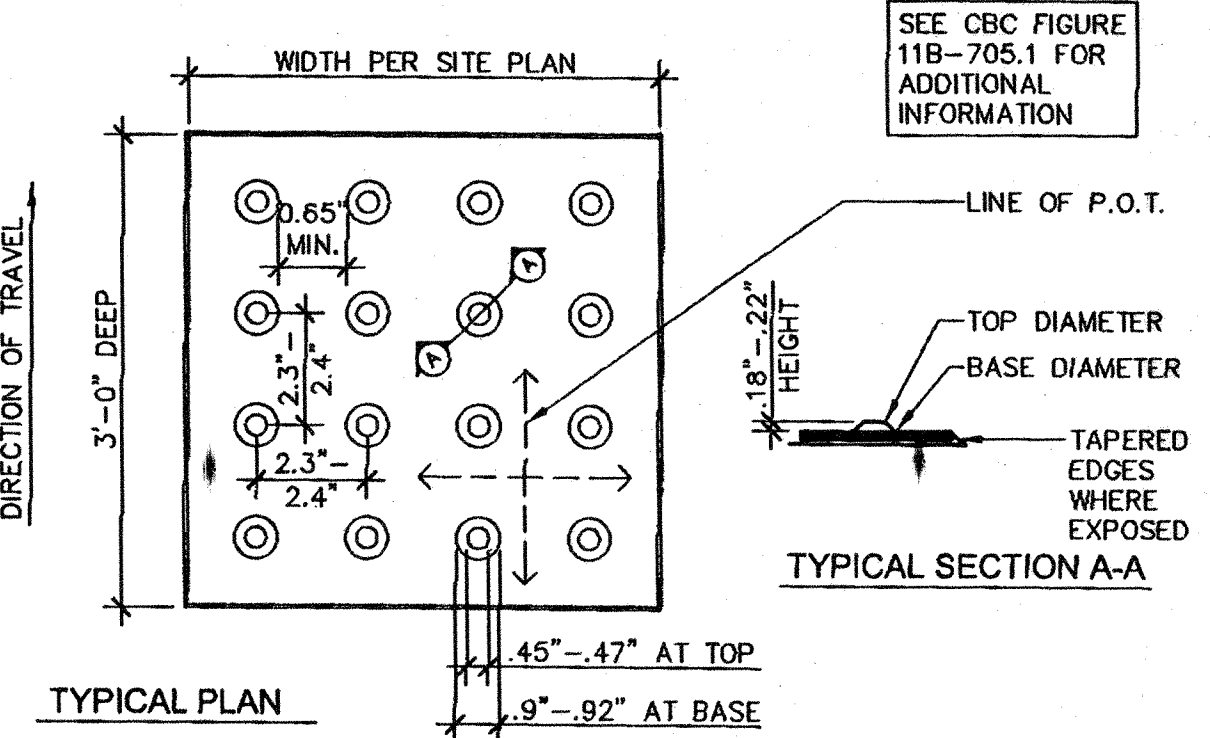

**15 TRUNCATED DOMES**  
A1.04 ADA100-23

SCALE: NO SCALE

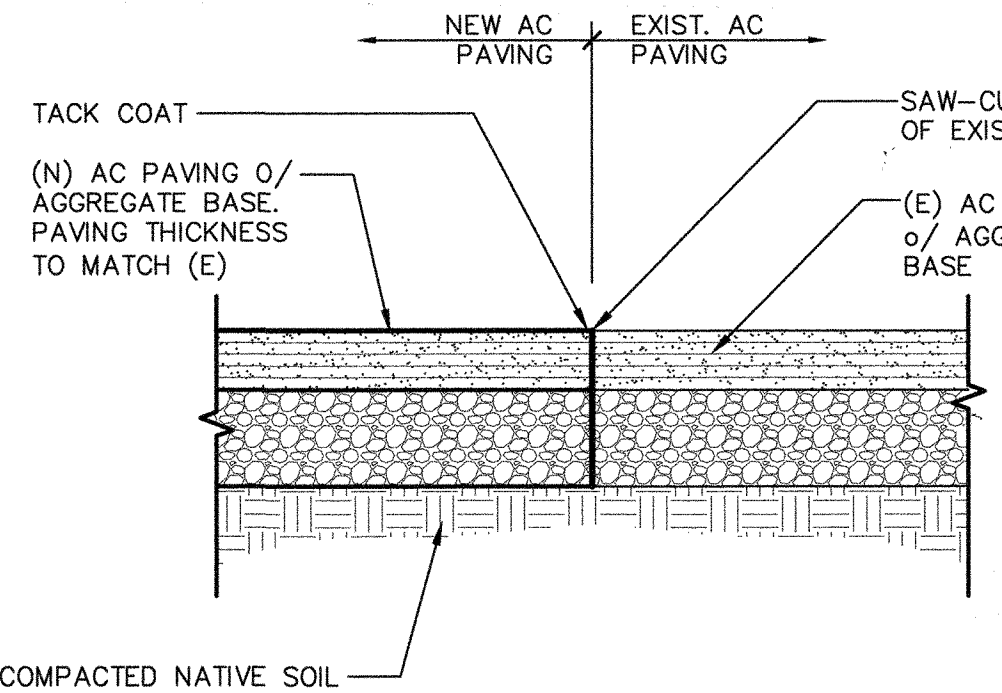

**11 (N) AC PAVING TO (E) AC PAVING**  
A1.04 ADS100-07

SCALE: 1" = 1'-0"

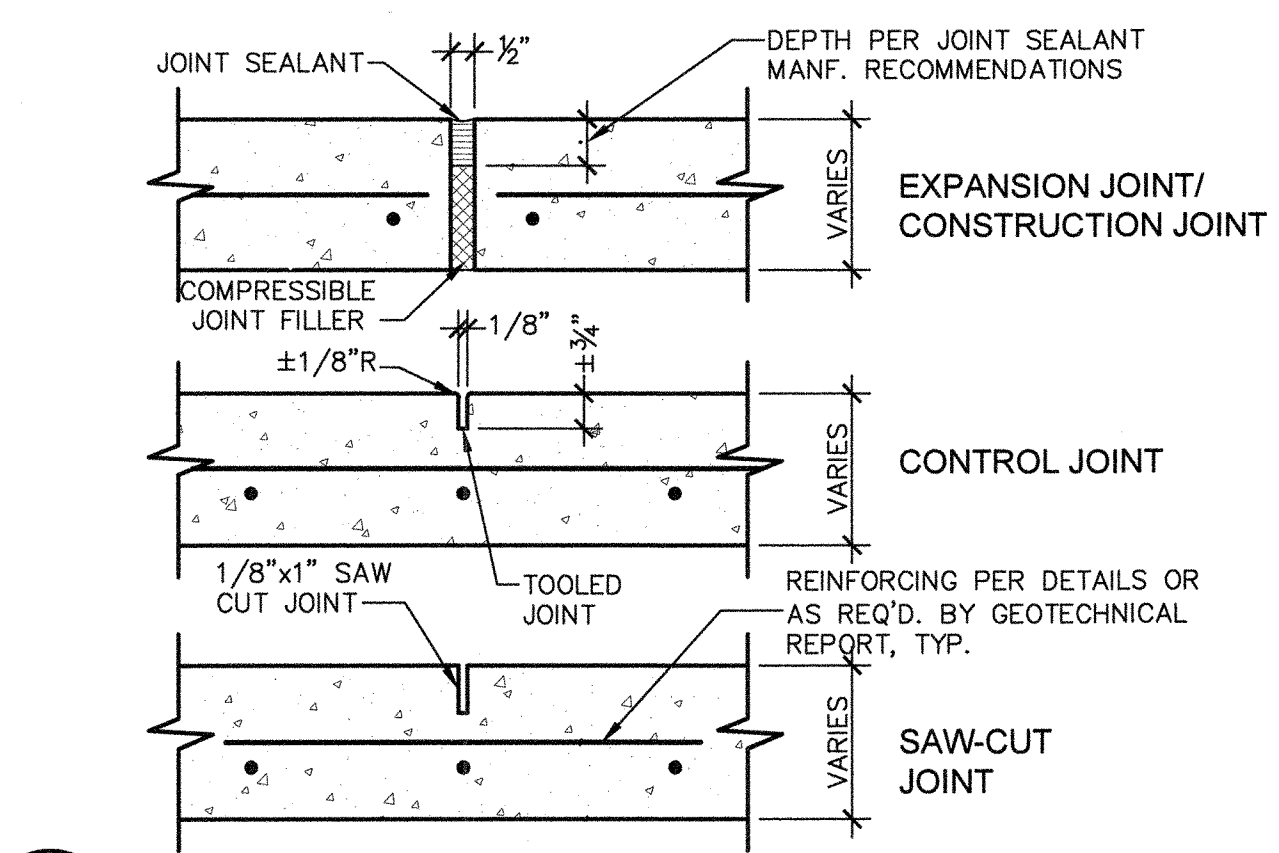

**7 CONCRETE JOINTS**  
A1.04 ADS110-01

SCALE: 1" = 1'-0"

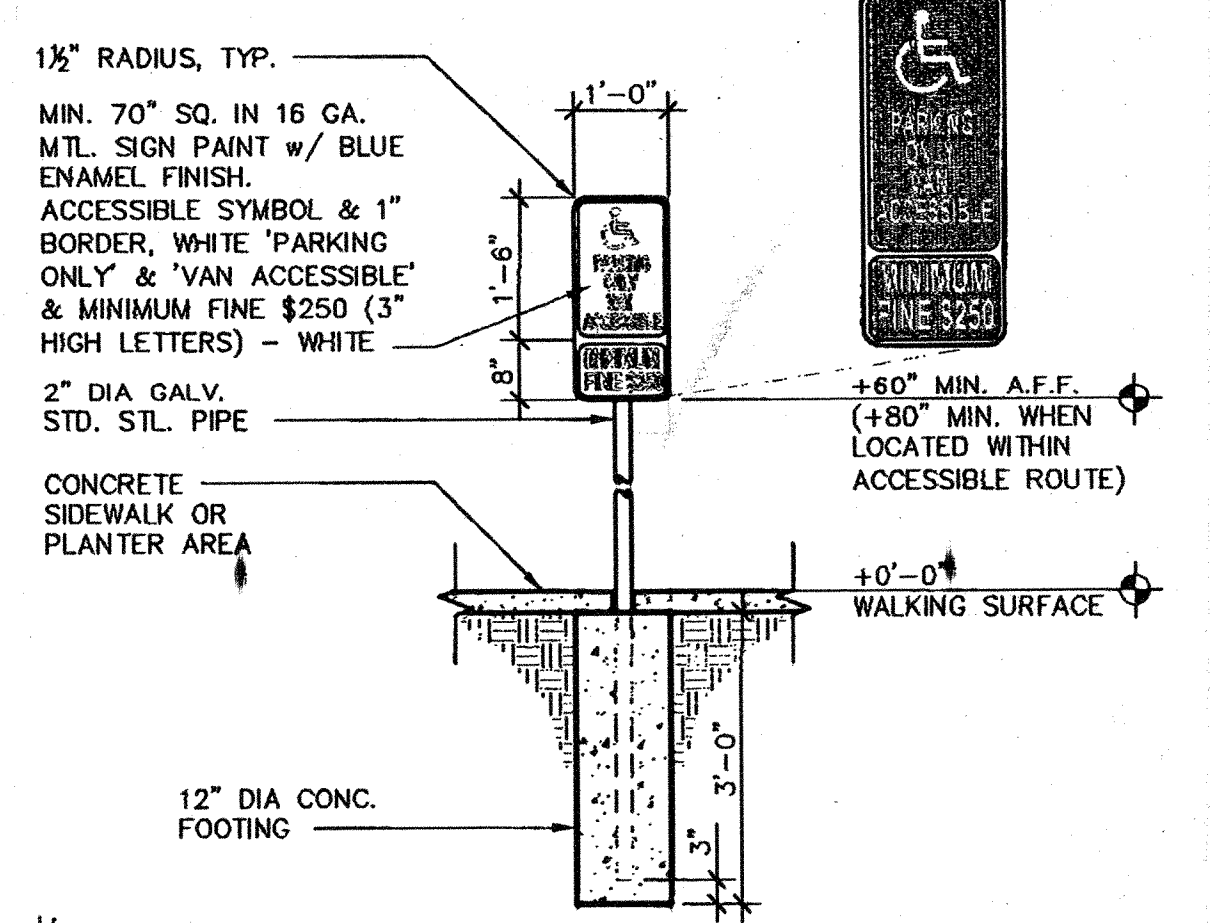

**16 VAN ACCESSIBLE PARKING SIGNAGE**  
A1.04 ADA100-50

SCALE: 1/2" = 1'-0"

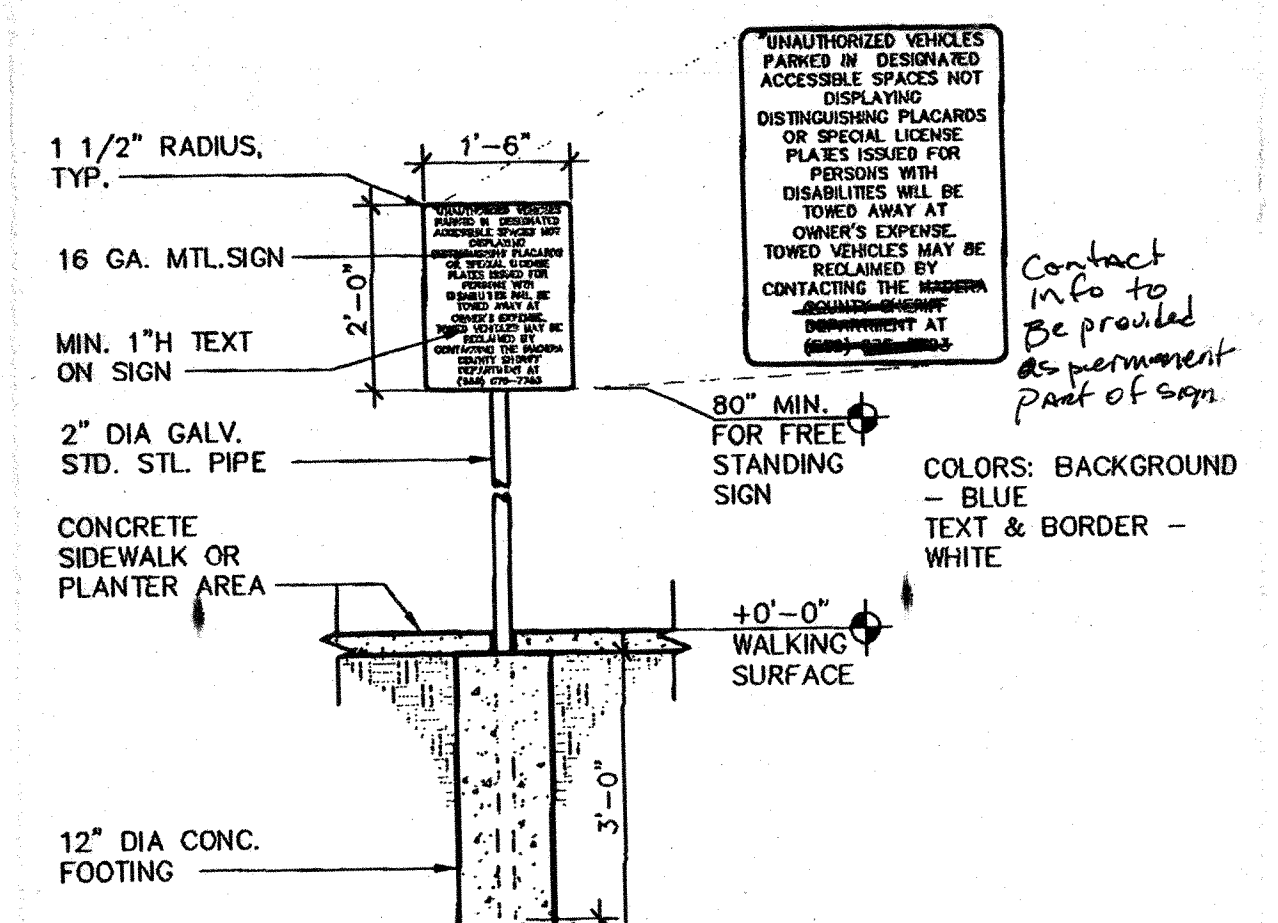

**12 TOW AWAY SIGNAGE**  
A1.04 ADA100-10

SCALE: 1/2" = 1'-0"

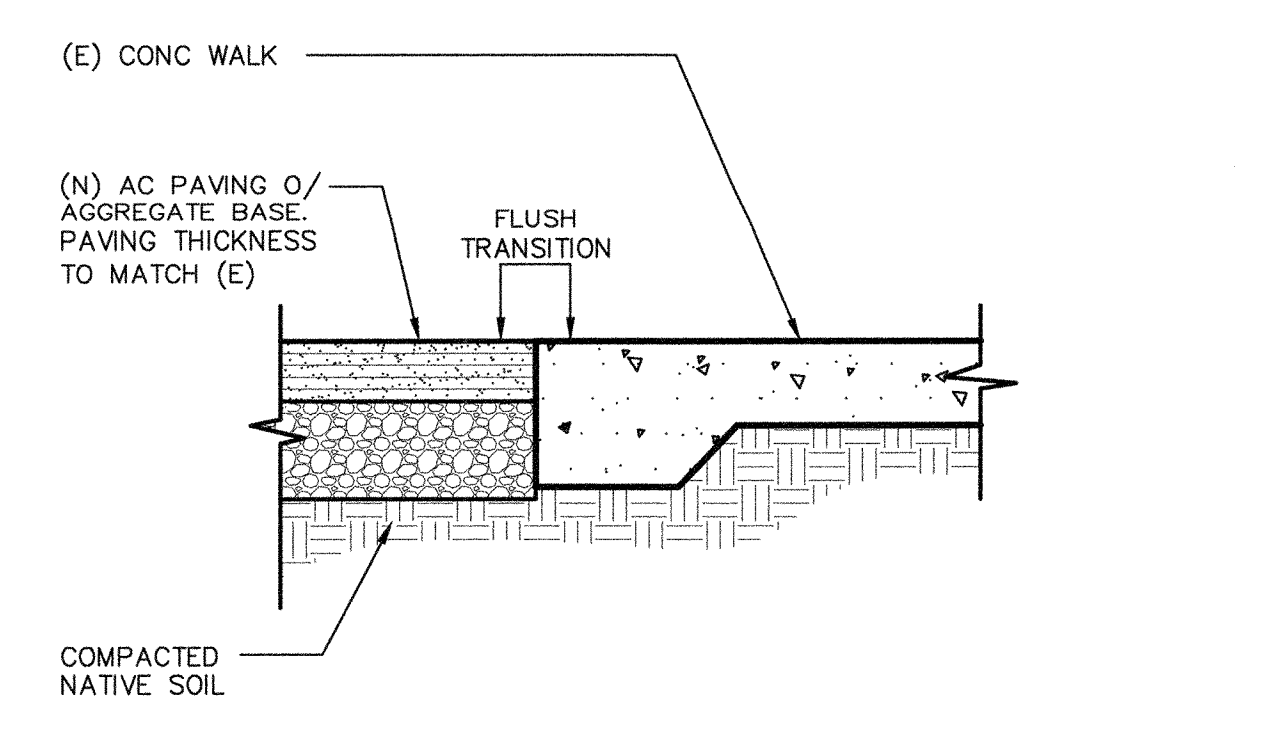

**8 (E) CONC WALK TO (N) AC PAVING**  
A1.04 ADS100-27

SCALE: 1" = 1'-0"

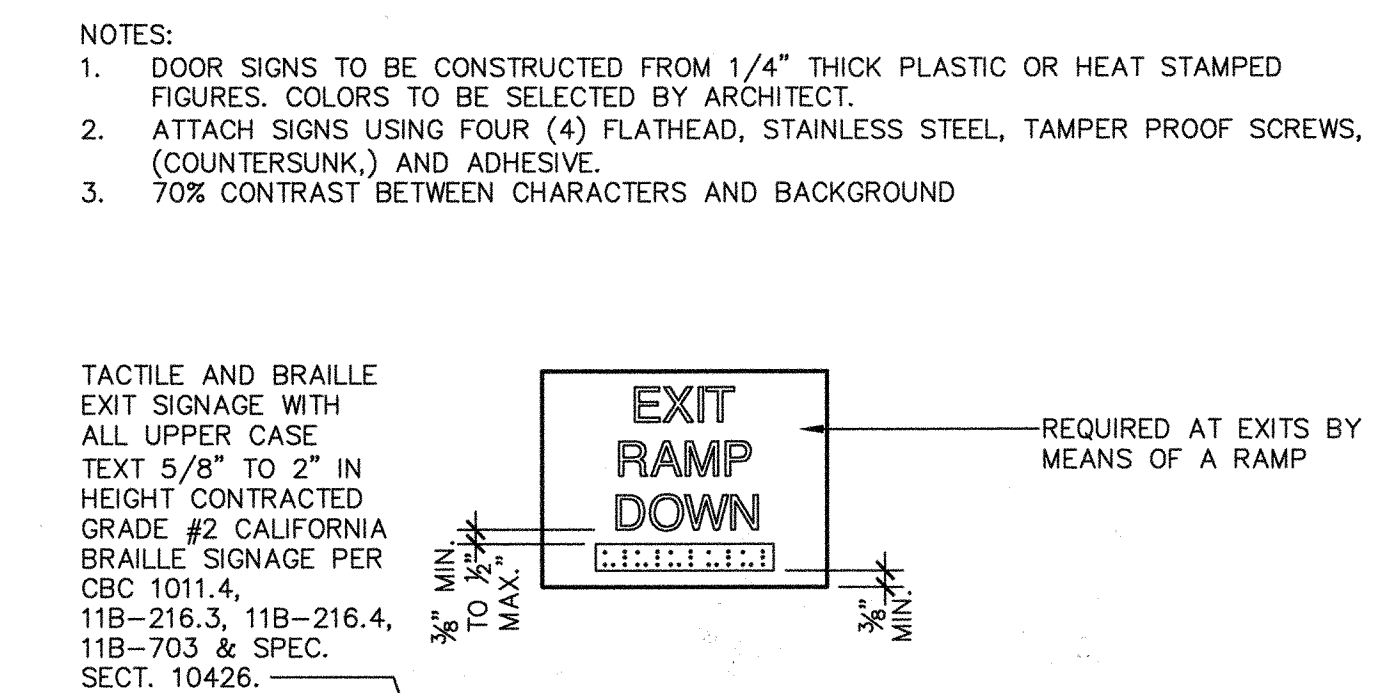

**4 TYPICAL EXTERIOR DOOR SIGNAGE**  
A1.04 ADX200-01

SCALE: 1" = 1'-0"

**Ownership of Documents**  
This document, the ideas and designs incorporated herein, as an instrument of Professional Service is the property of Integrated Designs by SOMAM Inc. and is not to be used, in whole or in part for any other project without written authorization.  
© COPYRIGHT 2015

**integrated designs** by SOMAM, Inc.  
ARCHITECTURE • ENGINEERING • INTERIOR DESIGN • CONSTRUCTION MANAGEMENT  
8011 N. Fremont, Suite 130 - Fremont, California 94701  
Phone (510) 438-0881 Fax (510) 438-0881 E-mail: design@somam.com  
www.integrateddesigns.com

**SITE DETAILS**

**WAYSIDE ELEMENTARY SCHOOL**  
PORTABLE CLASSROOMS, PRE-K AND TOILET  
BAKERSFIELD CITY SCHOOL DISTRICT  
1000 MING ROAD BAKERSFIELD, CA 93307

Issue Date: 04/22/16  
Date: 04/22/16  
Designer: [Signature]  
Checker: [Signature]  
PC INITIALS: [Signature]

Agency Approval Stamp:  
FILE # 15-6  
IDENTIFICATION STAMP  
DIV. OF THE STATE ARCHITECT  
OFFICE OF REGULATION SERVICES  
03-117237  
AC [Signature]  
DATE 02 29 16  
TRACKING #:

Stamp(s):  
[Professional Seal]

Job No: **5204**

Sheet No: **A1.04**

Release: -

G:\2016\15-6-5204 Wayside Pre-K\Sheets\A1.04 SITE DETAILS.dwg RICHARD DELLANINI