

FAIRGROUND PARKING

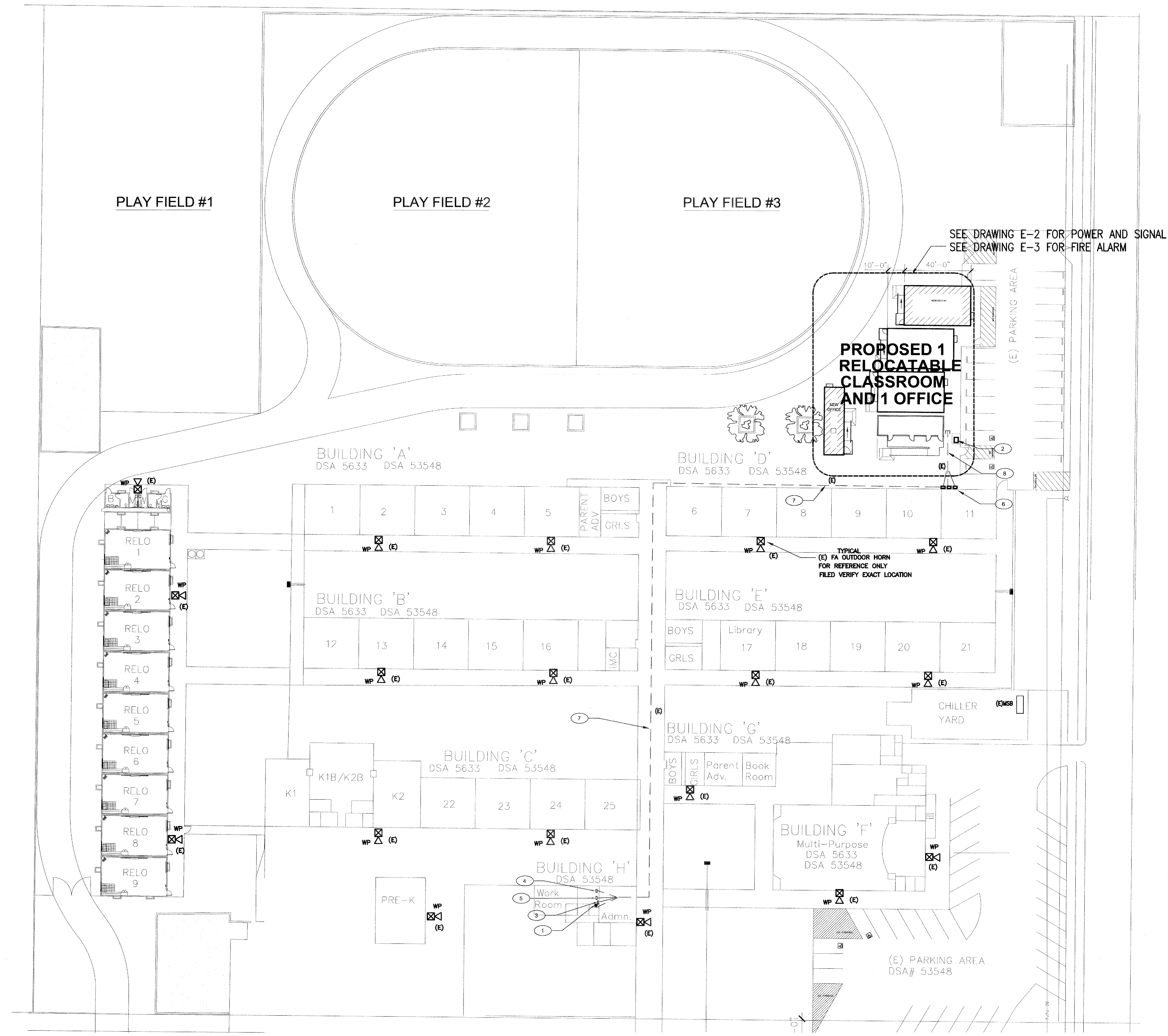
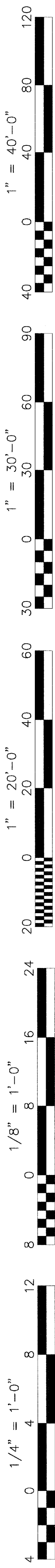

SHEET NOTES

1. APPROXIMATE LOCATION FOR EXISTING ADDRESSABLE FIRE ALARM CONTROL PANEL AND DIGITAL VOICE COMMAND CENTER TO REMAIN IN SERVICE. PROVIDE CONNECTION TO NEW FIRE ALARM DEVICES PER PLANS. UPDATE NEW FIRE ZONE MAP AND PROGRAM NEW DEVICES INFORMATION. MEASURE ACTUAL LOAD CURRENT AND VOLTAGE DROP FOR EACH NAC SIGNAL CIRCUITS, AND FACT STANDBY CURRENT AND ALARM CURRENT. SEND THE REPORT TO OWNER AND ENGINEER FOR REVIEW, AND PLASTIC LAMINATED ONE COPY INSIDE FACP CABINET DOOR.
2. APPROXIMATE LOCATION FOR EXISTING POWER DISTRIBUTION PANEL, PROVIDE NEW FEEDERS AND POWER CONNECTION FOR NEW RELOCATABLE CLASSROOM BUILDINGS PER PLANS. SEE SINGLE LINE DIAGRAM.
3. APPROXIMATE LOCATION FOR EXISTING PA/C/TELEPHONE EQUIPMENT IN ADMIN OFFICE. PROVIDE NEW CABLE AND CONNECTION FOR NEW SIGNAL DEVICES PER PLANS.
4. APPROXIMATE LOCATION FOR EXISTING COMPUTER NETWORK SERVER EQUIPMENT IN ADMIN OFFICE. PROVIDE NEW CABLE AND CONNECTION FOR NEW SIGNAL DEVICES PER PLANS.
5. APPROXIMATE LOCATION FOR EXISTING MASTER INTRUSION ALARM EQUIPMENT IN ADMIN OFFICE. PROVIDE NEW CABLE AND CONNECTION FOR NEW SIGNAL DEVICES PER PLANS.
6. (E) SIGNAL TO ON EXTERIOR WALL. SEE RISER DIAGRAMS.
7. (E) EMT SURFACE MOUNT SIGNAL CONDUITS, PULL IN NEW SIGNAL CONDUCTORS PER PLANS. SEE RISER DIAGRAMS.
8. (E) U.G. SIGNAL CONDUITS, FIELD VERIFY EXACT LOCATION. PULL BACK NEW SIGNAL CONDUCTORS PER PLANS. SEE DRAWING E-2 & E-3 FOR MORE INFORMATION.

GENERAL NOTES

1. ELECTRICAL CONTRACTOR SHALL APPRAISE HIMSELF OF ALL EXISTING CONDITIONS AT SITE WHICH INCLUDING OVERHEAD AND UNDERGROUND UTILITY SERVICE SUCH AS POWER, TELEPHONE, CABLE, GAS, WATER AND SEWER. PROVIDE MINIMUM WORKING CLEARANCE PER UTILITY COMPANY REQUIREMENT BEFORE STARTING WORK.
2. ELECTRICAL CONTRACTOR SHALL ARRANGE A MEETING WITH LOW VOLTAGE CONTRACTORS (PLUMBING, SECURITY, TELEPHONE, COMPUTER AND CTV), REVIEW THEIR EQUIPMENT AND DRAWINGS, INCLUDING ALL ELECTRICAL REQUIREMENT IN HIS SCOPE OF WORK PRIOR TO BID.
3. THE LAYOUT FOR THE POWER, TELEPHONE AND COMMUNICATION UNDERGROUND SERVICE IN THIS DRAWING IS ONLY FOR PLAN CHECK PURPOSE, AND HAS NOT BEEN APPROVED BY THE UTILITY COMPANIES. IT IS THE RESPONSIBILITY OF THE ELECTRICAL CONTRACTOR TO CONTACT THE UTILITY COMPANIES FOR BULK IN AND OTHER APPROVAL. CONSTRUCTION BEGINS PRIOR TO INSTALLATION.
4. ELECTRICAL CONTRACTOR TO HOOK UP ALL MOTOR CONTROL SYSTEM AS PER MECHANICAL & PLUMBING PLANS.
5. CIRCUIT BREAKERS USED TO SWITCH FLUORESCENT FIXTURES TO BE APPROVED FOR SWITCHING DUTY AND SHD TYPE.
6. PROVIDE MINIMUM 30" WORK CLEARANCE IN FRONT AND 30" WIDE WORK SPACE FOR SERVICE / PANEL / EQUIPMENT.
7. ALL EQUIPMENT TO HAVE TESTING LABORATORY LABEL ATTACHED. (UL, CSA, ...)
8. PROVIDE WEATHERPROOF (WP) GROUND FAULT INTERRUPTER (GFI) RECEPTACLE WITHIN 25 FEET OF ALL VACUUM BREAKERS OR ROOF.
9. GROUND ALL ELECTRICAL EQUIPMENT AS PER TITLE 24 AND CALIFORNIA ELECTRICAL CODE (CEC), SECTION 250-50.
10. FLUORESCENT BALLASTS SHALL MEET THE COMPATIBILITY REQUIREMENTS OF ARTICLE 2-5314 (A) OF CALIFORNIA ENERGY STANDARDS, TITLE 24.
11. SURFACE MOUNTED FIXTURES SHALL BE SECURED TO BLDG. STRUCTURE, NO TONGUE BOLTS SHALL BE ALLOWED.
12. PENETRATIONS OF FIRE RATED WALLS, CEILING OR FLOOR SHALL COMPLY WITH UBC REQUIREMENTS.
13. NO BACK TO BACK RECEPTACLES SHALL BE INSTALLED IN PREMISES. MAINTAIN HORIZONTAL SEPARATION OF 6" BETWEEN RECEPTACLES.
14. EXACT LOCATION OF ALL EQUIP. SERIAL DATA OUTLET, PHONE JACK AND RECEPTACLE ETC. TO BE VERIFY WITH OWNER IN FIELD.
15. ALL WIRING SHALL BE INSTALLED IN CONDUIT RACEWAY. PVC SOUL. 40 CONDUIT BELOW GRADE. EMT CONDUIT CONCEAL IN WALL AND ABOVE CEILING, RIGID STEEL CONDUIT ON EXTERIOR WALL OR ROOF.
16. THE LOCATION AND ROUTE OF CONDUITS AND RACEWAYS IN ALL ELECTRICAL DRAWINGS IN THESE SET OF DOCUMENT ARE SHOWN. ALL CONDUIT RACEWAYS SHALL BE INSTALLED PARALLEL OR PERPENDICULAR TO THE BUILDING STRUCTURE WITH THE MINIMUM LENGTH AS POSSIBLE.
17. ELECTRICAL CONTROLS AND SWITCHES INTENDED TO BE USED BY THE OCCUPANT OF THE ROOM OR AREA TO BE LOCATED NO MORE THAN 48" MEASURED FROM THE TOP OF THE OUTLET BOX AND NO LESS THAN 18" MEASURED FROM THE BOTTOM OF THE OUTLET BOX TO THE LEVEL OF THE FINISH FLOOR OR WORKING PLATFORM.
18. ELECTRICAL OUTLETS ON BRANCH CIRCUITS OF 30 AMPERES OR LESS AND COMMUNICATION SYSTEM RECEPTACLES TO BE LOCATED NO MORE THAN 48" MEASURED FROM THE TOP OF THE RECEPTACLE OUTLET BOX OR RECEPTACLE HOUSING AND NO LESS THAN 18" MEASURED FROM THE BOTTOM OF THE BOTTOM OF THE RECEPTACLE OUTLET BOX OR RECEPTACLE HOUSING TO THE LEVEL OF THE FINISH FLOOR OR WORKING PLATFORM. CEC 110-306.1

LEGEND

- DISTRIBUTION PANEL
- TERMINAL CABINET
- JUNCTION BOX
- DUPLEX OUTLET ON CIRCUIT NO. 3
- GFI
- WEATHERPROOF
- WALL SWITCH +48" AFF
- CONDUIT RUN UNDER FLOOR
- CONDUIT RUN IN CEILING AND IN WALL
- MOTOR DISCONNECT FUSED SWITCH
- CONDUIT RACEWAY
- EXISTING TO REMAIN
- REMOVE (E) ELECTRICAL DEVICE AND ASSOCIATE WIRING
- INDICATE EXISTING FIRE ALARM OUTDOOR HORN FOR REFERENCE ONLY, FIELD VERIFY AS REQUIRED.

CODE RULES AND REGULATIONS

ALL WORK AND MATERIAL SHALL BE IN FULL ACCORDANCE WITH THE LATEST RULES AND REGULATIONS OF THE STATE FIRE MARSHAL, THE CALIFORNIA ELECTRICAL CODE, THE SAFETY ORDERS OF THE DIVISION OF INDUSTRIAL SAFETY AND OTHER APPLICABLE STATE LAWS OR REGULATIONS. NOTHING IN THESE PLANS OR SPECIFICATIONS IS TO BE CONSTRUED TO PERMIT WORK NOT CONFORMING TO THESE CODES OR OTHERS APPLICABLE TO THIS SUBJECT. CEC 2013, CMC 2013, CPC 2013, CEC 2013, NFPA, STATE OF CALIFORNIA ENERGY CONSERVATION REGULATION, TITLE 24, 2013

U.S.A. - UNDERGROUND SERVICE ALERT
CALL BEFORE YOU DIG: 1-800-642-2444

THE LOCATION OF EXISTING UNDERGROUND UTILITIES WERE TAKEN FROM SOURCES BELIEVED TO BE RELIABLE. HOWEVER, THEY HAVE NOT BEEN INDEPENDENTLY VERIFIED BY THE OWNER OR THIS ENGINEER. THE CONTRACTORS SHALL DETERMINE THE EXACT LOCATION OF ALL EXISTING UTILITIES BEFORE COMMENCING WORK, AND AGREES TO BE FULLY RESPONSIBLE FOR ANY AND ALL DAMAGES WHICH MIGHT BE OCCASIONED BY THE CONTRACTOR'S FAILURE TO EXACTLY LOCATE AND PRESERVE ANY AND ALL UNDERGROUND UTILITIES.

NOTIFY OWNER 72 HOURS PRIOR TO ANY EXCAVATION

CONSULTING ENGINEERS
John Chong Engineering
JOHN S. CHONG
E 14419
Exp. 6/30/2016
1071 E. DECATUR AVE., FRESNO CA 93710
(559) 325-9988 • FAX 257-3401
jchong@ceee@aol.com

Ownership of Documents
This document, the ideas and designs incorporated herein, as an instrument of Professional Service is the property of Integrated Designs by SOMAM Inc. and is not to be used, in whole or in part for any other project without written authorization.
© COPYRIGHT 2013

integrated designs by SOMAM, Inc
ARCHITECTURE - ENGINEERING - INTERIOR DESIGN - CONSTRUCTION MANAGEMENT
6011 N. Fresno, Suite 130 - Fresno, California 93710
Phone: (559) 439-0881 Fax: (559) 439-0887 E-Mail: design@integrateddesigns.com
www.integrateddesigns.com

Rev. Date	Rev. Description

SITE PLAN - ELECTRICAL

WAYSIDE ELEMENTARY SCHOOL
1 RELOCATABLE CLASSROOM
BAKERSFIELD CITY SCHOOL DISTRICT
1000 MING AVE., BAKERSFIELD, CA

Project Name & Address:
Sheet Title:
Issue Date: 00/00/14
Date: 05/27/14
Designer: J. CHONG
Checker: J. CHONG
P.C.: C.M.

Agency Approval Stamp:

IDENTIFICATION STAMP
DIV. OF THE STATE ARCHITECT
APP03 116975
AC FLS SS
DATE: MAY 24 2016

Stamp(s):

Job No.: **5170**

Sheet No.: **E-1**

Release: