

**SYMBOL LEGEND**

- DISCONNECT-GENERAL SWITCH R610-B,60 AMP. NOT REQUIRED ON A/C UNITS WITH INTERNAL DISCONNECT BREAKER
- ⊠ PULL STATION @ +48" A.F.F.
- ⊠ EXT. HORN @ +7'-0" A.F.F.
- ⊕ 110V RECEPTACLE 20 AMP HOSP. GRADE @ +15" A.F.F.
- ⊕ SWITCH @ +42" A.F.F.
- ⊕ THERMOSTAT @ +48" A.F.F.
- ⊕ CLOCK @ +8'-0"
- ⊕ EXTERIOR LIGHT- SEE FIXTURE SCHEDULE

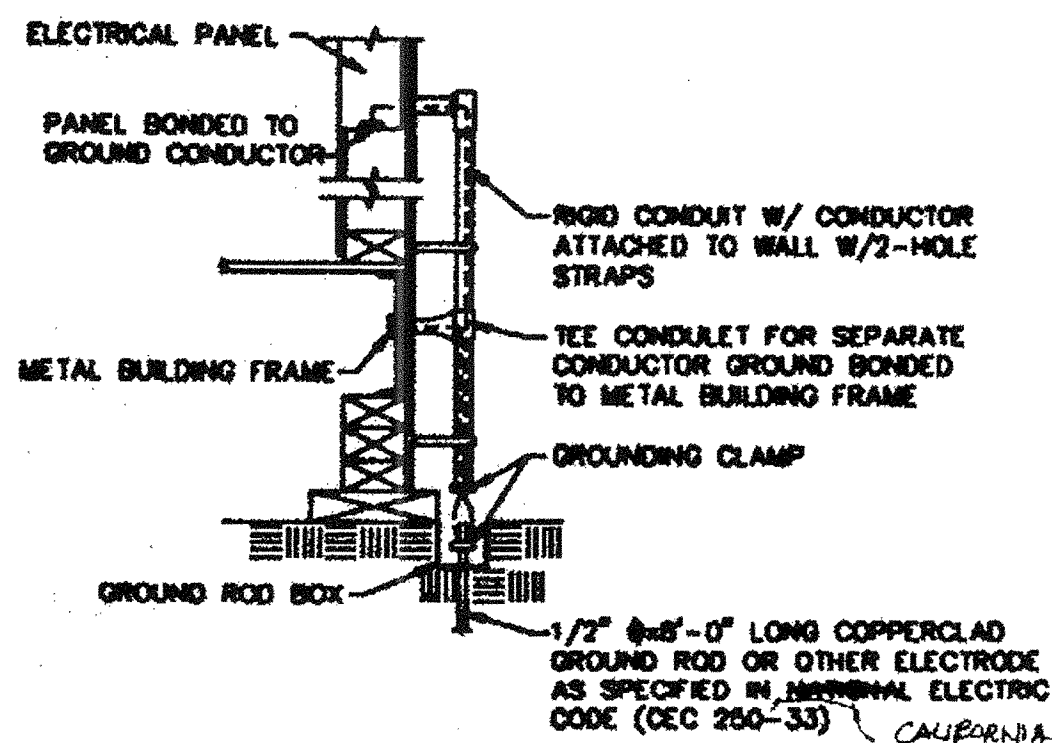

- NOTES:**
- SIZE OF CONDUCTORS SHALL COMPLY W/CEC TABLE 250-85.
  - BOND SEPARATE CONDUCTORS FROM GROUND ROD TO ELECTRICAL PANEL @ TO METAL BUILDING FRAME (CEC 250-81) IN ADDITION TO THE DETAIL SHOWN ABOVE. BOND THE ELECTRICAL GROUND TO METAL WATER PIPE EMBEDDED AT LEAST 10 FT. INTO THE SOIL IF AVAILABLE (CEC 250-81 & 250-83).
  - ALL MODULES OF METAL FRAME BUILDINGS SHALL BE ELECTRICALLY BONDED TOGETHER (BOLTING ONLY IS NOT ACCEPTABLE BONDING), INCLUDING RAMP TO STEEL FRAME.
  - CHECK RESISTANCE TO GROUND. IF RESISTANCE EXCEEDS 25 OHMS, INSTALL ADDITIONAL GROUND RODS W/CONDUCTORS AS SHOWN, SEPARATED AT LEAST 6'-0" UNTIL RESISTANCE IS REDUCED TO 25 OHMS OR LESS (CEC 250-84).
  - PROJECT INSPECTOR SHALL WITNESS GROUNDING TEST.

**ACCEPTABLE GROUNDING DETAIL**  
BY OWNER

PANELBOARD SCHEDULE W/ OPTIONAL WATER HEATER PANEL A(1)												PANELBOARD SCHEDULE. PANEL A											
VOLTS 120/240						PHASE 1						BUSS 100 A						FEED BOTTOM					
MAIN BRKR 100 A						WIRE 3						MOUNT FLUSH						LOCATION INTERIOR					
DESCRIPTION	WATTS	A#	B#	WIRE SIZE	BREAKER	POLE	PKT. NO.	A	O	B	PKT. NO.	WATTS	A#	B#	WIRE SIZE	BREAKER	POLE	PKT. NO.	A	O	B	PKT. NO.	
HVAC 3.5 TON	4392			8	50	2	1	2	1	20	12	960											
HVAC 3.5 TON				8			3	4	1	20	12	1060											
OPTIONAL WATER HEATER	1400			12	20	1	5	6	1	20	12	720											
							7	8															
							9	10															
							11	12															
<b>SUB TOTAL</b>																							
LOAD KW	L.C.L. = L.C.L. x 1.25 = 16155					TOTAL LOAD					LOAD KW	L.C.L. = L.C.L. x 1.25 = 13505					TOTAL LOAD						
A 8072	OTHER = 720					CONN. 74.00 AMPS					A 8072	OTHER = 720					CONN. 50.10 AMPS						
B 8852	MAX DEMAND = 16875					MAX DEMAND 92.50 AMPS					B 8452	MAX DEMAND = 14225					MAX DEMAND 61.85 AMPS						
TOT 12924											TOT 11524												

PROVIDE VISUAL DEVICE AT RESTROOMS AT 80" FROM F. FLOOR

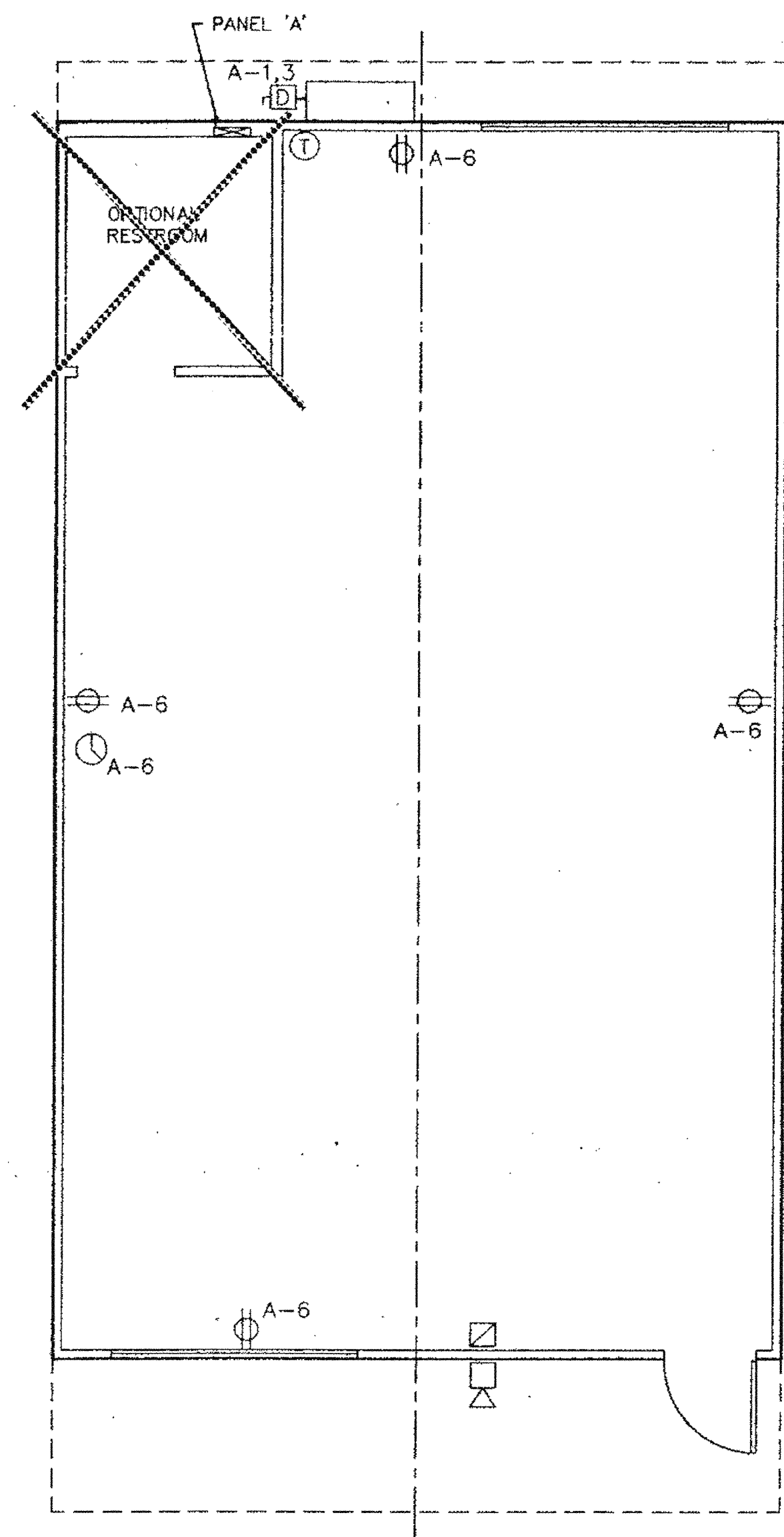

**ELECTRICAL POWER PLAN**

LIGHTING LEVEL = 1 FOOTCANDLE MIN. AT FLOOR PER SECTION 1012 OF C.B.C.

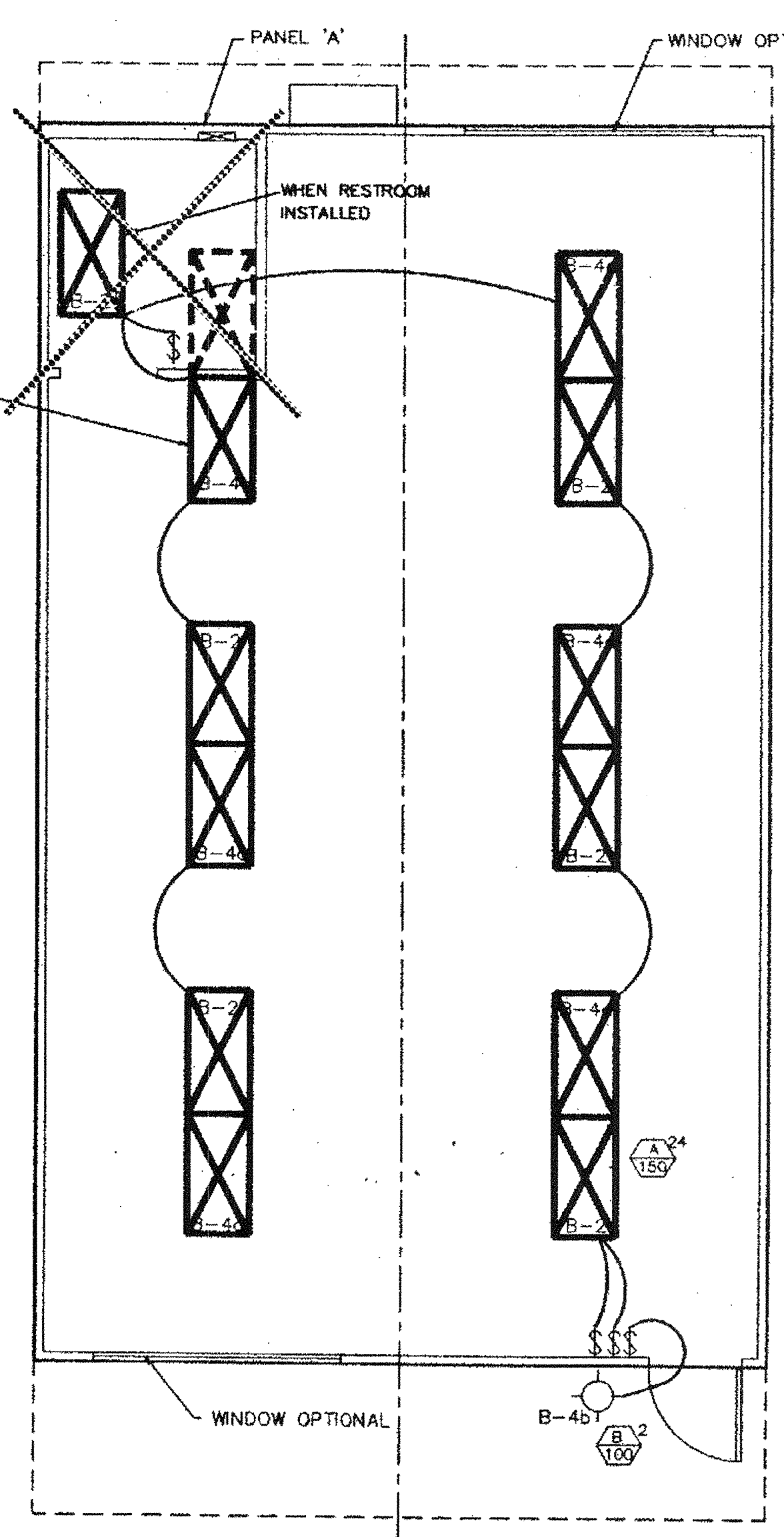

**ELECTRICAL LIGHTING PLAN**

- NOTES:**
- FIRE ALARM SYSTEM SHALL COMPLY W/ TITLE 24 SEC. 305.6, TITLE 24, PART 3, ARTICLE 790 OF THE CALIFORNIA CODE OF REGULATIONS AND CALIFORNIA FIRE REGULATIONS, ARTICLE 10.
  - INSTALLATION OF FIRE ALARM SYSTEM SHALL NOT BE STARTED UNTIL DETAIL PLANS, SPECIFICATIONS AND ENGINEERING CALCULATIONS HAVE BEEN ACCEPTED AND SIGNED BY THE ARCHITECT OR STRUCTURAL ENGINEER IN GENERAL CHARGE OF DESIGN AND THE SIGNATURE OF THE ARCHITECT OR PROFESSIONAL ENGINEER WHO HAS BEEN DELEGATED RESPONSIBILITY COVERING THE WORK SHOWN ON A PARTICULAR PLAN OR SPECIFICATION, AND APPROVED BY THE OFFICE OF THE STATE ARCHITECT AND STATE FIRE MARSHAL.

FIXTURE SCHEDULE					
NO. OF FIXTURES DESIGNATION	TYPE	SYMBOL	DESCRIPTION	WATTS	MANUFACTURER
150	⊠	⊠	2' x 4' FLUORESCENT DROP-IN LIGHT FIXTURE, ACRYLIC PRISMATIC LENS, ENERGY SAVING BALLAST, (4) 35 WATT TUBES. WEIGHT - 27 lbs	150 WATTS	
100	⊕	⊕	INCANDESCENT SURFACE MOUNTED EXTERIOR LIGHT FIXTURE WITH IMPACT RESISTANT ENCLOSURE.	100 WATTS	

THIS DRAWING AND THE MATERIAL CONTAINED HEREIN ARE THE PROPERTY OF M.S.I. INC. AND SHALL NOT BE REPRODUCED, COPIED OR OTHERWISE DISPOSED OF DIRECTLY OR INDIRECTLY AND SHALL NOT BE USED FOR THE PURPOSE OF FURNISHING ANY INFORMATION OR PARTS THEREOF WITHOUT THE FULL KNOWLEDGE AND WRITTEN CONSENT OF M.S.I. INC. MATERIAL CONTAINED HEREIN AND ORIGINATING WITH M.S.I. INC. SHALL BE THE PROPERTY OF M.S.I. INC. MATERIAL CONTAINED HEREIN AND ORIGINATING WITH M.S.I. INC. SHALL BE THE PROPERTY OF M.S.I. INC.

**ARCHITECT APPROVAL**

**STRUCTURAL ENGINEERS STAMP**

**STATE AGENCY APPROVAL**

**PROJECT**  
24'X40' MODULAR CLASSROOM BUILDING

**JOB #**  
96-1310

**DATE**  
11/21/96

**DRAWN BY**  
SCALE

**APPROVED**

**REVISIONS**

- Δ 2/4/97
- Δ 3/17/97 DSA REV.
- Δ 3/24/97 MSI REV.
- Δ 3/31/97 MSI REV.
- Δ 4/25/97 MSI REV.

**PLOT DATE:** 04/28/97

**SHEET NO.**  
E-1-24

**MSI**

**MODULAR STRUCTURES INTERNATIONAL, INC.**

630 ORTUS AVE. WOODBRIDGE, CALIFORNIA 92097

PHONE (909) 798-3035 FAX (909) 798-1883

**REGENCY ENGINEERING & CONSULTING GROUP**

17165 VON KARMAN, SUITE # 108  
IRVINE, CALIFORNIA, 92614  
TELEPHONE: (714) 263-3799  
FAX: (714) 263-3795

A SUBSIDIARY OF REGENCY COMPANY, INC.

**STATE AGENCY APPROVAL**

**PROJECT**  
24'X40' MODULAR CLASSROOM BUILDING

**JOB #**  
96-1310

**DATE**  
11/21/96

**DRAWN BY**  
SCALE

**APPROVED**

**REVISIONS**

- Δ 2/4/97
- Δ 3/17/97 DSA REV.
- Δ 3/24/97 MSI REV.
- Δ 3/31/97 MSI REV.
- Δ 4/25/97 MSI REV.

**PLOT DATE:** 04/28/97

**SHEET NO.**  
E-1-24

**STATE AGENCY APPROVAL**

**PROJECT**  
24'X40' MODULAR CLASSROOM BUILDING

**JOB #**  
96-1310

**DATE**  
11/21/96

**DRAWN BY**  
SCALE

**APPROVED**

**REVISIONS**

- Δ 2/4/97
- Δ 3/17/97 DSA REV.
- Δ 3/24/97 MSI REV.
- Δ 3/31/97 MSI REV.
- Δ 4/25/97 MSI REV.

**PLOT DATE:** 04/28/97

**SHEET NO.**  
E-1-24