

KEY NOTES

- 1 WC-1 WATER CLOSET (WALL MOUNTED):
15 GAL. CRANE
PLACIDUS 3-446E VITREOUS CHINA
MOUNTED AT HANDICAPPED HEIGHT
USE:
#10 CG OLSONITE SEAT @ 41" TO 19" MAX
#11 SLOAN FLUSH VALVE
ZURN Z-1023 - NL4 ADJUSTABLE
HORIZONTAL SIPHON JET (NO HUB)
- 2 WC-2 WATER CLOSET: SAME AS ABOVE
MOUNTED AT STANDARD HEIGHT.
- 3 URINAL (ACCESSIBLE) CRANE T-109 MAN-
HATTAN LOW CONSUMPTION (1.0 GAL. PER
FLUSH, WALL HUNG, SIPHON JET ACTION W/
INTEGRAL TRAP VITREOUS CHINA MOUNT
@ 41" A.F.F. TO LIP)
USE:
SLOAN - REGAL FLUSHOMETER #106
FLUSH VALVE.
- 4 URINAL (STANDARD) CRANE T-121 BEDFORD
WATER ECONOMY. (VITREOUS CHINA, WASH-
OUT, WITH INTEGRAL TRAP AND STRAINER
MOUNTED AT STANDARD HEIGHT
USE:
SLOAN - REGAL FLUSHOMETER #106
FLUSH VALVE.
- 5 LAVATORY - (ACCESSIBLE) CRANE HARNWICH
VITREOUS CHINA 1-412, MOUNT @ HANDICAP
HEIGHT
USE:
ZURN "Z" - DURA-COATED SYSTEM W/
CONCEALED ARMS (Z-1251 LAV WALL
SUPPORT) OR #100 SERIES
FAUCET - US BRASS NL 805 IPS LEVER
HANDLE
- 6 LAVATORY - (STANDARD) CRANE HARNWICH
VITREOUS CHINA, MOUNT @
STANDARD HEIGHT
USE:
ZURN "Z" - DURA-COATED SYSTEM W/
CONCEALED ARMS (Z-1251 LAV WALL
SUPPORT) OR #100 SERIES
FAUCET - US BRASS NL 805 IPS LEVER
HANDLE
- 7 GRAB BARS - MCKINNEY 9704-1-1/2" O.D.
STAINLESS STEEL GRAB BAR SATIN FINISH
36" LONG IN BACK AND 42" ON SIDE
- 8 TOILET PAPER HOLDER (NIC)
- 9 TOILET PARTITIONS TYPICAL - THE EMBASSY
- POWDER COATED METAL OVERHEAD
BRACED, BAKED ENAMEL FINISH, MANF.
BY GLOBAL STEEL PROD.
- 10 SOAP DISPENSER (NIC)
- 11 MIRROR - SERIES 530 RETURNED MIRRORS
STAINLESS STEEL - 10GA., 18"WIDE X
24" HIGH ("J" SHEET METAL - MANF.)
- 12 FLOOR COVERING (SEE FINISH SCHED. A4.0)
- 13 SEE A4.0 FOR SPECIFIC ADA
FITURE HEIGHTS ON THIS PROJECT

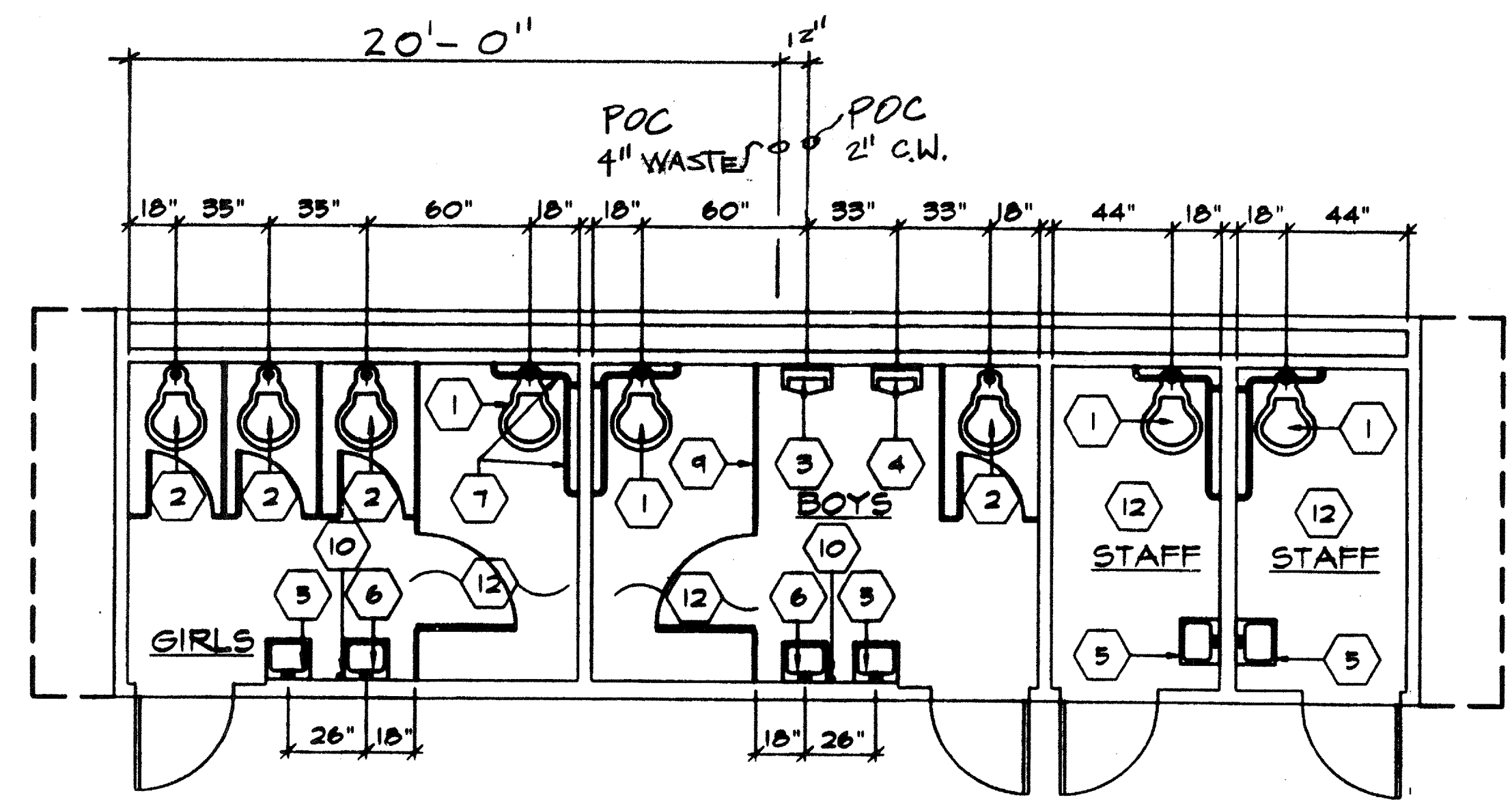
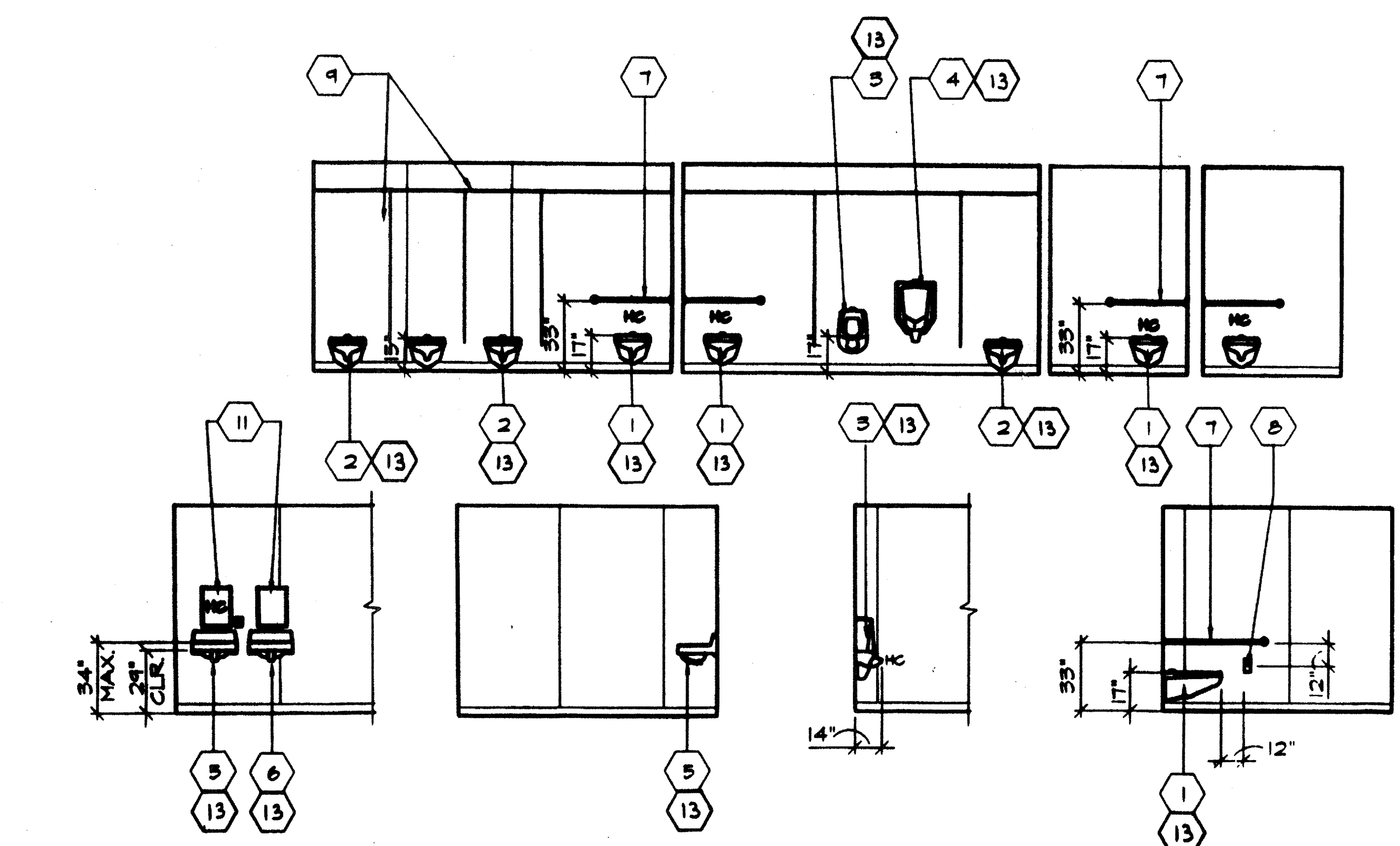

IDENTIFICATION STAMP
DIV. OF THE STATE ARCHITECT
OFFICE OF REGULATION SERVICES
04 100270
AC [Signature]
DATE APR 6 1998

IDENTIFICATION STAMP
DIV. OF THE STATE ARCHITECT
03 17035
AC [Signature]
DATE APR 12 1998

ARCHITECT	ELECTRICAL	STRUCTURAL	MECHANICAL	FIRE MARSHAL	ACCESS COMPLIANCE	STRUCTURAL SAFETY	JOB # A-134-96	© MODTECH INC. 1993	DRAWN BY AD
							JOB# 2724 #2918-C OPTION "C" ANAHEIM UHSD. (CLASS LEASING)	4012-081 CLLS.036	DATE CHECKED BY DATE
PLUMBING PLAN							PI.2W		