

**ELECTRICAL PANEL SCHEDULE**

MAIN: 100 AMP	12 POLE	PANEL: A	FEED: REAR											
		LOCATION: REAR/INTERIOR	MOUNTING: FLUSH											
LOAD	WATTS		BREAKER		A		B		BREAKER		WATTS		LOAD	
	A#	B#	Amps	P	UL	UL	P	Amps	A#	B#				
RECEPTACLE		720			20	1	1		2	2	60	7080	HVAC (3 1/2T)	
RECEPTACLE/CLOCK			900	20	1	3		4				7080	HVAC (3 1/2T)	
						5		6						
						7		8						
INT/EXT LIGHTS		900		20	1	9		10						
INT. LIGHTS											40		FIRE ALARM (DEDICATED)	
WATTS/PHASE	A =	8740	1620	1740							7120	7080	B = 8820	
TOTAL		17560	WATTS	73	AMPS	120/240	VOLTS						SINGLE #	THREE WIRE

**GENERAL GROUNDING NOTES**

- EACH BUILDING SHALL BE SEPARATELY GROUNDING WITH A 3/4" RD. X 8' COPPERCLAD STEEL GROUND ROD, WHERE ROCK BOTTOM IS ENCOUNTERED, ROD SHALL BE DRIVEN AT AN ANGLE NOT TO EXCEED 45 DEGREE'S FROM THE VERTICAL OR SHALL BE BURIED IN A TRENCH THAT IS AT LEAST 30" DEEP (BY SITE ELECTRICAL)
- TESTING: TEST FOR RESISTANCE TO GROUND, IF RESISTANCE EXCEEDS 25 OHMS, INSTALL ADDITIONAL GROUND RODS SEPARATED AT LEAST 6'-0" UNTIL RESISTANCE IS REDUCED TO 25 OHMS OR LESS. (BY SITE ELECTRICAL)
- APPROVAL OF THIS PLAN DOES NOT CONSTITUTE APPROVAL OF THIS FIRE ALARM FOR ALL SITES, THE FIRE ALARM SYSTEM AND/OR COMPONENTS MAYBE REQUIRED TO BE CHANGED DUE TO SITE LOCATION, EXISTING CONDITIONS OR INCOMPATIBLE COMPONENTS.
- GROUNDING TEST SHALL BE DONE IN THE PRESENCE OF THE PROJECT INSPECTOR. ALL GROUNDING SHALL BE IN ACCORDANCE WITH CEC ARTICLE 250.

**ELECTRICAL LEGEND**

- 2'x4' 4 TUBE FLUORESCENT LIGHT FIXTURE WITH T-8 ELECTRONIC BALLAST
- EXTERIOR LIGHT FIXTURE AT +93" AFF
- SWITCH AT +48" AFF
- 3WAY SWITCH AT +48" AFF UON
- DUPEX WALL RECEPTACLE 15A 125V 3-WIRE AT +18" AFF UON
- HVAC UNIT (HV)
- 4SD J-BOX FOR FIRE ALARM PULL STATION AT +48" AFF. 3/4" CO TO PULLSTRING
- 4SD J-BOX FOR FIRE ALARM STROBE/HORN AT +80" TO BOTTOM OF DEVICE AFF. 3/4" CO TO PULLSTRING.
- 4SD J-BOX FOR FIRE ALARM HORN AT +96" AFF 3/4" CO TO PULLSTRING
- WEATHER PROOF GUTTER BOX (6"x6"x4") AT +18" AFF RECEIVE 3/4" CO FROM FA DEVICE, PULLSTRING
- ELECTRICAL PANEL AT +60" AFF TO CENTERLINE 1 1/4" POWER NIPPLE POC, GND JUMPER BY SITE ELECT.
- CLOCK AT +90" AFF
- LIGHED EXIT SIGN WITH BATTERY BACK UP (SEE NOTE 3 BELOW FOR CODE)
- 4SD J-BOX FOR HEAT DETECTOR (ATTIC) MAX 35' FROM ANY POINT IN ATTIC BAY AND 50' BETWEEN THEM. \* (TO BE SITE SPECIFIC)
- 4SD J-BOX FOR SMOKE DETECTOR (CEILING) MAX 21' FROM ANY POINT IN ROOM AND 30' BETWEEN THEM. \* (TO BE SITE SPECIFIC)

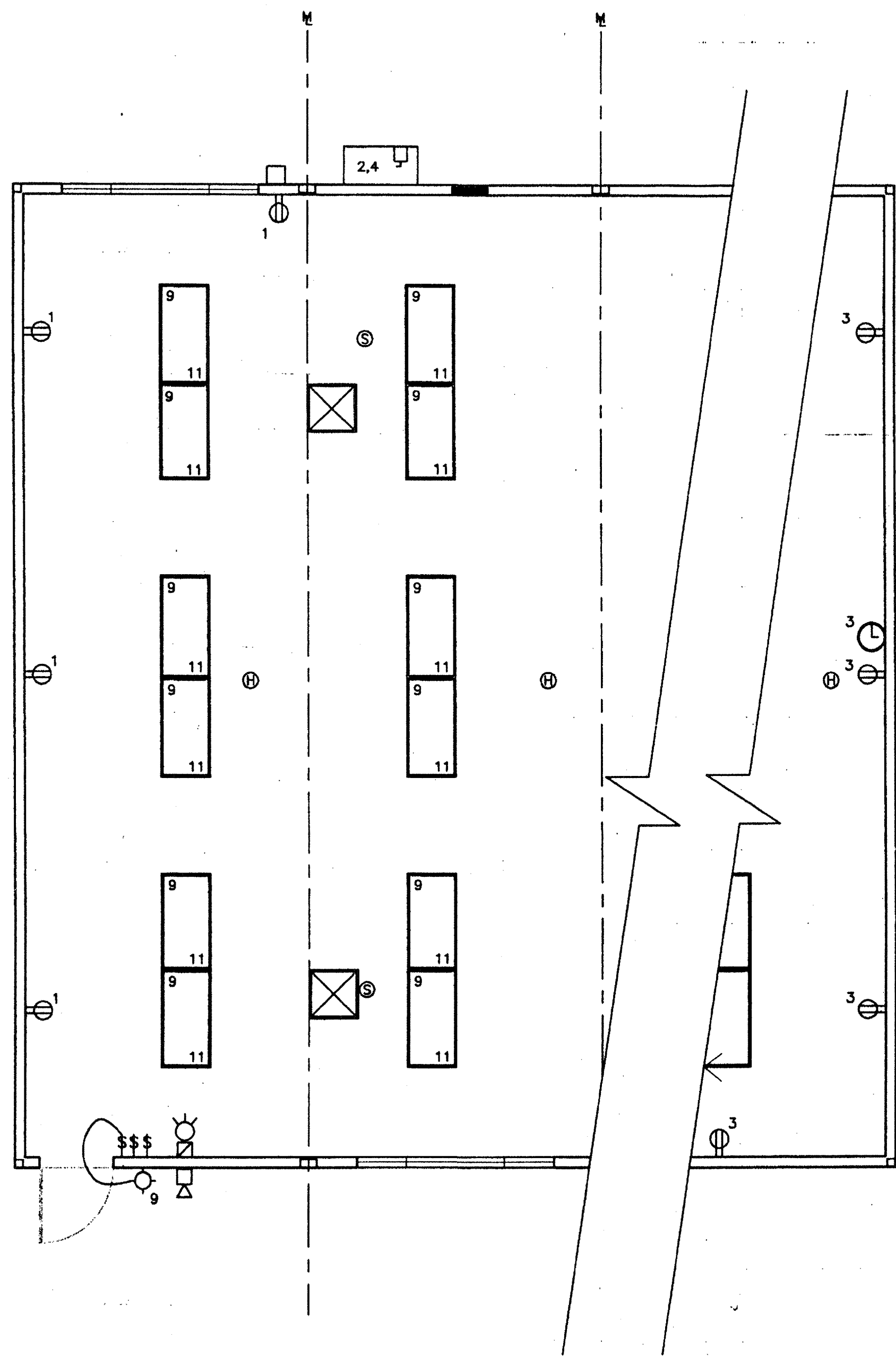

**ELECTRICAL PLAN**

(12-LIGHTS)

SCALE: 1/4" = 1'-0"

DATE SIGNED  
APR 18 2003

PC

CBC 2001

IDENTIFICATION STAMP  
DIV. OF THE STATE ARCHITECT  
OFFICE OF REGULATION SERVICES  
04 105299  
AC [Signature]  
DATE 4/18/03

**TYP GROUNDING DETAIL**

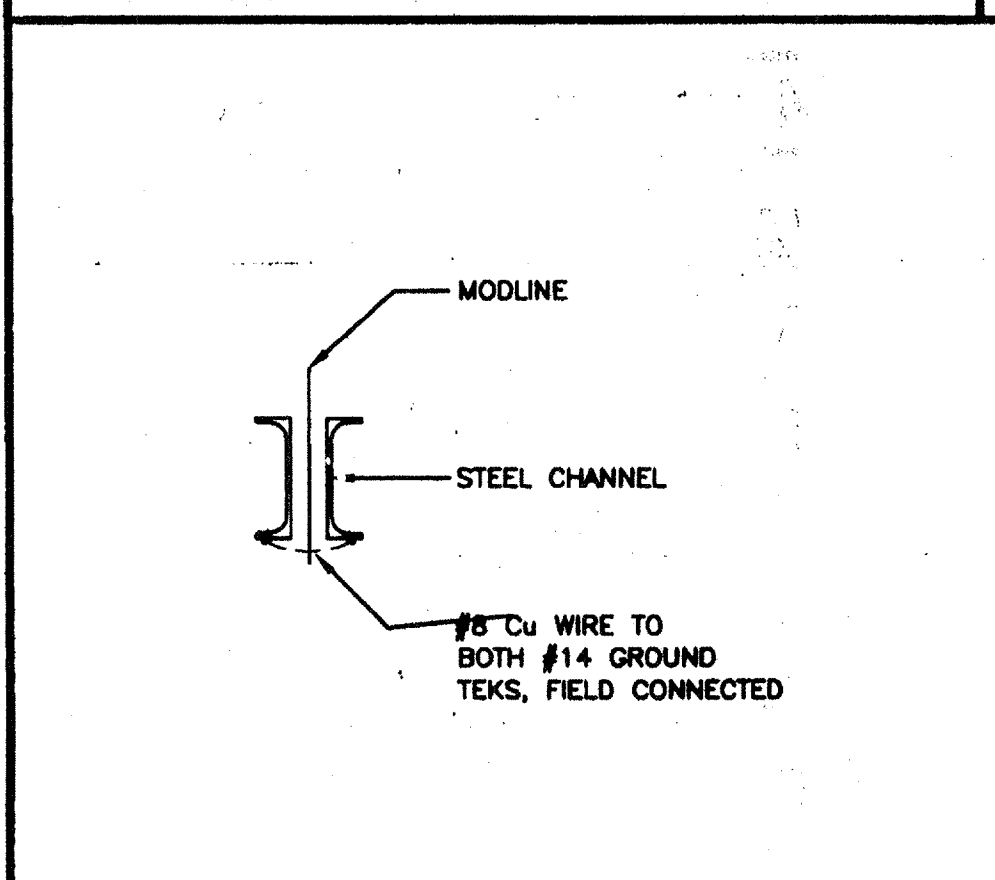

**GROUND JUMPER AT MOD LINE**

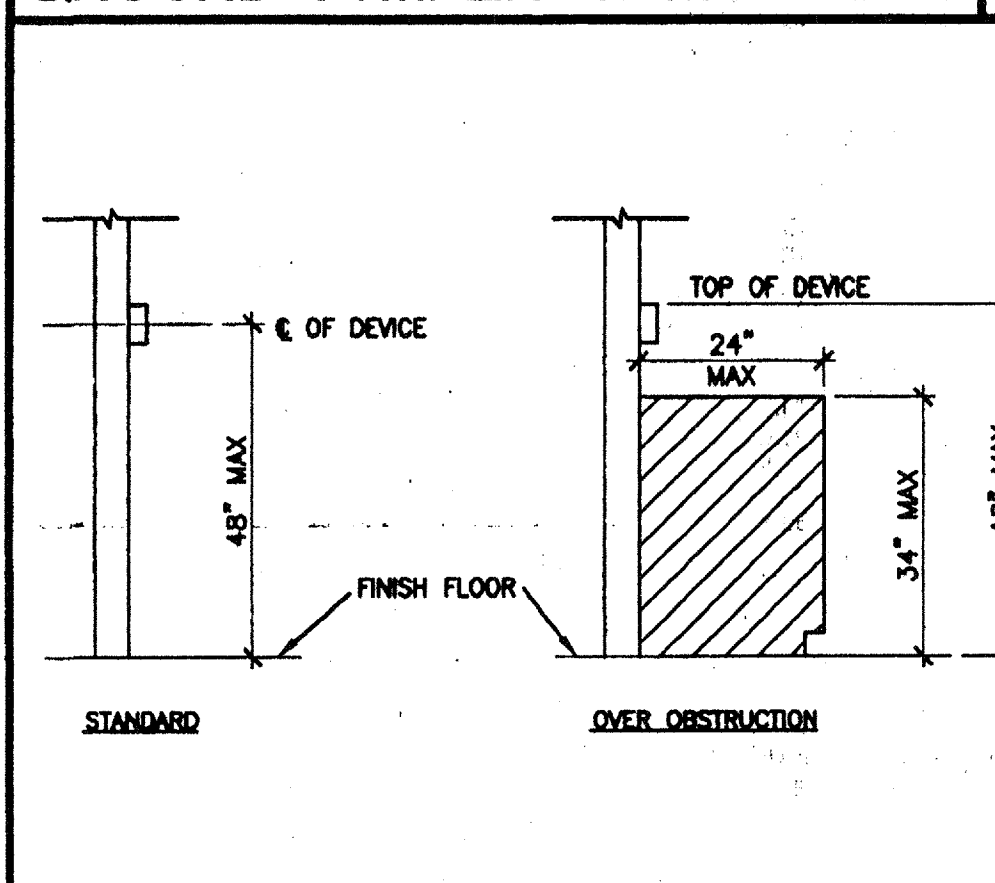

**DEVICE MOUNTING**

**NOTES**

- NOTE FOR THE DESIGN PROFESSIONAL:**  
THE FOLLOWING INSTRUCTIONS ARE MEANT TO BE FOLLOWED. THE DESIGN PROFESSIONAL SHALL PROVIDE ANCHORAGE CALCULATIONS AND DETAILS WITH THE SUBMITTAL PACKAGE, USING THE FOLLOWING DESIGN CRITERIA AND SHOULD BE READY TO POINT OUT DURING THE BACKCHECK PROCESS TO THE PLAN REVIEWER ANY EQUIPMENT FOR WHICH ANCHORAGE DETAILS ARE NOT PROVIDED.
- SCHOOL EQUIPMENT ANCHORAGE**  
**INSTRUCTIONS**  
ALL EQUIPMENT/COMPONENTS DIRECTLY SUPPORTED ON THE GROUND OR ROOF WITH Wp EXCEEDING 400 Lbs., EQUIPMENT WEIGHING MORE THAN 20 Lbs., SUSPENDED FROM A ROOF, FLOOR OR HUNG FROM A WALL SHALL HAVE ITS CORRESPONDING STRUCTURAL CALCULATIONS AND ANCHORAGE DETAIL(S) SHOWN ON THE PLANS, PRIOR TO SUBMITTAL FOR PLAN REVIEW AND BACKCHECK. ALL EQUIPMENT (REGARDLESS OF WEIGHT) SHALL HAVE THEIR CONNECTION TO THE STRUCTURE SHOWN IN THE PLANS.  
**DESIGN CRITERIA**  
a) THE SEISMIC ANCHORAGE FOR ALL MECHANICAL AND ELECTRICAL EQUIPMENT SHALL BE DESIGNED TO WITHSTAND A LATERAL FORCE:  
1- CALCULATED AS SPECIFIED IN SECTION 1632A AND TABLE 16A-0 OF THE VOL. 2, TITLE 24, 2001 CBC.  
2- IN LIEU OF CALCULATIONS PER 1- THE ANCHORAGE SHALL BE CAPABLE OF WITHSTANDING A LATERAL FORCE EQUAL TO 2.2 Wp ACTING SIMULTANEOUSLY WITH A VERTICAL FORCE EQUAL TO 0.72 Wp (BOTH FORCES AT SERVICE LEVEL, THESE VALUES CORRESPOND TO AN Ip=1.15 AND Co=0.66, FOR OTHER VALUES OF Ip AND Co, THE LATERAL AND VERTICAL FORCE CAN BE ADJUSTED ACCORDINGLY)  
\*INCLUSION OF VERTICAL FORCE PER TABLE 16-0 FOOTNOTE 20 (FOR EMERGENCY POWER SUPPLIES AND COMMUNICATIONS EQUIPMENT ONLY)  
b) THE CAPACITY OF THE ANCHORAGE CONNECTORS IN SHEAR AND/OR TENSION SHALL BE CLEARLY INDICATED IN THE CALCULATIONS, WHICH INDICATE, ICBO REPORT No. (IF APPLICABLE) THEIR TOTAL NUMBER, SIZE, GRADE, EMBEDMENT, EDGE DISTANCES, AND OTHER FACTORS WHICH AFFECT THE CAPACITY IN SHEAR TENSION.  
ANCHORAGE DETAILS FOR EQUIPMENT WHICH ARE NOT APPROVED DURING PLAN REVIEW ARE SUBJECT TO APPROVAL OF THE STRUCTURAL ENGINEER OF RECORD AND DSA'S DISTRICT STRUCTURAL ENGINEER PRIOR TO INSTALLATION AND INSPECTION BY THE PROJECT INSPECTOR.
  - SMOKE AND HEAT DETECTORS SHOWN ARE FOR OPTIONAL AUTOMATIC DETECTION. IF ELECTED AS AN OPTION, MODTECH WILL PROVIDE 4SD BOXES AND 3/4" CO. ON UNDERSIDE OF ROOF PURLINS. DEVICES PROVIDED AND INSTALLED BY OTHERS.
  - PROVIDE EXITS SIGNS AND EMERGENCY ILLUMINATION FIXTURES AS REQUIRED BY CBC 1003.2.8 AND CBC 1003.2.9. EXIT SIGNS SHALL BE READILY VISIBLE FROM ANY DIRECTION OF APPROACH. EXIT SIGNS SHALL BE LOCATED AS NECESSARY TO CLEARLY INDICATE THE DIRECTION OF EGRESS TRAVEL. NO POINT SHALL BE MORE THAN 100 FEET FROM THE NEAREST VISIBLE SIGN. EXCEPTION: WHERE AN OCCUPANT LOAD IS LESS THAN 50  
4012-125

**REVISIONS**

1		
2		
3		
4		
5		

Electrical Engineer's Seal  
Mechanical Engineer's Seal  
PC Professional of Record Seal  
Architect's Seal  
IDENTIFICATION STAMP  
DIV. OF THE STATE ARCHITECT  
OFFICE OF REGULATION SERVICES  
PC-04  
104801  
DATE 4/18/03

**MODTECH INC.**  
2830 BARRETT AVENUE  
PERRIS, CALIF. 92571  
PH (909) 943-4014  
FAX (909) 940-0427

PROJECT NUMBER: 4012-125  
© MODTECH, INC. 2002  
DRAWN BY: STK P-70  
DATE: 05-22-03  
CHECKED BY:  
DATE:  
MODTECH Index No.  
**E1.03**

**ELECTRICAL PLAN** (12 LIGHTS)

FILE PATH: 2440-E1.03.DWG PROJECT NO. PC-04-104801