



SAFE DISPERSAL	GENERAL NOTES	KEY NOTES
TEMP CLASSROOMS 4 (N) CLASSROOMS @ 960 S.F. (24'x40') EA. = 3,840 S.F. 3,840 S.F. / 20 S.F. PER OCCUPANT = 192 OCCUPANTS 192 OCCUPANTS x 5 S.F. / OCCUPANT = 960 S.F. REQ'D 960 S.F. PROVIDED = OK	A. DETERIORATION OR EXISTING NON-COMPLIANT CONSTRUCTION: IF ANY CONDITION IS DISCOVERED WHICH, IF LEFT UNCORRECTED, WOULD MAKE THE BUILDING NON-COMPLIANT WITH THE REQUIREMENTS OF THE EDITION OF THE CBC IN FORCE AT THE TIME OF ORIGINAL CONSTRUCTION, THE CONDITION MUST BE CORRECTED IN ACCORDANCE WITH CURRENT CODE REQUIREMENTS. A C.C.D. OR A SEPARATE SET OF PLANS AND SPECIFICATIONS DETAILING AND SPECIFYING THE REQUIRED REPAIR WORK SHALL BE SUBMITTED TO AND APPROVED BY DSA BEFORE PROCEEDING WITH THE REPAIR WORK. *PER DSA IR 16-1, SEC. 5.4 B. CONTRACTOR SHALL ADJUST ALL DOOR CLOSERS TO A MAXIMUM OPENING FORCE OF 5 LBF	1. NEW TEMPORARY PORTABLE BUILDING ON RAISED WOOD FOUNDATION WITH METAL RAMP SUPPLIED BY BUILDING MANUFACTURER 2. NEW TEMPORARY RESTROOM BUILDING ON RAISED WOOD FOUNDATION WITH METAL RAMP SUPPLIED BY BUILDING MANUFACTURER 3. EXISTING ASPHALT PAVEMENT 4. NEW TACTILE EXIT SIGN PER 2/A1.05 5. NEW ROOM IDENTIFICATION AND ISA SIGNAGE 3 & 4/A1.05 6. NEW PEDESTAL DRINKING FOUNTAIN, SEE 13 & 14/A1.05 7. NEW 6'-0" CHAIN LINK FENCE AND GATE 8. EXISTING CHAIN LINK FENCE TO REMAIN 9. EXISTING CHAIN LIKE GATE TO REMAIN 10. EXISTING ASPHALT PAVING TO REMAIN 11. EXISTING PATH OF TRAVEL 12. NEW PATH OF TRAVEL 13. <i>Landing @ Bottom of Ramp see 5/A1.05</i>

Ownership of Documents
 This document, the ideas and designs incorporated herein, as an instrument of Professional Service is the property of Integrated Designs by SOMAM, Inc. and is not to be used, in whole or in part for any other project without written authorization.
 © COPYRIGHT 2015

integrated designs by SOMAM, Inc.
 ARCHITECTURE · ENGINEERING · INTERIOR DESIGN · CONSTRUCTION MANAGEMENT
 6011 N. Fresno, Suite 130 - Fresno, California 93710
 Phone (559) 438-0887 Fax (559) 438-0887 E-Mail: design@somam.com
 www.integrateddesigns.com

Rev. Date	Rev. Description

BUCKNELL STREET

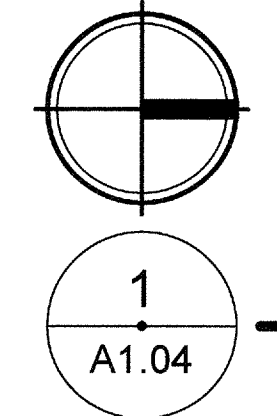
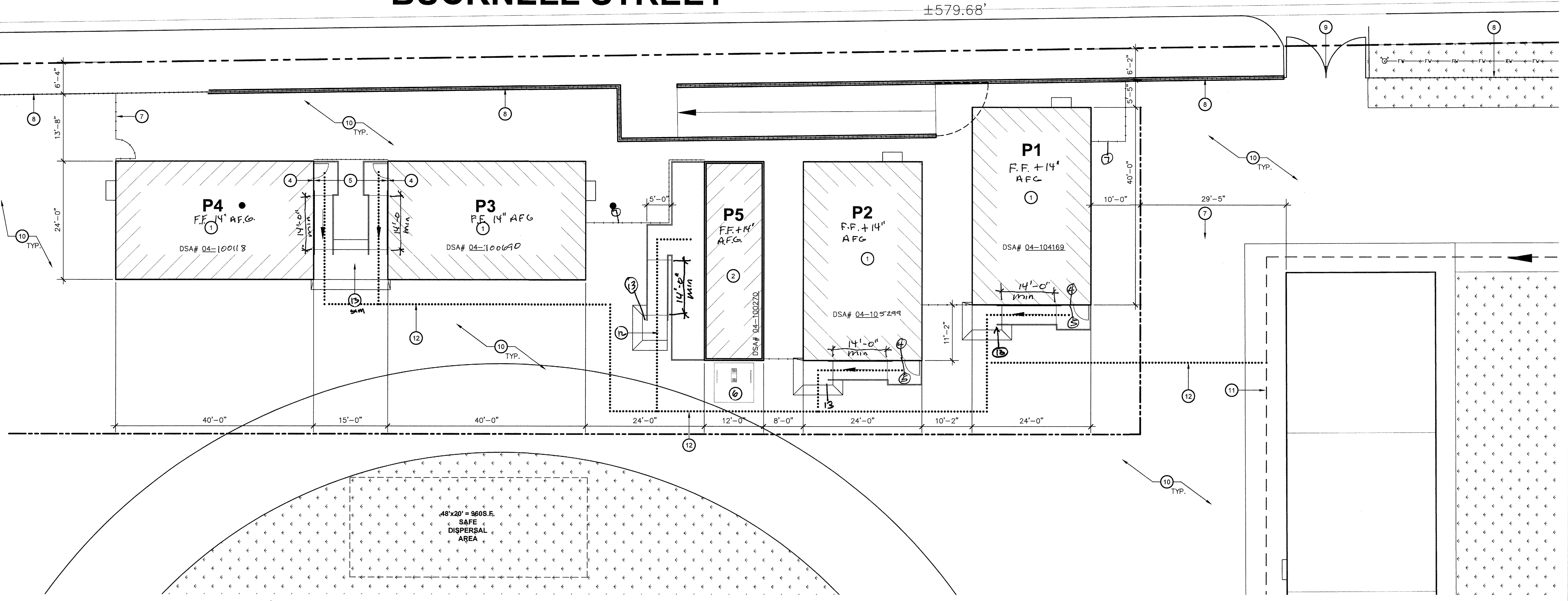

PARTIAL SITE PLAN WASHINGTON MIDDLE SCHOOL

SCALE: 1" = 10'

PARTIAL SITE PLAN

4 RELOCATABLE CLASSROOMS & 1 TOILET BLDG
WASHINGTON MIDDLE SCHOOL
 BAKERSFIELD CITY SCHOOL DISTRICT
 1101 NOBLE AVE. BAKERSFIELD, CA 93305

Issue Date: 11/13/14
 Date: 05/06/16
 Designer: [Signature]
 DR: [Signature]
 PC: CJH

Agency Approval Stamp:

FILE # 15-6
 IDENTIFICATION STAMP
 DIV. OF THE STATE ARCHITECT
 OFFICE OF REGULATION SERVICES
 03-117025
 AC: [Signature]
 DATE: 05/31/2016
 TRACKING #: 63321-

CLSRM	STKP #	SERIAL #
P1	04-104169	55976 / 55977
P2	04-105299	47729-01/02
P3	04-100690	36658
P4	04-100118	4563
P5	04-100270	35292

LEGEND	
	INDICATES EXISTING BUILDING TO REMAIN (NO WORK)
	INDICATES NEW PORTABLE BUILDING UNDER THIS APPLICATION
	HALF-TONE DASHED LINE INDICATES EXISTING ACCESSIBLE PATH OF TRAVEL
	INDICATES PROPOSED ACCESSIBLE PATH OF TRAVEL, THIS APPLICATION

Stamp(s):

Job No.: **5127**

Sheet No.: **A1.04**

Release: -