

ISOMETRIC DETAIL OF POWDER SHELF & ALUMINUM MIRROR FRAME
1/2" FILL SCALE

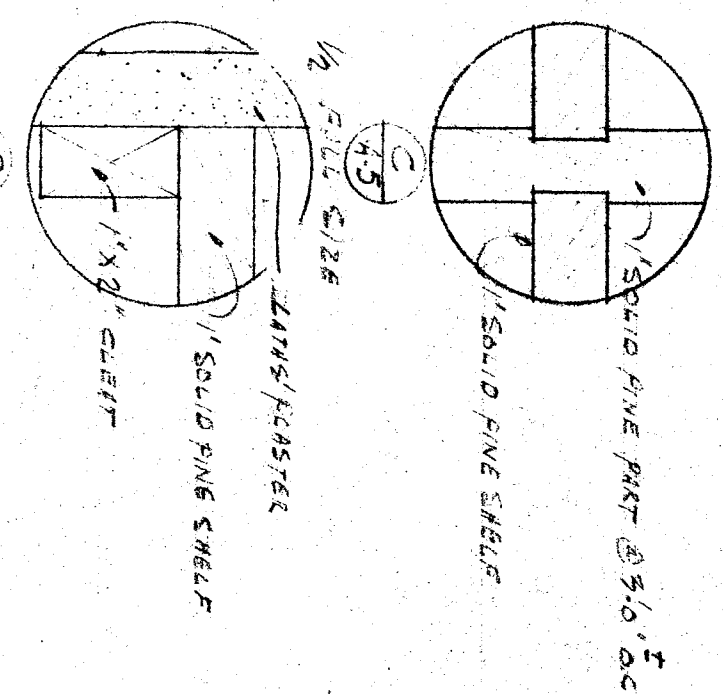

DETAIL OF JOINT TREATMENT FOR MIRROR & ALUMINUM FRAME ONLY
1/2" FILL SCALE

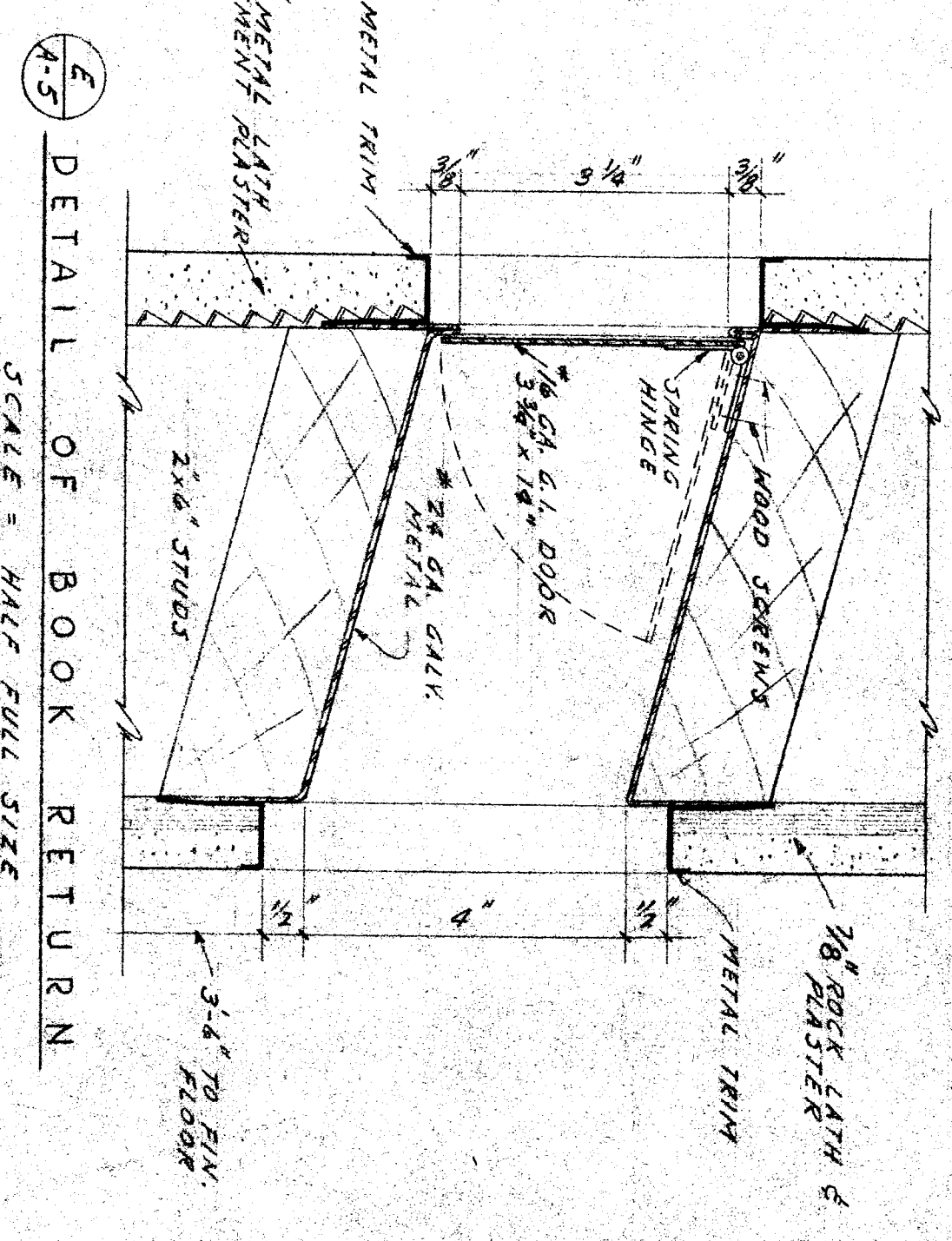

DETAIL OF BOOK RETURN
SCALE = HALF FULL SIZE

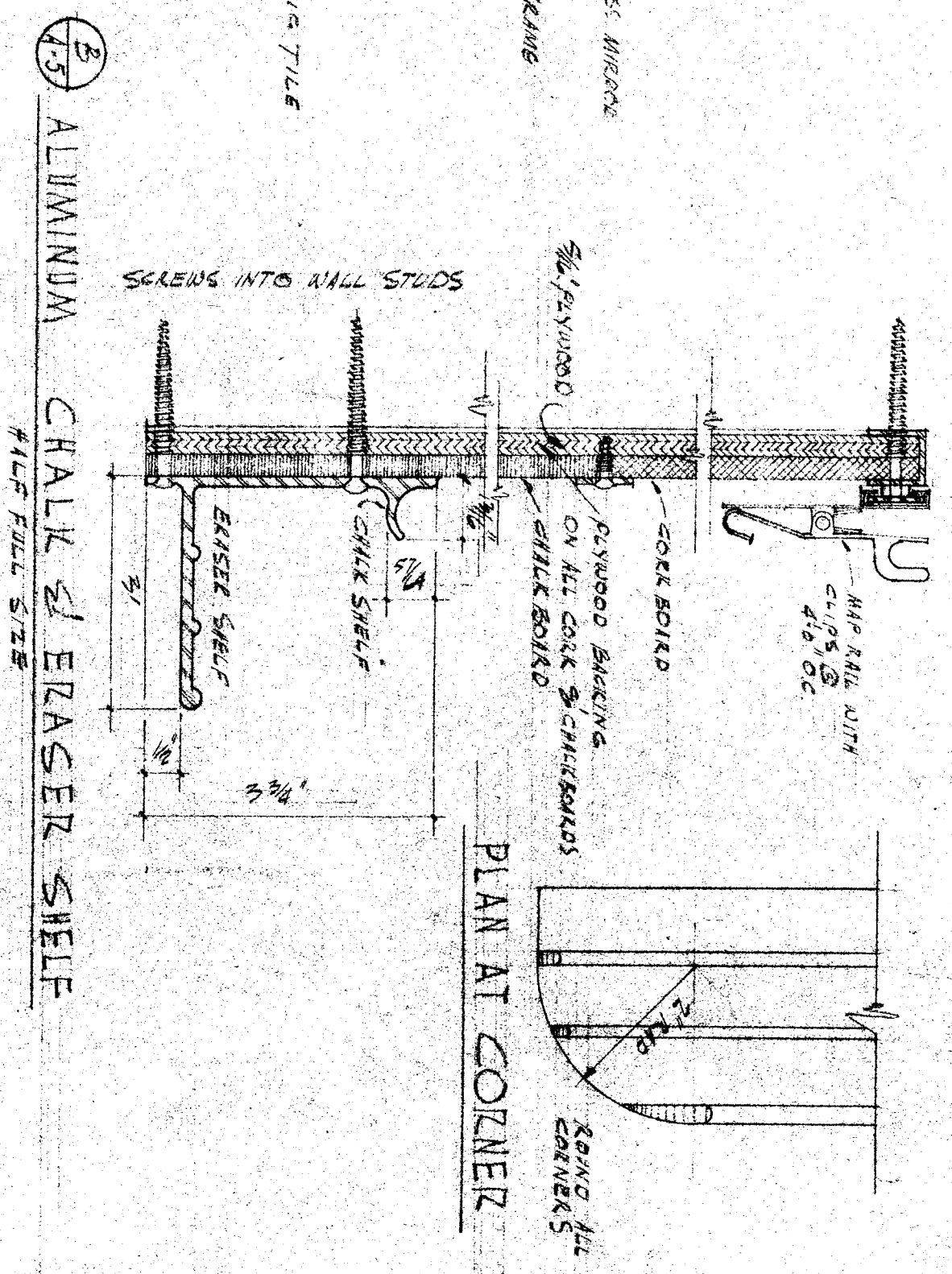

ALUMINUM CHALK & ERASER SHELF
1/2" FILL SCALE

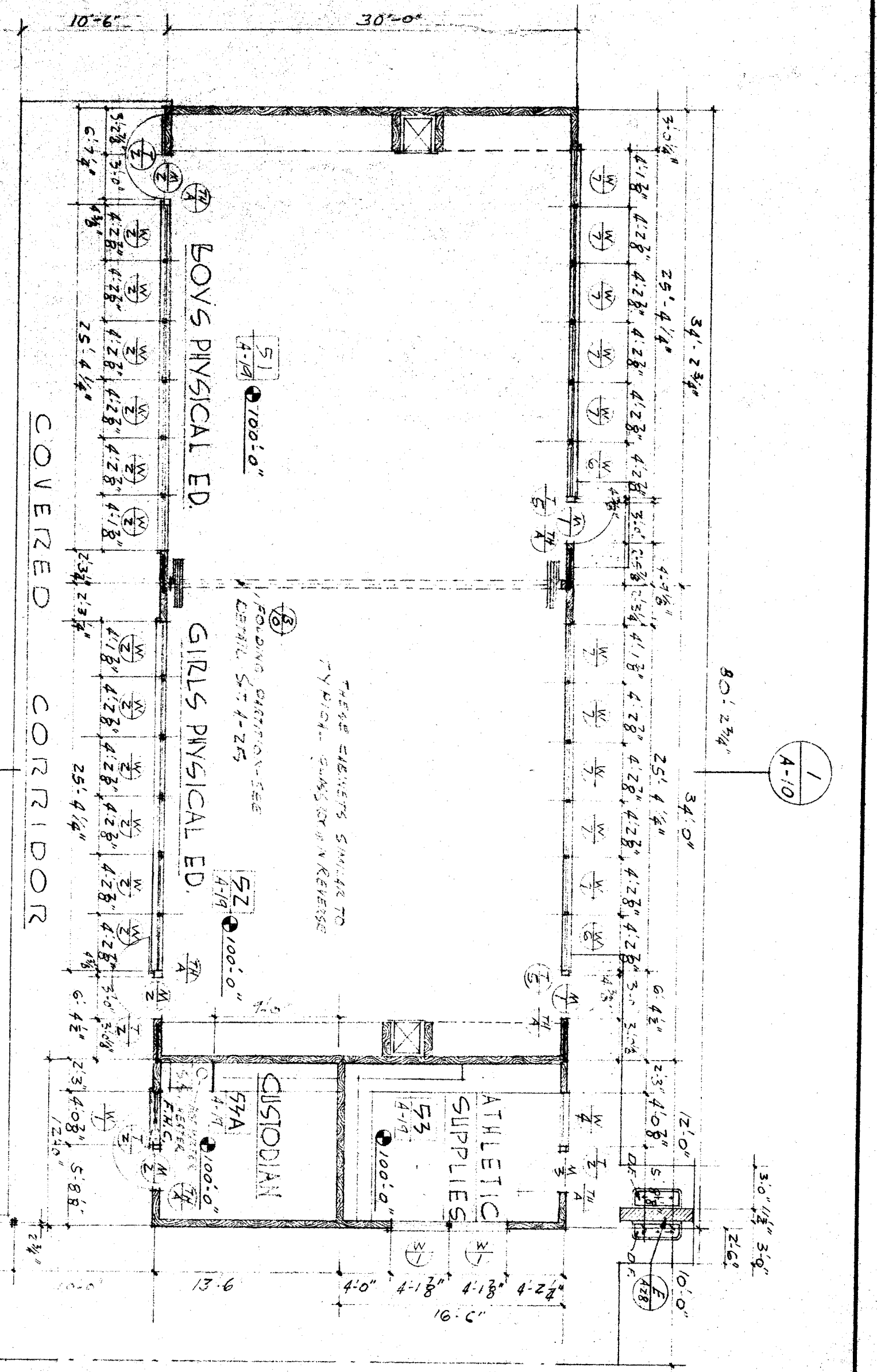

FLOOR PLAN OF UNIT G
SCALE

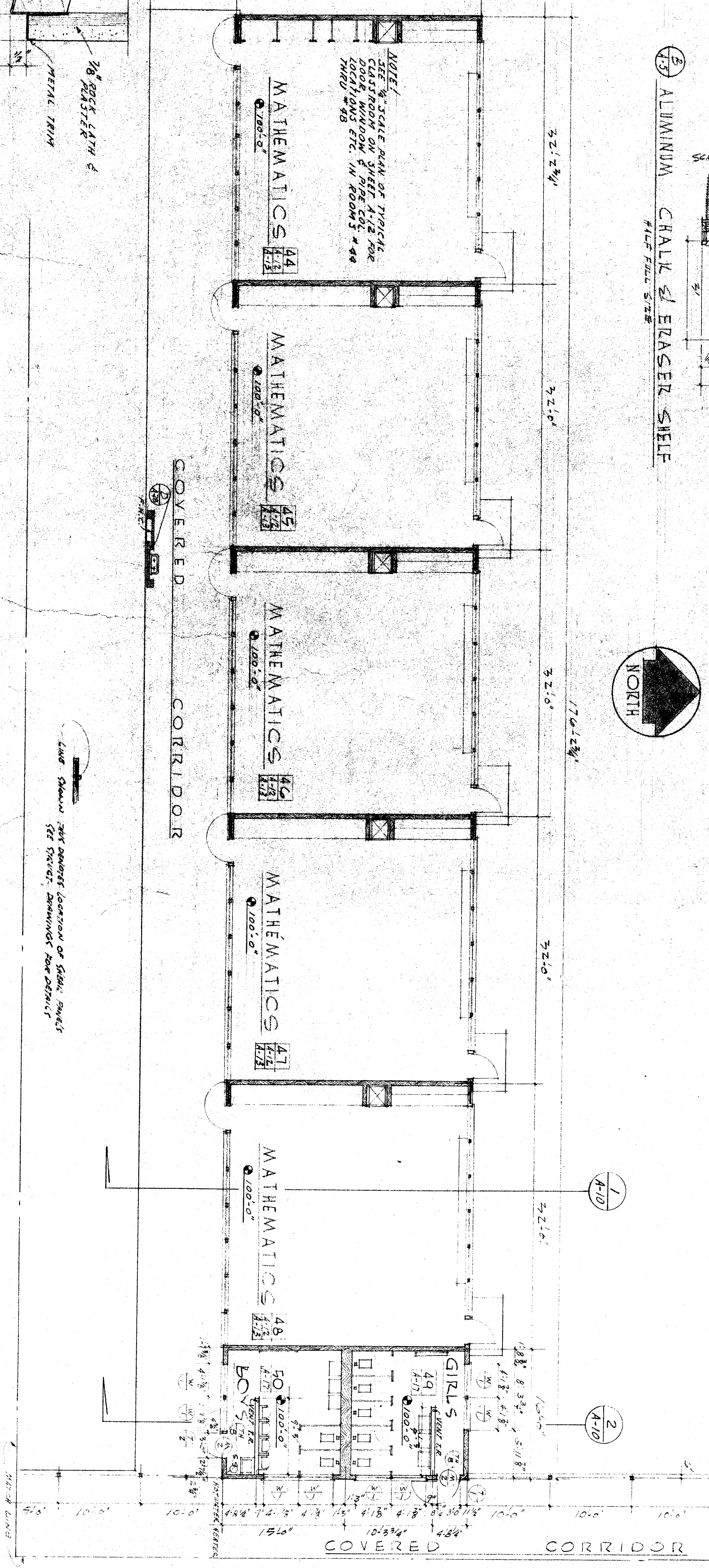

FLOOR PLAN OF UNIT F
SCALE 1/8" = 1'-0"

BAKERSFIELD CITY SCHOOLS BOARD OF EDUCATION PRELIMINARY APPROVAL DATE: 1/15/57 BY: [Signature]		COUNTY OF KERN OFFICE OF SUPERINTENDENT OF SCHOOLS JESSE B. STODOLN SUPERINTENDENT APPROVED: [Signature] DATE: 1/15/57		STATE OF CALIFORNIA DEPARTMENT OF PUBLIC WORKS DIVISION OF ARCHITECTURE APPROVED: [Signature] DATE: 1/15/57		BAKERSFIELD CITY SCHOOLS BOARD OF EDUCATION APPROVED: [Signature] DATE: 1/15/57		JUNIOR HIGH SCHOOL BAKERSFIELD CITY SCHOOL DISTRICT BELLE TERRACE & P STREETS BAKERSFIELD, CALIFORNIA JOB NO. 8238 ERNEST L. MCOY, AIA, ARCHITECT 129 HAY BLDG. BAKERSFIELD, CALIFORNIA		DRAWN BY L.W. DATE 3/1/57
------------------------------------------------------------------------------------------------------------	--	---------------------------------------------------------------------------------------------------------------------------------------	--	-------------------------------------------------------------------------------------------------------------------------	--	------------------------------------------------------------------------------------------	--	--------------------------------------------------------------------------------------------------------------------------------------------------------------------------------------------------------------	--	------------------------------------

NOTE: DIMENSIONS LOCATING WINDOWS ARE FROM WINDOW CENTERLINE AT JAMBS TO CENTER OF MULLIONS.
 NOTE: DIMENSIONS LOCATING WALLS AND PARTITIONS ARE GIVEN.
 NOTE: DIMENSIONS LOCATING DOORS ARE GIVEN FROM FACE OF DOOR TO FACE OF DOOR.
 NOTE: DIMENSIONS LOCATING STAIRS ARE GIVEN FROM FACE OF STAIR TO FACE OF STAIR.
 NOTE: DIMENSIONS LOCATING STAIRS ARE GIVEN FROM FACE OF STAIR TO FACE OF STAIR.