

DETAILS OF ALUMINUM FRAME & DOORS AT ROOM

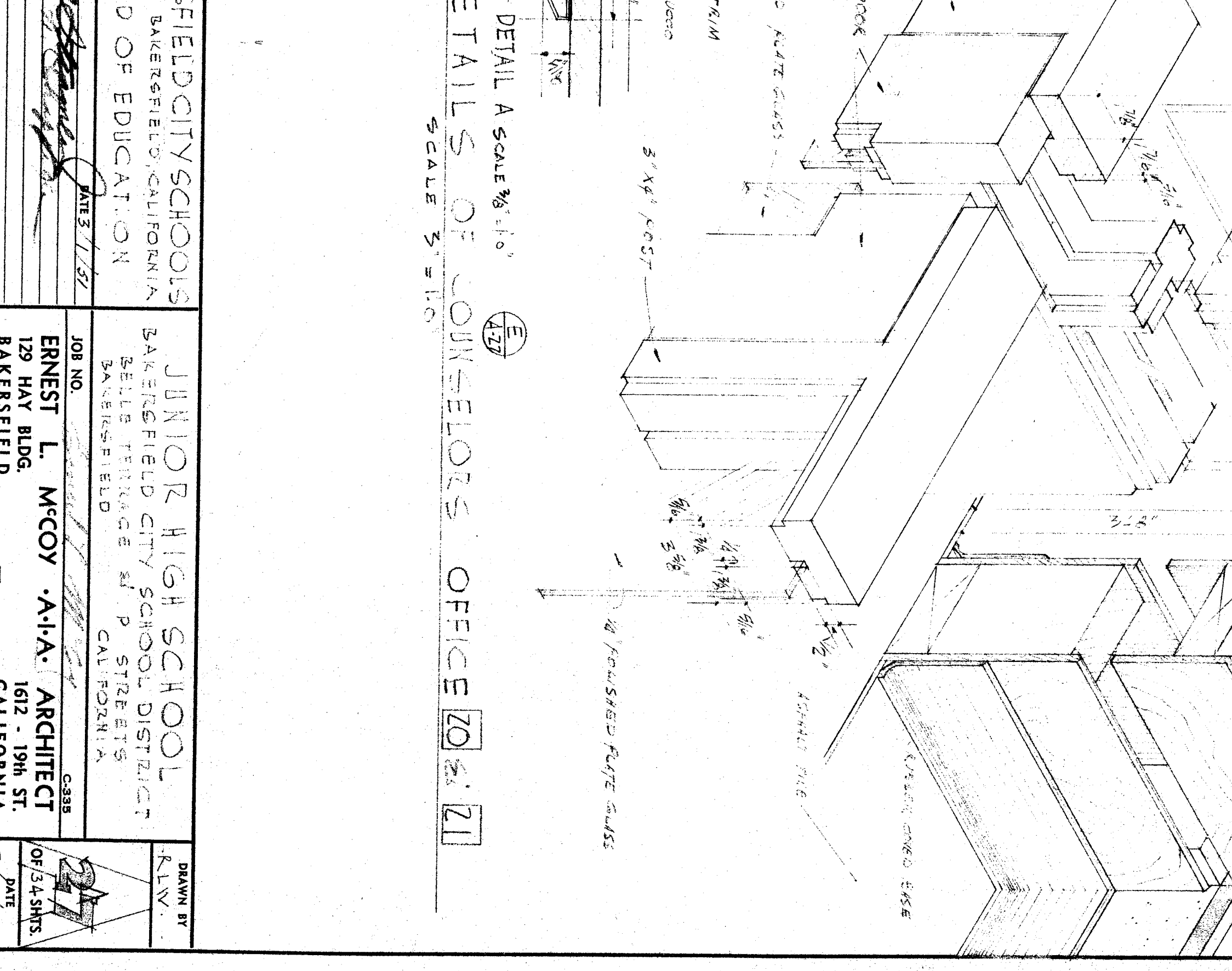
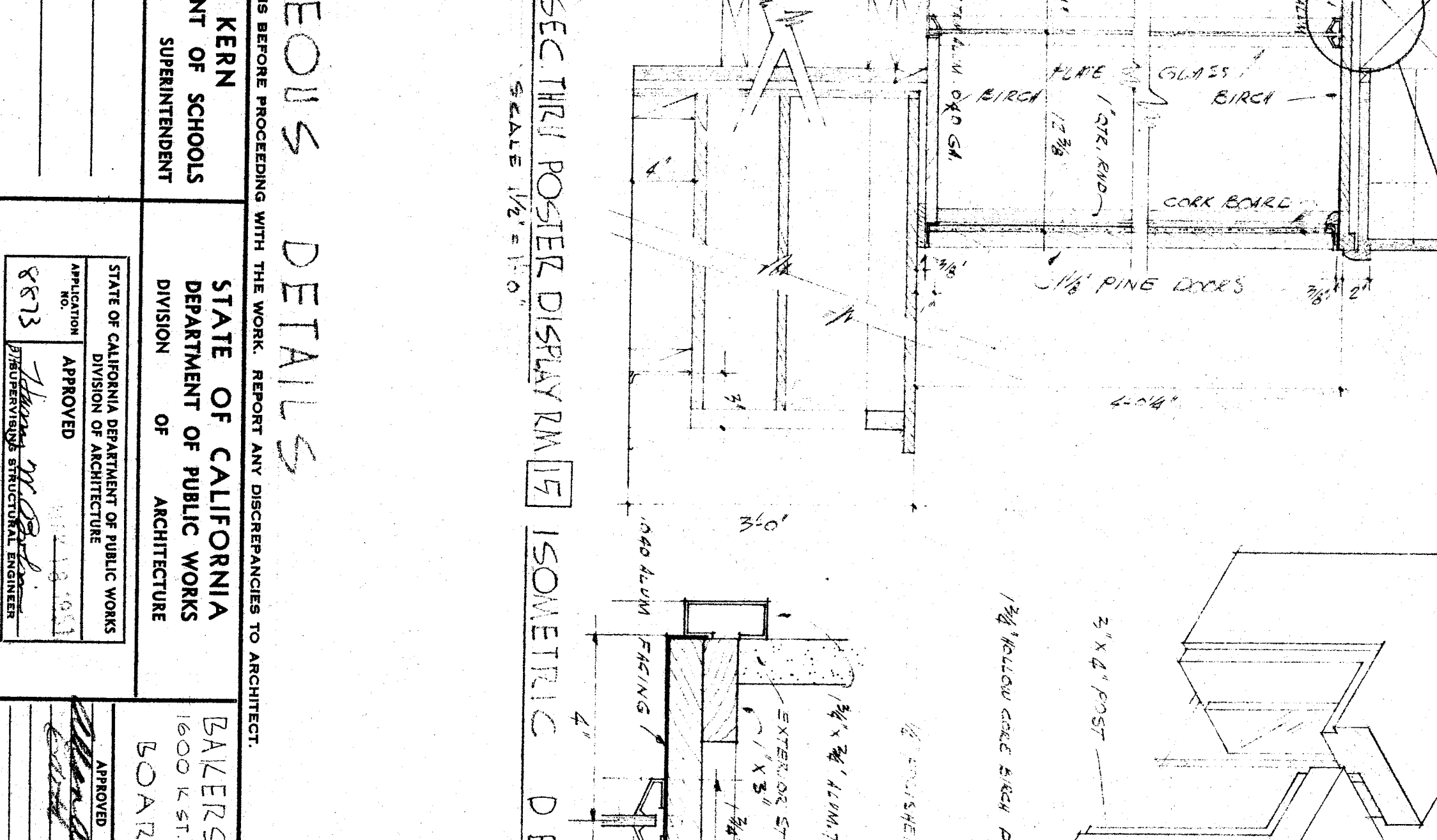
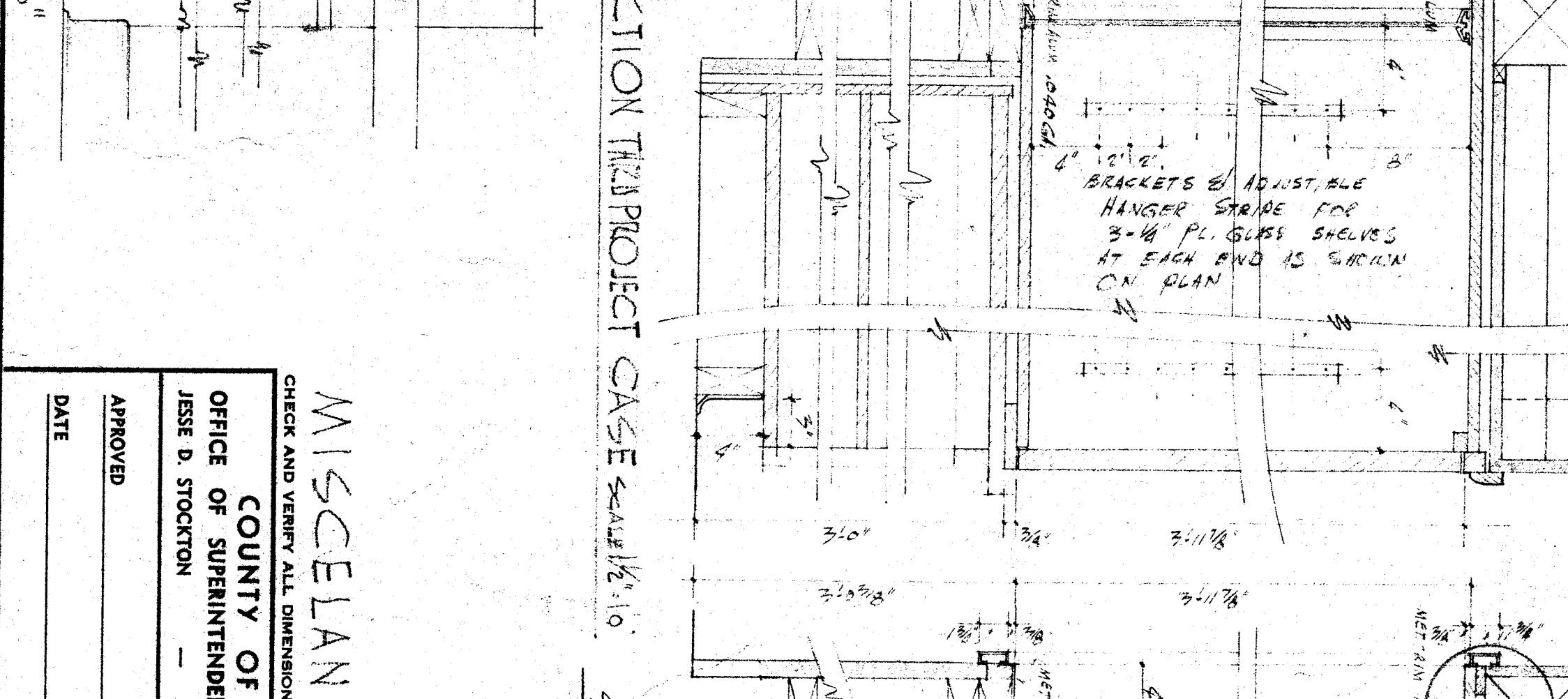
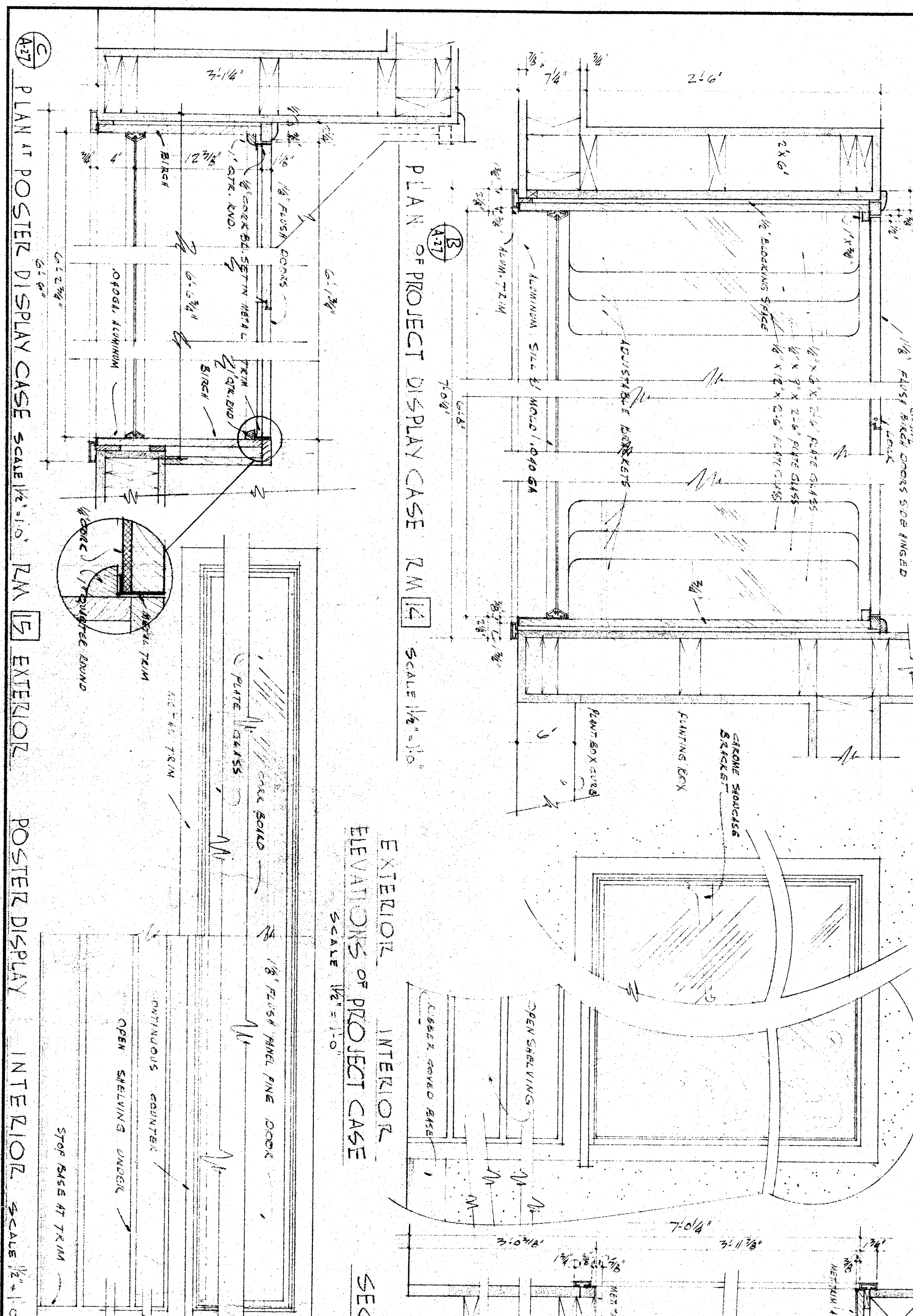
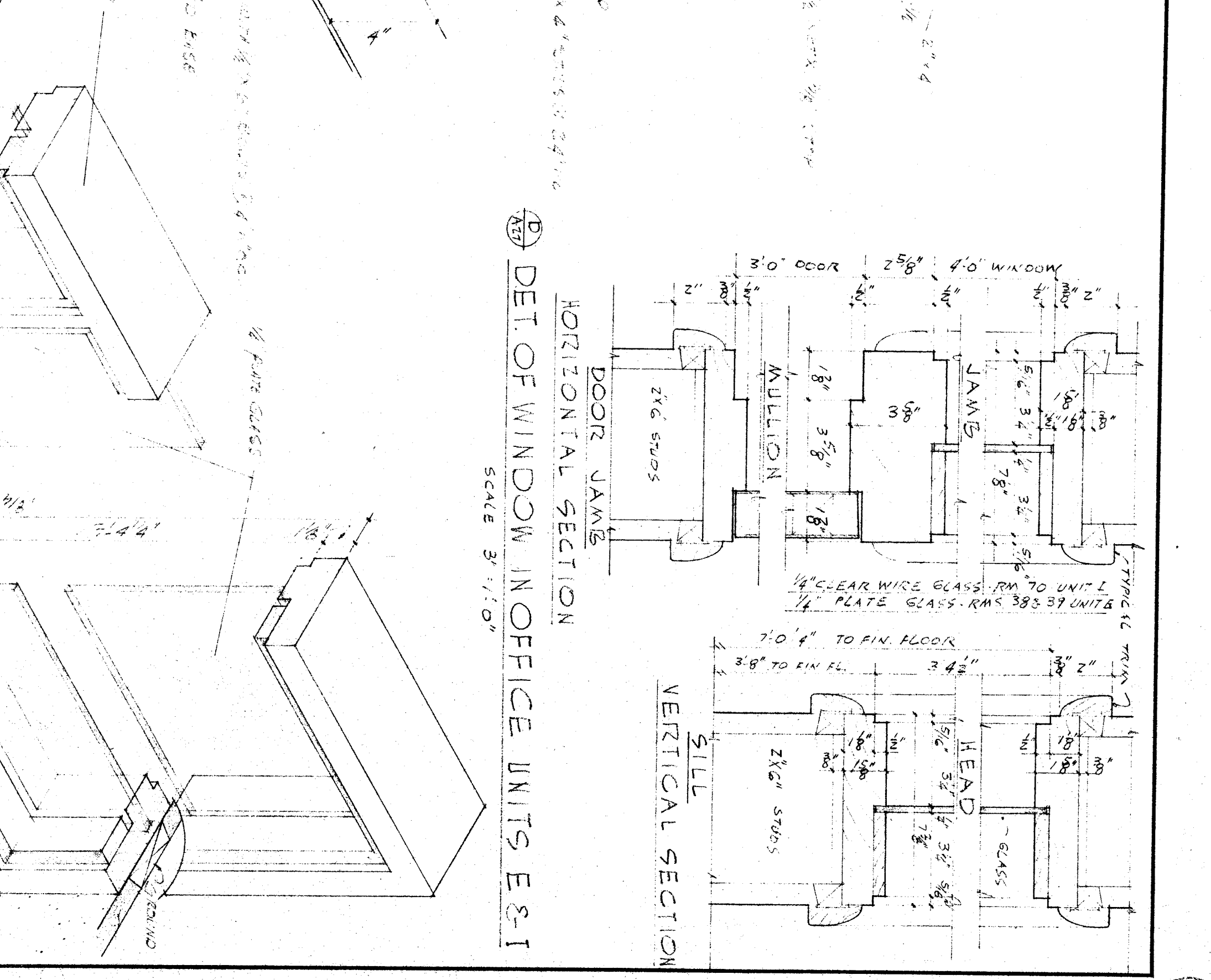
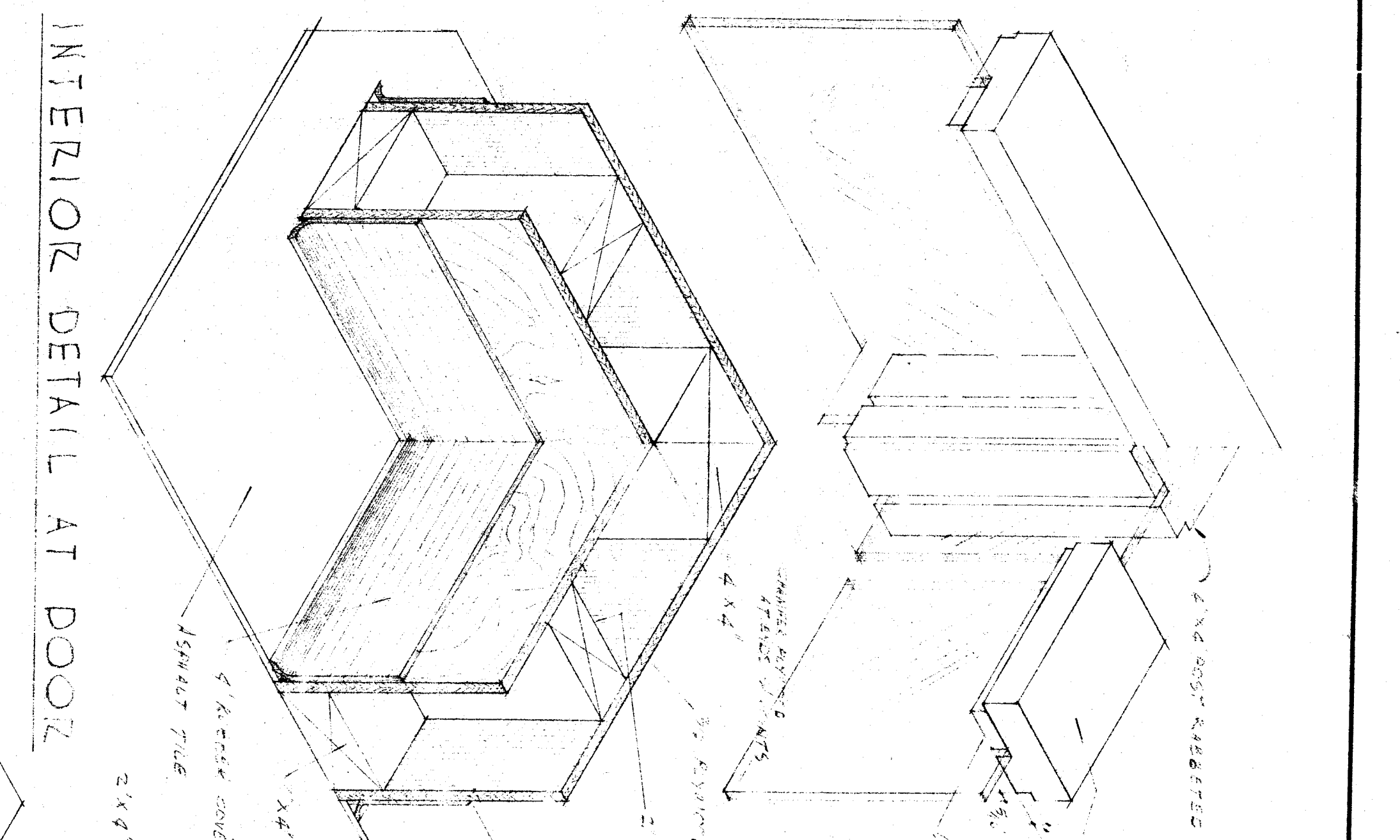
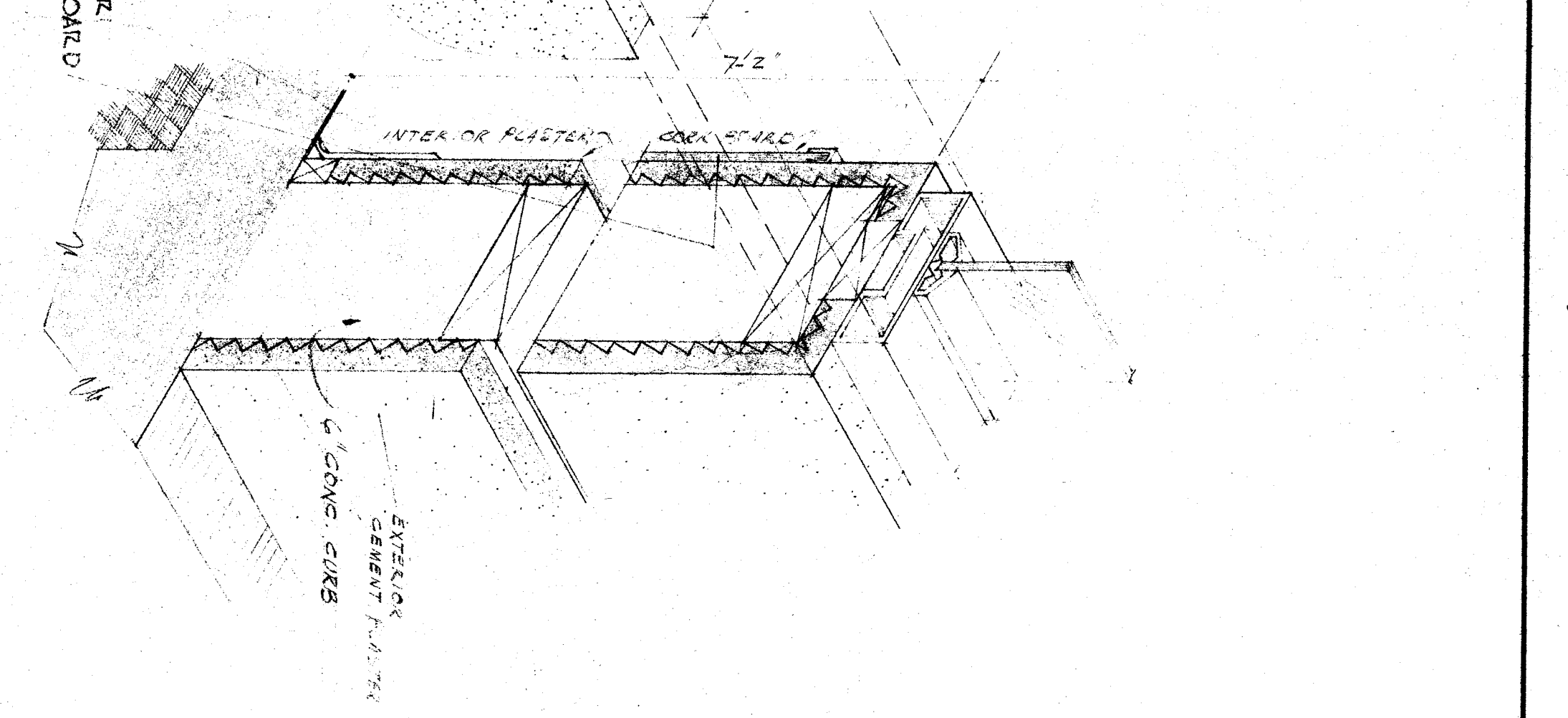

MISCELLANEOUS DETAILS

CHECK AND VERIFY ALL DIMENSIONS BEFORE PROCEEDING WITH THE WORK. REPORT ANY DISCREPANCIES TO ARCHITECT.

COUNTY OF KERN OFFICE OF SUPERINTENDENT OF SCHOOLS JESSE D. STOCKTON SUPERINTENDENT	STATE OF CALIFORNIA DEPARTMENT OF PUBLIC WORKS DIVISION OF ARCHITECTURE APPROVED: [Signature] DATE: 3/13/57	BAKERSFIELD CITY SCHOOLS 1600 K ST BAKERSFIELD, CALIFORNIA BOARD OF EDUCATION APPROVED: [Signature] DATE: 3/13/57	JUNIOR HIGH SCHOOL BAKERSFIELD CITY SCHOOL DISTRICT 5012 1/2 ST BAKERSFIELD CALIFORNIA ERNEST L. MCGOY ARCHITECT 1029 HAY AVE BAKERSFIELD CALIFORNIA DATE: 3/13/57
--	---	---	--