

SITE FIRE ALARM PLAN NOTES

- 1 PULL NEW CABLES IN EXISTING CONDUIT. PULL PAST EXISTING CABLES.
- 2 SAWCUT AND REPAIR TO MATCH EXISTING. BORING IS AN ACCEPTABLE METHOD OF CONDUIT INSTALLATION. PROVIDE METHOD OF PROCEDURE FOR BORING TO ENGINEER FOR REVIEW AND APPROVAL. DETAIL BORING PROCEDURE. IDENTIFY TYPE OF CONDUIT TO BE USED IN BORE.

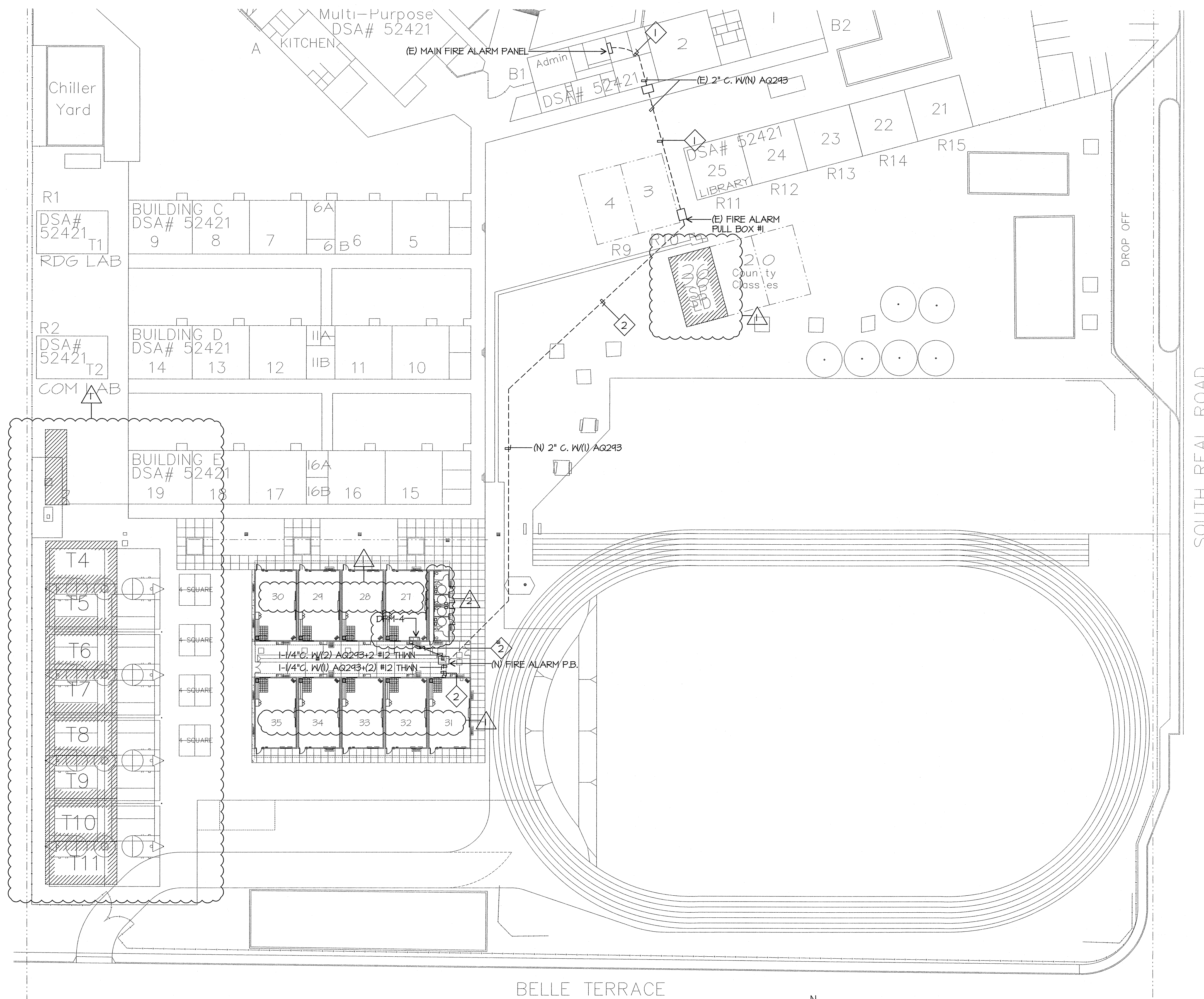

SITE FIRE ALARM PLAN

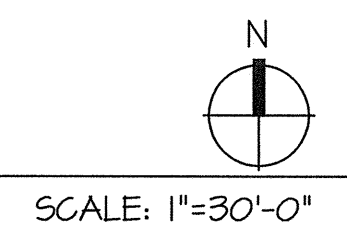

Ownership of Documents
 This document, the ideas and designs incorporated herein, as an instrument of Professional Service is the property of Integrated Designs by SOMAM, Inc. and is not to be used, in whole or in part for any other project without written authorization. © COPYRIGHT 2009

integrated designs by SOMAM, Inc.
 ARCHITECTURE • INTERIOR DESIGN • CONSTRUCTION MANAGEMENT
 6011 N. Fresno, Suite 130 - Fresno, California 93710
 Phone (559) 435-0881 Fax (559) 435-0887 E-Mail: design@somam.com
 www.integrateddesigns.com

Revision	Description	Rev. Date	Rev. Date
1	ADDENDUM 1	10/15/09	
2	CHANGE ORDER	01/22/10	

SITE FIRE ALARM PLAN
MUNSEY ELEMENTARY SCHOOL
10 NEW PORTABLE CLASSROOMS
 BAKERSFIELD CITY SCHOOL DISTRICT
 3801 BRAVE AVE. BAKERSFIELD, CA 93309

Issue Date: 05/02/06
 Date: 05/02/06
 Designer: DESIGNER
 DR: DRAFTER
 PC: C.U.M.

DSA Identification Stamp:
 IDENTIFICATION STAMP
 DIV. OF THE STATE ARCHITECT
 03-112985
 AC: [Signature]
 DATE: [Signature]

Stamp(s):

Job No.: **3832**
 Sheet No.: **X10-E-3**
 Release: CURTIS MCNALLY

JMPE
 LICENSED ARCHITECT
 ELECTRICAL ENGINEERING
 LIGHTING DESIGN
 CA REGISTRATION NO. E13063
 04082
 6500 KING AVENUE,
 SUITE 201
 BAKERSFIELD, CA 93309
 (805) 831-7901
 FAX (805) 831-7913
 email: maloney@jmpe.net
 www.jmpe.net

JMPE/JOB#:04082/DATE:01-14-10 AC