

- SITE COMMUNICATION PLAN NOTES**
- 1 PULL NEW CABLES IN EXISTING CONDUIT. PULL PAST EXISTING CABLES.
  - 2 SAWCUT AND REPAIR TO MATCH EXISTING. BORING IS AN ACCEPTABLE METHOD OF CONDUIT INSTALLATION. PROVIDE METHOD OF PROCEDURE FOR BORING TO ENGINEER FOR REVIEW AND APPROVAL. DETAIL BORING PROCEDURE. IDENTIFY TYPE OF CONDUIT TO BE USED IN BORE.

**SITE COMMUNICATION PLAN**

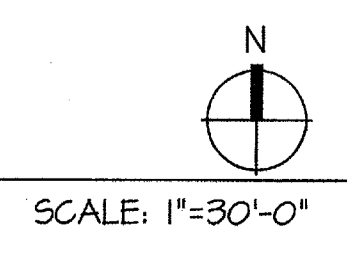

SOUTH REAL ROAD

**Ownership of Documents**  
 This document, the ideas and designs incorporated herein, as an instrument of Professional Service is the property of Integrated Designs by SOMAM Inc. and is not to be used, in whole or in part for any other project without written authorization.  
 © COPYRIGHT 2009

**integrated designs** by SOMAM, Inc.  
 ARCHITECTURE - ENGINEERING - INTERIOR DESIGN - CONSTRUCTION MANAGEMENT  
 6011 N. Fresno, Suite 130 - Fresno, California 93710  
 Phone: (559) 438-0881 Fax: (559) 438-0887 E-Mail: design@somam.com  
 www.integrateddesigns.com

Revision:	ADDENDUM 1	Rev. Date:	10/15/09
Revision Description:		Rev. Date:	

**SITE COMMUNICATION PLAN**

Project Name & Address:  
**MUNSEY ELEMENTARY SCHOOL**  
 10 NEW PORTABLE CLASSROOMS  
 BAKERSFIELD CITY SCHOOL DISTRICT  
 3801 BRAVE AVE. BAKERSFIELD, CA 93309

Issue Date: 05/02/06  
 Designer: DESIGNER  
 DR: DRAFTER  
 PC: CJM

DSA Identification Stamp:

Stamp(s):

Job No.: **3832**

Sheet No.: **E-2**

Release: **APPENDUM 1**

Release: **APPENDUM 1**

**JMPE**  
 ELECTRICAL ENGINEERING  
 LICENSED DESIGNER  
 CA REGISTRATION NO. E12088  
 04082

PROFESSIONAL ENGINEER  
**Malcolm**  
 ELECTRICAL  
 STATE OF CALIFORNIA

LICENSED ARCHITECT  
**CURTIS E. MCNALLY**  
 No. C 28966  
 5-31-03  
 STATE OF CALIFORNIA