

**LEGEND (EXISTING CONDITIONS)**

- AC ASPHALT CONCRETE
  - AP ANGLE POINT
  - BC BEGINNING CURVE
  - CO CLEANOUT
  - EP EDGE OF PAVEMENT
  - EX EXISTING
  - FL FLOWLINE
  - NG NATURAL GROUND
  - TOC TOP OF CONCRETE
  - WV WATER VALVE
  - EXISTING GROUND CONTOUR
  - EXISTING TREE
- EXISTING PLAYGROUND AREA
  - EXISTING CONCRETE
  - EXISTING LANDSCAPING (TURF)
  - EXISTING ASPHALT CONCRETE
  - LIMITS OF DEMOLITION

**DEMOLITION NOTES:**

- 1 CONTRACTOR SHALL RESEARCH ALL EXISTING UTILITIES, AND SHALL "POTHOLE" TO VERIFY THEIR LOCATIONS. ALL EXISTING UNDERGROUND UTILITIES, EXCEPT AS OTHERWISE NOTED, SHALL BE PROTECTED IN-PLACE.
- 2 ALL PAVEMENT OR CONCRETE TO BE DEMOLISHED SHALL BE SAW-CUT ALONG THE REMOVAL LINE.
- 3 COORDINATE WITH THE DISTRICT FOR REMOVAL OF EXISTING CLASSROOMS. EXISTING CLASSROOMS SHALL REMAIN IN-TACT, FULLY FUNCTIONAL AND ACCESSIBLE, UNTIL NEW MODULARS ARE INSTALLED AND ACCEPTED FOR USE BY THE DISTRICT.
- 4 REMOVE ELECTRICAL BOXES AND BACKBOARD PANEL.
- 5 CHAIN LINK FENCE TO REMAIN
- 6 COORDINATE WITH DISTRICT FOR RELOCATING EXISTING SERVICE POLE.
- 7 REFER TO SHEET 2 OF THESE PLANS AND THE ARCHITECTURAL DRAWINGS FOR ADDITIONAL NOTES REGARDING DEMOLITION.
- 8 THE LOCATION OF EXISTING UNDERGROUND UTILITIES AND PIPELINES HAVE NOT BEEN SHOWN ON THESE PLANS. THE EXACT DEPTH AND LOCATION OF UNDERGROUND UTILITIES SHALL BE DETERMINED PRIOR TO ANY GROUND DISTURBANCE.
- 9 TURF AND IRRIGATION SHALL BE REMOVED AS NECESSARY FOR CONSTRUCTION OF STORM WATER DISPOSAL AREA - SEE SHEET 7, CUT AND CAP IRRIGATION AS DIRECTED BY THE ENGINEER.
- 10 CONTRACTOR SHALL SALVAGE EXISTING BASKETBALL GOALS, VOLLEYBALL POLES, AND TETHERBALL POLES, AND SHALL DELIVER TO THE DISTRICT.

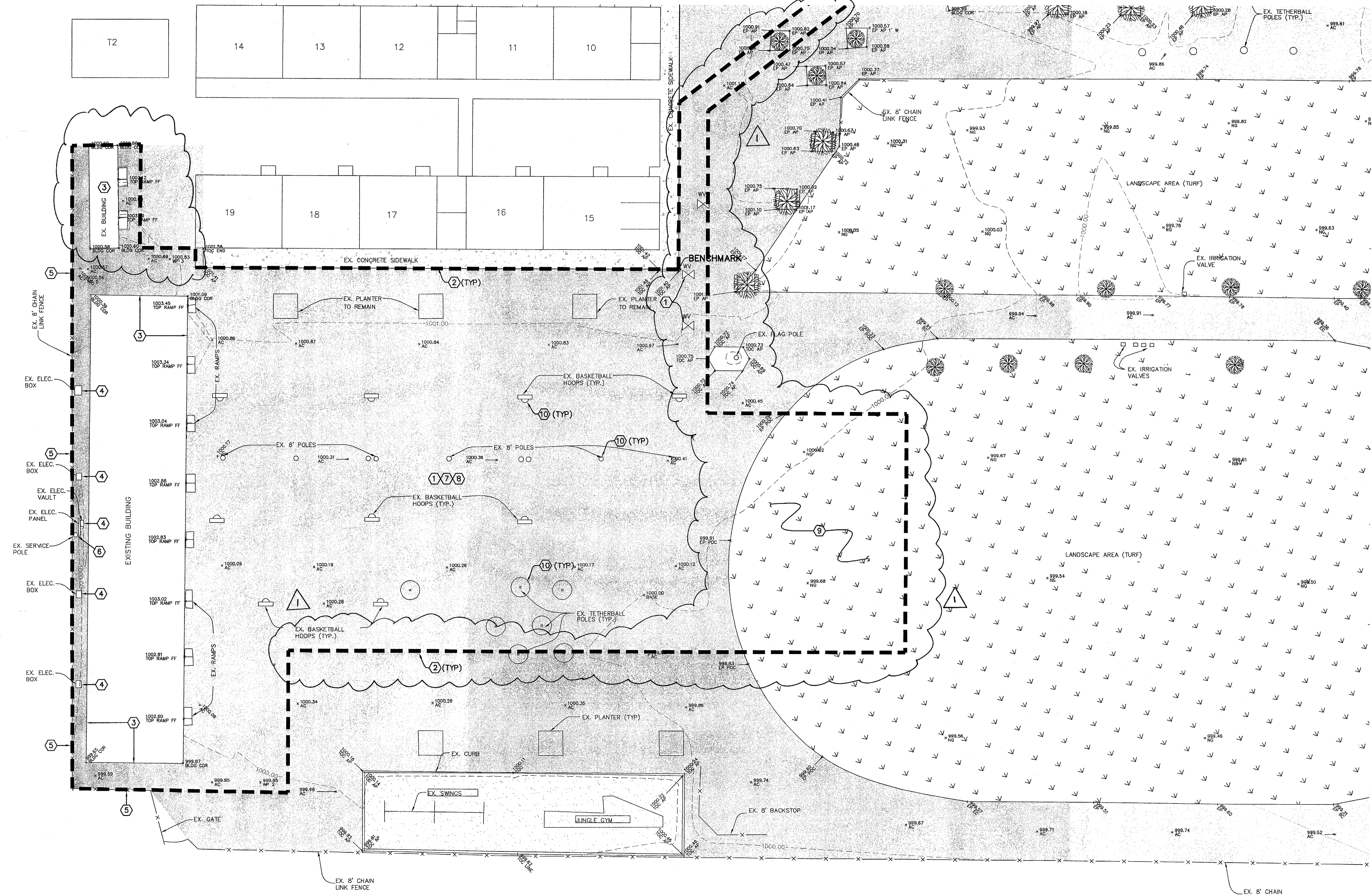

BELLE TERRACE

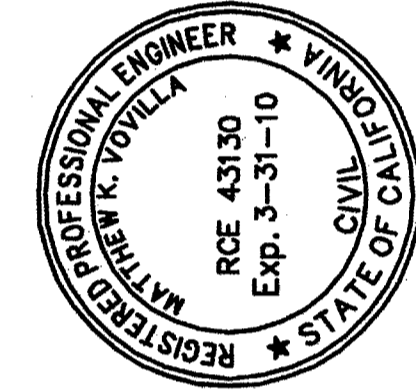

**Pinnacle Civil Engineering, Inc.**  
 2161 Saturn Court, Bakersfield, CA 93308  
 Phone: (661) 869-0184 Fax: (661) 377-0076

REVISIONS	DATE
APPENDIX #1	10/15/2009
MATTHEW K. VOVILLA RCE 43130 EXP. 3/31/10 REGISTERED PROFESSIONAL ENGINEER - CIVIL STATE OF CALIFORNIA	

**DEMOLITION PLAN  
 MUNSEY ELEMENTARY  
 3801 BRAVE AVENUE  
 BAKERSFIELD, CALIFORNIA**

JOB No.:	09-388
DWG NO.:	09-388-BM
DATE:	09/23/2009
DRAWN BY:	ADK
CHECKED BY:	MKV
SHEET	5
OF 8 SHEETS	