

NOTES LISTED IN THIS COLUMN WHICH ARE NOT INDICATED ON THIS SHEET SHALL BE DISREGARDED. COMPLETE PATCH AND REPAIR OF AREAS AND ADJACENT AREAS WHERE REMOVAL, DEMOLITION OR MODIFICATIONS ARE MADE ARE A PART OF THIS WORK. FIELD VERIFICATION FOR ACTUAL EXISTING CONDITIONS PRIOR TO BIDDING, FABRICATION, INSTALLATION OR CONSTRUCTION IS A PART OF THIS WORK. NOTES ARE TYPICAL UNLESS OTHERWISE INDICATED.

LEGEND

(N) = NEW; AS SHOWN, DETAILED,  
(E) = EXISTING; SCHEDULED, A/OR  
(D) = DEMOLITION; SPECIFIED.

1. (E) MECHANICAL UNIT TO BE REMOVED. (REFER TO MECHANICAL DRAWINGS)
2. (E) MECHANICAL UNIT TO REMAIN.
3. (E) ROOFING REMOVED AND/OR DAMAGED DURING MECHANICAL UNIT REMOVAL SHALL BE PATCHED AND REPAIRED WITH LIKE KIND TO MATCH ADJACENT.

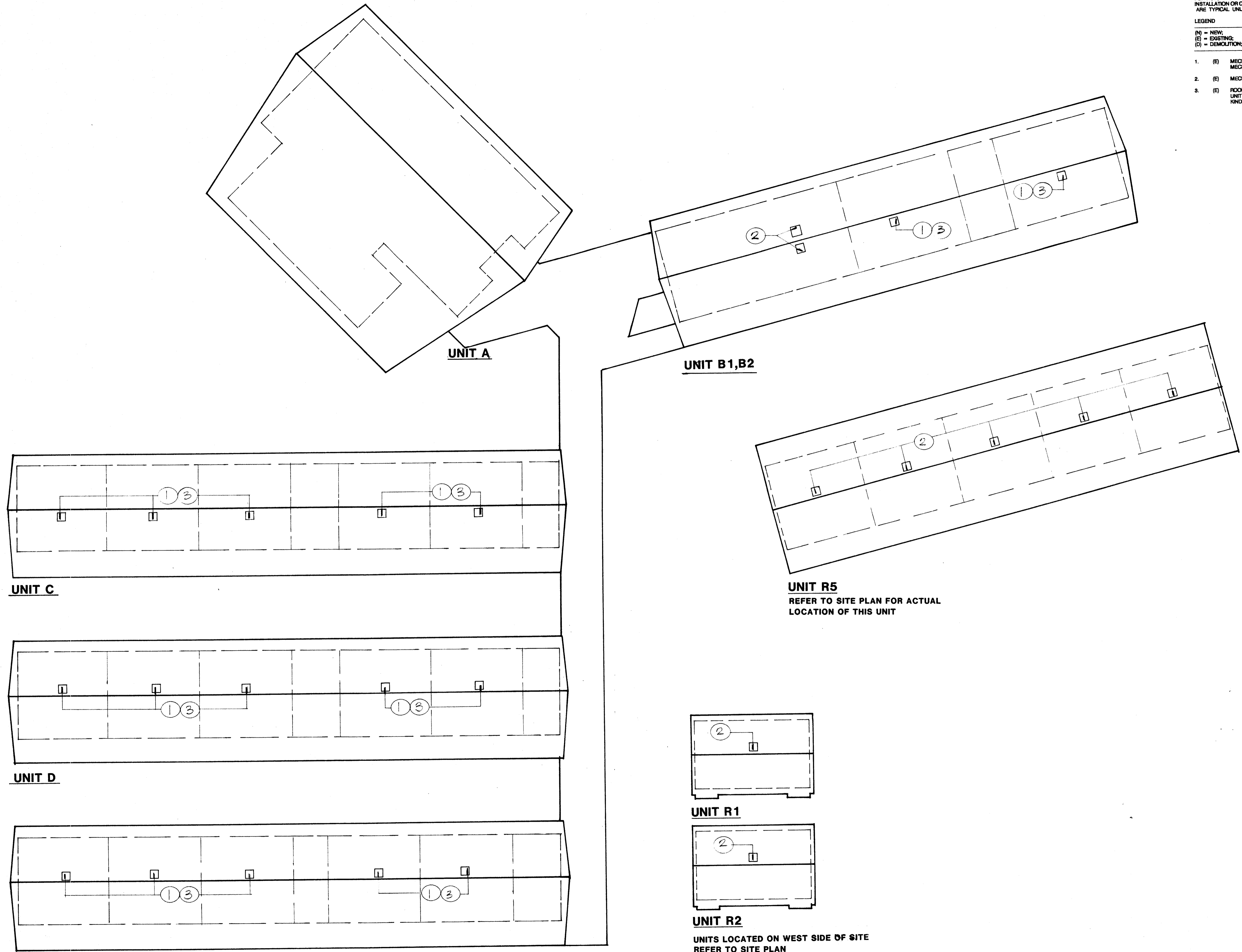

UNIT C

UNIT D

UNIT E

UNIT A

UNIT B1,B2

UNIT R5  
REFER TO SITE PLAN FOR ACTUAL  
LOCATION OF THIS UNIT

UNIT R1

UNIT R2

UNITS LOCATED ON WEST SIDE OF SITE  
REFER TO SITE PLAN

TITLE 24 & 1379 UBC

7

52421 AM/LA



(EXISTING UNITS A,B1,B2,C,D,E,R1,R2,R5)

1/16"=1'-0"

2115 19th Street, Bakersfield, CA 93301 • (805) 322-1863

Architects • Planners

*Handwritten signature: Kenrick Design Group*

Kenrick Design Group A.S.A.

job number  
**8712**

sheet number  
**A-19**