

SITE IMPROVEMENTS AND PORTABLE CLASSROOMS

AT CHIPMAN JR HIGH FOR BAKERSFIELD CITY SCHOOL DISTRICT BAKERSFIELD, CALIFORNIA

ORDIZ MELBY ARCHITECTS, INC.
5800 KING AVENUE SUITE 200
BAKERSFIELD, CALIFORNIA 93309
TELEPHONE (805) 832-6268
FACSIMILE (805) 832-4081

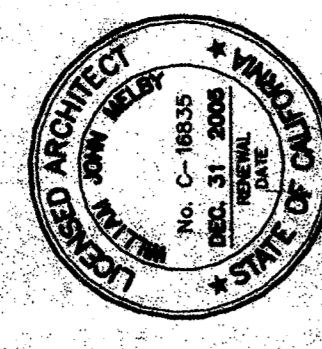

IDENTIFICATION STAMP
DIVISION OF STATE ARCHITECTURE
OFFICE OF REGULATION SERVICES

DATE: JUL 2 5 2005
FILE # 03-106755

PTN: 63321-50

SITE IMPROVEMENTS PORTABLE CLASSROOMS AT CHIPMAN JUNIOR HIGH SCHOOL BAKERSFIELD CITY SCHOOL DISTRICT

ESSILIER STREET BAKERSFIELD CALIFORNIA 93306

MARK	DATE	DESCRIPTION
SD		
CD		
AI	01-15-15	CCD 801

TITLE SHEET AND SITE PLAN

SHEET IDENTIFICATION NUMBER: **A-111**

SHEET 01 OF 03

PROJECT APP# 03-106755 SHALL NOT BE CERTIFIED AS COMPLETE UNTIL THE ARCHITECT HAS RECEIVED ALL NECESSARY PERMITS AND APPROVALS FROM THE CITY OF BAKERSFIELD AND THE CALIFORNIA DEPARTMENT OF INDUSTRIAL RELATIONS AND LABOR RELATIONS. THE ARCHITECT SHALL BE RESPONSIBLE FOR OBTAINING ALL NECESSARY PERMITS AND APPROVALS FROM THE CITY OF BAKERSFIELD AND THE CALIFORNIA DEPARTMENT OF INDUSTRIAL RELATIONS AND LABOR RELATIONS. THE ARCHITECT SHALL BE RESPONSIBLE FOR OBTAINING ALL NECESSARY PERMITS AND APPROVALS FROM THE CITY OF BAKERSFIELD AND THE CALIFORNIA DEPARTMENT OF INDUSTRIAL RELATIONS AND LABOR RELATIONS.

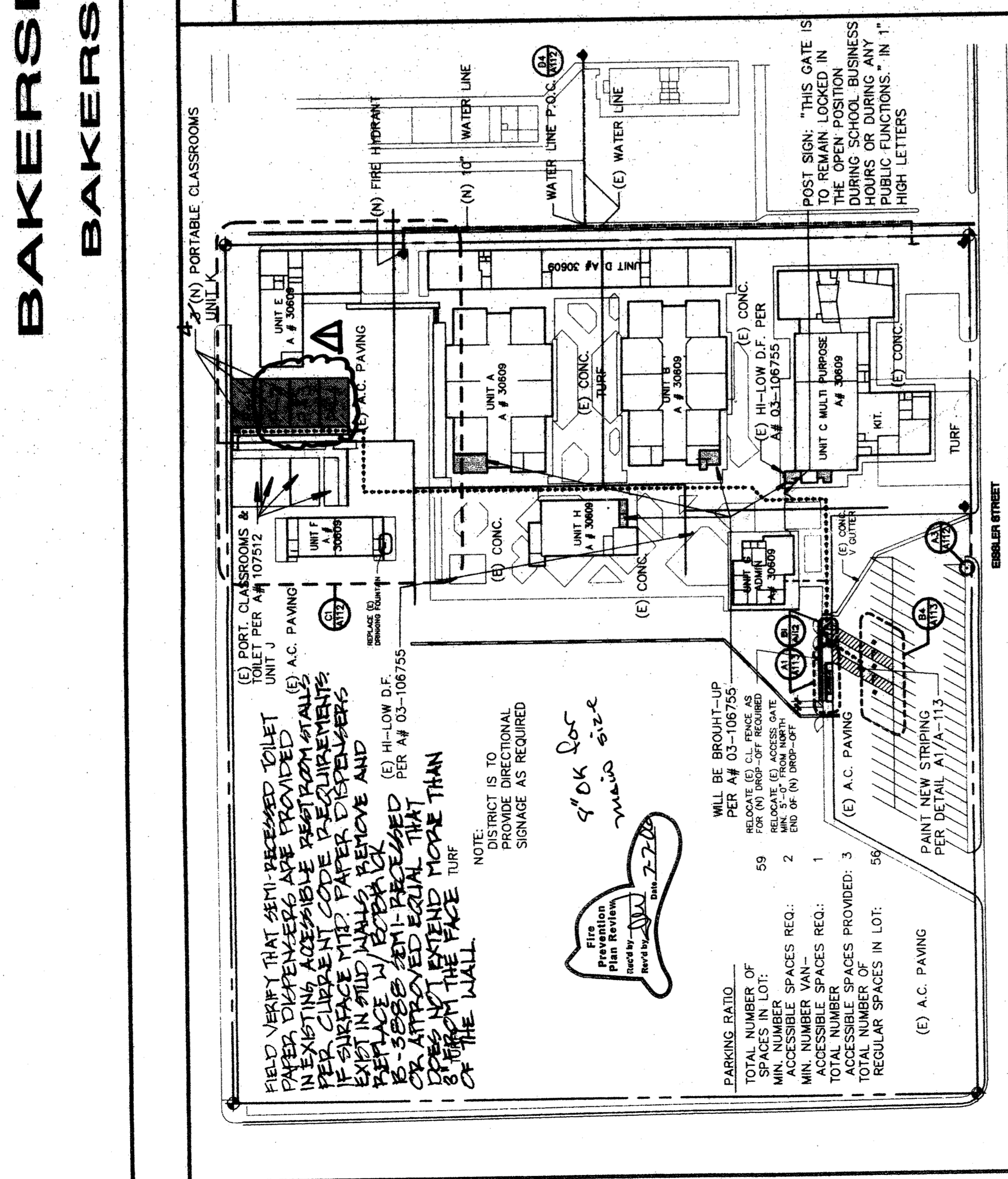

VERIFY THAT ALL EXISTING GATES MEET THE FOLLOWING REQUIREMENTS. GATES IN THE PATH OF TRAVEL MUST COMPLY WITH EXIT DOOR REQUIREMENTS (SEE SECTION 1133B.2) SPECIFY LEVER HARDWARE AND KICK PLATE OR GATE STAYING THAT THIS GATE IS TO REMAIN LOCKED IN THE OPEN POSITION DURING BUSINESS SCHOOL HOURS OR DURING ANY PUBLIC FUNCTIONS. FIRE AND LIFE SAFETY REQUIREMENTS FOR EMERGENCY EXISTING EVEN WITH THE SIGN. ORDNATE WITH FIRE AND LIFE SAFETY REQUIREMENTS.

COMPLETE FIRE ALARM PLAN SUBMITTAL:
THE FIRE ALARM SYSTEM SHOWN ON THESE PLANS HAS BEEN SUBMITTED AND APPROVED BY THE DIVISION OF STATE ARCHITECTURE. ANY SUBSTITUTION OF THE FIRE ALARM SYSTEM SHALL BE RESPONSIBLE FOR ANY FEES THAT ARE INCURRED DUE TO THIS SUBSTITUTION. APPROVAL FEES, CONTRACTOR SHALL BE RESPONSIBLE FOR ANY FEES THAT ARE INCURRED DUE TO THIS SUBSTITUTION.

LOCAL FIRE AUTHORITY REVIEW

CHIPMAN JR. HIGH
ADDRESS: 2905 ESSILIER ST.
CITY/STATE/ZIP: BAKERSFIELD, CALIFORNIA 93306

LOCAL FIRE AUTHORITY: BAKERSFIELD COUNTY FIRE DEPARTMENT

APPROVAL ISSUED BY: *[Signature]*
RANK/TITLE: Fire Planner
DATE: 7/25/05
PHONE NUMBER: (661) 862-5001

PURSUANT TO: TITLE 19 CALIFORNIA ADMINISTRATION SUB CHAPTER 1, ARTICLES 3.05 ACCESS ROADS AND 3.16 GATE ENTRANCES TO SCHOOL GROUNDS IT IS NECESSARY TO PROVIDE THE STATE FIRE MARSHAL (SFM) WITH WRITTEN CERTIFICATION FROM THE FIRE AUTHORITY THAT THE ABOVE SECTIONS ARE BEING MET TO THEIR SATISFACTION.

FIRE-FLOWS & HYDRANTS HAVE BEEN REVIEWED FOR COMPLIANCE WITH STATE APPENDICES 111-AA & 111-BB PART 9 TITLE 24.

GENERAL NOTES

- THE INTENT OF THESE DRAWINGS AND SPECIFICATIONS IS THAT THE WORK IS TO BE IN ACCORDANCE WITH TITLE 24, CALIFORNIA CODE OF REGULATIONS. SHOULD ANY CONFLICTS OR DISCREPANCIES BE DISCOVERED WHICH IS NOT COVERED BY THE CONTRACT DOCUMENTS WHEREIN THE FINISH WORK WILL NOT COMPLY WITH TITLE 24, CALIFORNIA CODE OF REGULATIONS, A CHANGE ORDER, OR A SEPARATE SET OF PLANS AND SPECIFICATIONS SHALL BE OBTAINED FROM THE DIVISION OF THE STATE ARCHITECT BEFORE PROCEEDING WITH THE WORK.
- NOTHING IN THE DRAWINGS AND/OR THE SPECIFICATIONS SHALL BE CONSTRUED TO PERMIT AN INSTALLATION THAT COULD BE IN VIOLATION OF THE APPLICABLE CODES, ORDINANCES, REGULATIONS, ETC.
- ALL WORK SHALL BE DONE UNDER THIS CONTRACT SHALL BE IN FULL ACCORDANCE WITH ALL APPLICABLE CODES, ORDINANCES, REGULATIONS, ETC.
- THE DRAWINGS, IDEAS, DESIGNS, AND ARRANGEMENTS REPRESENTED HEREBY ARE AND SHALL REMAIN THE PROPERTY OF THE ARCHITECT AND NO PART THEREOF SHALL BE COPIED OR DISCLOSED TO OTHERS WITHOUT THE SPECIFIC PERMISSION OF THE ARCHITECT. THE ARCHITECT SHALL BE RESPONSIBLE FOR THE PROTECTION OF HIS OR HER WORK AND SHALL BE RESPONSIBLE FOR THE PROTECTION OF HIS OR HER WORK.
- THE CONTRACTOR SHALL VERIFY ALL DIMENSIONS IN THE FIELD AND SHALL NOTIFY THE ARCHITECT OF ANY DISCREPANCIES IMMEDIATELY. DISCREPANCIES BETWEEN THE FIELD CONDITIONS AND THE DRAWINGS SHALL BE NOTICED BY ANY VARIATIONS FROM THE DIMENSIONS AND CONDITIONS SHOWN BY THESE DRAWINGS.
- THE CONTRACTOR SHALL VERIFY ALL DIMENSIONS IN THE FIELD AND SHALL NOTIFY THE ARCHITECT OF ANY DISCREPANCIES IMMEDIATELY. DISCREPANCIES BETWEEN THE FIELD CONDITIONS AND THE DRAWINGS SHALL BE NOTICED BY ANY VARIATIONS FROM THE DIMENSIONS AND CONDITIONS SHOWN BY THESE DRAWINGS.
- THE CONTRACTOR SHALL VERIFY ALL DIMENSIONS IN THE FIELD AND SHALL NOTIFY THE ARCHITECT OF ANY DISCREPANCIES IMMEDIATELY. DISCREPANCIES BETWEEN THE FIELD CONDITIONS AND THE DRAWINGS SHALL BE NOTICED BY ANY VARIATIONS FROM THE DIMENSIONS AND CONDITIONS SHOWN BY THESE DRAWINGS.
- THE CONTRACTOR SHALL VERIFY ALL DIMENSIONS IN THE FIELD AND SHALL NOTIFY THE ARCHITECT OF ANY DISCREPANCIES IMMEDIATELY. DISCREPANCIES BETWEEN THE FIELD CONDITIONS AND THE DRAWINGS SHALL BE NOTICED BY ANY VARIATIONS FROM THE DIMENSIONS AND CONDITIONS SHOWN BY THESE DRAWINGS.

PROJECT DATA

GENERAL NOTES

THE DRAWINGS, IDEAS, DESIGNS, AND ARRANGEMENTS REPRESENTED HEREBY ARE AND SHALL REMAIN THE PROPERTY OF THE ARCHITECT AND NO PART THEREOF SHALL BE COPIED OR DISCLOSED TO OTHERS WITHOUT THE SPECIFIC PERMISSION OF THE ARCHITECT. THE ARCHITECT SHALL BE RESPONSIBLE FOR THE PROTECTION OF HIS OR HER WORK AND SHALL BE RESPONSIBLE FOR THE PROTECTION OF HIS OR HER WORK.- THE CONTRACTOR SHALL VERIFY ALL DIMENSIONS IN THE FIELD AND SHALL NOTIFY THE ARCHITECT OF ANY DISCREPANCIES IMMEDIATELY. DISCREPANCIES BETWEEN THE FIELD CONDITIONS AND THE DRAWINGS SHALL BE NOTICED BY ANY VARIATIONS FROM THE DIMENSIONS AND CONDITIONS SHOWN BY THESE DRAWINGS.
- THE CONTRACTOR SHALL VERIFY ALL DIMENSIONS IN THE FIELD AND SHALL NOTIFY THE ARCHITECT OF ANY DISCREPANCIES IMMEDIATELY. DISCREPANCIES BETWEEN THE FIELD CONDITIONS AND THE DRAWINGS SHALL BE NOTICED BY ANY VARIATIONS FROM THE DIMENSIONS AND CONDITIONS SHOWN BY THESE DRAWINGS.
- THE CONTRACTOR SHALL VERIFY ALL DIMENSIONS IN THE FIELD AND SHALL NOTIFY THE ARCHITECT OF ANY DISCREPANCIES IMMEDIATELY. DISCREPANCIES BETWEEN THE FIELD CONDITIONS AND THE DRAWINGS SHALL BE NOTICED BY ANY VARIATIONS FROM THE DIMENSIONS AND CONDITIONS SHOWN BY THESE DRAWINGS.
- THE CONTRACTOR SHALL VERIFY ALL DIMENSIONS IN THE FIELD AND SHALL NOTIFY THE ARCHITECT OF ANY DISCREPANCIES IMMEDIATELY. DISCREPANCIES BETWEEN THE FIELD CONDITIONS AND THE DRAWINGS SHALL BE NOTICED BY ANY VARIATIONS FROM THE DIMENSIONS AND CONDITIONS SHOWN BY THESE DRAWINGS.
- THE CONTRACTOR SHALL VERIFY ALL DIMENSIONS IN THE FIELD AND SHALL NOTIFY THE ARCHITECT OF ANY DISCREPANCIES IMMEDIATELY. DISCREPANCIES BETWEEN THE FIELD CONDITIONS AND THE DRAWINGS SHALL BE NOTICED BY ANY VARIATIONS FROM THE DIMENSIONS AND CONDITIONS SHOWN BY THESE DRAWINGS.
- THE CONTRACTOR SHALL VERIFY ALL DIMENSIONS IN THE FIELD AND SHALL NOTIFY THE ARCHITECT OF ANY DISCREPANCIES IMMEDIATELY. DISCREPANCIES BETWEEN THE FIELD CONDITIONS AND THE DRAWINGS SHALL BE NOTICED BY ANY VARIATIONS FROM THE DIMENSIONS AND CONDITIONS SHOWN BY THESE DRAWINGS.
- THE CONTRACTOR SHALL VERIFY ALL DIMENSIONS IN THE FIELD AND SHALL NOTIFY THE ARCHITECT OF ANY DISCREPANCIES IMMEDIATELY. DISCREPANCIES BETWEEN THE FIELD CONDITIONS AND THE DRAWINGS SHALL BE NOTICED BY ANY VARIATIONS FROM THE DIMENSIONS AND CONDITIONS SHOWN BY THESE DRAWINGS.

ARCHITECT'S STATEMENT

THESE DRAWINGS AND/OR SPECIFICATIONS AND ALL CALCULATIONS FOR THE ITEMS LISTED HEREIN HAVE BEEN PREPARED BY ME OR UNDER MY CLOSE PERSONAL SUPERVISION AND I AM A LICENSED ARCHITECT AND/OR REGISTERED PROFESSIONAL ENGINEER IN THE STATE OF CALIFORNIA. I HAVE REVIEWED THESE DRAWINGS AND/OR SPECIFICATIONS AND I HAVE FOUND THEM TO BE IN ACCORDANCE WITH THE APPLICABLE CODES, ORDINANCES, REGULATIONS, ETC. AND I HAVE FOUND THEM TO BE IN ACCORDANCE WITH THE APPLICABLE CODES, ORDINANCES, REGULATIONS, ETC. AND I HAVE FOUND THEM TO BE IN ACCORDANCE WITH THE APPLICABLE CODES, ORDINANCES, REGULATIONS, ETC.

DATE: DEC. 31, 2005

Signature of the Architect/Engineer: William J. Melby, Principal, Architect

SHEET INDEX

SHEET	DESCRIPTION
A-111	TITLE SHEET
A-112	ARCHITECTURAL ELECTRICAL
A-113	ARCHITECTURAL ELECTRICAL

ABBREVIATIONS

SYMBOL	DESCRIPTION
S	SEWER
P.O.C.	POINT OF CONNECTION
F.L.	FINISHED GRADE
R.F.	RESTROOM
D.F.	DRINKING FOUNTAIN
F.H.	FIRE HYDRANT
PL	PLACES
(E)	EXISTING

APPLICABLE CODES

- 2001 BUILDING STANDARDS ADMINISTRATIVE CODE PART 1, TITLE 24, CALIFORNIA
- 2001 CALIFORNIA ELECTRICAL CODE PART 2, TITLE 24, C.C.R. (1987 U.F.C. AND 1988 CALIFORNIA AMENDMENTS)
- 2001 CALIFORNIA MECHANICAL CODE PART 3, TITLE 24, C.C.R. (1987 U.F.C. AND 1988 CALIFORNIA AMENDMENTS)
- 2001 CALIFORNIA PLUMBING CODE PART 4, TITLE 24, C.C.R. (1987 U.F.C. AND 1988 CALIFORNIA AMENDMENTS)
- 2001 CALIFORNIA FIRE CODE PART 5, TITLE 24, C.C.R. (1987 U.F.C. AND 1988 CALIFORNIA AMENDMENTS)
- 2001 CALIFORNIA ENERGY CODE PART 6, TITLE 24, C.C.R. (1987 U.F.C. AND 1988 CALIFORNIA AMENDMENTS)
- 2001 CALIFORNIA REFERENCED STANDARDS PART 12, TITLE 24, C.C.R.
- 1989 TITLE 19, C.C.R. PUBLIC SAFETY, STATE FIRE MARSHAL REGULATIONS
- NFPA 13 AUTOMATIC SPRINKLER SYSTEM 1989 EDITION
- NFPA 14 STANDPIPE SYSTEM 1989 EDITION
- NFPA 176 MET CHEMICAL SYSTEM 1984 EDITION
- NFPA 72 NATIONAL FIRE ALARM CODE (CALIFORNIA AMEND) 1999 EDITION
- (NOTE: SEE U.S. STANDARDS 1971 FOR VISUAL DEVICES)
- NFPA 265-CRITICAL FLUID FLOW OF FLOOR CONCRETE SYSTEMS 1984 EDITION
- NFPA 200 CLEAN AGENT FIRE EXTINGUISHING SYSTEMS 1984 EDITION
- REFERENCE CODE SECTION FOR ULTRA STRUCTURES - 2001 (2001) 33041 - 1994 EDITION

BUILDING DATA

UNIT	NEW PORTABLE CLASSROOMS	EXISTING BUILDINGS
UNIT K	24' X 40' = 960 S.F.	10,811 S.F.
UNIT L	24' X 40' = 960 S.F.	14,442 S.F.
UNIT M	24' X 40' = 960 S.F.	6,036 S.F.
UNIT N	24' X 40' = 960 S.F.	3,387 S.F.
UNIT O	24' X 40' = 960 S.F.	2,488 S.F.
UNIT P	24' X 40' = 960 S.F.	3,872 S.F.
UNIT Q	24' X 40' = 960 S.F.	4,320 S.F.
UNIT R	24' X 40' = 960 S.F.	4,320 S.F.
UNIT S	24' X 40' = 960 S.F.	4,320 S.F.
UNIT T	24' X 40' = 960 S.F.	4,320 S.F.
UNIT U	24' X 40' = 960 S.F.	4,320 S.F.
UNIT V	24' X 40' = 960 S.F.	4,320 S.F.
UNIT W	24' X 40' = 960 S.F.	4,320 S.F.
UNIT X	24' X 40' = 960 S.F.	4,320 S.F.
UNIT Y	24' X 40' = 960 S.F.	4,320 S.F.
UNIT Z	24' X 40' = 960 S.F.	4,320 S.F.
TOTAL	72,000 S.F.	72,000 S.F.

APPROVED

DIVISION OF THE STATE ARCHITECT
LOS ANGELES REGIONAL OFFICE
DATE: 7/27/05

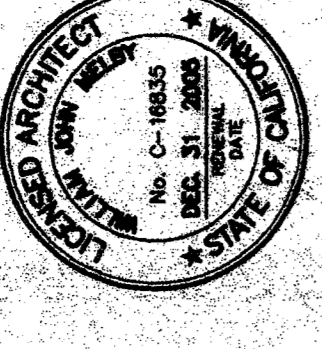

DANNY E. ORDIZ, AIA ARCHITECT C-14728
 WILLIAM J. MELBY, AIA ARCHITECT C-16435
 REGISTRATION STAMP
 DIVISION OF STATE ARCHITECTS
 OFFICE OF REGULATION SERVICES
 JUL 2 2005
 AC 5/16/05
 PLAN: 1, 2, 3, 4, 5, 6
 DATE

PTN: 63321-50
 SITE IMPROVEMENTS
 PORTABLE CLASSROOMS
 AT
 CHIPMAN JUNIOR HIGH SCHOOL
 BAKERSFIELD
 CITY SCHOOL DISTRICT I
 EISSLER STREET
 BAKERSFIELD
 CALIFORNIA
 93306

MARK	DATE	DESCRIPTION
SD		
CD		
A	01-19-15	CCD #01

JOB NUMBER: 2004771
 CAD DRAWING FILE: A-112.AEC
 DRAWN BY: JAH
 CHECKED BY: ENW
 CHECK AND VERIFY DIMENSIONS BEFORE PROCEEDING WITH THE WORK. REPORT DISCREPANCIES TO THE ARCHITECT. THE DRAWING, IDEAS AND DESIGN ARE THE PROPERTY OF THE ARCHITECT.
 COPYRIGHT © 2004 ORDIZ-MELBY ARCHITECTS, INC. 2004

ENLARGED SITE PLAN AND DETAILS
 SHEET IDENTIFICATION NUMBER: **A-112**
 SHEET 02 OF 03

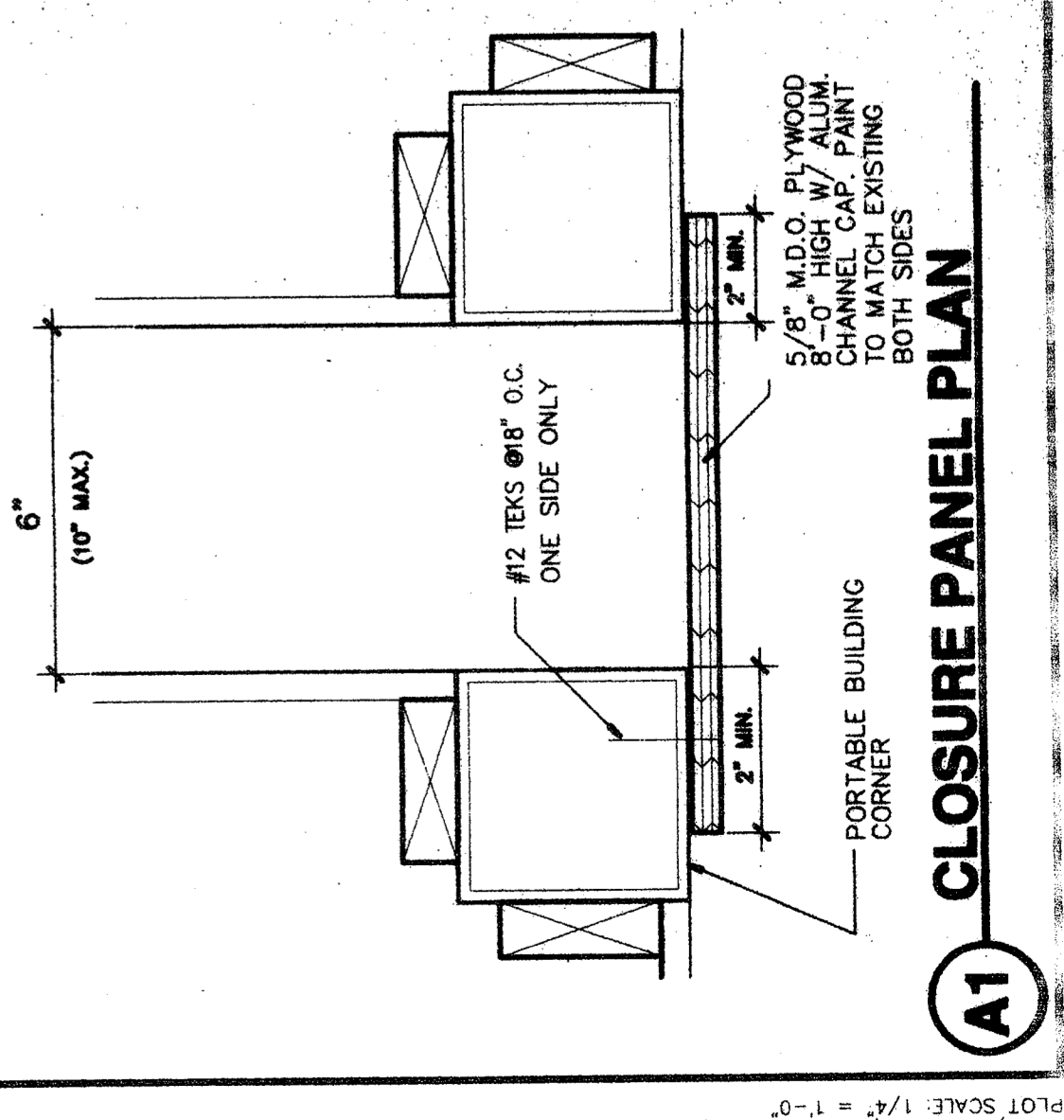
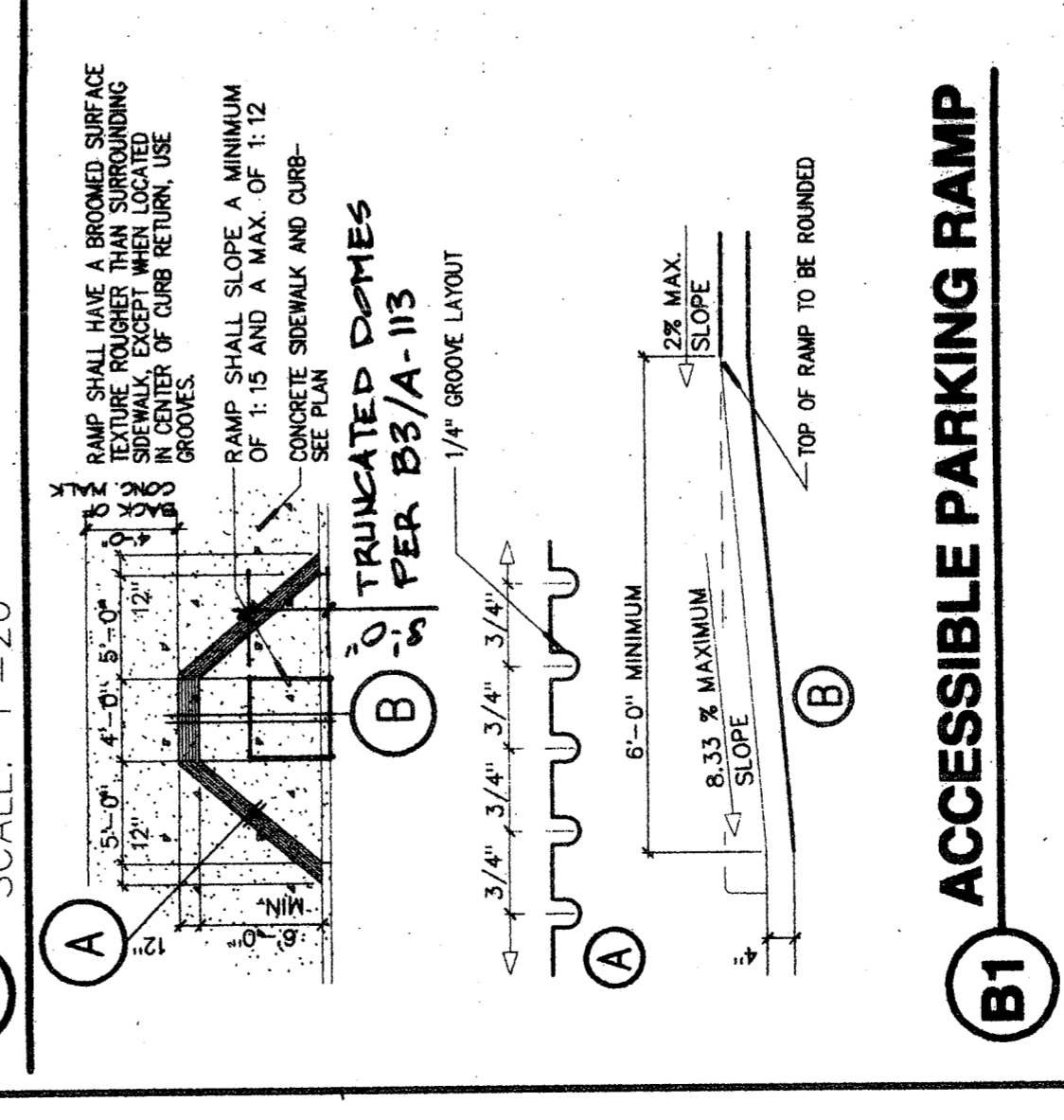
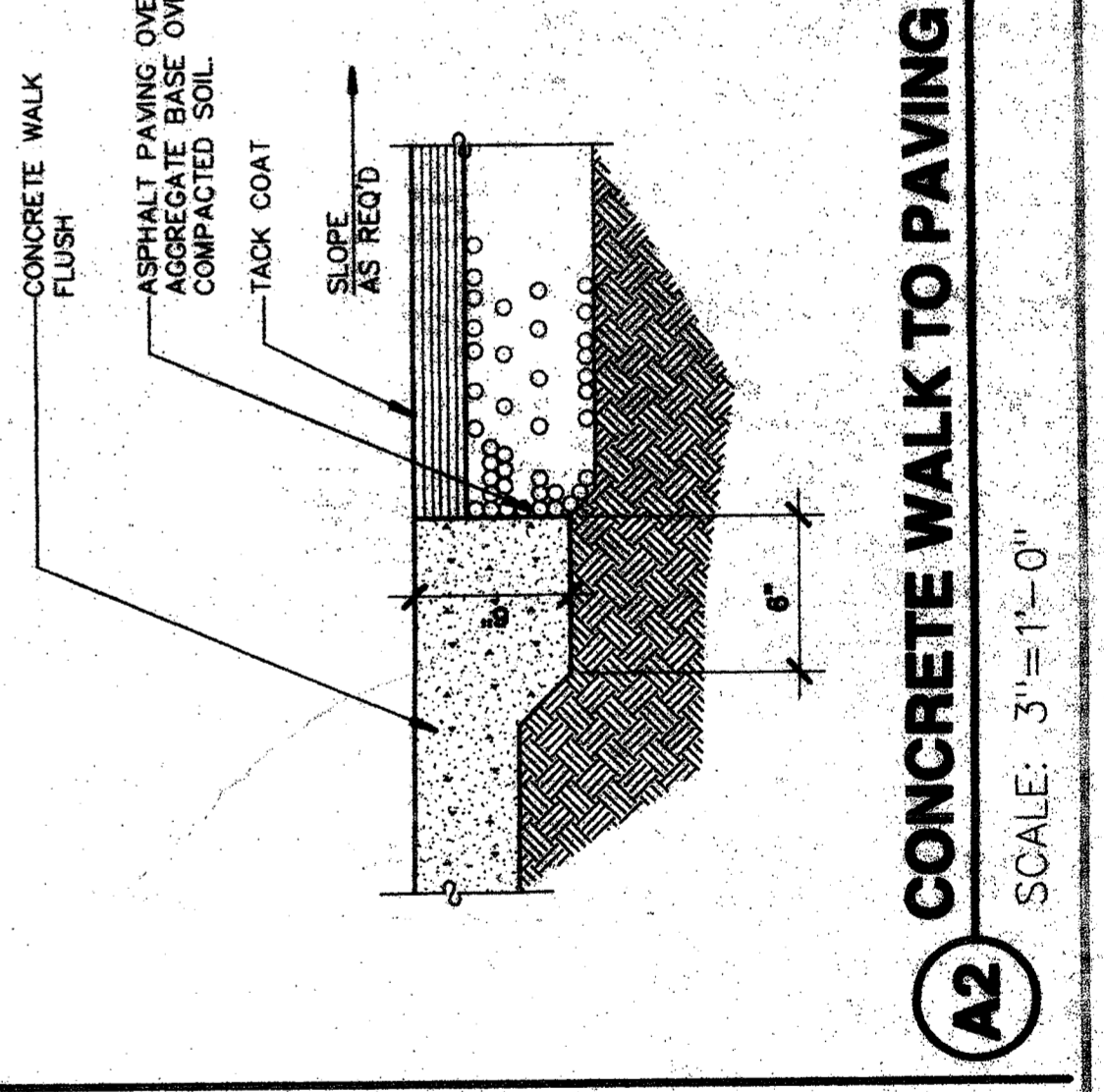
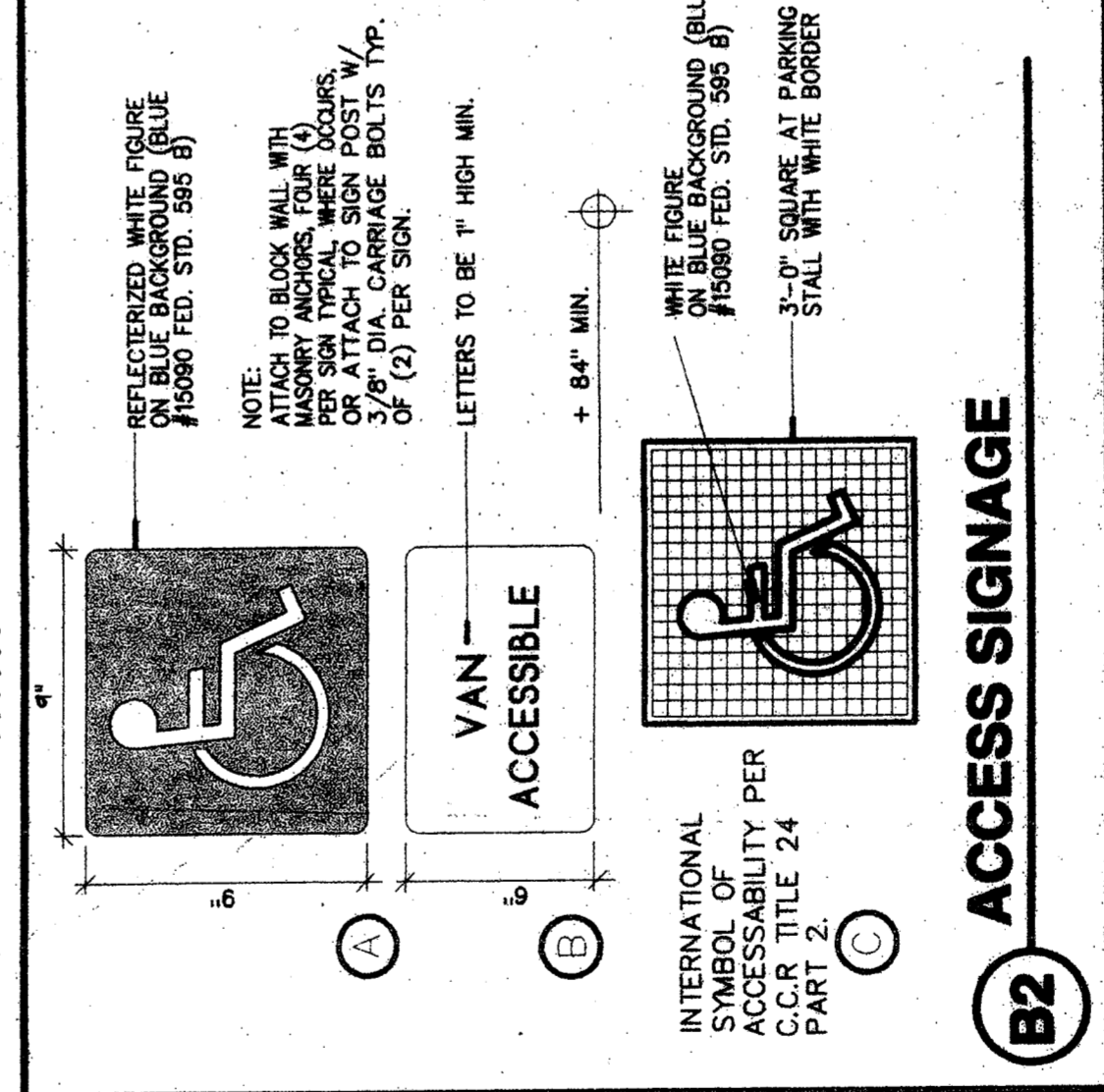
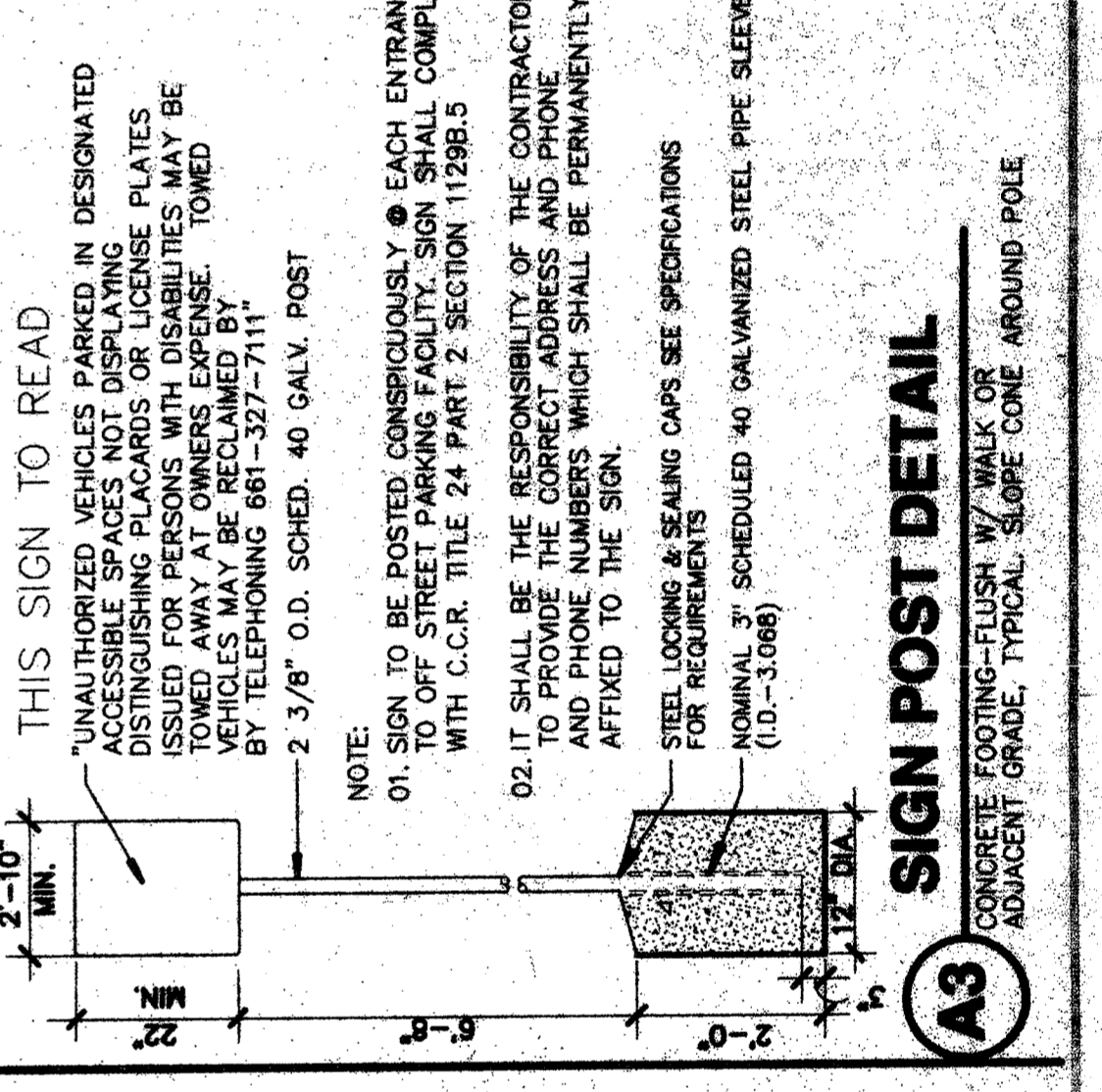
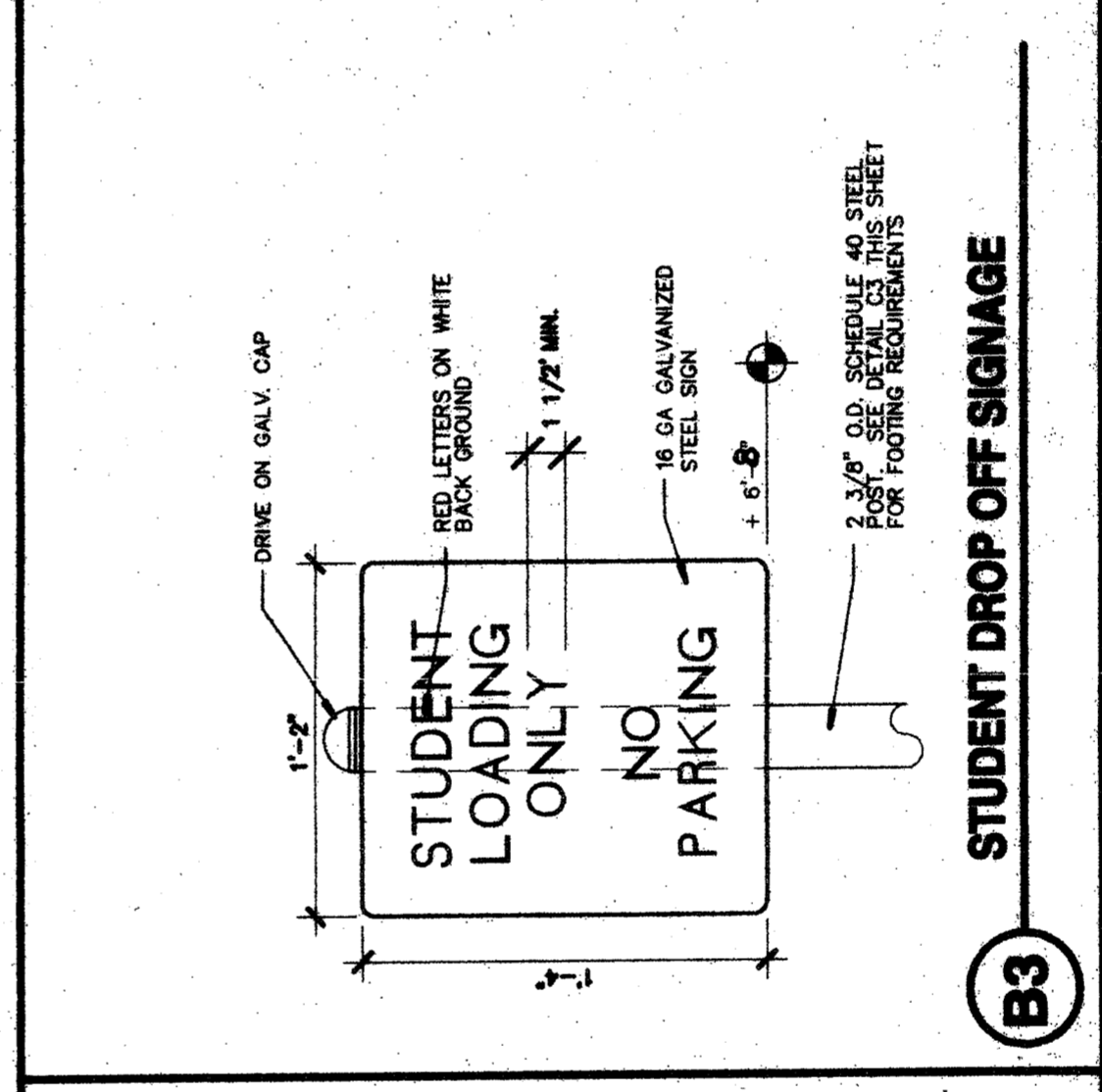
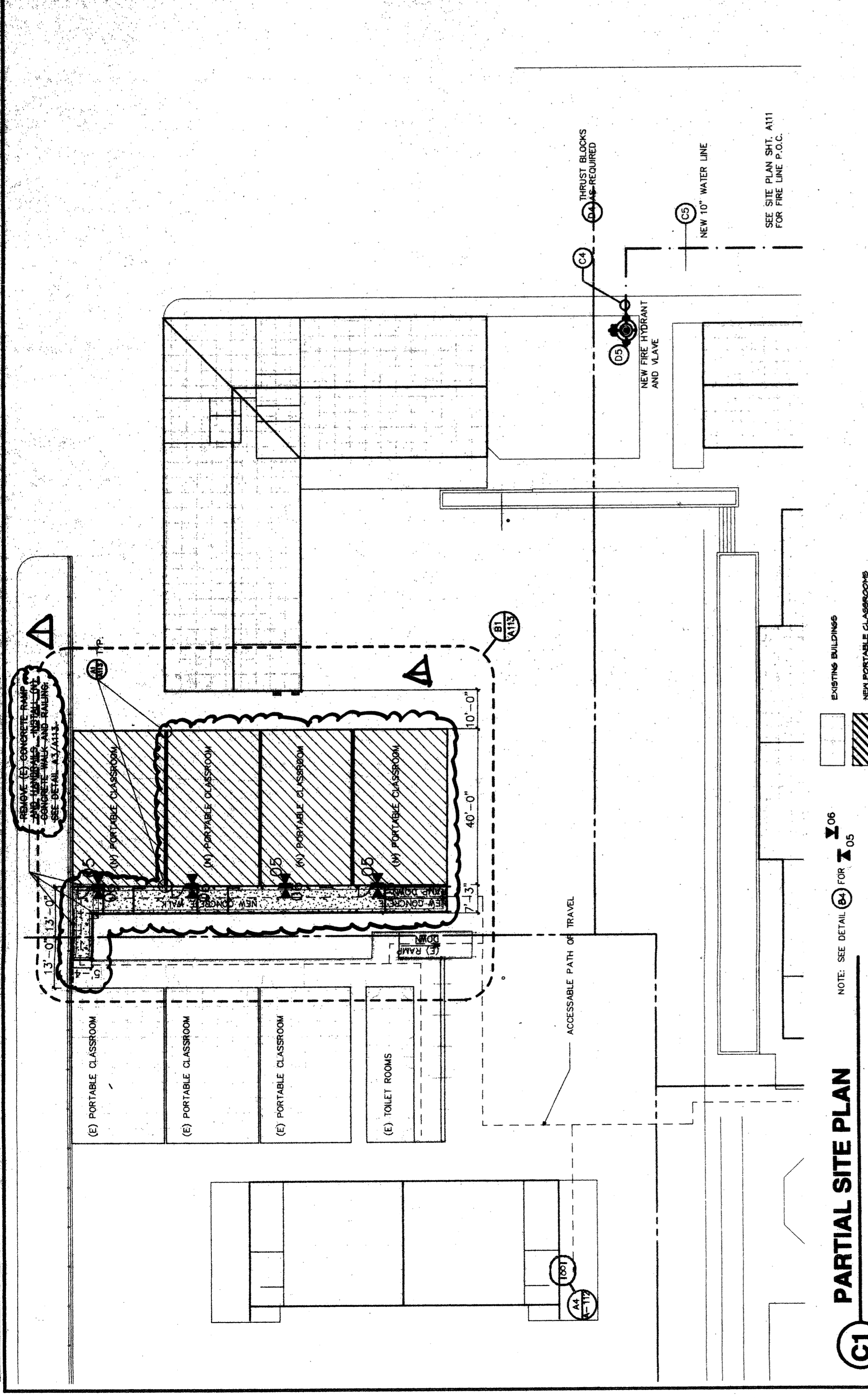
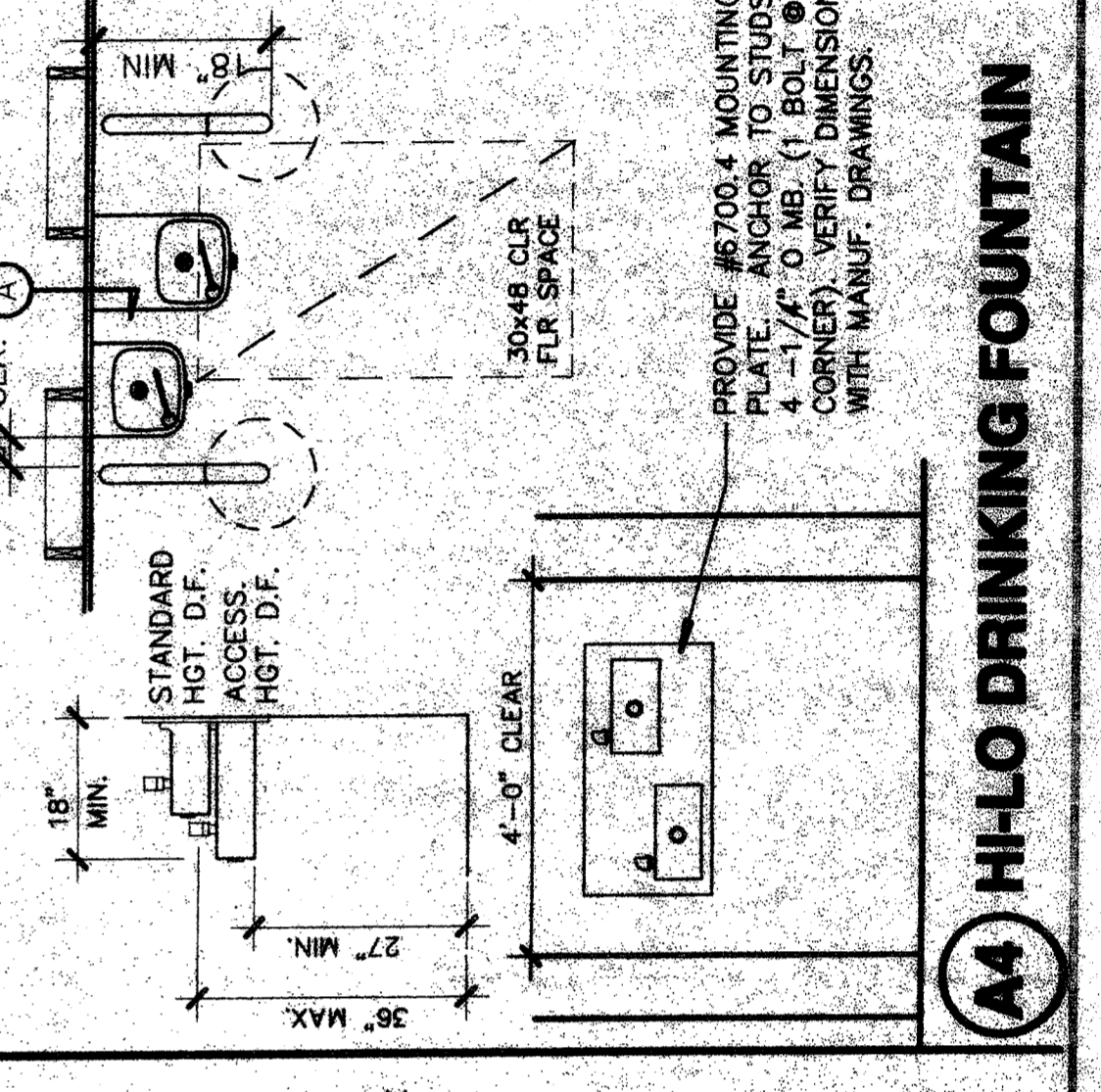
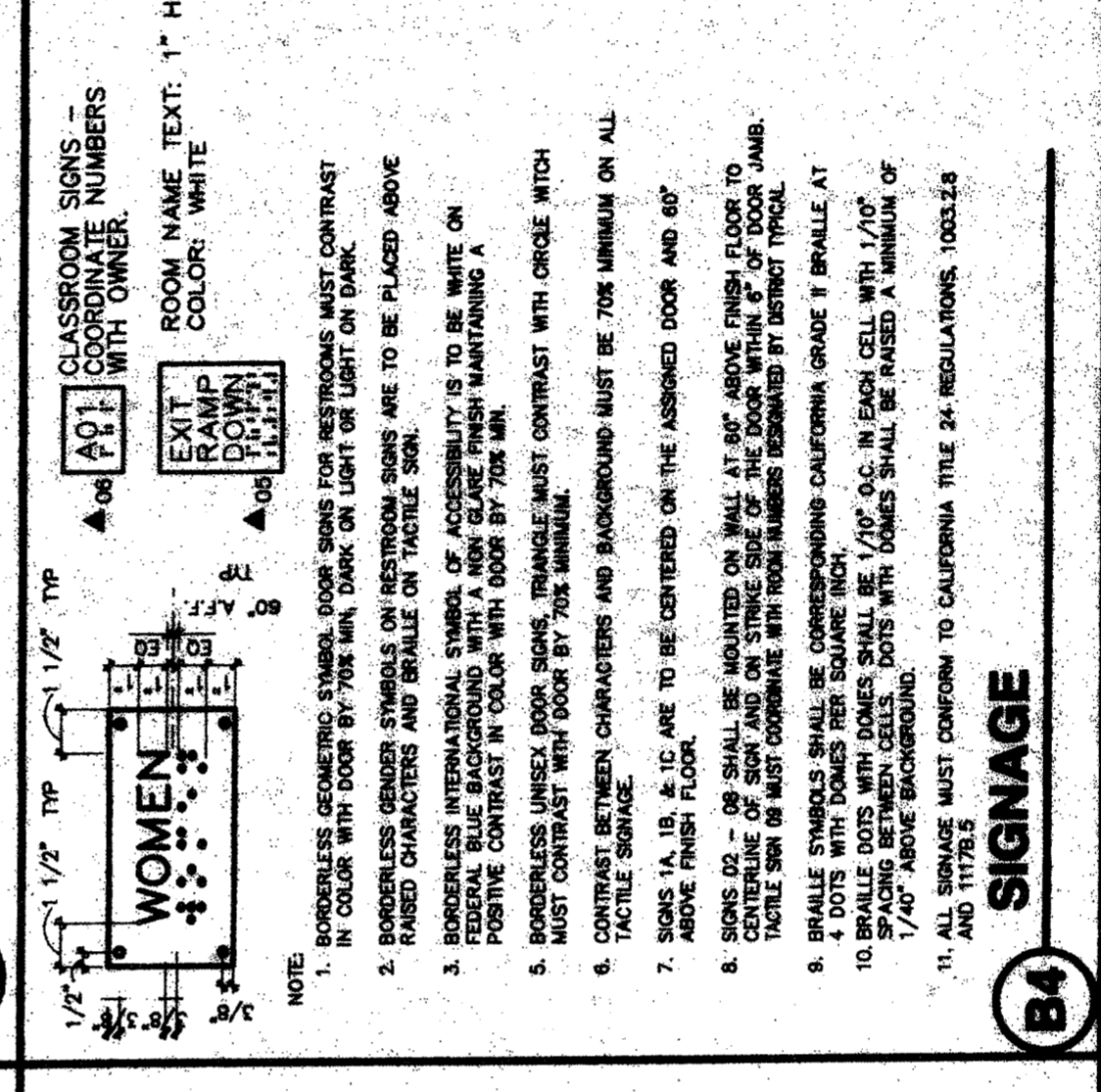
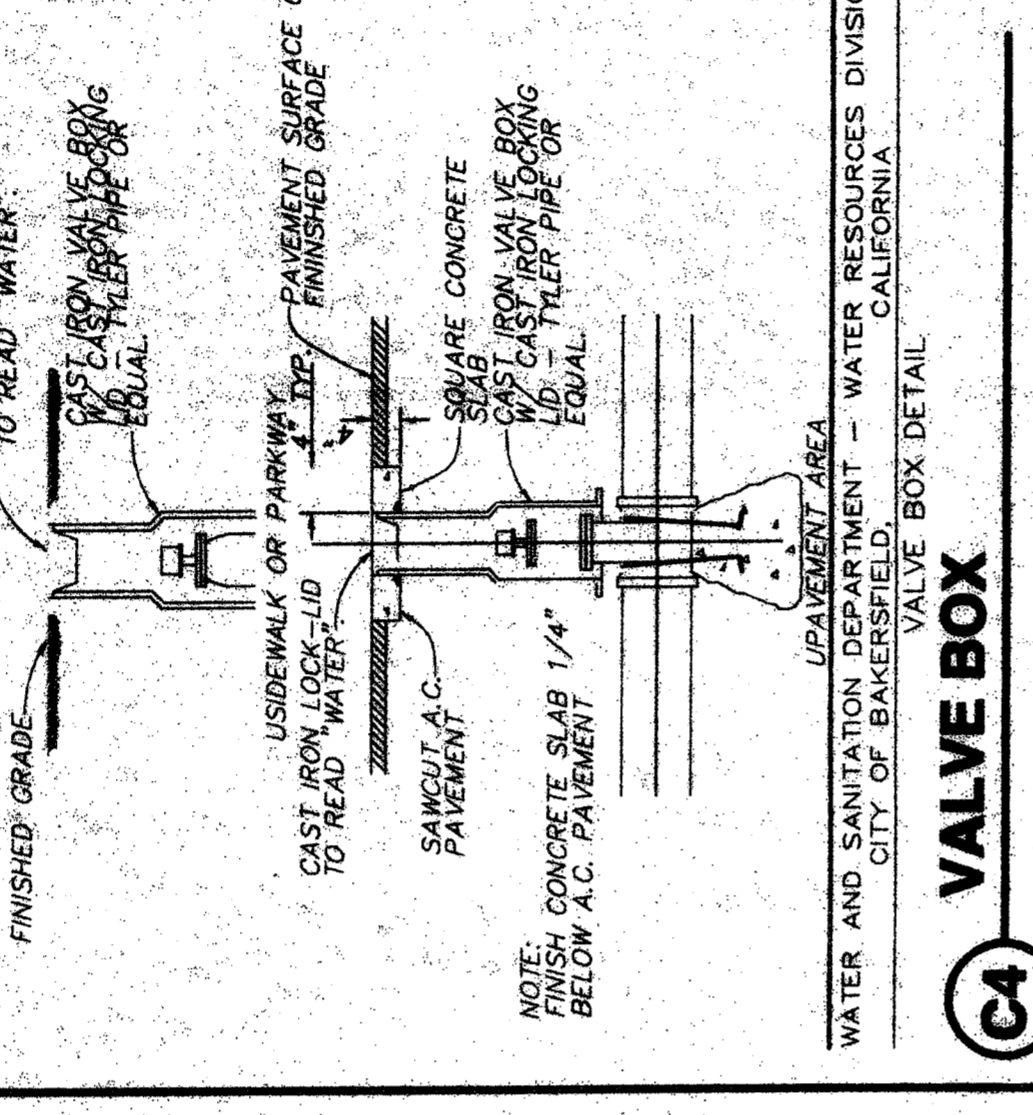
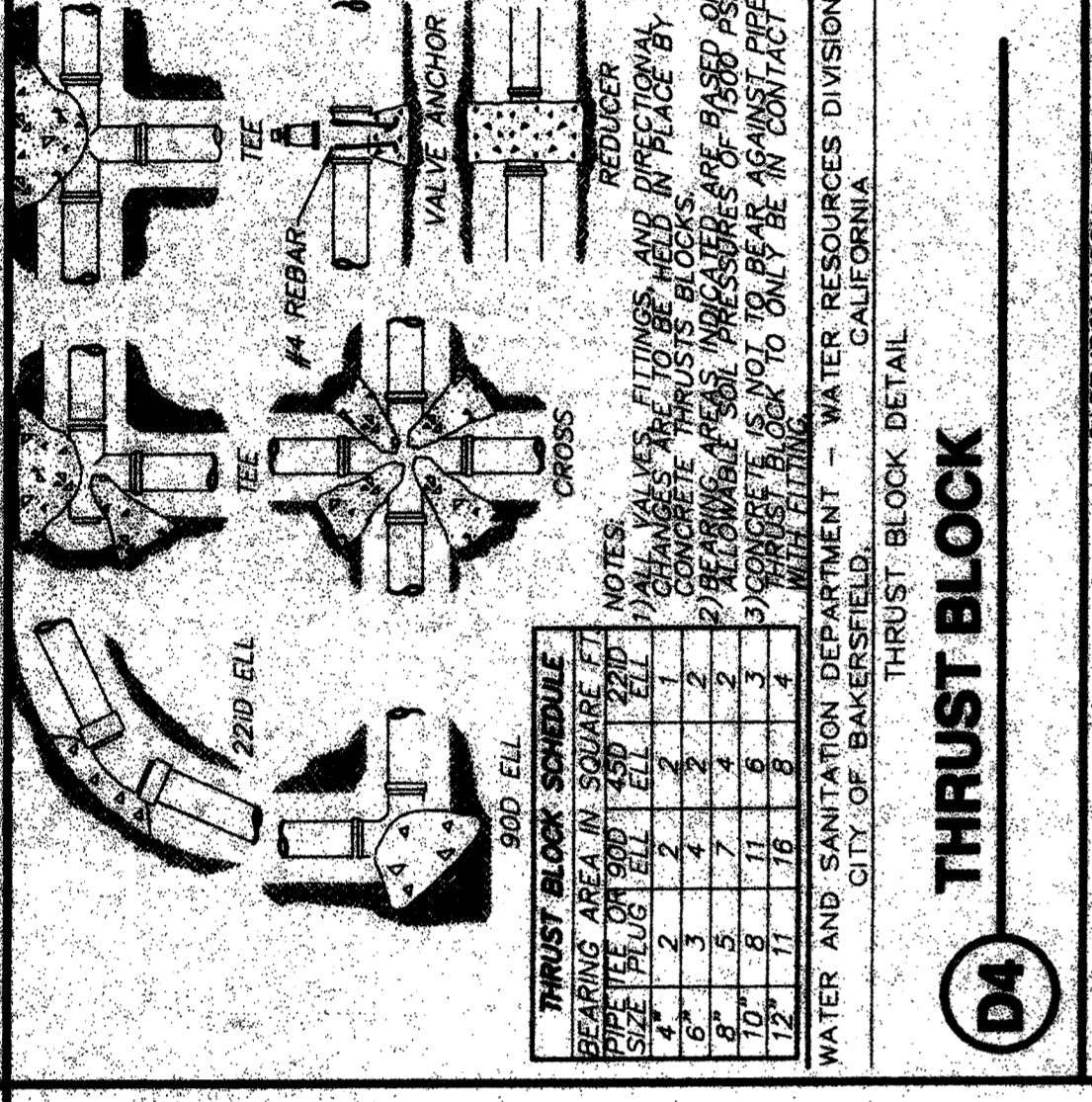
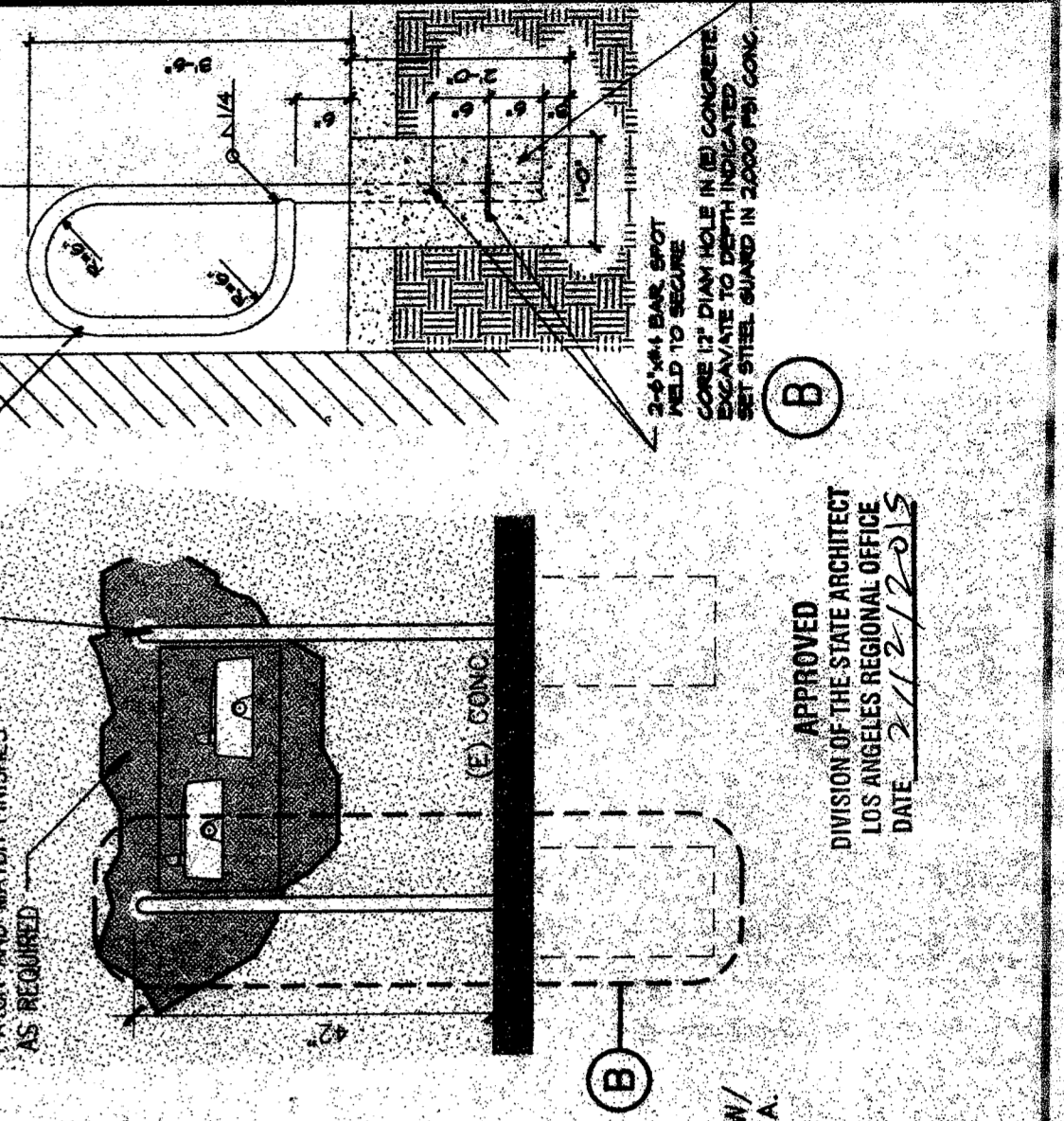
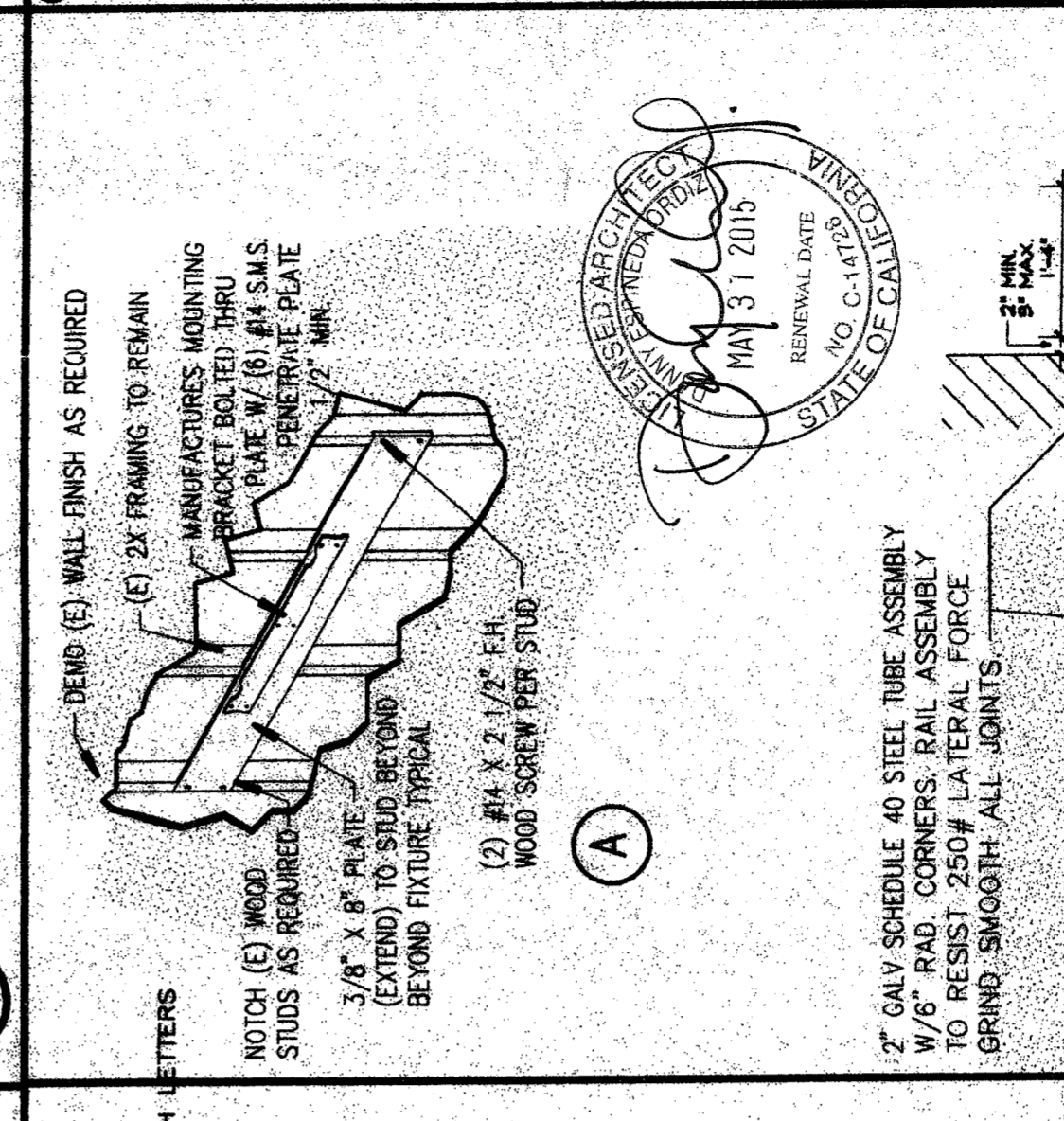
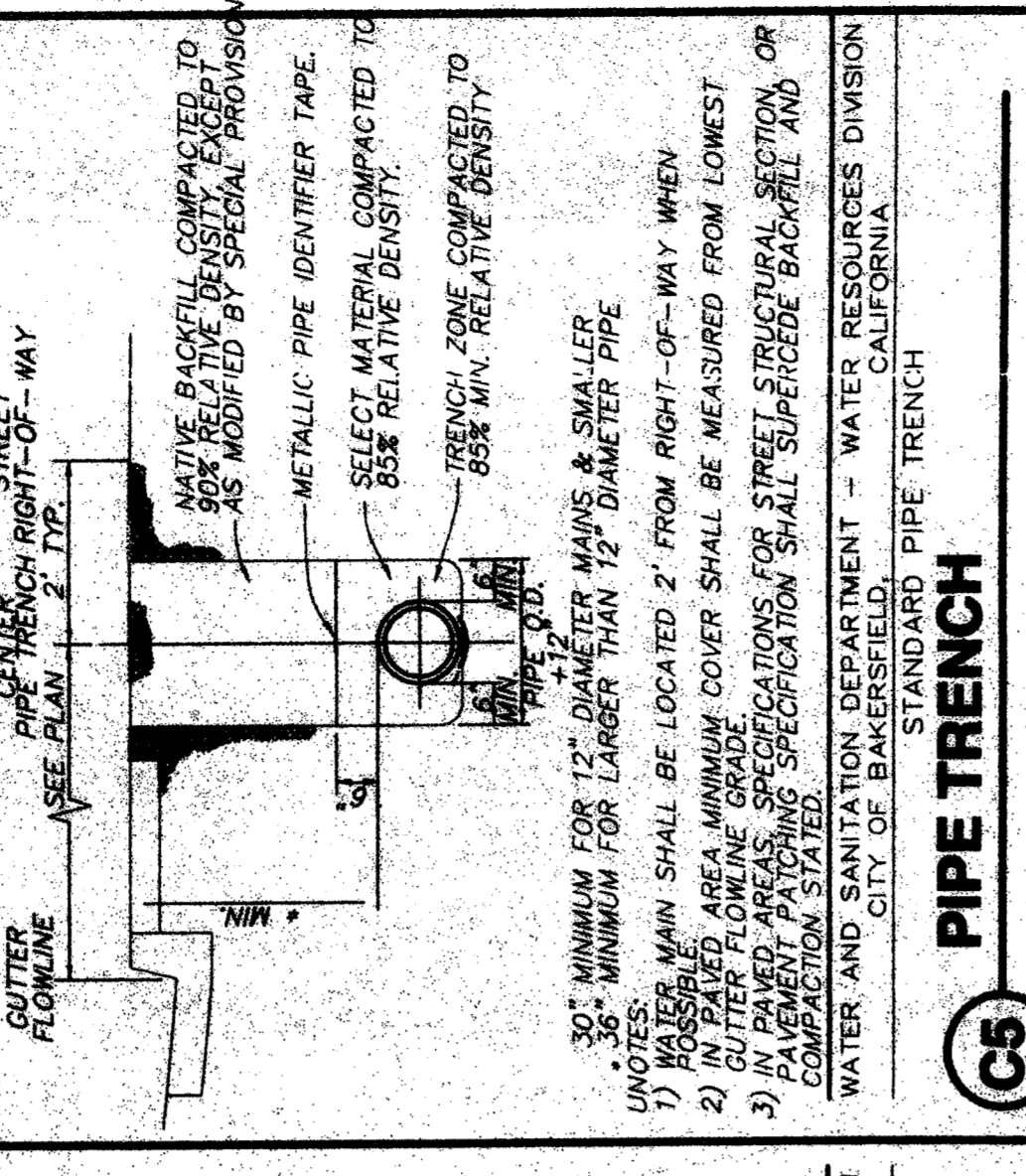
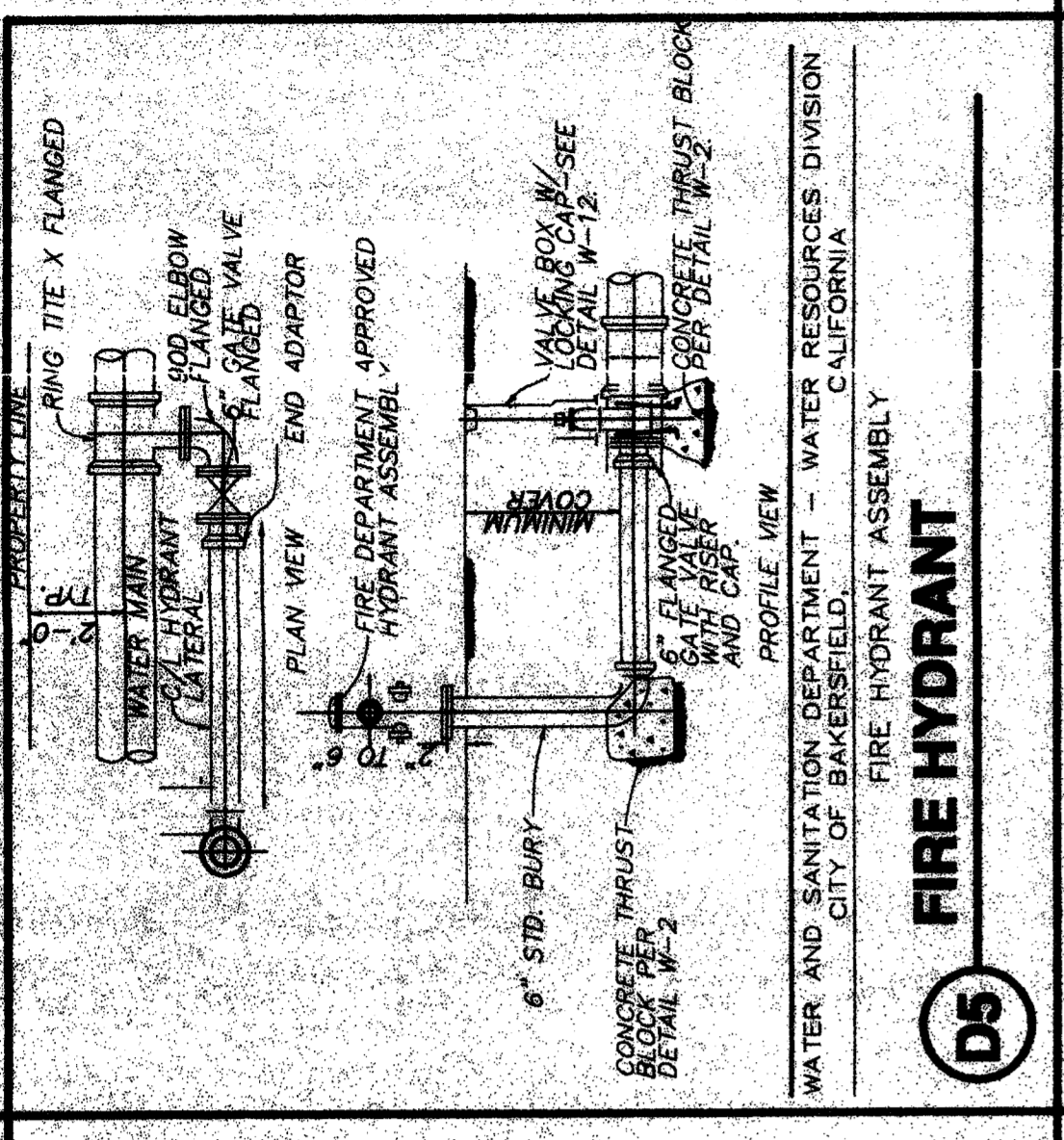

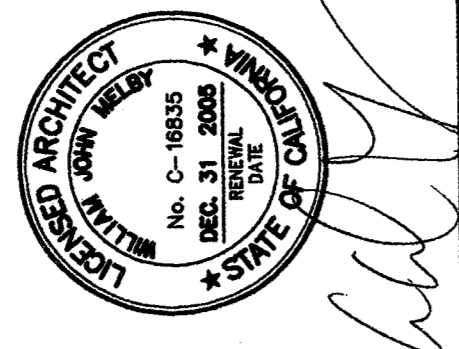

DANNY E. CRDZ, AIA
 ARCHITECT C-14,728
 WILLIAM J. MELBY, AIA
 ARCHITECT C-16,635

IDENTIFICATION STAMP
 DIVISION OF STATE ARCHITECTURE
 OFFICE OF REGULATION SERVICES
 APP 03/10/2004
 FILE #: 03-1-6
 AC 03/10/2004
 DATE JUL 2 6 2005

PTN: 63321-50
 SITE IMPROVEMENTS
 PORTABLE CLASSROOMS
 AT
 CHIPMAN JUNIOR HIGH SCHOOL
 BAKERSFIELD
 CITY SCHOOL DISTRICT

83321-50
 EISSLER STREET
 BAKERSFIELD
 CALIFORNIA
 93306

MARK	DATE	DESCRIPTION
SD		
CD	01-13-15	CCD #01

JOB NUMBER: 2004771
 CAD DRAWING FILE: A-113AEC
 DRAWN BY: JAH
 CHECKED BY: EW
 CHECK ALL DIMENSIONS BEFORE PROCEEDING WITH THE WORK. REPORT DISCREPANCIES TO THE ARCHITECT. THE DRAWINGS, IDEAS AND DESIGN ARE THE PROPERTY OF THE ARCHITECT.

ORDIZ-MELBY ARCHITECTS, INC. 2004
 SHEET TITLE: ENLARGED SITE PLAN AND DETAILS
 SHEET IDENTIFICATION NUMBER: A-113
 SHEET 03 OF 03

