

### SYMBOL LEGEND

- DISCONNECT-GENERAL SWITCH R610-B, 60 AMP.  
NOT REQUIRED ON A/C UNITS WITH INTERNAL DISCONNECT BREAKER
- PULL STATION @ +48" A.F.F.
- EXT. HORN @ +7'-0" A.F.F.
- 110V RECEPTACLE 20 AMP.  
HOSP. GRADE @ +15" A.F.F.
- SWITCH @ +42" A.F.F.
- THERMOSTAT @ +48" A.F.F.
- CLOCK @ +8'-0"
- EXTERIOR LIGHT- SEE FIXTURE SCHEDULE

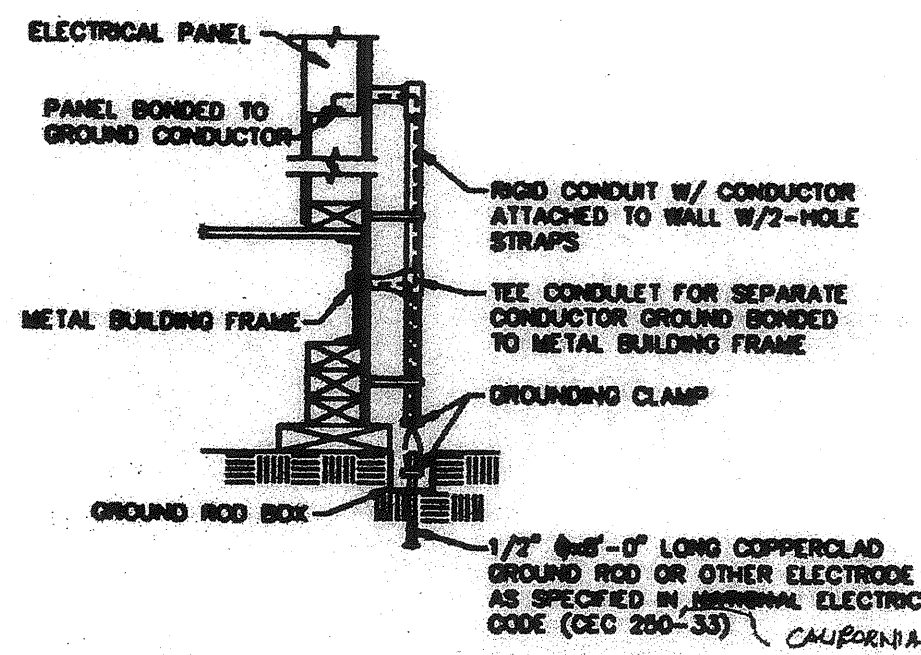

- NOTES:**
1. SIZE OF CONDUCTORS SHALL COMPLY W/CEC TABLE 250-85.
  2. BOND SEPARATE CONDUCTORS FROM GROUND ROD TO ELECTRICAL PANEL & TO METAL BUILDING FRAME (SEE 250-81) IN ADDITION TO THE DETAIL SHOWN ABOVE. BOND THE ELECTRICAL GROUND TO METAL WATER PIPE EMBEDDED AT LEAST 10 FT. INTO THE SOIL IF AVAILABLE (CEC 250-81 & 250-83).
  3. ALL MODULES OF METAL FRAME BUILDINGS SHALL BE ELECTRICALLY BONDED TOGETHER (INCLUDING ONLY IS NOT ACCEPTABLE BONDING), INCLUDING RAMP TO STEEL FRAME.
  4. CHECK RESISTANCE TO GROUND. IF RESISTANCE EXCEEDS 25 OHMS, INSTALL ADDITIONAL GROUND RODS W/CONDUCTORS AS SHOWN, SEPARATED AT LEAST 6'-0" UNITS. RESISTANCE IS REDUCED TO 25 OHMS OR LESS (CEC 250-84).
  5. PROJECT INSPECTOR SHALL WITNESS GROUNDING TEST.

### ACCEPTABLE GROUNDING DETAIL

BY OWNER

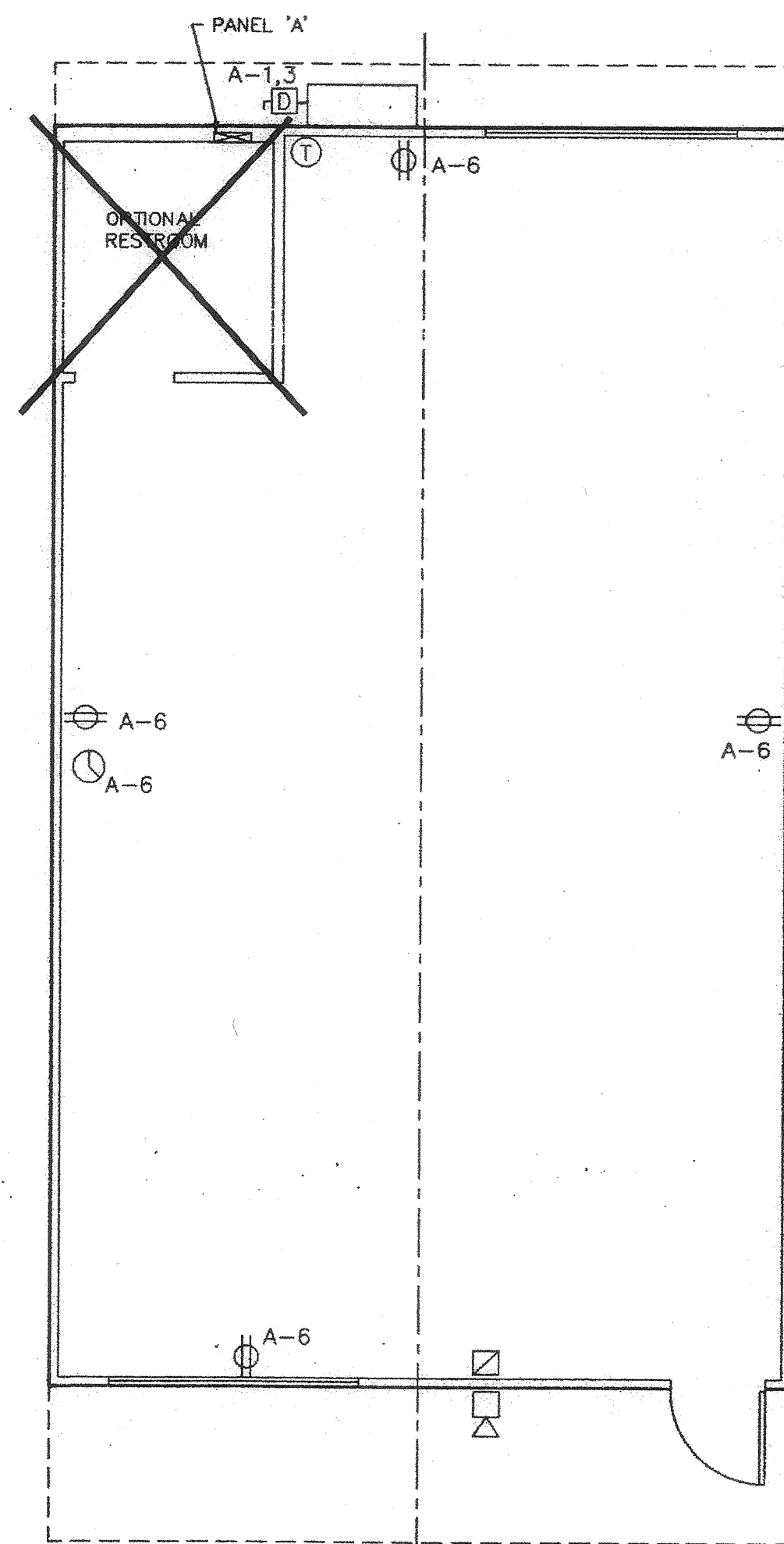

ELECTRICAL POWER PLAN

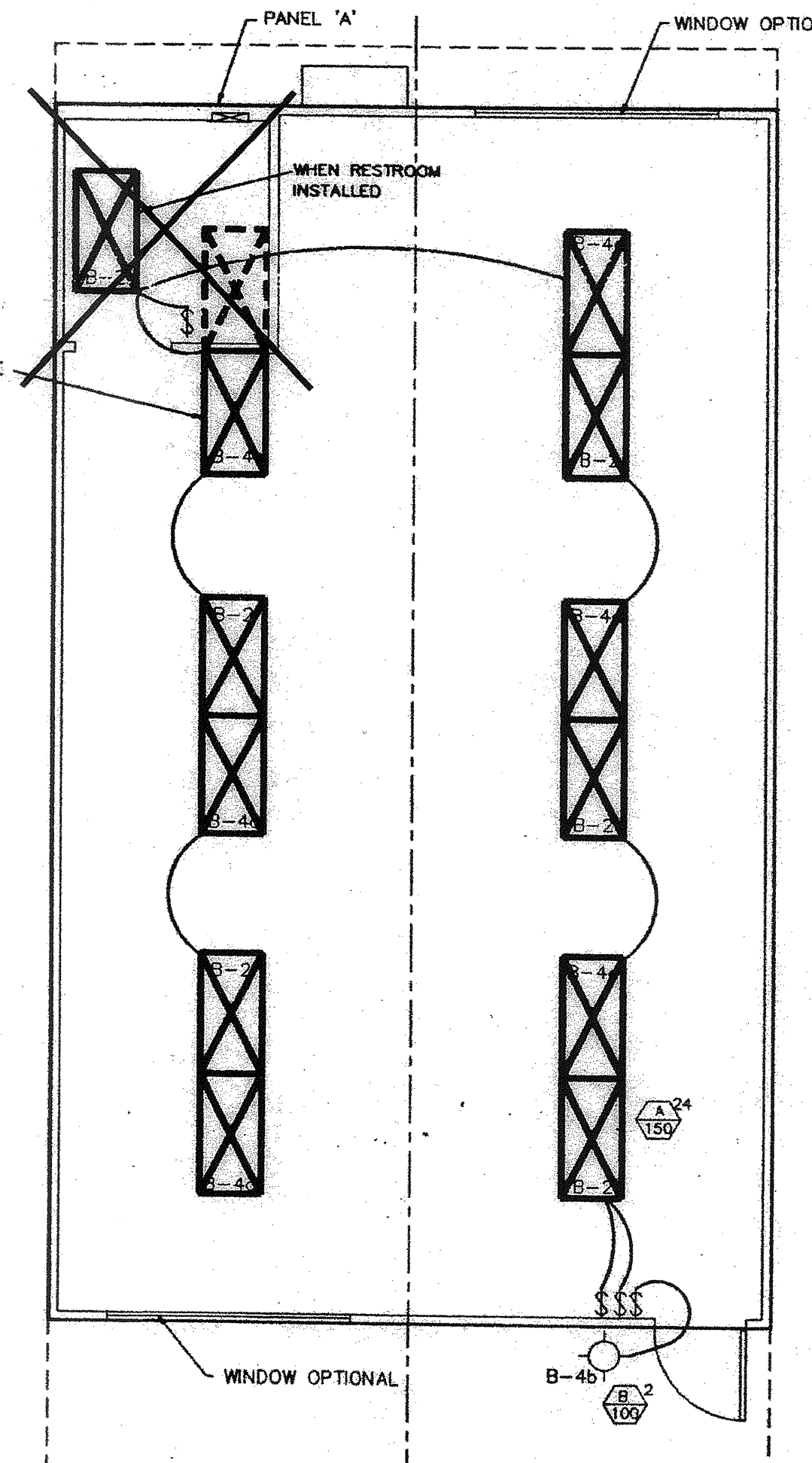

ELECTRICAL LIGHTING PLAN

IDENTIFICATION STAMP  
DIV. OF THE STATE ARCHITECT

APPO3 117549  
AGW/FLS/MS/TH  
Date OCT 14 2010

- NOTES:**
1. FIRE ALARM SYSTEM SHALL COMPLY W/ TITLE 24 SEC. 305.8, TITLE 24, PART 3, ARTICLE 700 OF THE CALIFORNIA CODE OF REGULATIONS AND CALIFORNIA FIRE REGULATIONS, ARTICLE 10.
  2. INSTALLATION OF FIRE ALARM SYSTEM SHALL NOT BE STARTED UNTIL DETAIL PLANS, SPECIFICATIONS AND ENGINEERING CALCULATIONS HAVE BEEN ACCEPTED AND SIGNED BY THE ARCHITECT OR STRUCTURAL ENGINEER IN GENERAL CHARGE OF DESIGN AND THE SIGNATURE OF THE ARCHITECT OR PROFESSIONAL ENGINEER WHO HAS BEEN DELEGATED RESPONSIBILITY COVERING THE WORK SHOWN ON A PARTICULAR PLAN OR SPECIFICATION AND APPROVED BY THE OFFICE OF THE STATE ARCHITECT AND STATE FIRE MARSHAL.

PANELBOARD SCHEDULE W/ OPTIONAL WATER HEATER PANEL A(1)													PANELBOARD SCHEDULE PANEL A												
VOLTS 120/240 PHASE 1 BUSS 100 A FEED BOTTOM						VOLTS 120/240 PHASE 1 BUSS 100 A FEED BOTTOM						VOLTS 120/240 PHASE 1 BUSS 100 A FEED BOTTOM						VOLTS 120/240 PHASE 1 BUSS 100 A FEED BOTTOM							
DESCRIPTION	WATTS	WIRE SIZE	BREAKER	POLE	CONDUIT	DESCRIPTION	WATTS	WIRE SIZE	BREAKER	POLE	CONDUIT	DESCRIPTION	WATTS	WIRE SIZE	BREAKER	POLE	CONDUIT	DESCRIPTION	WATTS	WIRE SIZE	BREAKER	POLE	CONDUIT		
MAIN BRKR	100 A	3	---	---	---	MAIN BRKR	100 A	3	---	---	---	MAIN BRKR	100 A	3	---	---	---	MAIN BRKR	100 A	3	---	---	---		
DESCRIPTION	WATTS	WIRE SIZE	BREAKER	POLE	CONDUIT	DESCRIPTION	WATTS	WIRE SIZE	BREAKER	POLE	CONDUIT	DESCRIPTION	WATTS	WIRE SIZE	BREAKER	POLE	CONDUIT	DESCRIPTION	WATTS	WIRE SIZE	BREAKER	POLE	CONDUIT		
HVAC 3.5 TON	4392	8	50	2	12	HVAC 3.5 TON	4392	8	50	2	12	HVAC 3.5 TON	4392	8	50	2	12	HVAC 3.5 TON	4392	8	50	2	12		
OPTIONAL WATER HEATER	1400	12	20	1	5	1080 LIGHTS/PORCH	1080	---	---	---	---	RECEPT	720	---	---	---	---	RECEPT	720	---	---	---	---		
SUB TOTAL												SUB TOTAL													
LOAD KW	L.C.L. = L.C.L x 1.25 = 16155					TOTAL LOAD	L.C.L. = L.C.L x 1.25 = 13605					TOTAL LOAD	L.C.L. = L.C.L x 1.25 = 13605												
A	8072					CONN	7400 AMPS					A	8072												
B	6852					MAX DEMAND	92.50 AMPS					B	5452												
TOT	12924					MAX DEMAND	16875					TOT	11524												

TYPE	SYMBOL	DESCRIPTION	WATTS	MANUFACTURER
750		2' x 4' FLUORESCENT DROP-IN LIGHT FIXTURE, ACRYLIC PRISMATIC LENS, ENERGY SAVING BALLAST, (4) 35 WATT TUBES. WEIGHT- 27 lbs	150 WATTS	
100		INCANDESCENT SURFACE MOUNTED EXTERIOR LIGHT FIXTURE WITH IMPACT RESISTANT ENCLOSURE.	100 WATTS	

THE DRAWINGS AND THE MATERIAL COVERED THEREIN ARE THE PROPERTY OF MSI, INC. AND SHALL NOT BE REPRODUCED, COPIED, OR OTHERWISE DISPOSED OF IN WHOLE OR IN PART TO ASSIST IN THE MAKING OF OR FOR THE PURPOSE OF FURNISHING ANY INFORMATION OR PARTS THEREOF WITHOUT THE FULL KNOWLEDGE AND WRITTEN CONSENT OF MSI, INC. ALL PATENTABLE AND WRITABLE INVENTIONS AND RIGHTS HEREIN ARE RESERVED AND WILL REMAIN THE PROPERTY OF MSI, INC. ANY MATERIAL CONTAINED HEREIN AND ORIGINATING WITH MSI, INC. SHALL BE THE PROPERTY OF MSI, INC.

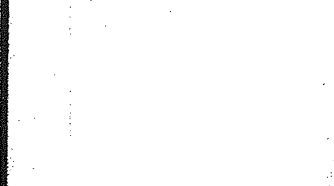
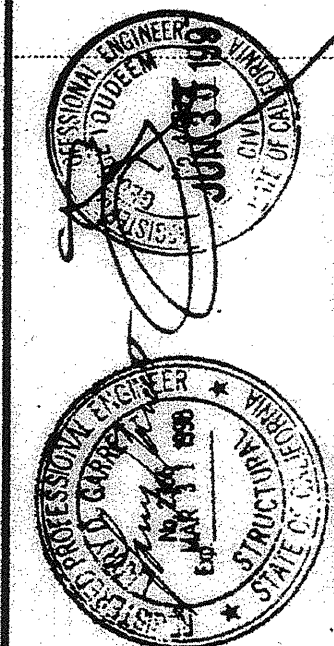

REGENCY ENGINEERING & CONSULTING GROUP  
17165 VON KARMAN, SUITE # 108  
IRVINE, CALIFORNIA 92614  
TELEPHONE (714) 953-3799  
FAX (714) 953-3795

STATE AGENCY APPROVAL  
DATE: APR 8 5 05  
APPROVED BY: [Signature]

STATE AGENCY APPROVAL  
DATE: APR 20 2010  
APPROVED BY: [Signature]

STATE AGENCY APPROVAL  
DATE: APR 20 2010  
APPROVED BY: [Signature]

<b>MSI</b> MODULAR STRUCTURES INTERNATIONAL, INC. 800 CROWN AVE. EVANSTON, CALIFORNIA 94507 PHONE: (909) 798-3035 FAX: (909) 798-1883	
ARCHITECT APPROVAL REGENCY ENGINEERING & CONSULTING GROUP 17165 VON KARMAN, SUITE # 108 IRVINE, CALIFORNIA 92614 TELEPHONE (714) 953-3799 FAX (714) 953-3795 A SUBSIDIARY OF REGENCY COMPANY, INC.	PROJECT 24'X40' MODULAR CLASSROOM BUILDING TITLE ELECTRICAL LIGHTING PLAN ELECTRICAL POWER PLAN PANEL SCHEDULE
STATE AGENCY APPROVAL JOB # 96-1310 DATE 11/21/96 DRAWN BY SCALE APPROVED	REVISIONS 2/4/97 3/17/97 DSA REV. 3/24/97 MSI REV. 3/31/97 MSI REV. 4/25/97 MSI REV.
PLOT DATE: 04/28/97 SHEET NO. <b>E-1-24</b>	<b>PC-323</b>