

CHARGER STREET

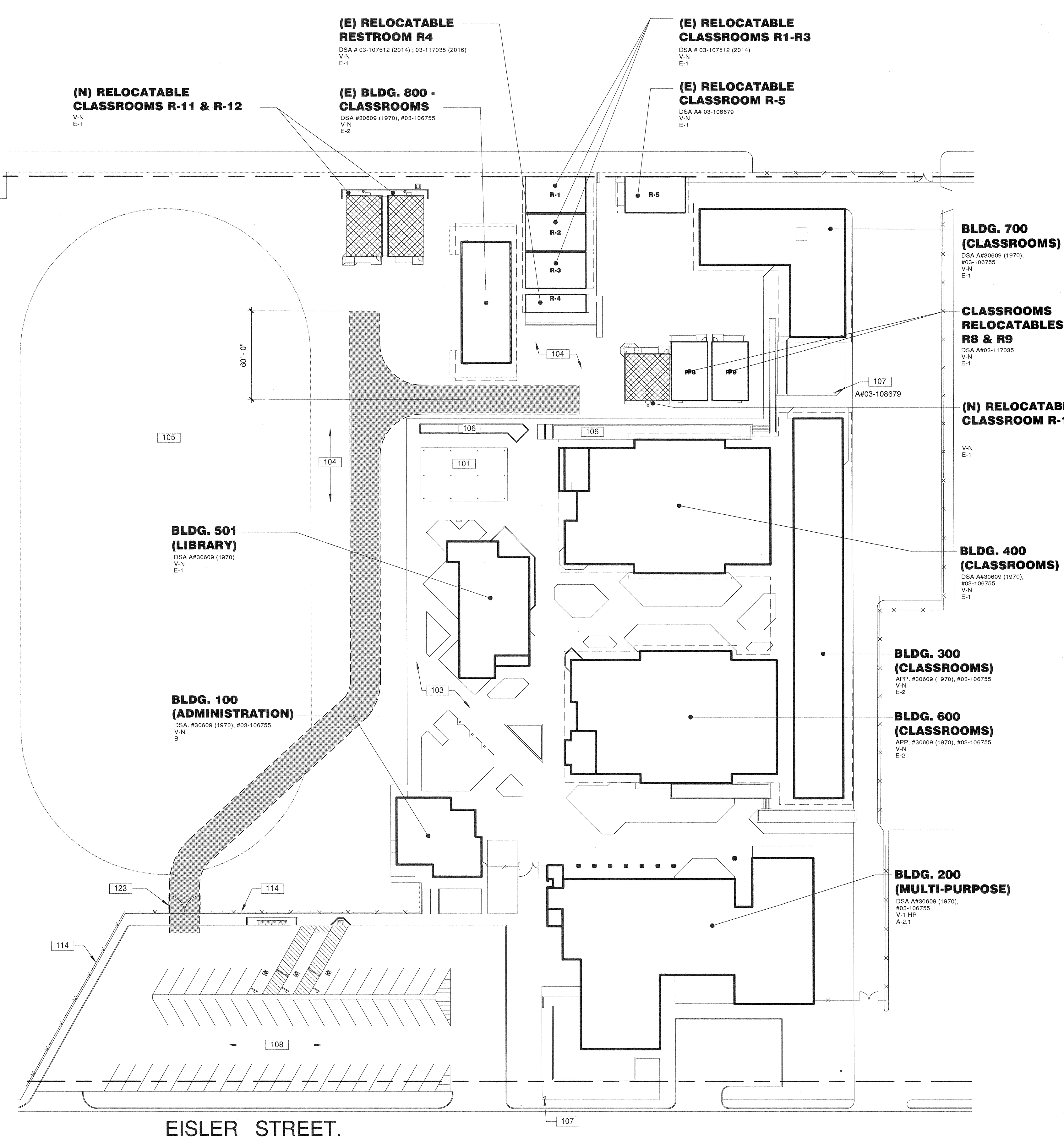

**SITE PLAN**

EISLER STREET.

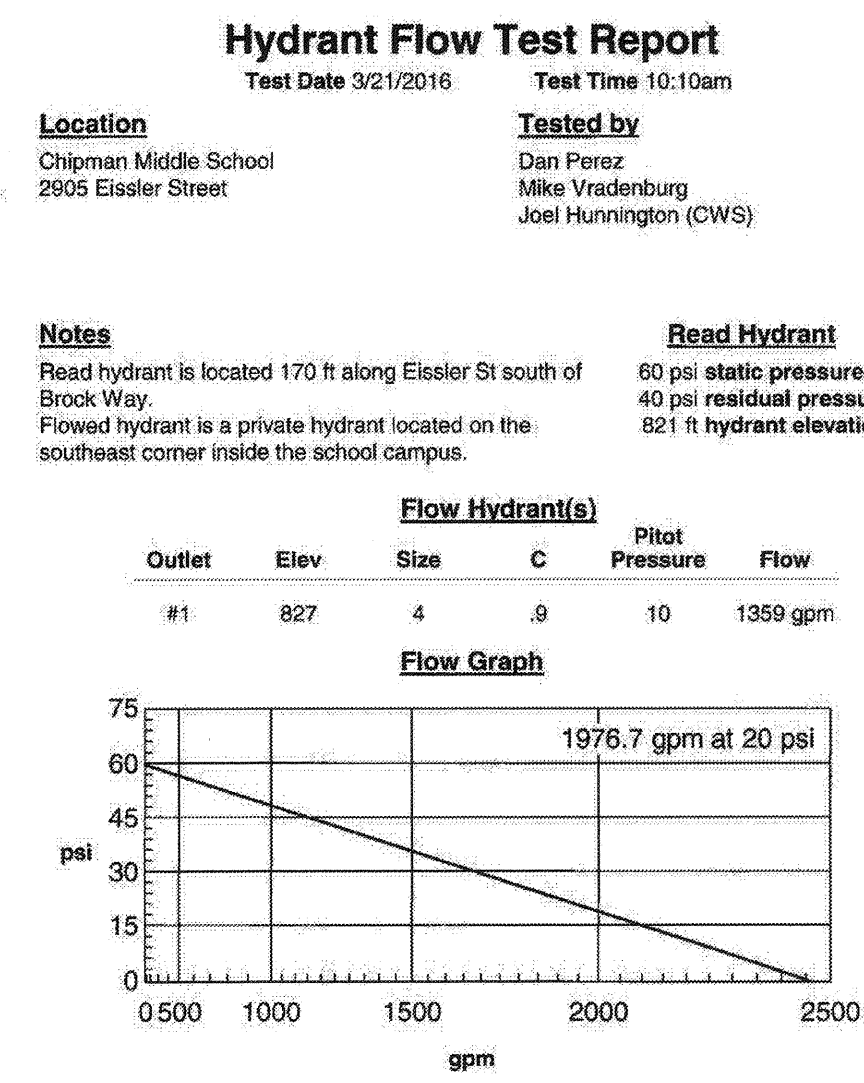
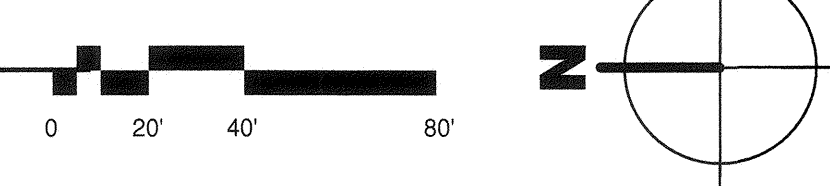

**100-GENERAL NOTES**

- THESE DRAWINGS INDICATE THE APPROXIMATE EXTENT OF DEMOLITION WORK. CONTRACTOR IS RESPONSIBLE FOR DETERMINING THE EXTENT OF DEMOLITION REQUIRED TO INSTALL IMPROVEMENTS INDICATED ON THE CONSTRUCTION DOCUMENTS.
- ALL MATERIAL INDICATED TO BE REMOVED IS TO BE DISPOSED OF OFF-SITE IN A LEGAL MANNER, UNLESS INDICATED TO BE SALVAGED OR REINSTALLED.
- PRIOR TO ANY UNDERGROUND SITE WORK, VERIFY LOCATION OF ALL EXISTING UTILITIES WITH UNDERGROUND SERVICE ALERT (U.S.A.)
- CONTRACTOR SHALL REPLACE IN KIND ANY EXISTING IMPROVEMENTS DAMAGED BY DEMOLITION OR CONSTRUCTION ACTIVITIES.

**100 - KEYNOTES**

- (E) COVERED LUNCH AREA TO REMAIN.
- (E) CONCRETE FLATWORK TO REMAIN.
- (E) ASPHALT PAVING TO REMAIN.
- (E) TURF AREA TO REMAIN.
- (E) LANDSCAPE PLANTER TO REMAIN.
- (E) FIRE HYDRANT TO REMAIN.
- (E) PARKING & ENTRY SIGN PER A# 03-117035.
- (E) CHAINLINK FENCE AND/OR GATE TO REMAIN.
- (E) 20'-0" WIDE DRIVE APPROACH AND PAIR OF 10'-0" WIDE GATES FOR FIRE DEPARTMENT ACCESS.

**LEGEND**

- NOTE: ITEMS IN THIS LIST MAY NOT NECESSARILY OCCUR ON THIS SHEET
- RELOCATABLE CLASSROOM BUILDINGS TO BE CONSTRUCTED AS PART OF THIS DSA APPLICATION NUMBER AND CONTRACT.
  - A.C. PAVING, SEE CIVIL PLAN FOR EXTENT OF SCOPE
  - EXISTING BUILDING AND/OR PORTABLES NOT A PART OF THIS DSA APPLICATION NUMBER AND CONTRACT.
  - EXISTING ACCESSIBLE STUDENT OR STAFF RESTROOM PER DSA APPLICATION INDICATED ON PLANS (S-STAFF, M-MEN, W-WOMEN, B-BOYS, G-GIRLS, U-UNISEX STUDENT, N-NURSE) PREVIOUSLY APPROVED UNDER A#03-117283. SEE SHEET A1.14.
  - LANDSCAPE AREA TO REMAIN, REMOVE EXISTING IRRIGATION SYSTEM FROM SERVICE THIS AREA
  - FIRE DEPARTMENT ACCESS, 20'-0" MIN.
  - DENOTES ACCESSIBLE PATH OF TRAVEL, COMPLYING WITH DESIGN PROFESSIONAL STATEMENT BELOW
  - Design Professional in General Responsible Charge Statement:** The POT identified in these construction documents is compliant with the current applicable California Building Code accessibility provisions for path of travel requirements for alterations, additions and structural repairs. As part of the design of this project, the POT was examined and any elements, components or portions of the POT that were determined to be noncompliant 1) have been identified and 2) the corrective work necessary to bring them into compliance has been included within the scope of this project's work through details, drawings and specifications incorporated into these construction documents. Any noncompliant elements, components or portions of the POT that will not be corrected by this project based on valuation threshold limitations or a finding of unreasonable hardship are so indicated in these construction documents. During construction, if POT items within the scope of the project represented as code compliant are found to be nonconforming beyond reasonable construction tolerances, they shall be brought into compliance with the CBC as a part of this project by means of a construction change document.
  - ACCESSIBLE BUILDING ENTRANCE
  - PROPERTY LINE
  - ASSUMED PROPERTY LINE

PRIME CONSULTANT

**IBI** ARCHITECTURE PLANNING  
 San Luis Obispo  
 4119 Broad Street, Suite 210  
 San Luis Obispo, CA 93401  
 805.546.0433 fax: 805.546.0504

SEAL

COPYRIGHT: Any reproduction or distribution for any purpose other than authorized by IBI Group is forbidden.  
 COPYRIGHT 2016 IBI GROUP

REVISIONS

NO.	DATE	APPRD.	DESCRIPTION
101			(E) COVERED LUNCH AREA TO REMAIN.
103			(E) CONCRETE FLATWORK TO REMAIN.
104			(E) ASPHALT PAVING TO REMAIN.
105			(E) TURF AREA TO REMAIN.
106			(E) LANDSCAPE PLANTER TO REMAIN.
107			(E) FIRE HYDRANT TO REMAIN.
108			(E) PARKING & ENTRY SIGN PER A# 03-117035.
114			(E) CHAINLINK FENCE AND/OR GATE TO REMAIN.
123			(E) 20'-0" WIDE DRIVE APPROACH AND PAIR OF 10'-0" WIDE GATES FOR FIRE DEPARTMENT ACCESS.

CONSULTANT

AGENCY INFORMATION:  
 AGENCY TRACKING NO. 83321-243  
 FILE NO. 15-6

IDENTIFICATION STAMP  
 DIV. OF THE STATE ARCHITECT  
 OFFICE OF REGULATION SERVICES  
 03-117549  
 AC. 117549  
 DATE: OCT 17 2016

**BAKERSFIELD CITY SCHOOL DISTRICT**

**CHIPMAN JR. HIGH NEW RELOCATABLES (3)**

2905 ESSLER ST  
 BAKERSFIELD, CA 93306

OPSC or OSHPD PROJ. NO.:  
 PROJECT NO: 16166.000  
 DRAWN BY: rRr  
 CHK'D BY: RM  
 ISSUE DATE: 10/05/2016

SHEET TITLE  
**SITE PLAN - FIRE ACCESS**

SHEET NUMBER  
**A1.10A**

PLOT DATE: 9/28/2016 2:14:29 PM

CONSTRUCTION DOCUMENTS