

FILE PATH: 2440-A1.01.DWG

KEY NOTES

- 1 ROOF OVERHANG
- 2 HVAC UNIT (HV)
- 3 MODLINE (M)
- 4 FINISH FLOORING (FIN)
- 5 INTERIOR FINISH (FIN)
- 6 ELECTRICAL PANEL (EL)
- 7 2- 8'X4' MARKER BOARDS (SEE SPECIFICATIONS FOR TYPE)
- 8 FIRE EXTINGUISHER - 5 POUNDS DRY CHEMICAL WITH 2A - 10BC UL RATING ON WALL MTD BRACKET, HANDLE AT 48" AFF
- 9 RAMP/LANDING (RMP) SEE SHEETS R1 - R4
- 10 SIGNAGE PROVIDED AND INSTALLED BY DISTRICT PRIOR TO OCCUPANCY. SEE SHEET A6.01

NOTES

- 1. PLACE (2) PERMANENT METAL IDENTIFICATION LABELS ON EACH MODULE. (1) LABEL AT REAR EXTERIOR AND (1) LABEL ABOVE CEILING LINE AT INTERIOR FRAME. LABELS WILL BE MECHANICALLY FASTENED AND SHOW THE ISA APPLICATION NUMBER, MANUFACTURERS NAME AND SERIAL NUMBER, DESIGN LIVE LOAD FOR ROOF AND FLOOR FRAMING, WIND SPEED AND EXPOSURE CATEGORY.
- 2. INSULATION MATERIALS INSTALLED WITHIN FLOOR/CEILING ASSEMBLIES, ROOF-CEILING ASSEMBLIES, WALLS, CRAWL SPACES OR ATTICS SHALL HAVE A FLAME SPREAD RATING NOT TO EXCEED 25 AND A SMOKE DENSITY NOT TO EXCEED 450. EXCEPTIONS:
 (1) FOAM PLASTIC INSULATION SHALL COMPLY WITH SECTION 2802
 (2) WHEN MATERIALS ARE INSTALLED IN CONCEALED SPACES OF TYPES III, IV, AND V CONSTRUCTION, THE FLAME SPREAD AND SMOKE-DEVELOPED LIMITATIONS DO NOT APPLY TO FACINGS IF THE FACING IS INSTALLED IN SUBSTANTIAL CONTACT WITH THE UNEXPOSED SURFACE OF THE CEILING, FLOOR OR WALL FINISH (CBC SECTION 707.3)
 (3) CELLULOSE LOOSE-FILL INSULATION SHALL COMPLY WITH CPSC 16 CFR PARTS 1209 AND 1404
- 3. INTERIOR SIDE WALLS MAY BE LOCATED ON EITHER SIDE OF MODLINE
- 4. DISTRICT TO PROVIDE OCCUPANCY LOAD SIGN PER CBC 1007.2.6 PRIOR TO OCCUPANCY
- 5. ADEQUATE EXITS, EXIT WIDTH, AND SEPARATION OF EXITS SHALL BE PROVIDED AS REQUIRED BY CBC CHAPTER 10
- 6. PANIC HARDWARE IS REQUIRED WHEN THE CONFIGURATION OF ANY ROOM PROVIDES AN OCCUPANT LOAD OF 50 OR GREATER PER CBC 1007.3.10

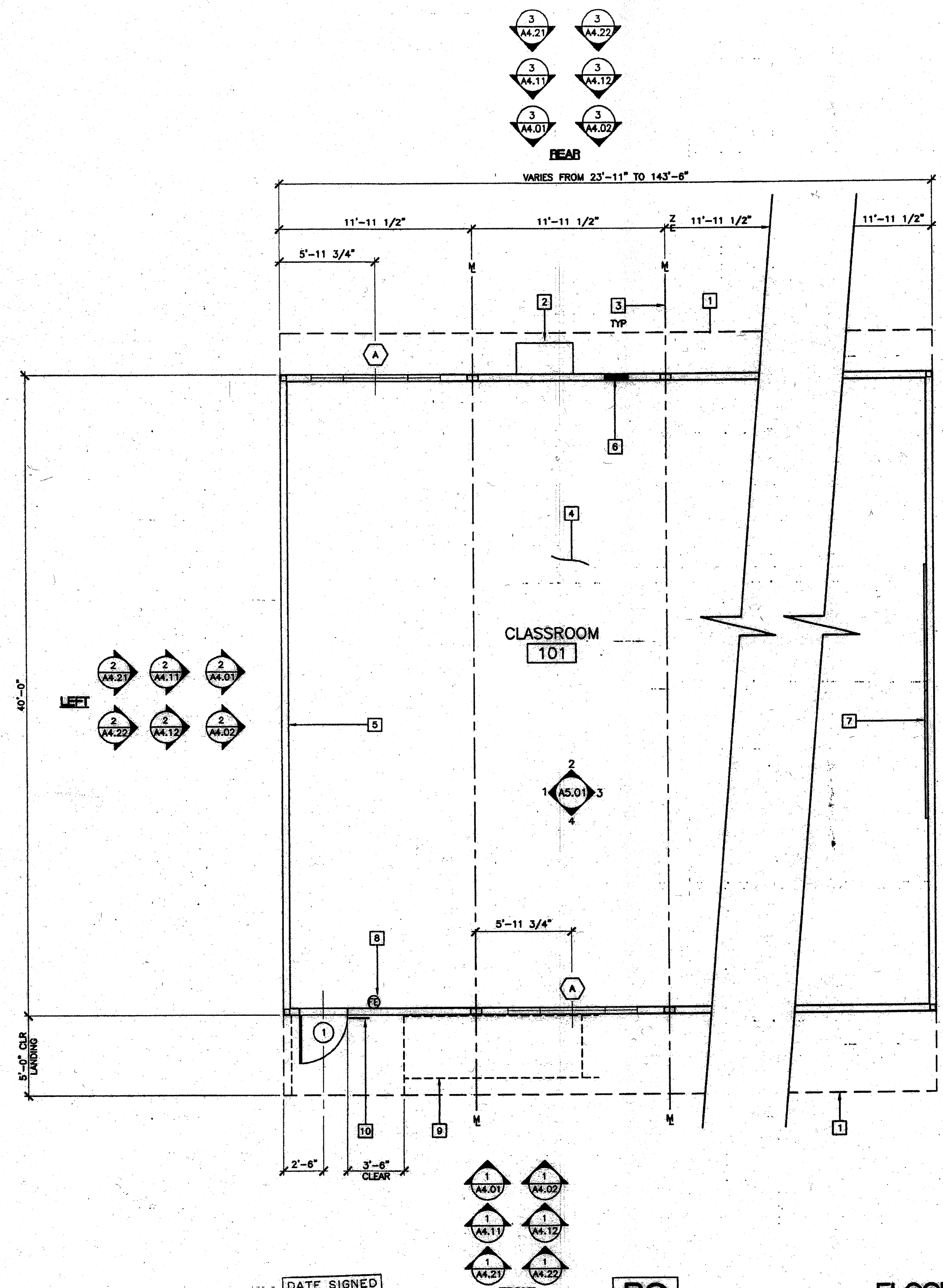

DATE SIGNED
APR 30 2003

PC
CBC 2001

FLOOR PLAN

"A" AS SHOWN "B" OPPOSITE SCALE: 1/4" = 1'-0"

IDENTIFICATION STAMP
DIV. OF THE STATE ARCHITECT
OFFICE OF REGULATION SERVICES

04 105200
ACROSS PLS. [Signature]
DATE MAY 2 2003

4012-125

REVISIONS	DESCRIPTION	DATE

AGENCY TRACKING NO. 82231-267
FILE NO. 15-6

IDENTIFICATION STAMP
DIV. OF THE STATE ARCHITECT

03118235
AC. PLS. [Signature]
DATE JUL 11 2017

PC Professional of Record Seal
Architects Seal

STATE OF CALIFORNIA
LICENSE EXPIRES 6-30-2004

LICENSED ARCHITECT
STATE OF CALIFORNIA
NOV. 8 2002

IDENTIFICATION STAMP
DIV. OF THE STATE ARCHITECT
OFFICE OF REGULATION SERVICES

PC-04
104901
ACROSS PLS. [Signature]
DATE 5/12/03

MODTECH™
2830 BARRETT AVENUE PH (909) 943-4014
PERRIS, CALIF. 92571 FAX (909) 940-0427

PROJECT NUMBER: _____ © MODTECH, INC. 2002

DRAWN BY: STKP-70
CHECKED BY: 05-22-03
DATE: _____

CLASS LEASING INC STOCKPILE # 70
100-24 x 40 CLASSROOM BUILDINGS
4012-125 05-22-2003 80 MPH

MODTECH Index No. _____

A1.01

PROJECT NO. PC-04-104801