

**LEGEND**

- DESIGN GRADE
- DESIGN SLOPE
- EXISTING GRADE
- EXISTING SLOPE
- MATCH EXISTING ELEVATION
- EXISTING WATER BOX/VALVE
- EXISTING UTILITY BOX
- EXISTING SEWER BOX/CLEANOUT
- EXISTING FENCE
- "PATH OF TRAVEL"

**CONSTRUCTION NOTES (THIS SHEET ONLY)**

- 1 SAWCUT TO NEAT, CLEAN, VERTICAL FACE.
- 2 EXISTING AC OR CONCRETE TO REMAIN, PROTECT IN PLACE.
- 3 FEATHER PATCH AC TO MATCH EXISTING @ 5% MAX SLOPE.
- 4 CONSTRUCT RAMP PER BUILDING MANUFACTURER.
- 5 INSTALL GALVANIZED FLASHING PER DETAIL (A).
- GRIND 0.1" MIN. EX. AC AND OVERLAY TO DESIGN GRADES SHOWN.
- CONSTRUCT 4" MIN. CONCRETE TO DESIGN GRADES SHOWN.

**NOTES:**

1. WARP CONCRETE TO CALIFORNIA PUBLIC ACCESSIBILITY STANDARDS TO MATCH FINISHED FLOOR AT ALL BUILDING ACCESS OPENINGS.
2. ACCESSIBLE PARKING SHALL NOT EXCEED 2% MAXIMUM SLOPE IN ANY DIRECTION.
3. SEE ARCHITECT'S PLANS FOR ALL DIMENSIONS NOT SHOWN.
4. CONTRACTOR SHALL COORDINATE RELOCATION OF ALL EXISTING UTILITIES WITH DISTRICT.
5. ALL GRADES SHOWN ARE FINISHED GRADES. CONTRACTOR SHALL INSTALL RAMPS PER BUILDING PLANS AND FURNISH INTERMEDIATE PAVING AS REQUIRED.

**ACCESSIBILITY NOTES**

1. ACCESSIBILITY NOTES ARE PROVIDED FOR REFERENCE ONLY. ALL WORK SHALL BE PERFORMED IN ACCORDANCE WITH APPLICABLE SECTIONS OF THE CALIFORNIA BUILDING CODE AND ADA STANDARDS. THE CONTRACTOR SHALL OBTAIN THE LATEST EDITION THEREOF.
2. CURB RAMPS SHALL BE 8.33% MAXIMUM GRADE.
3. PERPENDICULAR CURB RAMP SIDE SLOPES SHALL NOT EXCEED 10% GRADIENT.
4. SURFACE SLOPE OF RAMPS SHALL NOT EXCEED 8.33%.
5. ACCESSIBLE ROUTE SLOPES SHALL NOT EXCEED 5%, UNLESS CONSTRUCTED AS A RAMP AND HANDRAILS ARE PROVIDED.
6. ACCESSIBLE ROUTE CROSS SLOPES SHALL NOT EXCEED 2%.
7. RAMP LANDINGS SHALL NOT EXCEED 2% MAXIMUM GRADE IN ANY DIRECTIONS.
8. GRATINGS LOCATED WITHIN ACCESSIBLE ROUTES SHALL HAVE MAXIMUM 1/2" OPENINGS IN THE DIRECTION OF PEDESTRIAN TRAVEL.
9. TRANSITIONS ALONG ACCESSIBLE ROUTES SHALL BE FLUSH WITH CHANGES IN LEVEL NO GREATER THAN 1/4". CHANGES IN LEVEL BETWEEN 1/4" AND 1/2" SHALL BE BEVELED WITH A MINIMUM GRADIENT OF 1:2. CHANGES IN LEVEL BETWEEN 0" AND 1/4" MAY BE VERTICAL.
10. EXCEPT BETWEEN SIDEWALKS AND ADJACENT STREETS OR DRIVEWAYS, ABRUPT CHANGES IN LEVEL EXCEEDING 4" ALONG A PATH OF TRAVEL SHALL BE PROTECTED BY A WARNING CURB A MINIMUM OF 6" IN HEIGHT ABOVE THE WALKWAY SURFACE. A WARNING CURB IS NOT REQUIRED WHEN A GUARD OR HANDRAIL IS PROVIDED WITH A GUIDE RAIL CENTERED 2" MINIMUM AND 4" MAXIMUM ABOVE THE WALKWAY SURFACE.
11. ALL ACCESSIBLE DOORS SHALL HAVE LEVEL LANDINGS IN ACCORDANCE WITH CALIFORNIA BUILDING CODE, CURRENT EDITION.
12. ACCESSIBLE PARKING STALLS AND LOADING AISLES SHALL NOT EXCEED 2% MAXIMUM GRADE IN ANY DIRECTION.

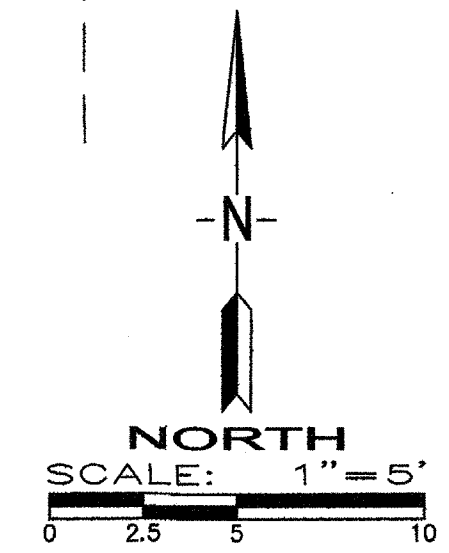
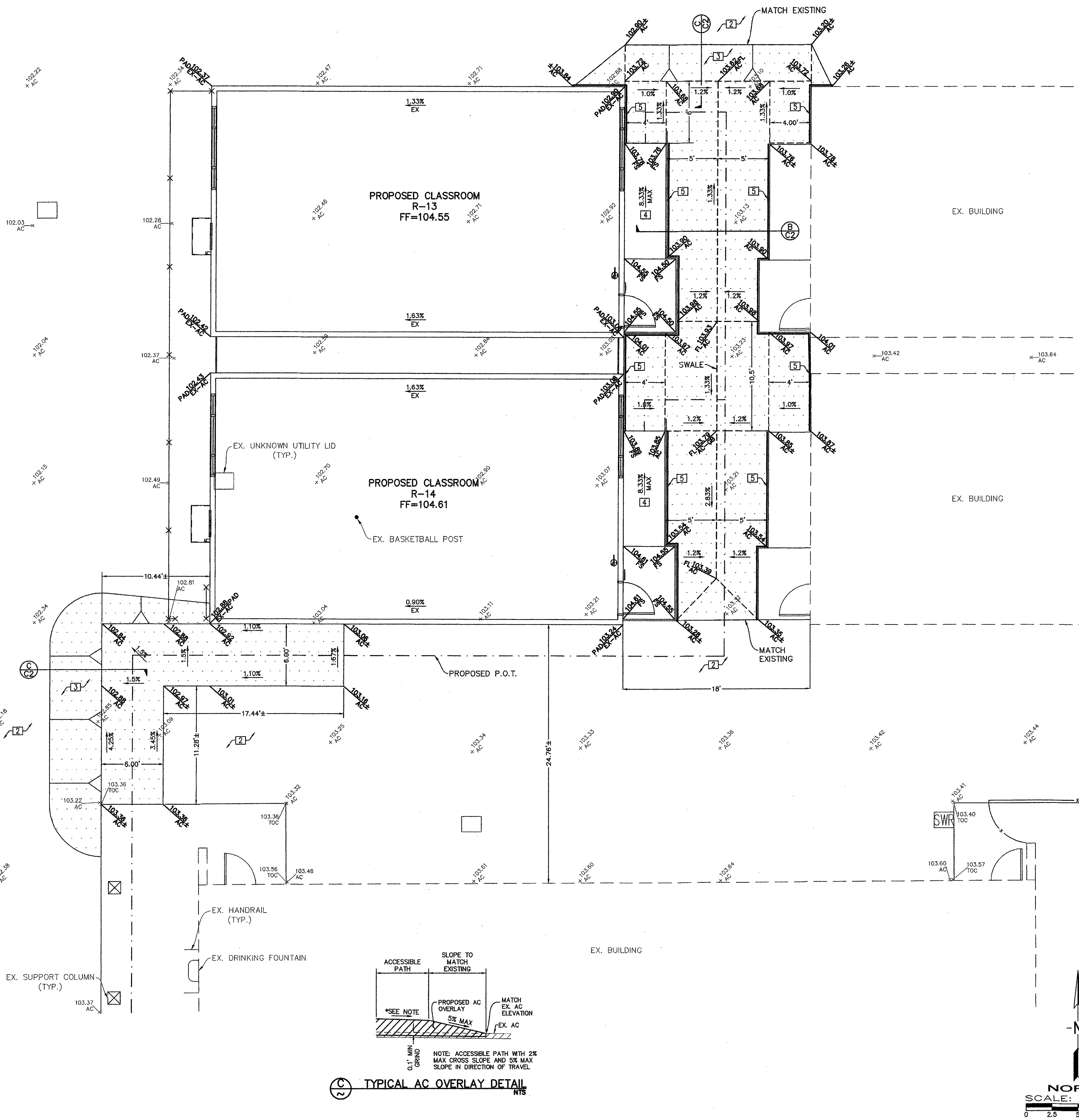
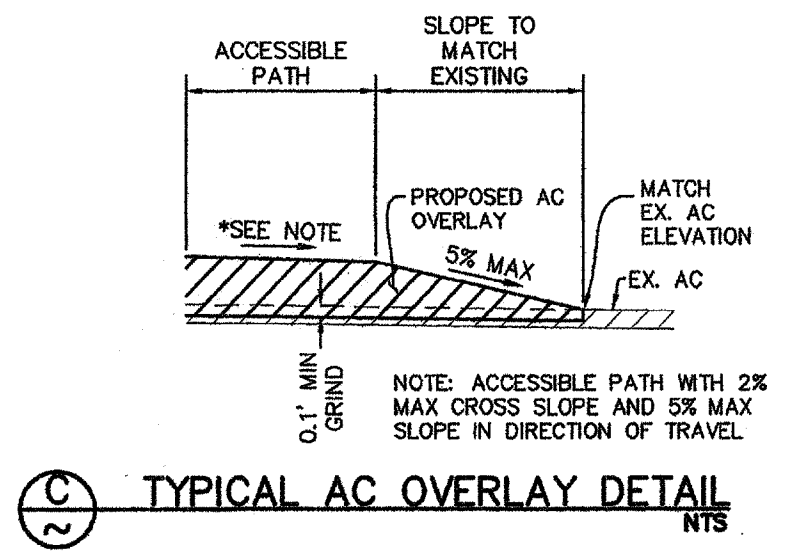
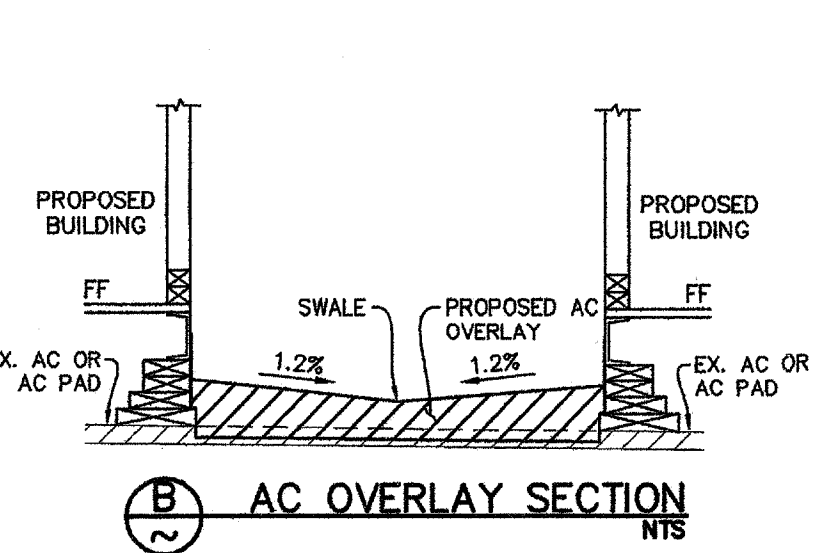
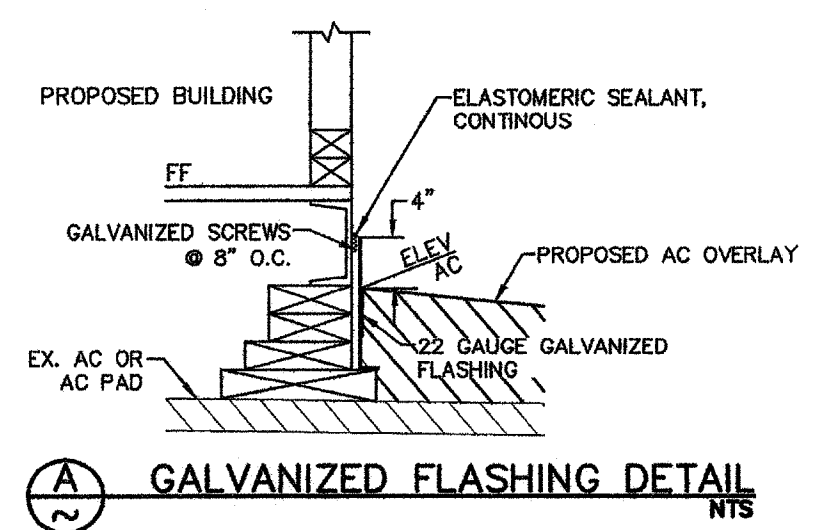

PRIME CONSULTANT

**IBI** ARCHITECTURE PLANNING

San Luis Obispo  
4119 Broad Street, Suite 210  
San Luis Obispo, CA 93401  
805.546.0433 fax: 805.546.0504

SEAL

COPYRIGHT: Any reproduction or distribution for any purpose other than authorized by IBI Group is forbidden.

COPYRIGHT 2016 IBI GROUP

REVISIONS

NO.	DATE	APPRD.	DESCRIPTION

CONSULTANT

**PORTER & ASSOCIATES, INC.**  
ENGINEERING & SURVEYING  
1200 21st Street, Bakersfield, California 93301  
861.327.0362 FAX 861.327.1065

AGENCY INFORMATION:

AGENCY TRACKING NO 63321-267  
FILE NO. 15-6

IDENTIFICATION STAMP  
DIV. OF THE STATE ARCHITECT  
OFFICE OF REGULATION SERVICES

03118235  
AC MF FLS SS  
DATE JUL 11 2017

BAKERSFIELD CITY SCHOOL DISTRICT

**CHIPMAN JR. HIGH RELOCATABLES R-13&R-14**

2905 ESSLER ST  
BAKERSFIELD, CA 93306

OPSC or OSHPD PROJ. NO:

PROJECT NO:	17150109623
DRAWN BY:	NMS
CHKD BY:	FP2
ISSUE DATE:	8/28/2016

SHEET TITLE

**GRADING PLAN  
DETAIL**

SHEET NUMBER

**C2**

CONSTRUCTION DOCUMENTS

PLOT DATE: 2/28/2016 14:22:22 PM J:\16166\_B0\_Chipman\36.9\_Drawing\656Arch\Current\ATW-16166-Asile\_Chipman.rvt