

CHARGER STREET

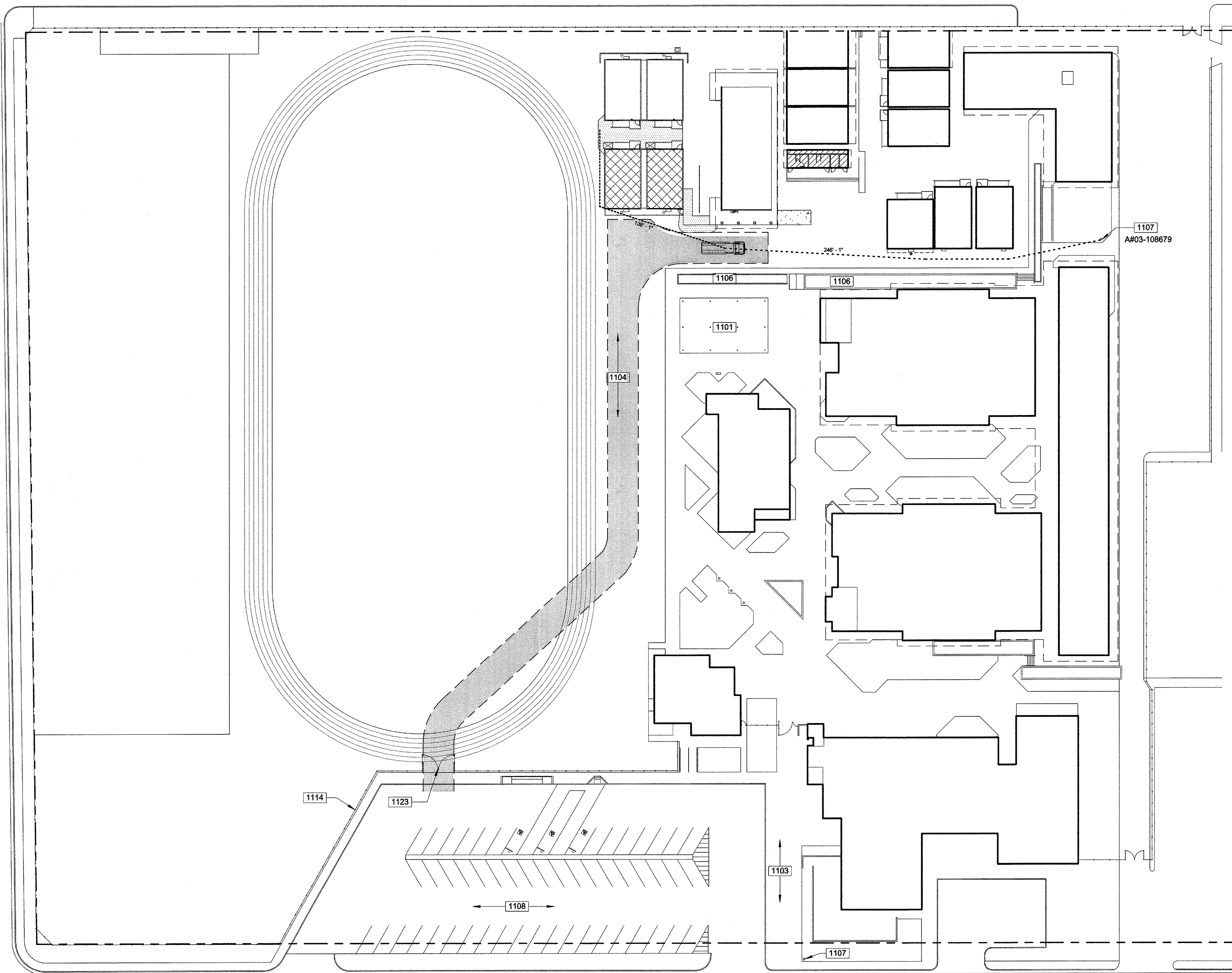

EISSLER STREET



1 OVERALL SITE PLAN - FIRE ACCESS



Ruben Ruiz
 From: Humphrey, Douglas@DGS <Douglas.Humphrey@dgs.ca.gov>
 Sent: Tuesday, June 07, 2016 6:03 PM
 To: Carlos Caceres
 Cc: Rick Mello; Ruben Ruiz
 Subject: RE: 15209.000 Pauly and 16132.000 Chipman portables -- fire authority signature sheets.
 Categories: Filed by Newforma

Carlos,

This email is a confirmation that the current situation in Bakersfield unfortunately makes participation of the LFA problematic and DSA is not requiring the DSA 810 for projects being developed in the City of Bakersfield. This may change in the future, but currently the 810 is not a required document.

Douglas Humphrey, AIA
 Regional Manager, DSA Los Angeles
 Division of the State Architect
 Department of General Services
 700 N. Alameda St., Suite 9-500
 Los Angeles, Ca. 90012

Phone (213) 897-4092
 E-mail douglas.humphrey@dgs.ca.gov



From: Carlos Caceres [mailto:carlos.caceres@bigroup.com]
 Sent: Tuesday, June 07, 2016 1:58 PM
 To: Humphrey, Douglas@DGS
 Cc: Rick Mello; Ruben Ruiz
 Subject: FW: 15209.000 Pauly and 16132.000 Chipman portables -- fire authority signature sheets.

Hi Mr. Humphrey

As stated in our previous Email to you, our DSA appointment is the 22nd of this month. We need to know that it will be fine to submit the Bakersfield city school district projects, without the local fire authority signature.
 (Please refer to previous email text below)
 We do not want to risk jeopardizing the OTC plan check appointment, because we do not have the local fire authority signature requirement.

Hydrant Flow Test Report

Test Date 6/26/2017 Test Time 04:00

Location

CHIPMAN JR HIGH
 2905 EISSLER ST
 BAKERSFIELD, CA 93306

Tested by

E. CLARK AND M. RODRIGUEZ

Notes

TESTED WITH 4" HOSE MONSTER

Read Hydrant

50 psi static pressure
 40 psi residual pressure
 1.7 ft hydrant elevation

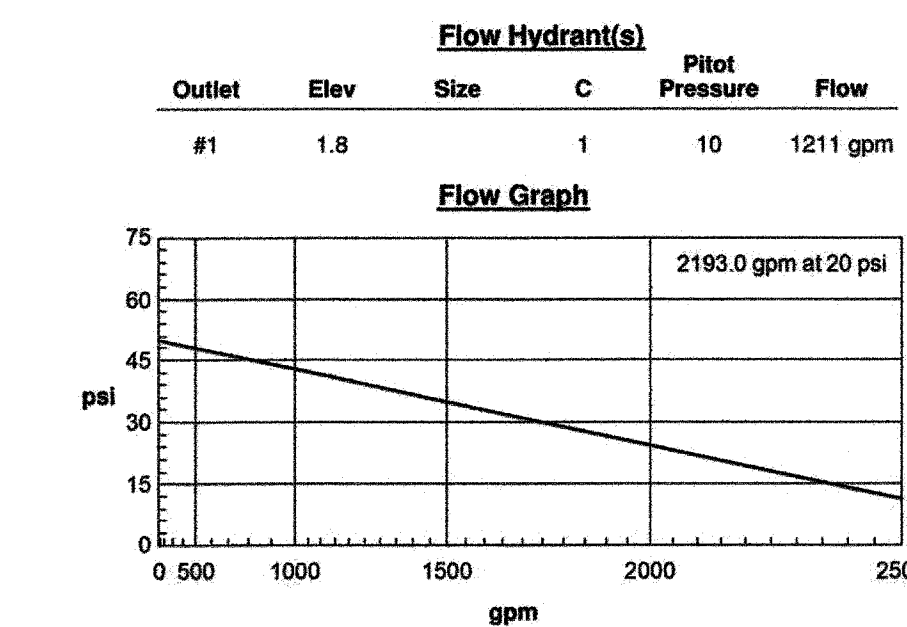

Created with the free hydrant flow test program from www.igresinc.com

1100 - KEYNOTES

- 1101 (E) COVERED LUNCH AREA TO REMAIN.
- 1103 (E) CONCRETE FLATWORK TO REMAIN.
- 1104 (E) ASPHALT PAVING TO REMAIN.
- 1106 (E) LANDSCAPE PLANTER TO REMAIN.
- 1107 (E) FIRE HYDRANT TO REMAIN.
- 1108 (E) ACCESSIBLE PARKING & ENTRY SIGN PER A# 03-117549.
- 1114 (E) CHAIN LINK FENCE AND/OR GATE TO REMAIN.
- 1123 (N) CHAIN LINK GATE, SEE DETAIL 10/A8000.

LEGEND

- ASSUMED PROPERTY LINE
- - - - - PROPERTY LINE
- NEW BUILDING TO BE CONSTRUCTED AS PART OF DSA APPLICATION NUMBER AND CONTRACT
- FIRE TRUCK ROUTE
- ATTACK HOSE LENGTH, LENGTH AS SPECIFIED
- FIRE HOSE LENGTH, LENGTH AS SPECIFIED

PRIME CONSULTANT

ARCHITECTURE PLANNING

IBI San Luis Obispo
 4119 Broad Street, Suite 210
 San Luis Obispo, CA 93401
 805.546.0433 fax: 805.546.0504

SEAL



COPYRIGHT:
 Any reproduction or distribution for any purpose other than authorized by IBI Group is forbidden.

COPYRIGHT 2017 IBI GROUP

REVISIONS

NO.	DATE	APPRD.	DESCRIPTION

CONSULTANT

AGENCY INFORMATION:

AGENCY TRACKING NO. 63321-267
 FILE NO. 15-6

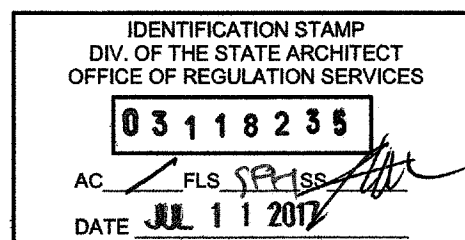

BAKERSFIELD CITY SCHOOL DISTRICT



CHIPMAN JR. HIGH,
 RELOCATABLES R13 & R14
 2905 EISSLER ST. BAKERSFIELD, CA 93306

OPSC or OSHPD PROJ. NO:

PROJECT NO: 17150/109623

DRAWN BY: rRr

CHK'D BY: RM

ISSUE DATE: 07/11/2017

SHEET TITLE

FIRE ACCESS PLAN

SHEET NUMBER

G1200

CONSTRUCTION DOCUMENTS

PLOT DATE: 7/10/2017 10:42:08 AM J:\17150_BC_Chipman\Reacts\9 Drawings\Search\current\ATW-17150-CHIPMAN\2\RELOS-A-2016.rvt