

Glenn Hartzell A.I.A.  
 26 H. STREET, 93304  
 P.O. BOX 2344, 93303, BAKERSFIELD, CALIFORNIA  
 ARCHITECT C-10298

BAKERSFIELD CITY SCHOOL DISTRICT  
 BY RESOLUTION OF THE BOARD OF TRUSTEES  
 APPROVED: \_\_\_\_\_  
 DATE: \_\_\_\_\_

DATE 4-19-91  
 DRAWN J.A.  
 SHEET INDEX ~ VICINITY MAP ~ SITE PLAN  
 (PRE-K RELOCATABLE CLASSROOM)  
 WAYSIDE ELEMENTARY SCHOOL  
 BAKERSFIELD, KERN COUNTY, CALIFORNIA

SHEET INDEX

SHT.	TITLE
A1	SHEET INDEX ~ VICINITY MAP ~ SITE PLAN
A2	PARTIAL SITE PLAN ~ DETAILS ~ GENERAL SPECIFICATIONS
E1	PARTIAL ELECTRICAL SITE PLAN ~ LINE DIAGRAM ~ DETAILS ~ SCHEDULE
E2	ELECTRICAL SPECIFICATIONS ~ DETAIL
BUILDING PLANS	
0	COVER SHEET ~ BUILDING DATA ~ SHEET INDEX
1	FLOOR PLAN ~ ROOF PLAN ~ BUILDING ELEVATIONS
2	FOUNDATION PLAN & DETAILS
3	TYPICAL WALLS & BUILDING SECTIONS
4	TYPICAL DETAILS
5	ROOF FRAMING ~ FLOOR FRAMING ~ STRUCTURAL ELEVATIONS
6	TYPICAL DETAILS
7	REFLECTED CEILING PLAN & DETAILS
8	ELECTRICAL POWER PLAN & LIGHTING PLAN
9	GENERAL NOTES & SPECIFICATIONS
R-1	METAL RAMP PLAN & DETAILS
F-1	STEPS & DETAILS

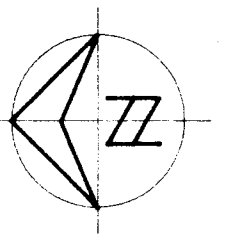
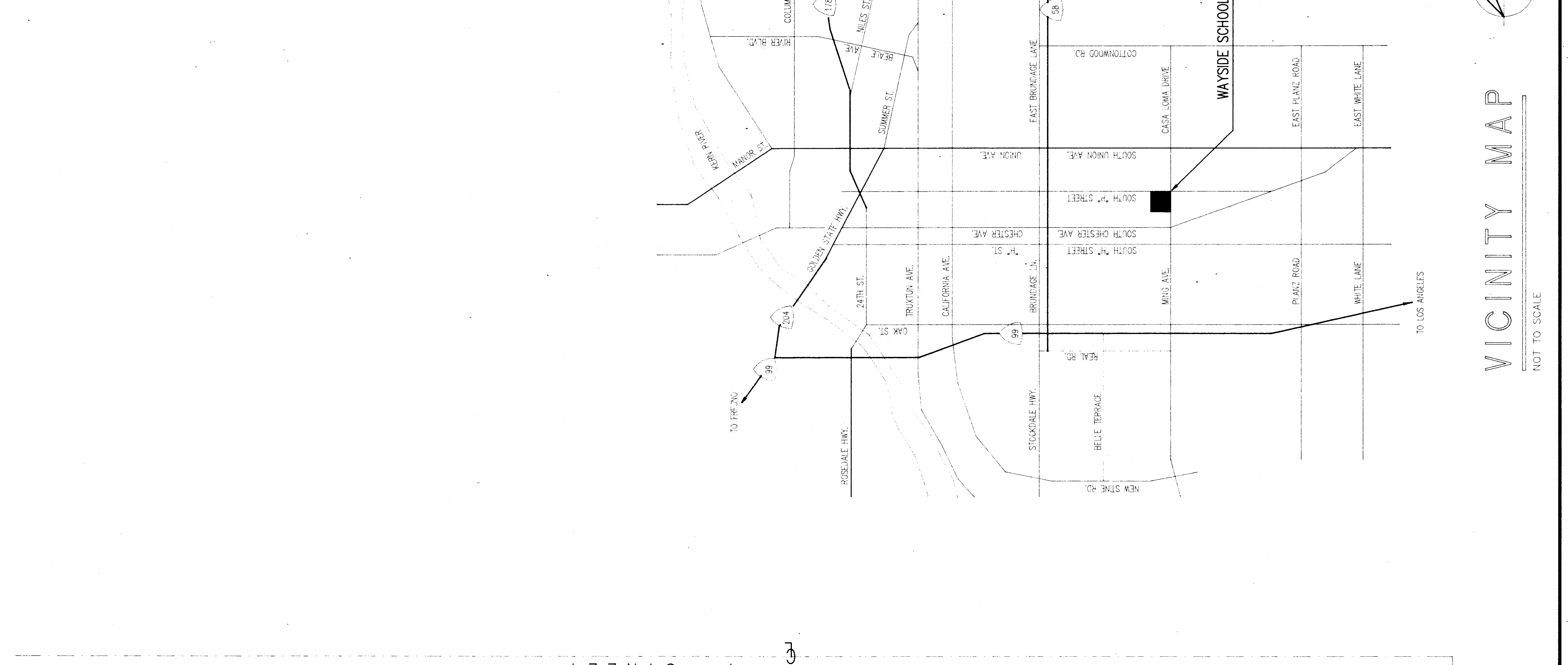

VICINITY MAP  
 NOT TO SCALE

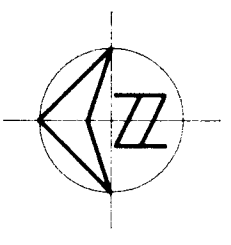
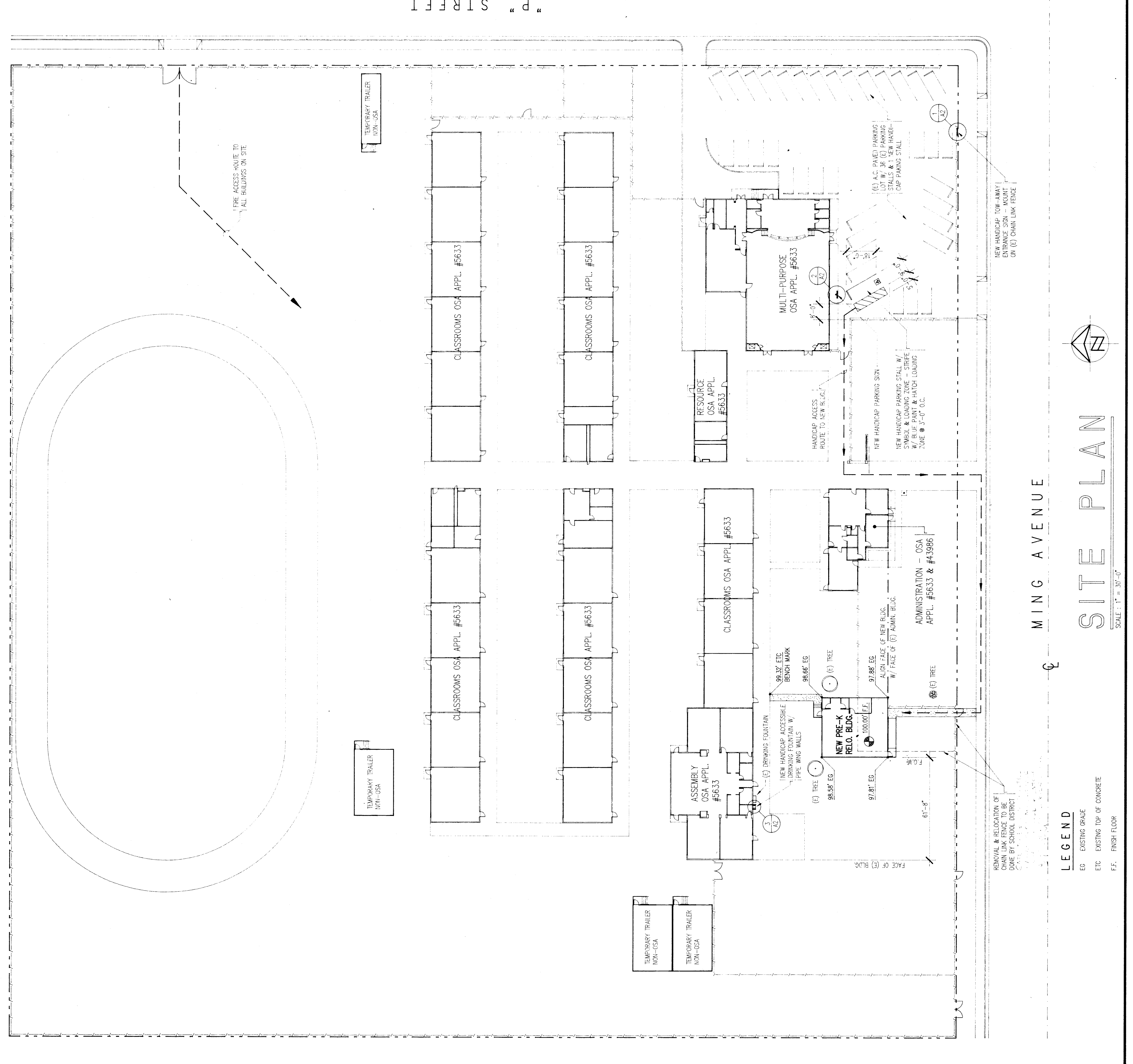

SITE PLAN  
 SCALE: 1" = 30'-0"

LEGEND  
 EG - EXISTING GRADE  
 ETC - EXISTING TOP OF CONCRETE  
 FF - FINISH FLOOR

56074  
 Byron Foster, DSN III  
 4-23-91

FIRE MARSHAL  
 5097 MAR 23 91

A.C.S.

O.S.A.