

NOTE:
REFER TO SHEET 4 FOR
CONSTRUCTION NOTES &
SHEET 1 FOR LEGEND

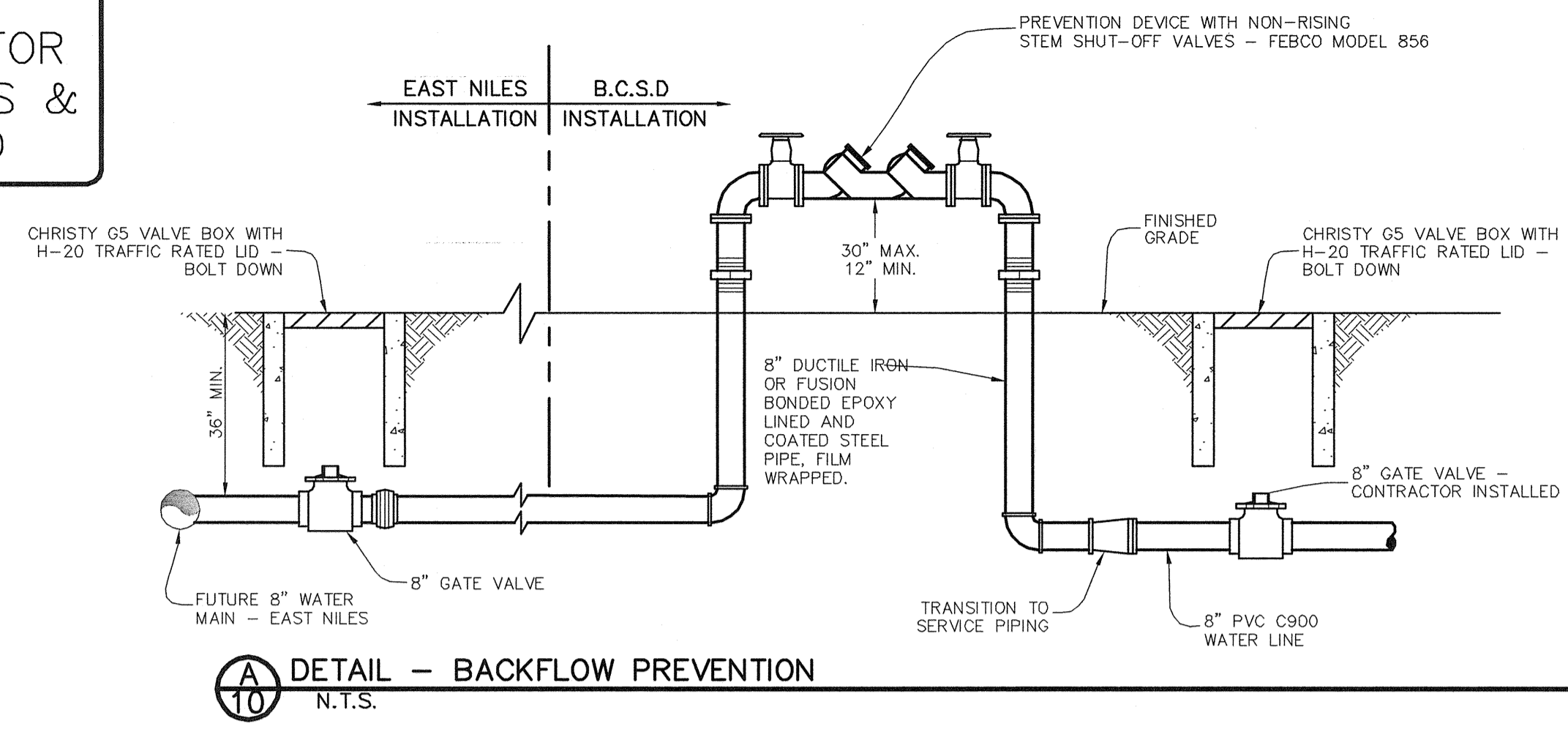

WATER NOTES – EAST NILES COMMUNITY SERVICES DISTRICT

1. THE WATER FACILITIES TO BE DEDICATED TO THE E.N.C.S.D. SHALL BE CONSTRUCTED IN ACCORDANCE WITH THE E.N.C.S.D. STANDARD SPECIFICATIONS.
2. THE E.N.C.S.D. SHALL BE NOTIFIED AT LEAST TWO (2) WORKING DAYS PRIOR TO START OF CONSTRUCTION. TELEPHONE (661) 871-2011
3. THE CONSTRUCTION PLANS MUST BE APPROVED BY THE E.N.C.S.D. PRIOR TO THE START OF ANY WATER CONSTRUCTION. TWO (2) SETS OF APPROVED PLANS SHALL BE FURNISHED TO E.N.C.S.D. AND ONE (1) SET OF THE SAME TO THE DISTRICT'S ENGINEER. PRIOR TO DISTRICT APPROVAL, THE PLANS MUST BE SIGNED BY A CALIFORNIA REGISTERED CIVIL ENGINEER.
4. PRIOR TO ACCEPTANCE OF THE WATER FACILITIES, ALL NECESSARY EASEMENT DOCUMENTS SHALL BE PROPERLY EXECUTED AND RECORDED. THREE (3) COPIES EACH OF THE RECORDED DOCUMENTS SHALL BE FURNISHED TO E.N.C.S.D.
5. WATER MAINS SHALL BE INSTALLED 6 FEET FROM THE CURB FACE UNLESS OTHERWISE INDICATED ON THE PLANS. ALL WATER SERVICES SHALL BE METERED.
6. WORK IN THE STATE OF CALIFORNIA OR THE COUNTY OF KERN RIGHTS-OF-WAY SHALL BE DONE IN ACCORDANCE WITH THE APPROPRIATE ENCROACHMENT PERMITS.
7. THE WATER SYSTEM, INCLUDING LATERALS, SHALL BE HYDROSTATIC TESTED, AFTER ALL UNDERGROUND UTILITIES ARE CONSTRUCTED, AND PRIOR TO PLACING STREET PAVEMENT.
8. ALL WATER METERS AND METER BOXES SHALL BE APPROVED BY THE DISTRICT AND SHALL BE DELIVERED TO THE E.N.C.S.D. OFFICE.
9. ALL VALVES SHALL BE FLANGE CONNECTED TO FITTINGS.
10. ALL WATER LINES SHALL HAVE A MINIMUM COVER OF 36 INCHES.
11. ONE COMPLETE SET OF DRAWINGS (REPRODUCIBLE 3-MIL DOUBLE MATTE FILM) SHALL BE FURNISHED TO THE DISTRICT ON COMPLETION OF CONSTRUCTION.

SEE SHEET 9

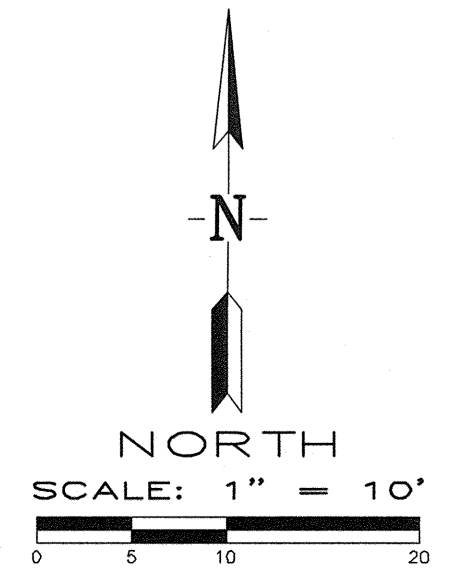
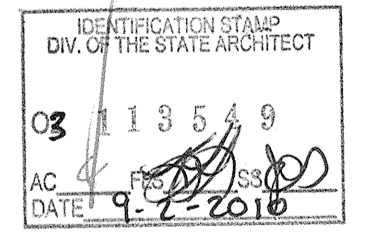
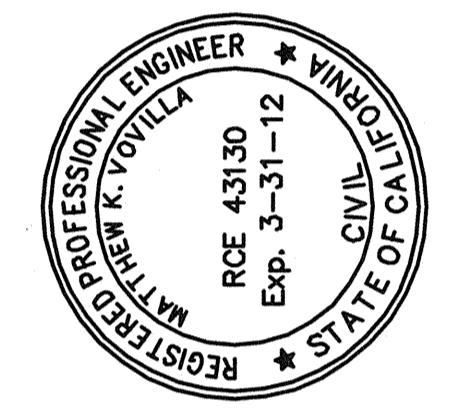
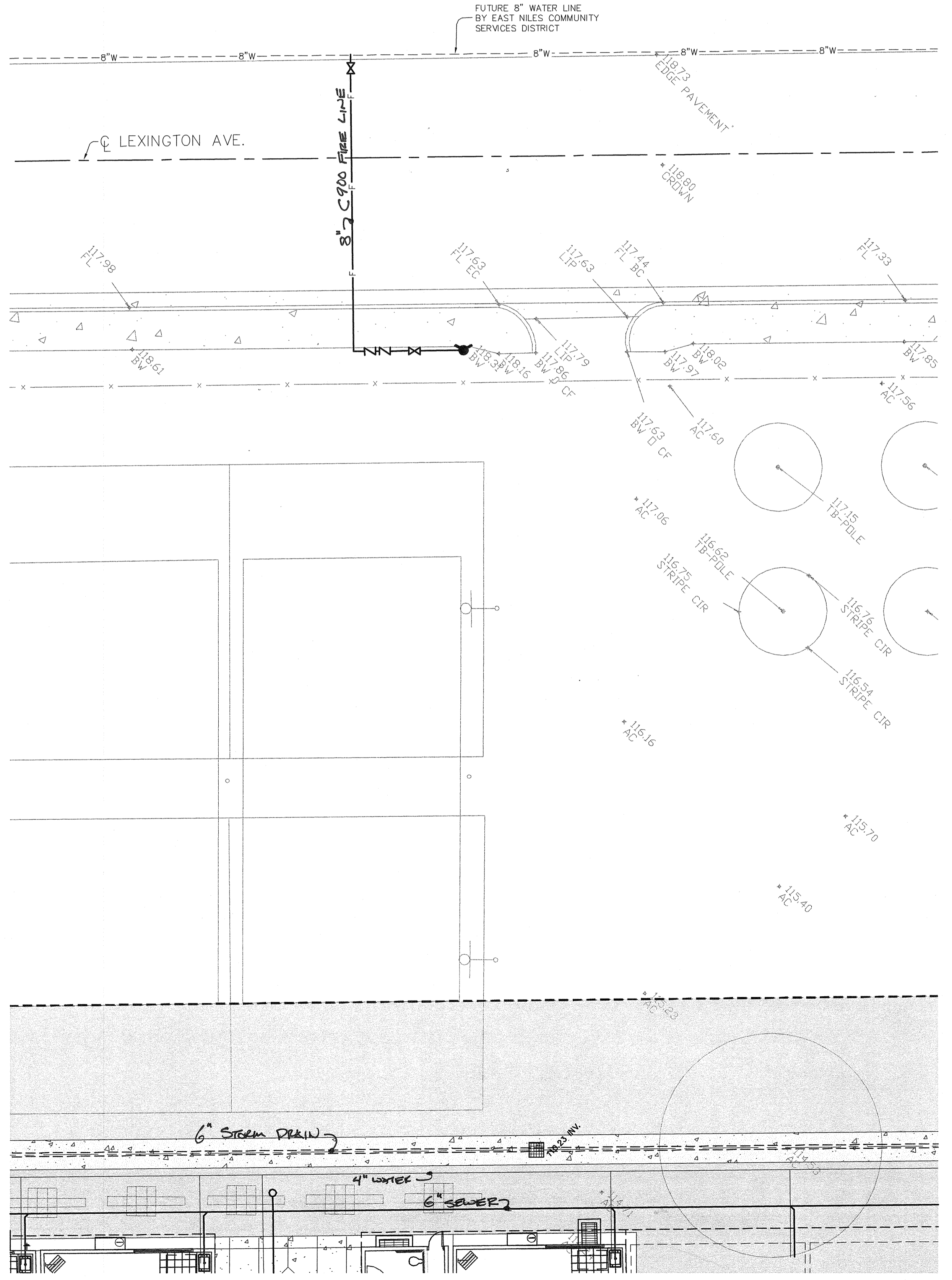
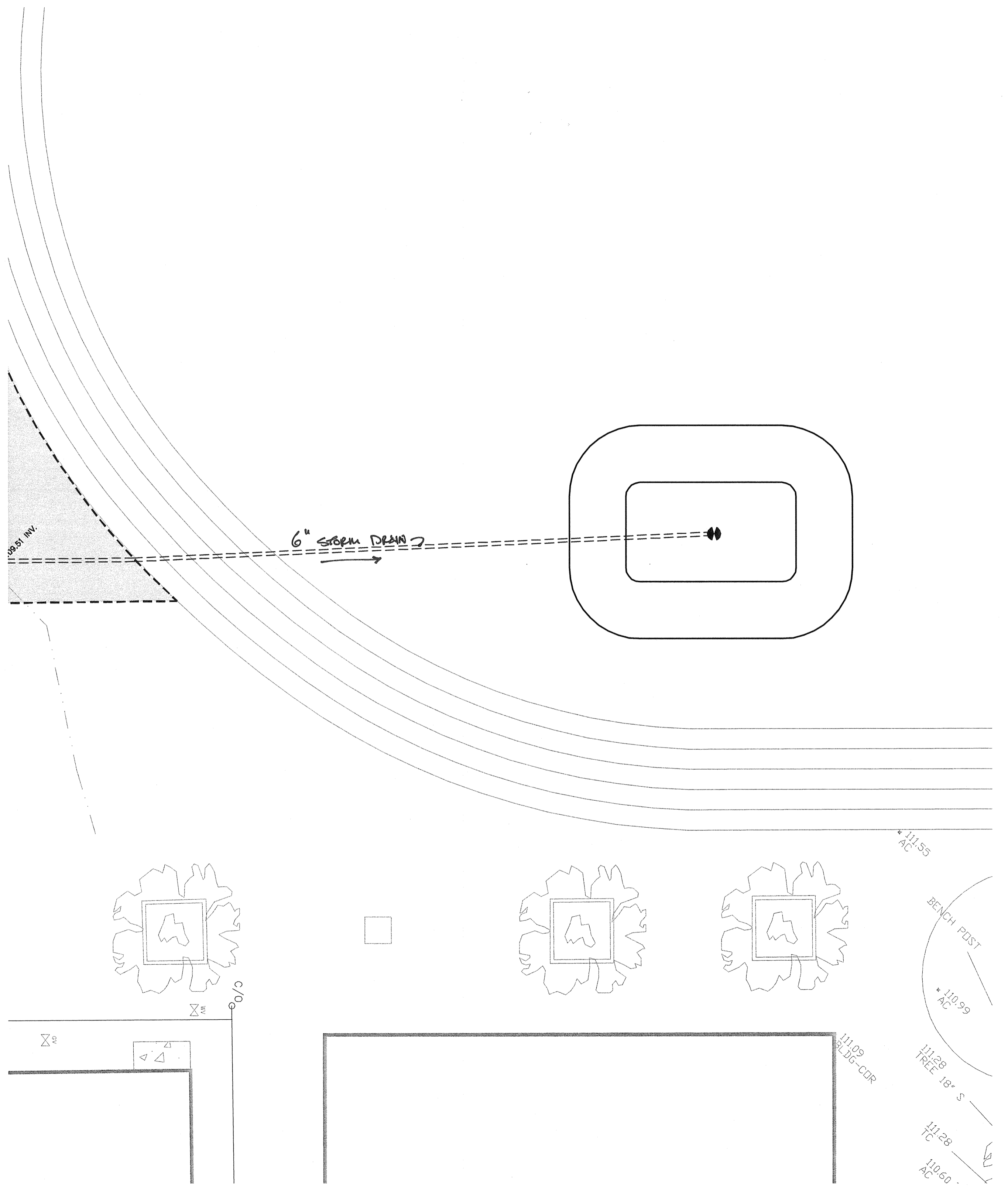

Pinnacle Civil Engineering, Inc.
4620 California Avenue, Bakersfield, CA 93309
Phone: (661) 869-0184 Fax: (661) 377-0076

DATE	
REVISIONS	
MATTHEW K. VOVILLA	RCE 43130 EXP. 3/31/12

**UTILITY PLANS
PIONEER ELEMENTARY SCHOOL
4404 PIONEER DRIVE
BAKERSFIELD, CALIFORNIA**

JOB No.:	09-419
DWG No.:	09-419-BM
DATE:	09/01/2010
DRAWN BY:	ADK
CHECKED BY:	MKV
SHEET	10
OF 10 SHEETS	