

All mechanical and electrical equipment shall be braced and supported in the direction of travel in any direction using the following criteria:

- Fixed Equipment on Grade 22% of Operating Weight
  - Emergency Power Equipment on 33% of Operating Weight
  - Emergency Power Equipment on 50% of Operating Weight
  - Structure 50% of Operating Weight
- For Flexibly Mounted Equipment Use 2 X the above values. Simultaneous Vertical Forces - Use 1/3 X Horizontal Force.
- Where equipment details are not shown on the drawings, the field representative shall consult with the Mechanical Engineer and the field representative of the Office of the State Architect.

GENERAL PROJECT NOTE - COORDINATION OF WORK:

Layout of equipment, equipment and systems is generally diagrammatic in nature. Specific dimensions and locations may vary from office to office. The actual locations of all materials, piping, ductwork, fixtures, equipment, supports, etc. shall be carefully planned prior to construction. The contractor shall be responsible for verifying the proper voltage and phase of all equipment with the electrical plans. All equipment shall be installed in accordance with the manufacturer's and the field representative of the Office of the State Architect.

REMOVE ALL EXISTING THERMOSTATS AND DO NOT REUSE. INSTALL OVER PLATE. (UNLESS EXISTING HEATING SYSTEM TO REMAIN OR OTHERWISE NOTED).

CONTRACTOR TO WATER-JET WHERE EXISTING CONCRETE WHEN SOIL CONDITIONS DO NOT ALLOW SETTING OR EXCAVATION BELOW EXISTING CONCRETE. ALL CONCRETE TO BE PATCHED TO MATCH EXISTING WHEN OUT.

AIR CONDITIONING LEGEND		
SYMBOL	ITEM	ABBV
—	HOT WATER SUPPLY	HWS
—	HOT WATER RETURN	HWR
—	CHILLED WATER SUPPLY	CWS
—	CHILLED WATER RETURN	CWR
—	CHILLED/HOT WATER SUPPLY	CWS
—	CHILLED/HOT WATER RETURN	CWR
—	CHILLED/HOT WATER	CWS
—	CHILLED/HOT WATER RETURN	CWR
—	STEAM SUPPLY	SS
—	STEAM RETURN	SR
—	STEAM CONDENSATE RETURN	SCR
—	REFRIGERANT DISCHARGE	RD
—	REFRIGERANT LIQUID	RL
—	REFRIGERANT SUCTION	RS
—	BALL VALVE	BV
—	BUTTERFLY VALVE	BV
—	CHECK VALVE	CV
—	GATE VALVE	GV
—	PLUG VALVE	PV
—	PRESSURE RELIEF VALVE	PRV
—	ONION	ON
—	FLOW SWITCH	FS
—	STRAINER	ST
—	REDUCER OR INCREASER	—

AIR CONDITIONING LEGEND		
SYMBOL	ITEM	ABBV
—	ROUND DUCT	RD
—	SHEET METAL DUCT	SM
—	DUCT WITH	—
—	ACOUSTIC LINING	—
—	SUPPLY AIR DUCT DRGP	—
—	RETURN AIR DUCT DRGP	—
—	EXHAUST AIR DUCT DRGP	—
—	EXHAUST AIR DUCT RISE	—
—	RETURN AIR DUCT RISE	—
—	EXHAUST AIR DUCT RISE	—
—	TURNING VANES	TV
—	EXTRACTOR	—
—	CONTRON DAMPER WITH LOCKING QUADRANT	FD
—	FIRE DAMPER WITH	—
—	ACCESS PANEL	—
—	COBIC FEET OF AIR PER MINUTE	CFM
—	THERMOSTAT @ +5.0°	TSTAT
—	DIRECTION OF FLOW	—
—	SUPPLY AIR	SA
—	RETURN AIR	RA
—	EXHAUST AIR	EA
—	OUTSIDE AIR	OSA
—	PIPE OR DUCT TURN DOWN	—
—	PIPE OR DUCT TURN UP	—
—	BYPASS TIMER	BPT
—	POINT OF CONNECTION	POC
—	EXISTING (DESIGNATED)	(E)

- \* FIRE DAMPERS SHALL BE STATE FIRE MARSHAL APPROVED AND INSTALLED STRICTLY PER MANUFACTURER'S PRINTED INSTRUCTIONS.
- \* MANUFACTURER'S INSTALLATION INSTRUCTIONS SHALL BE MADE AVAILABLE TO THE INSPECTING AUTHORITIES.

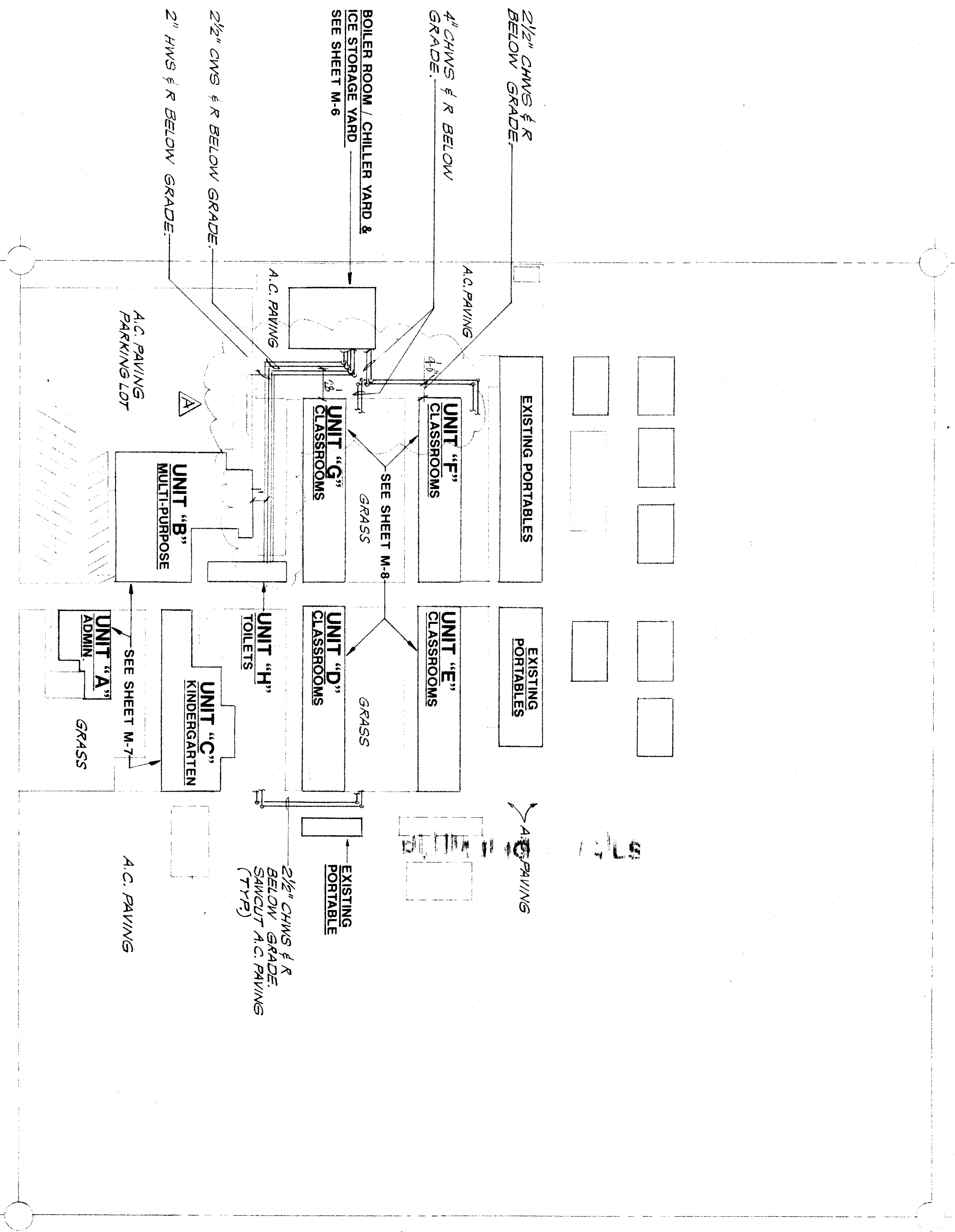

**AIR CONDITIONING SITE PLAN**

SCALE: 1"=50'-0"



**ROBERT F. STUHR ARCHITECT INC.**  
 3121 CALIFORNIA AVE.  
 BAKERSFIELD, CA 93304  
 (805) 327-1632

ROBERT F. STUHR  
 WILLIAM J. MELBY AIA  
 DANNY E. ORDIZ AIA  
 C-14728

**Donald R. Lammers & Associates**  
 CONSULTING MECHANICAL ENGINEERS, ARCHITECTS AND PLANNERS  
 2000 W. BAKER ST. SUITE 100  
 BAKERSFIELD, CA 93311  
 (805) 327-1632

**IDENTIFICATION STAMP**  
 Department of State Professional Regulation  
 Office of State Architect  
 5192 K Street  
 Sacramento, CA 95834

PROJECT NO. 5192 K-10-98  
 DATE: 11/19/98

**AIR CONDITIONING SITE PLAN**  
**PIONEER DRIVE SCHOOL MODERNIZATION**  
**BAKERSFIELD CITY SCHOOL DISTRICT**  
**BAKERSFIELD, KERN COUNTY, CALIFORNIA**

**'As Built'**

CHECK AND VERIFY ALL DIMENSIONS BEFORE PROCEEDING WITH THE WORK. REPORT ALL DISCREPANCIES TO THE ARCHITECT BEFORE CONSTRUCTION SHALL CONFORM TO UBC.

MARK	DATE	REVISIONS
△		
△		
△		
△		

JOB NO. \_\_\_\_\_  
 DRAWN BY: **D. EWMS**  
 CHECKED BY: **S. AYE**  
 DATE: \_\_\_\_\_

**M**  
 5  
 OF 11 SHEETS