

- NOTES
- EXISTING WATER CLOSET TO BE REMOVED. CAP PIPING BEHIND FINISH SURFACES.
 - EXISTING WATER CLOSET TO REMAIN. SCRUB CLEAN AND PROVIDE NEW FLUSH VALVE ASSEMBLY, FILL, NEW SEAT WSS-1 AND SUPPLY PIPE AND BOLT CAPS. RECONNECT TO EXISTING PIPING.
 - EXISTING LAVATORY TO BE REMOVED. CAP PIPING BEHIND FINISH SURFACES.
 - EXISTING LAVATORY TO BE REMOVED AND RELOCATED. SCRUBB CLEAN AND RESET IN NEW LOCATION AFTER ALL ARCHITECTURAL WORK HAS BEEN COMPLETED. PROVIDE NEW LT-1, NEW P-TAP, TAP ARM, WATER STOP AND SUPPLY. RECONNECT TO EXISTING PIPING.
 - EXISTING SERVICE SINK TO BE REMOVED. CAP PIPING BEHIND FINISH SURFACES.
 - SNOUT AND PATCH EXISTING FLOOR FOR BELOW FLOOR PIPE INSTALLATION. TYPICAL.
 - EXISTING WATER CLOSET TO BE RELOCATED. CAP PIPING BEHIND FINISH SURFACES. SEE PLAN FOR NEW LOCATION. PROVIDE NEW FLUSH WATER ASSEMBLY, FILL, AND SUPPLY PIPE.
 - EXISTING WATER CLOSET TO REMAIN. SCRUB CLEAN AND PROVIDE NEW FLUSH WATER ASSEMBLY, FILL, SUPPLY PIPE AND BOLT CAPS. RECONNECT TO EXISTING PIPING.

REMOVE EXISTING PIPING AS SHOWN IN THIS DETAIL. SEE DETAIL BIM-4 TYP

REMOVE EXISTING PIPING AS SHOWN IN THIS DETAIL. SEE DETAIL BIM-4 TYP

CONNECT 3/4" COND DRAIN TO UNIT VENTILATOR TERMINATE THROUGH WALL W/ 90° ELL DN AT 4" ABV FIN SURF. TYP SEE DET. 1/2" COND TO R-4 UNIT. SEE DET. F/M-4.

CONNECT 3/4" COND DRAIN TO UNIT VENTILATOR TERMINATE THROUGH WALL W/ 90° ELL DN AT 4" ABV FIN SURF. TYP SEE DET. 1/2" COND TO R-4 UNIT. SEE DET. F/M-4.

REMOVE EXISTING PIPING AS SHOWN IN THIS DETAIL. SEE DET. BIM-4 TYP

REMOVE EXISTING PIPING AS SHOWN IN THIS DETAIL. SEE DET. BIM-4 TYP

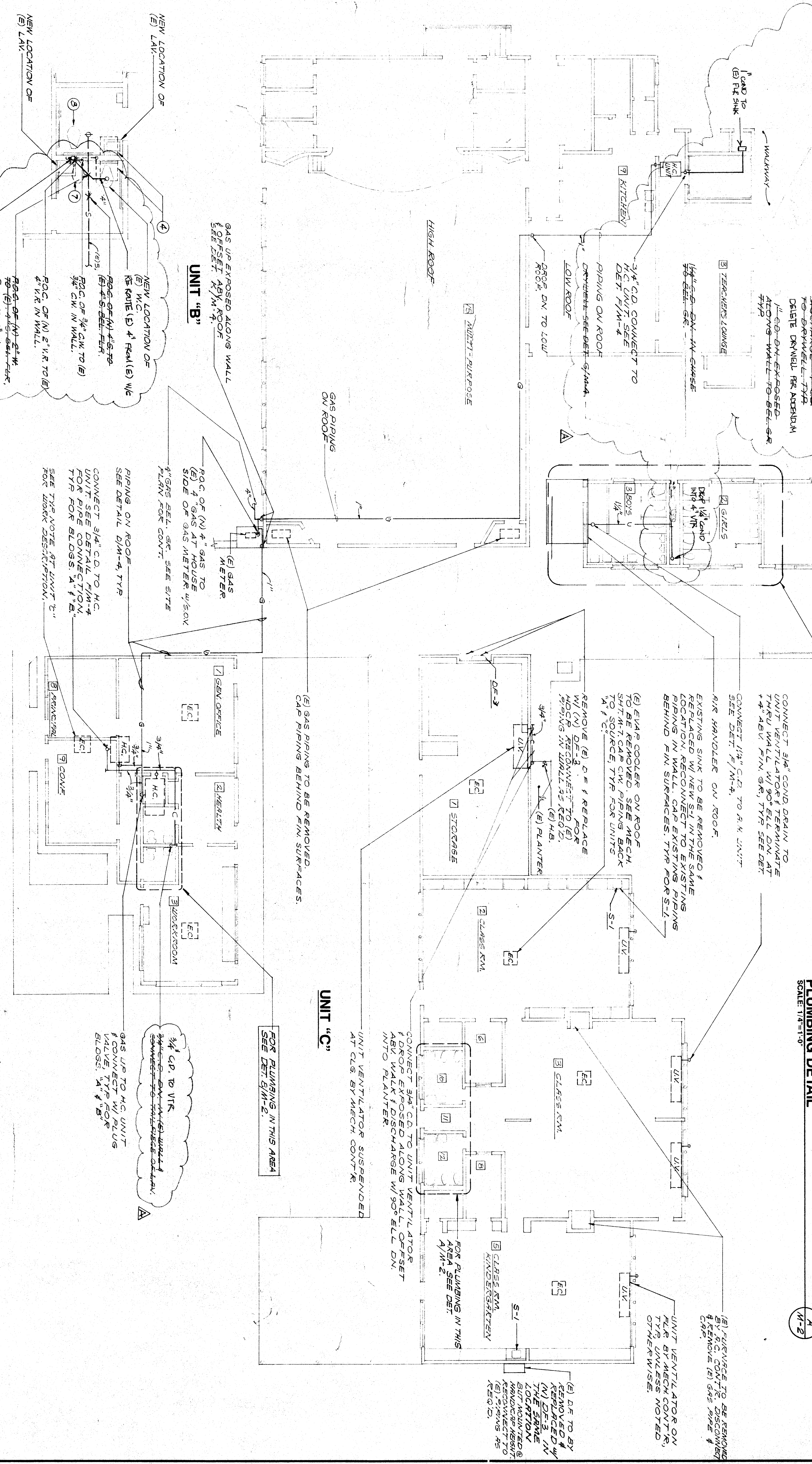

PLUMBING DETAIL
SCALE: 1/4"=1'-0"

PLUMBING PLAN
SCALE: 1/8"=1'-0"

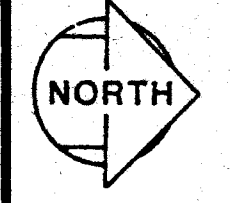

ROBERT F. STUHR ARCHITECT INC.
3121 CALIFORNIA AVE.
BAKERSFIELD, CA 93304
(805) 327-1632

ROBERT F. STUHR AIA
WILLIAM J. MELBY AIA
DANNY E. ORDIZ AIA

INSPECTOR'S SIGNATURE
Department of General Services
Office of the State Architect
Standard Safety Section
Field # 111899
Inspected By: 5172 R
Date: 5/19/21

1/8" PLANS FOR "A", "B", & "C"
PIONEER DRIVE SCHOOL MODERNIZATION
BAKERSFIELD CITY SCHOOL DISTRICT
BAKERSFIELD, KERN COUNTY, CALIFORNIA

'As Built'

MARK DATE REVISIONS

JOB NO. 547216
DRAWN: GANZMUS
CHECKED: GANZMUS
DATE: 5/19/21

OF 11 SHEETS