

PRIME CONSULTANT  
**IBI** ARCHITECTURE PLANNING  
 San Luis Obispo  
 4119 Broad Street, Suite 210  
 San Luis Obispo, CA 93401  
 805.546.0433 fax: 805.546.0504  
 ibigroup.com

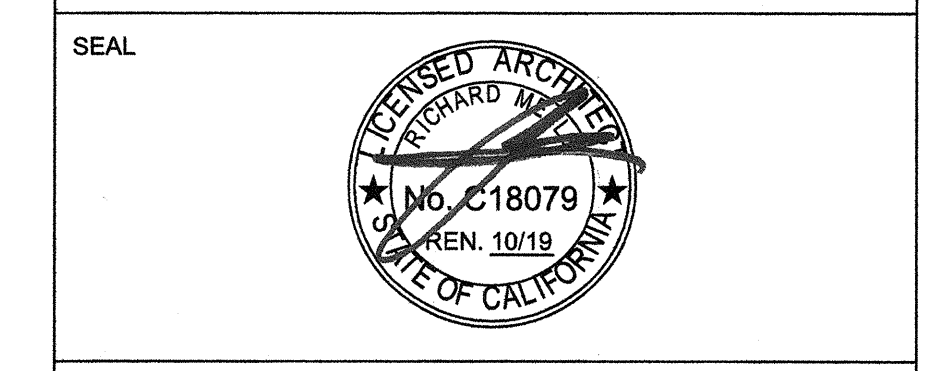

**COPYRIGHT:**  
 Any reproduction or distribution for any purpose other than authorized by IBI Group is forbidden.  
**COPYRIGHT 2018 IBI GROUP**

REVISIONS

NO.	DATE	APPRD.	DESCRIPTION

CONSULTANT  
**JMPE**  
 ELECTRICAL ENGINEERING  
 LIGHTING DESIGN  
 CA REGISTRATION NO. E13089  
 10176  
 156 W. ALAMAR AVE.  
 SUITE B  
 SANTA BARBARA, CA 93105  
 (805) 569-2216  
 FAX: (805) 569-2405  
 email: jmalone@jmpe.net  
 www.jmpe.net

AGENCY INFORMATION:  
 AGENCY TRACKING NO. 63321-329  
 FILE NO. 15-6  
 IDENTIFICATION STAMP  
 DIV. OF THE STATE ARCHITECT  
 OFFICE OF REGULATION SERVICES  
 03-119029  
 AC. FILED  
 DATE NOV 06 2018

**BAKERSFIELD CITY SCHOOL DISTRICT**

**PIONEER DRIVE E.S. - MARQUEE SIGN**  
 4404 PIONEER DR, BAKERSFIELD, CA 93306

OPSC or OSHPD PROJ. NO:  
 PROJECT NO: 17146/109642.CO5  
 DRAWN BY: Author  
 CHKD BY: Checker  
 ISSUE DATE: 09/27/2018

SHEET TITLE  
**PARTIAL ELECTRICAL SITE PLAN**

SHEET NUMBER  
**E-1**

**PARTIAL ELECTRICAL SITE PLAN NOTES**  
 1 BORE UNDER EXISTING SIDEWALK

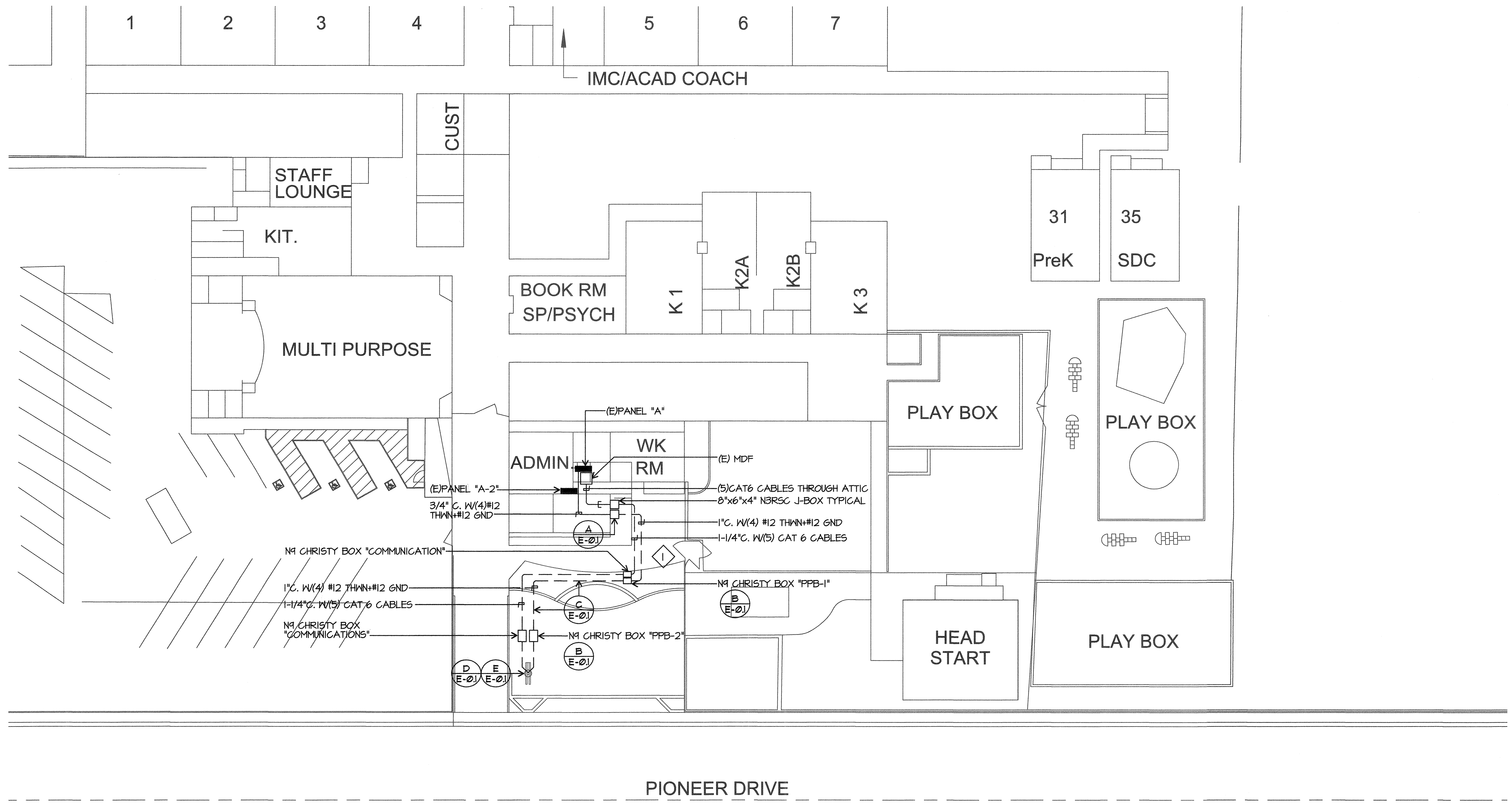

**PARTIAL ELECTRICAL SITE PLAN**  
 SCALE: 1" = 20'-0" 0 5 10 20 40

CONSTRUCTION DOCUMENTS  
 PLOT DATE: 6/7/2017 10:18:14 AM J:\17146\_BC\_Marquee7.5.9 Drawings\BArch\current\ATV\_2017-03-23\_WILLIAM PENN-V2016.rvt