

**FIXTURE SCHEDULE**

TITLE	DESCRIPTION	QUANTITY	NOTES
a	RECESSED CCT # 4018-400-4	2/40W T/R 85	RECESS
b	RECESSED CCT # 2818-240-R1-50-WH	2/140W T/R 85	CELLS
c	RECESSED CCT # 4018	1/R T/R 85	CELLS
d	RECESSED CCT # 1627B	1/50W T/R 85	RECESS
f	RECESSED CCT # 4018	1/R T/R 85	CELLS

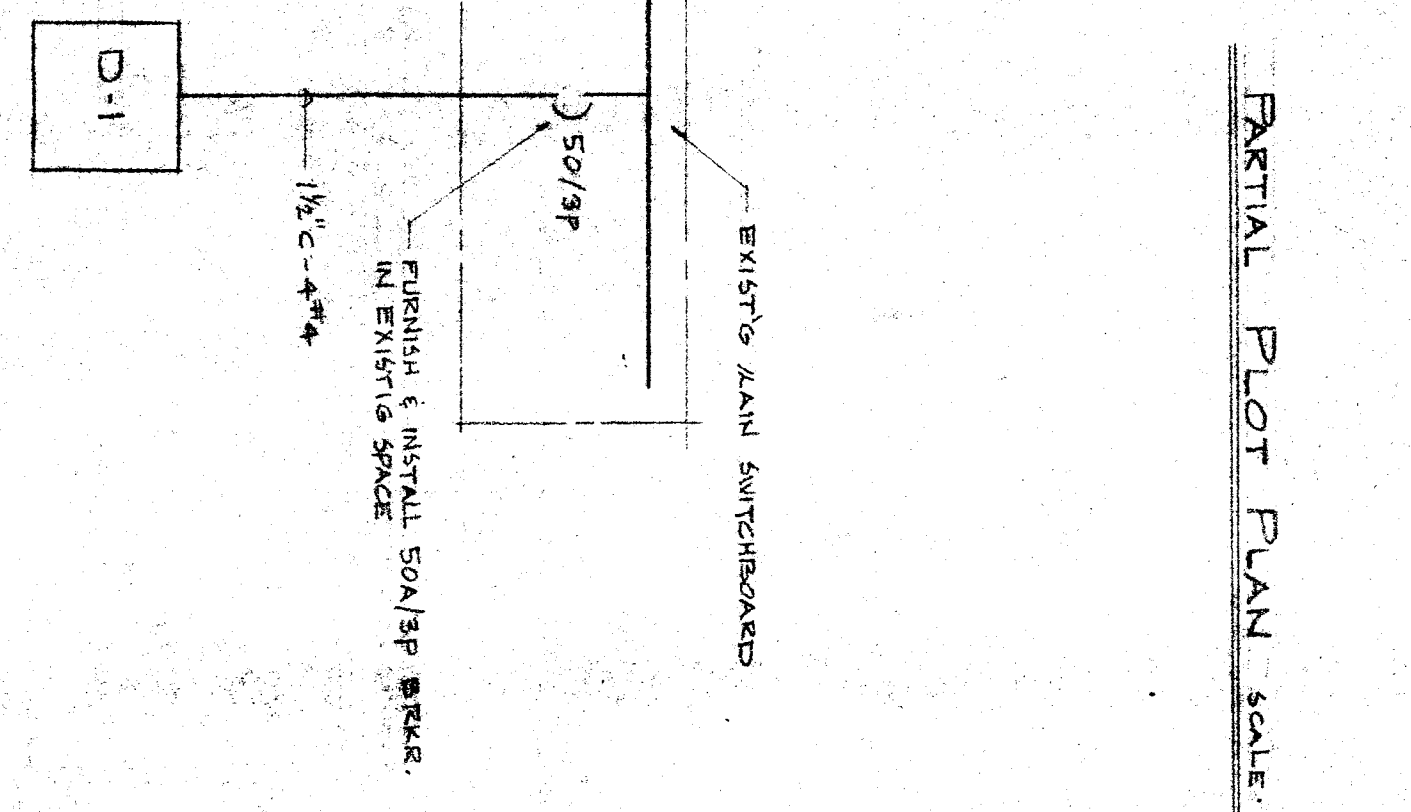

**LINE DIAGRAM**

**PANEL "D-1" SCHEDULE**

CIR. NO.	WIRING	DESCRIPTION
1	1200	LIGHTS
2	1200	RECESSED
3	500	RECESSED
4	1200	RECESSED
5	1200	RECESSED
6	1200	RECESSED
7	1200	RECESSED
8	1200	RECESSED
9	1200	RECESSED
10	1200	RECESSED
11	1200	RECESSED
12	1200	RECESSED
13	1200	RECESSED
14	1200	RECESSED
15	1200	RECESSED
16	1200	RECESSED
17	1200	RECESSED
18	1200	RECESSED
19	1200	RECESSED
20	1200	RECESSED
21	1200	RECESSED
22	1200	RECESSED
23	1200	RECESSED
24	1200	RECESSED
25	1200	RECESSED
26	1200	RECESSED
27	1200	RECESSED
28	1200	RECESSED
29	1200	RECESSED
30	1200	RECESSED
31	1200	RECESSED
32	1200	RECESSED
33	1200	RECESSED
34	1200	RECESSED
35	1200	RECESSED
36	1200	RECESSED
37	1200	RECESSED
38	1200	RECESSED
39	1200	RECESSED
40	1200	RECESSED
41	1200	RECESSED
42	1200	RECESSED
43	1200	RECESSED
44	1200	RECESSED
45	1200	RECESSED
46	1200	RECESSED
47	1200	RECESSED
48	1200	RECESSED
49	1200	RECESSED
50	1200	RECESSED
51	1200	RECESSED
52	1200	RECESSED
53	1200	RECESSED
54	1200	RECESSED
55	1200	RECESSED
56	1200	RECESSED
57	1200	RECESSED
58	1200	RECESSED
59	1200	RECESSED
60	1200	RECESSED
61	1200	RECESSED
62	1200	RECESSED
63	1200	RECESSED
64	1200	RECESSED
65	1200	RECESSED
66	1200	RECESSED
67	1200	RECESSED
68	1200	RECESSED
69	1200	RECESSED
70	1200	RECESSED
71	1200	RECESSED
72	1200	RECESSED
73	1200	RECESSED
74	1200	RECESSED
75	1200	RECESSED
76	1200	RECESSED
77	1200	RECESSED
78	1200	RECESSED
79	1200	RECESSED
80	1200	RECESSED
81	1200	RECESSED
82	1200	RECESSED
83	1200	RECESSED
84	1200	RECESSED
85	1200	RECESSED
86	1200	RECESSED
87	1200	RECESSED
88	1200	RECESSED
89	1200	RECESSED
90	1200	RECESSED
91	1200	RECESSED
92	1200	RECESSED
93	1200	RECESSED
94	1200	RECESSED
95	1200	RECESSED
96	1200	RECESSED
97	1200	RECESSED
98	1200	RECESSED
99	1200	RECESSED
100	1200	RECESSED

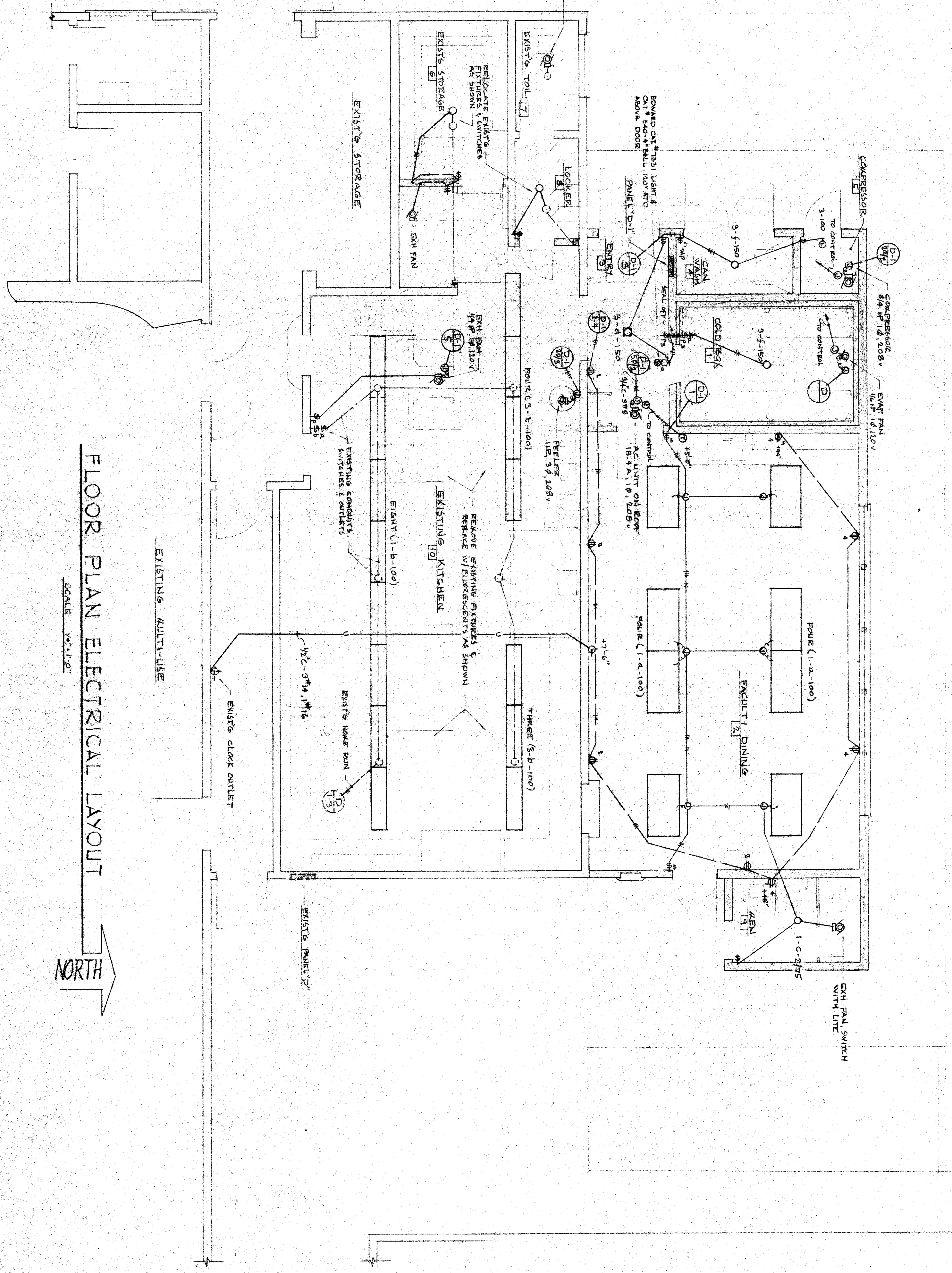

**EARTHQUAKE PROOFING OF LIGHTING FIXTURES**

If the fixture is a recessed type, it shall be secured to the ceiling structure by means of a seismic anchor. If the fixture is a surface mounted type, it shall be secured to the wall structure by means of a seismic anchor. The fixture shall be secured to the structure in any direction (X, Y, or Z) by means of a seismic anchor.

**ELECTRICAL SYMBOLS**

- ⊕ HOUSING AND/OR W/COVER
- ⊖ DISTRIBUTION PANEL
- ⊗ TRANSFORMER
- ⊙ JUNCTION BOX
- ⊕ CALLING OUTLET
- ⊖ WALL BRACKET OUTLET
- ⊙ QUANTITY UNIT
- ⊕ RECESSED UNIT
- ⊖ DUPLEX COMMUNICATOR OUTLET
- ⊙ WALL BRACKET OUTLET
- ⊕ FLOOR OUTLET - NATIONAL #500
- ⊖ FLOOR OUTLET AND DISCONNECT SWITCH
- ⊙ CLOCK OUTLET
- ⊕ PUBLIC TELEPHONE OUTLET
- ⊖ P.A. SPEAKER OUTLET
- ⊙ AIR CONDITIONER OUTLET
- ⊕ TRANSFORMER
- ⊖ 3-WAY SWITCH
- ⊙ 4-WAY SWITCH
- ⊕ KEY OPERATED SWITCH
- ⊖ THERMAL OVERLOAD SWITCH
- ⊙ SPECIAL OUTLET
- ⊕ SPECIAL CIRCUIT NUMBER
- ⊖ DIMETER, PHYSICAL TYPE
- ⊙ DIMETER, WALLTYPE
- ⊕ CONDUIT RUN IN FLOOR
- ⊖ CONDUIT RUN IN CEILING
- ⊙ FIRE ALARM STATION
- ⊕ PROCESSOR UNIT
- ⊖ POSITIONAL SOCKET RECESSED W/ PULL SWITCH
- ⊙ HORIZONTAL DUPLEX OUTLET
- ⊕ EXISTING OUTLET

**GENERAL NOTES**

1. VERIFY EXISTING LOCATION OF ALL EQUIPMENT ELECTRICAL OUTLETS, SWITCHES, AND/OR W/COVERS BEFORE PROCEEDING WITH THE WORK. REPORT ANY DISCREPANCIES TO THE ARCHITECT.
2. VERIFY EXISTING LOCATION OF ALL EQUIPMENT ELECTRICAL OUTLETS, SWITCHES, AND/OR W/COVERS BEFORE PROCEEDING WITH THE WORK. REPORT ANY DISCREPANCIES TO THE ARCHITECT.
3. VERIFY EXISTING LOCATION OF ALL EQUIPMENT ELECTRICAL OUTLETS, SWITCHES, AND/OR W/COVERS BEFORE PROCEEDING WITH THE WORK. REPORT ANY DISCREPANCIES TO THE ARCHITECT.
4. VERIFY EXISTING LOCATION OF ALL EQUIPMENT ELECTRICAL OUTLETS, SWITCHES, AND/OR W/COVERS BEFORE PROCEEDING WITH THE WORK. REPORT ANY DISCREPANCIES TO THE ARCHITECT.
5. VERIFY EXISTING LOCATION OF ALL EQUIPMENT ELECTRICAL OUTLETS, SWITCHES, AND/OR W/COVERS BEFORE PROCEEDING WITH THE WORK. REPORT ANY DISCREPANCIES TO THE ARCHITECT.
6. VERIFY EXISTING LOCATION OF ALL EQUIPMENT ELECTRICAL OUTLETS, SWITCHES, AND/OR W/COVERS BEFORE PROCEEDING WITH THE WORK. REPORT ANY DISCREPANCIES TO THE ARCHITECT.
7. VERIFY EXISTING LOCATION OF ALL EQUIPMENT ELECTRICAL OUTLETS, SWITCHES, AND/OR W/COVERS BEFORE PROCEEDING WITH THE WORK. REPORT ANY DISCREPANCIES TO THE ARCHITECT.
8. VERIFY EXISTING LOCATION OF ALL EQUIPMENT ELECTRICAL OUTLETS, SWITCHES, AND/OR W/COVERS BEFORE PROCEEDING WITH THE WORK. REPORT ANY DISCREPANCIES TO THE ARCHITECT.
9. VERIFY EXISTING LOCATION OF ALL EQUIPMENT ELECTRICAL OUTLETS, SWITCHES, AND/OR W/COVERS BEFORE PROCEEDING WITH THE WORK. REPORT ANY DISCREPANCIES TO THE ARCHITECT.
10. VERIFY EXISTING LOCATION OF ALL EQUIPMENT ELECTRICAL OUTLETS, SWITCHES, AND/OR W/COVERS BEFORE PROCEEDING WITH THE WORK. REPORT ANY DISCREPANCIES TO THE ARCHITECT.

**CODE RULES AND REGULATIONS**

All work and materials shall be in full accordance with the latest rules and regulations of the State Fire Marshal, Department of Industrial Relations, and the Department of Public Works, State of California. The contractor shall be responsible for obtaining all necessary permits and approvals from the appropriate authorities.

**OFFICE OF SUPERINTENDENT OF SCHOOLS**  
**STATE OF CALIFORNIA**  
**DEPARTMENT OF PUBLIC WORKS**  
**DIVISION OF ARCHITECTURE**

APPROVED: *[Signature]* DATE: 4-18-63

DATE OF ORIGINAL: 4-18-63

DATE OF REVISION: 4-18-63

REVISIONS:

NO.	DATE	REVISIONS
1		
2		
3		
4		
5		
6		
7		
8		
9		
10		
11		
12		
13		
14		
15		
16		
17		
18		
19		
20		
21		
22		
23		
24		
25		
26		
27		
28		
29		
30		
31		
32		
33		
34		
35		
36		
37		
38		
39		
40		
41		
42		
43		
44		
45		
46		
47		
48		
49		
50		
51		
52		
53		
54		
55		
56		
57		
58		
59		
60		
61		
62		
63		
64		
65		
66		
67		
68		
69		
70		
71		
72		
73		
74		
75		
76		
77		
78		
79		
80		
81		
82		
83		
84		
85		
86		
87		
88		
89		
90		
91		
92		
93		
94		
95		
96		
97		
98		
99		
100		

APPROVED: *[Signature]* DATE: 4-18-63

EDWARD LOWE  
 ELECTRICAL ENGINEER  
 1000 TULARE ST.  
 SACRAMENTO, CALIF.

ERNEST L. MICOY A. I. A.  
 ARCHITECT  
 1000 TULARE ST.  
 SACRAMENTO, CALIF.

STATE OF CALIFORNIA  
 STATE FIRE MARSHAL  
 Approved under Statutes of California

SCALE: 1/4" = 1'-0"

FACILITY DINING ROOM & WALK-IN BOX  
 BARNESFIELD DRIVE, SCHOOL DISTRICT  
 BARNESFIELD, CALIF.