

FLOOD ZONE	PARKING LOT #1	LEGEND
FLOOD ZONE DETERMINATION: ZONE "X" (0.2%) F.I.R.M. PANEL DESIGNATION: 06029C2306E EFFECTIVE F.I.R.M. DATE: 9/26/2008 BASE FLOOD ELEVATION (BFE): -400 FT COMMUNITY ORDINANCE: BMC 15.74.040	TOTAL STALLS PROVIDED: 52 ACCESSIBLE STALLS REQUIRED PER CBC TABLE 11B-6: 3 VAN SPACES REQUIRED (1 PER 11B-208.2.4): 1 ACCESSIBLE STALLS PROVIDED: 2 REGULAR, 1 VAN, 3 TOTAL	<ul style="list-style-type: none"> [Solid Box] INDICATES EXISTING BUILDING TO REMAIN (NO WORK) [Hatched Box] INDICATES NEW TEMPORARY BUILDING UNDER THIS APPLICATION [Dashed Line] INDICATES FIRE TRUCK ACCESS OVER AC PAVING [Dotted Line] INDICATES ACCESSIBLE PATH OF TRAVEL

LOCAL FIRE AUTHORITY REVIEW

810

To facilitate the Division of the State Architect's (DSA) approval of the Fire/Life Safety portion of a project, DSA requires Local Fire Authority (LFA) review of certain elements as identified in this form. Use of this form is mandatory for projects that add square footage to a campus or if any item on this form is relevant to the project. For additional information, see DSA 810 Instructions and DSA Policy 09-01.

PROJECT INFORMATION
 School District/Owner: Bakersfield City School District
 Project Name/School: Pioneer Elementary School
 Project Address: 4404 Pioneer Dr, Bakersfield Ca.

LOCAL FIRE AUTHORITY (LFA)
 LFA Agency Name: Kern County Fire
 LFA Reviewer Name: Jim Killam Title: Plan Reviewer
 Email: jkilam@kerncountyfire.org Telephone Number: 661.391.3313

I have reviewed and responded to the applicable items for this project as listed below.
 Note: Only sign this form when it is inserted into the site plan. A loose form is not acceptable to DSA.
 LFA Reviewer's Signature: [Signature] Date: 11/1/15
 Review Key: "Y" = Complies with LFA requirements "N" = Not approved (complete Section 8)
 "NA" = Not applicable to the project "NR" = LFA elects not to review

Description	Y	N	NA	NR
1 Where an elevator does not meet medical emergency service cab size, per the California Building Code (CBC), use of stairways for emergency rescue and patient transport is acceptable.			x	
2 Access roads, fire lane markings, pavers and gate entrances are in accordance with Title 19, California Code of Regulations and the California Fire Code, Chapter 5.	x			
3 Fire hydrant location and distribution complies with the California Fire Code (or see #4).	x			
4 Fire hydrant location and distribution complies with NFPA 1142, "Alternate Means." If "NR" is checked, DSA can only approve on-site water storage as an alternate. The signature of the school district official is required to acknowledge the use of alternate means.				x
Signature of School District Official: _____ Date: _____				
Print the School District Official's Name: _____				
5 The location(s) of the proposed post indicator valve and fire department connection meet the requirements of this jurisdiction.				x
6 The location(s) of the detector check valve assembly meet the requirements of this jurisdiction.	x			
7 Is the project located in a hazard severity zone area? (CBC, Chapter 7A, Section 701.A.) <input type="checkbox"/> Yes <input checked="" type="checkbox"/> No Check type if "Yes": <input type="checkbox"/> Moderate <input type="checkbox"/> High <input type="checkbox"/> Very High <input type="checkbox"/> WIFA (If one of these boxes is checked, the project design must meet the requirements of Chapter 7A.)				
COMMENTS (note deficiencies):				

Page 1 of 1
 DSA 810 (rev 05-12-14) DIVISION OF THE STATE ARCHITECT DEPARTMENT OF GENERAL SERVICES STATE OF CALIFORNIA

- ### KEYNOTES
- PROPERTY LINE
 - EXISTING CHAIN LINK FENCE TO REMAIN
 - EXISTING PARKING LOT AND STRIPING TO REMAIN
 - EXISTING BUILDING TO REMAIN (NO WORK)
 - EXISTING PLAY AREA TO REMAIN (NO WORK)
 - EXISTING A.C. PAVING TO REMAIN
 - EXISTING LAWN / TURF TO REMAIN
 - EXISTING PUBLIC ROADWAY TO REMAIN
 - ACCESSIBLE PATH OF TRAVEL (P.O.T.) REFER TO ACCESSIBILITY NOTE THIS SHEET
 - EXISTING DRIVE APPROACH TO REMAIN
 - EXISTING CONCRETE WALK TO REMAIN
 - 20' WIDE FIRE TRUCK ACCESS LANE
 - NEW CLASSROOM ON WOOD FOUNDATION W/ METAL RAMPS INSTALLED PER MANUFACTURERS DRAWINGS
 - EXISTING FIRE HYDRANT TO REMAIN
 - (E) ACCESSIBLE BOYS RESTROOM PER #03-113549
 - (E) ACCESSIBLE MENS RESTROOM PER #03-113549
 - (E) ACCESSIBLE WOMENS RESTROOM PER #03-113549
 - (E) ACCESSIBLE GIRLS RESTROOM PER #03-113549
 - EXISTING RAMP PER DSA APP #51927 W/ HANDRAILS PER DSA APP #03-113549
 - EXISTING ACCESSIBLE RAMP PER DSA APP #03-113549
 - EXISTING HI/LOW DRINKING FOUNTAIN PER DSA APP #03-113535
 - EXISTING 20' ACCESS GATE W/ KNOX BOX PER LOCAL FIRE MARSHAL REQUIREMENTS
 - EXISTING SITE ENTRANCE SIGN PER DSA APP #03-113549
 - ACCESSIBLE RESTROOM DIRECTIONAL SIGNAGE MOUNTED AT +80" MIN. ABOVE FINISH GRADE. SEE DETAIL 6/A1.03
 - NEW DETECTOR CHECK VALVE. PER BAKERSFIELD STANDARDS
 - NEW FIRE HYDRANT, PER BAKERSFIELD STANDARDS
 - NEW PIPE BOLLARDS, PER DETAIL 5/A1.03. TYP OF 5
 - NEW 8" FIRE LINE PER CITY STANDARDS

Ownership of Documents
 This document, the ideas and designs incorporated herein, as an instrument of Professional Service is the property of Integrated Designs by SOMAM, Inc. and is not to be used, in whole or in part for any other project without written authorization.
 © COPYRIGHT 2017

integrated designs by SOMAM, Inc.
 ARCHITECTURE - INTERIOR DESIGN - PROJECT MANAGEMENT
 6011 N. Fresno, Suite 130 - Fresno, California 93710
 Phone (559) 432-0887 Fax (559) 432-0887 E-Mail: design@somam.com
 www.integrateddesigns.com

Rev. No.	Rev. Date	Rev. Description

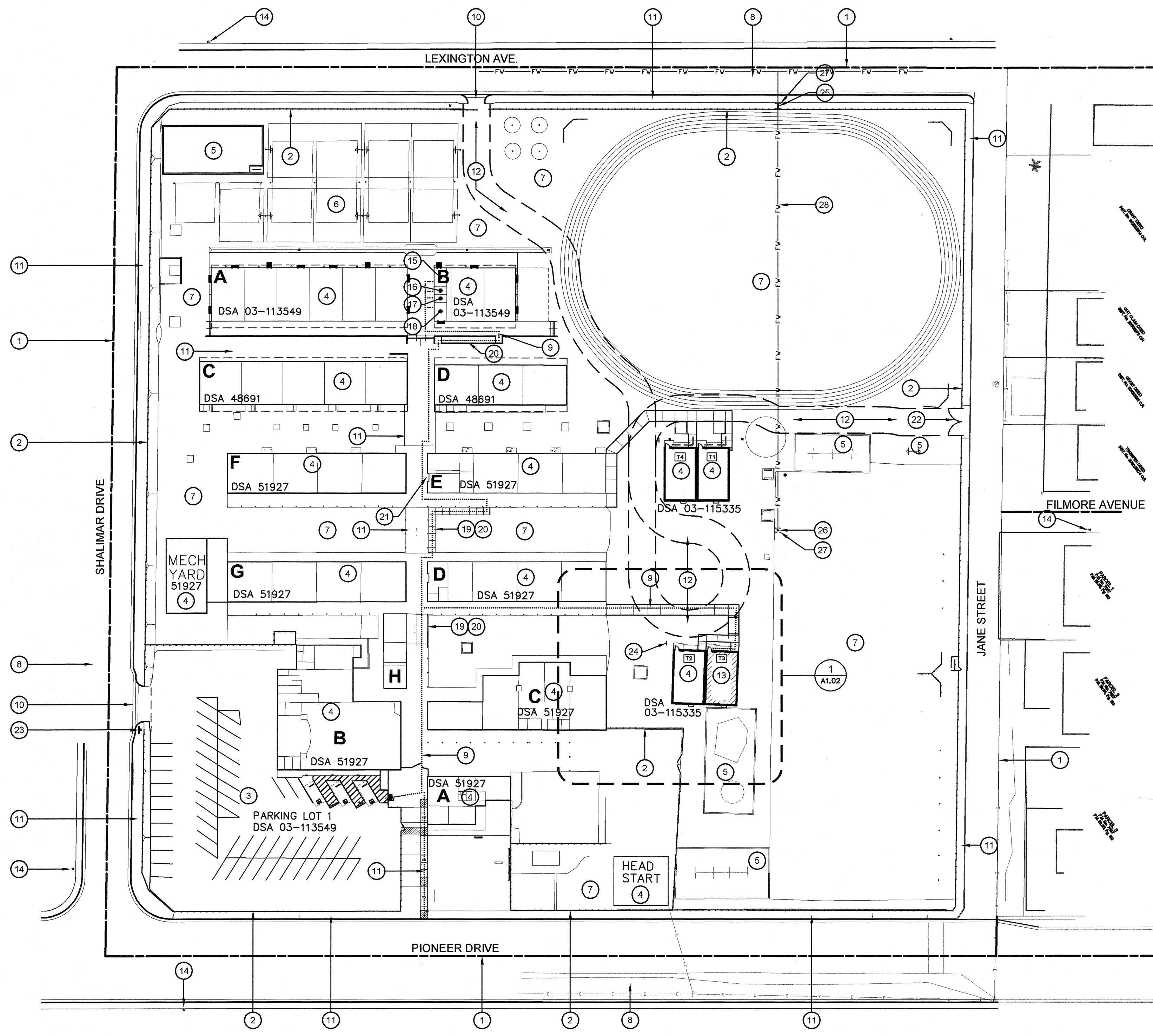

GENERAL NOTES

- GENERAL CONTRACTOR SHALL FIELD VERIFY ALL SITE CONDITIONS PRIOR TO BID. IF ANY DISCREPANCIES ARE FOUND, THE ARCHITECT SHALL BE NOTIFIED IN WRITING.
- CONTRACTOR SHALL BE RESPONSIBLE FOR THE CORRECTNESS OF LAYOUTS AND ESTABLISHED LOCATIONS OF BURIED UTILITY LINES. ANY UTILITIES REQUIRING RELOCATION SHALL BE THE RESPONSIBILITY OF THE GENERAL CONTRACTOR CONTACT APPLICABLE GOVERNING AGENCIES REGARDING ARRANGEMENT AND COORDINATION OF WORK.
- GENERAL CONTRACTOR WILL BE RESPONSIBLE FOR ANY COMPACTION RETEST DUE TO INITIAL FAILURE.
- PROJECT INSPECTOR SHALL BE EMPLOYED BY THE OWNER, APPROVED BY THE RESPONSIBLE ARCHITECT AND DSA.
- A COPY OF TITLE-24, ALL PARTS APPLICABLE, TO BE KEPT AT THE JOB SITE AT ALL TIMES.
- ADDENDA SHALL BE SIGNED BY THE ARCHITECT (RESPONSIBLE IN CHARGE) AND APPROVED BY DSA.
- C.C.D.s SHALL BE SIGNED BY THE ARCHITECT (RESPONSIBLE IN CHARGE), OWNER AND APPROVED BY DSA.
- TESTING LAB SHALL BE EMPLOYED BY THE OWNER, APPROVED BY THE RESPONSIBLE ARCHITECT AND DSA.
- ALL WORK SURFACES DISTURBED OR DAMAGED BY THE CONSTRUCTION ACTIVITIES SHALL BE REPAIRED IN KIND, TEXTURED AND FINISHED TO MATCH ADJACENT SURFACES.
- NEW CONCRETE WALKS SHALL HAVE SLOPES NOT TO EXCEED 1 IN 20 IN THE DIRECTION OF PATH OF TRAVEL. PROVIDE CONTROL JOINTS "C.J." AT 5'-0" o.c. MAX. AND EXPANSION JOINTS NOT TO EXCEED 30'-0" MAX. PROVIDE MEDIUM BROOM FINISH ON ALL WALKS.
- ALL BUILDING AND ROOM NAMES INDICATED ON THESE CONSTRUCTION DOCUMENTS ARE "NOT" THE ACTUAL BUILDING/ ROOM SIGNAGE DESIGNATION. THE GENERAL CONTRACTOR SHALL FURNISH, INSTALL AND COORDINATE ALL REQUIRED SIGNAGE WITH THE OWNER/ARCHITECT PRIOR TO STARTING CONSTRUCTION.
- GENERAL CONTRACTOR WILL BE RESPONSIBLE TO COORDINATE RELOCATABLE BUILDING DELIVERY DATES TO THE SCHOOL SITE WITH THE MFG.
- THE GENERAL CONTRACTOR SHALL CONSTRUCT ALL NEW RELOCATABLE BUILDING FOUNDATIONS AS PER THE RELOCATABLE BUILDING MANUFACTURER'S DRAWINGS AND SPECIFICATIONS.
- THE GENERAL CONTRACTOR SHALL BE RESPONSIBLE TO PROVIDE ALL HOOK-UPS TO THE RELOCATABLE BUILDINGS AFTER INSTALLATION HAS BEEN COMPLETED BY THE MANUFACTURER.
- 5'-0" DEEP x 5'-0" WIDE MINIMUM LANDINGS AT DOORWAYS SHALL BE AS DETAILED AND SHALL HAVE SLOPES (IN ANY DIRECTION) OF NOT GREATER THAN 1/4 IN 12 SLOPE. SLOPES SHALL BE AWAY FROM DOORWAYS.
- GENERAL/SITE CONTRACTOR SHALL FIELD VERIFY THAT EXISTING PATH OF TRAVEL (P.O.T.) IS A MINIMUM OF 4'-0" WIDE AND IS SLIP RESISTANT. IF IT IS NOT, THEN THE CONTRACTOR SHALL NOTIFY THE ARCHITECT OF RECORD AND A REMEDY OR ALTERNATE P.O.T. WILL BE PROVIDED.
- THE MAXIMUM DROP BETWEEN EXISTING FINISHED GRADES AND THE TOP OF THE P.O.T. SHOULD NOT EXCEED 4". IF IT DOES, PROVIDE THE NECESSARY WARNING CURB PER CBC SEC. 11B-303.5.

ACCESSIBILITY NOTES

THE PATH OF TRAVEL (P.O.T.) IDENTIFIED IN THESE CONSTRUCTION DOCUMENTS IS COMPLIANT WITH THE CURRENT APPLICABLE CALIFORNIA BUILDING CODE ACCESSIBILITY PROVISIONS FOR PATH OF TRAVEL REQUIREMENTS FOR ALTERATIONS, ADDITIONS AND STRUCTURAL REPAIRS. AS PART OF THE DESIGN OF THIS PROJECT, THE P.O.T. WAS EXAMINED AND ANY ELEMENTS, COMPONENTS OR PORTIONS OF THE P.O.T. THAT WERE DETERMINED TO BE NONCOMPLIANT 1) HAVE BEEN IDENTIFIED AND 2) THE CORRECTIVE WORK NECESSARY TO BRING THEM INTO COMPLIANCE HAS BEEN INCLUDED WITHIN THE SCOPE OF THIS PROJECT'S WORK THROUGH DETAILS, DRAWINGS AND SPECIFICATIONS INCORPORATED INTO THESE CONSTRUCTION DOCUMENTS. ANY NONCOMPLIANT ELEMENTS, COMPONENTS OR PORTIONS OF THE P.O.T. THAT WILL NOT BE CORRECTED BY THIS PROJECT BASED ON VALUATION THRESHOLD LIMITATIONS OR A FINDING OF UNREASONABLE HARDSHIP ARE SO INDICATED IN THESE CONSTRUCTION DOCUMENTS.

DURING CONSTRUCTION, IF P.O.T. ITEMS WITHIN THE SCOPE OF THE PROJECT REPRESENTED AS CODE COMPLIANT ARE FOUND TO BE NONCOMPLYING BEYOND REASONABLE CONSTRUCTION TOLERANCES, THEY SHALL BE BROUGHT INTO COMPLIANCE WITH THE CBC AS A PART OF THIS PROJECT BY MEANS OF A CONSTRUCTION CHANGE DOCUMENT.

ARCHITECT HAS INSPECTED THE PATH OF TRAVEL (P.O.T.) AS INDICATED ON THE PLANS AND HAS FOUND IT TO BE, OR HAS INDICATED ON THE PLANS REMEDIAL WORK WHICH WOULD CAUSE IT TO BE, A BARRIER-FREE ACCESSIBLE ROUTE:

- AT LEAST 48" IN WIDTH; OR AS APPROVED BY CODE
- FREE OF ABRUPT LEVEL CHANGES EXCEEDING 3/4" IF BEVELED AT 1:2 MAX SLOPE, OR VERTICAL LEVEL CHANGES EXCEEDING 3/4"
- WITH A FIRM, STABLE, AND SLIP RESISTANT WALKING SURFACE
- WITH A RUNNING SLOPE OF 1:20 (5%) OR LESS AND WITH A CROSS SLOPE OF 1:50 (2%) OR LESS OR A RAMP WITH A RUNNING SLOPE OF 1:12 (8.33%) AND A CROSS SLOPE OF 1:50 (2%) WITH APPROPRIATE REQUIREMENTS AS DETAILED WITHIN THIS SET OF DOCUMENTS.
- IS FREE OF OVERHEAD OBSTRUCTIONS WITHIN 80" ABOVE THE WALKING SURFACE
- IS FREE OF OBJECTS WHICH PROTRUDE MORE THAN 4" BETWEEN THE HEIGHTS OF 27" AND 80" ABOVE THE WALKING SURFACE

OVERALL SITE PLAN
PORTABLE CLASSROOM

SCALE: 1" = 50'

OVERALL SITE PLAN

PIONEER ELEMENTARY SCHOOL
 BAKERSFIELD CITY SCHOOL DISTRICT
 4404 PIONEER DR. BAKERSFIELD, CA.

Issue Date: 7/31/17 Date: 10/18/18
 Designer: _____
 DR: _____
 PC: _____
 RJD

Agency Approval Stamp:
 FILE # 15-6
 IDENTIFICATION STAMP
 DIV. OF THE STATE ARCHITECT
 OFFICE OF REGULATION SERVICES
 03-118271
 AC: [Signature]
 DATE: NOV 14 2018
 TRACKING #: 63321-294

Stamp(s):

Job No.: **5289**

Sheet No.: **A1.01**

Release: -