

Scale bars for various dimensions: 1" = 40'-0", 1" = 30'-0", 1" = 20'-0", 1/8" = 1'-0", 1/4" = 1'-0".

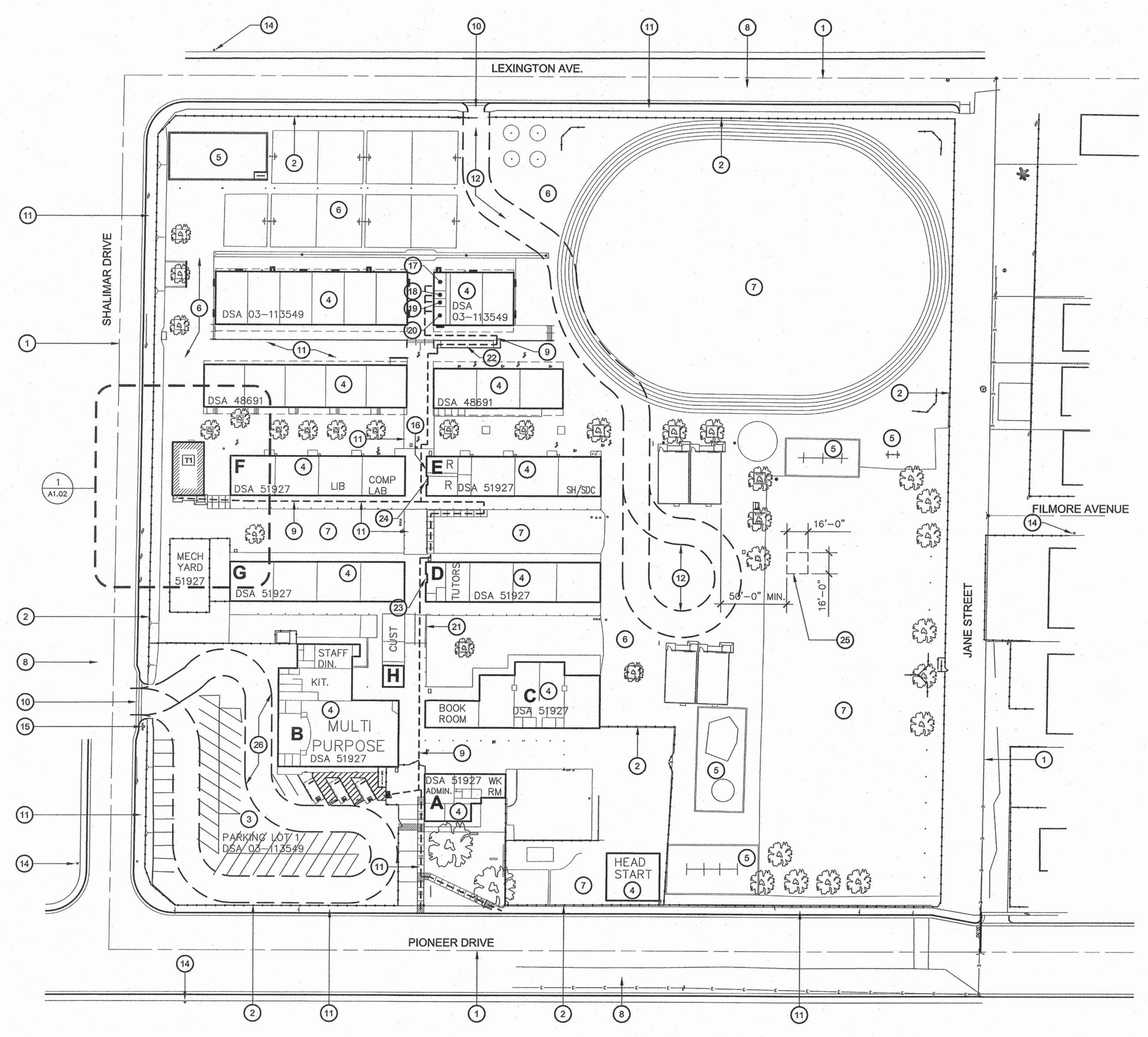

**OVERALL SITE PLAN
PIONEER ELEMENTARY**

SCALE: 1" = 50'

KEYNOTES		GENERAL NOTES	
1. PROPERTY LINE		A. GENERAL CONTRACTOR SHALL FIELD VERIFY ALL SITE CONDITIONS PRIOR TO BID. IF ANY DISCREPANCIES ARE FOUND, THE ARCHITECT SHALL BE NOTIFIED IN WRITING.	
2. EXISTING CHAIN LINK FENCE TO REMAIN		B. CONTRACTOR SHALL BE RESPONSIBLE FOR THE CORRECTNESS OF LAYOUTS AND ESTABLISHED LOCATIONS OF BURIED UTILITY LINES. ANY UTILITIES REQUIRING RELOCATION SHALL BE THE RESPONSIBILITY OF THE GENERAL CONTRACTOR. CONTACT APPLICABLE GOVERNING AGENCIES REGARDING ARRANGEMENT AND COORDINATION OF WORK.	
3. EXISTING PARKING LOT AND STRIPING TO REMAIN		C. GENERAL CONTRACTOR WILL BE RESPONSIBLE FOR ANY COMPACTION RETEST DUE TO INITIAL FAILURE.	
4. EXISTING BUILDING TO REMAIN (NO WORK)		D. PROJECT INSPECTOR SHALL BE EMPLOYED BY THE OWNER, APPROVED BY THE RESPONSIBLE ARCHITECT AND DSA.	
5. EXISTING PLAY AREA TO REMAIN (NO WORK)		E. A COPY OF TITLE-24, ALL PARTS APPLICABLE, TO BE KEPT AT THE JOB SITE AT ALL TIMES.	
6. EXISTING A.C. PAVING TO REMAIN		F. ADDENDA SHALL BE SIGNED BY THE ARCHITECT (RESPONSIBLE IN CHARGE) AND APPROVED BY DSA.	
7. EXISTING LAWN / TURF TO REMAIN		G. C.C.D.s SHALL BE SIGNED BY THE ARCHITECT (RESPONSIBLE IN CHARGE), OWNER AND APPROVED BY DSA.	
8. EXISTING PUBLIC ROADWAY TO REMAIN		H. TESTING LAB SHALL BE EMPLOYED BY THE OWNER, APPROVED BY THE RESPONSIBLE ARCHITECT AND DSA.	
9. PROPOSED ACCESSIBLE PATH OF TRAVEL (P.O.T.)		I. ALL WORK SURFACES DISTURBED OR DAMAGED BY THE CONSTRUCTION ACTIVITIES SHALL BE REPAIRED IN KIND, TEXTURED AND FINISHED TO MATCH ADJACENT SURFACES.	
10. EXISTING DRIVE APPROACH TO REMAIN		J. NEW CONCRETE WALKS SHALL HAVE SLOPES NOT TO EXCEED 1 IN 20 IN THE DIRECTION OF PATH OF TRAVEL. PROVIDE CONTROL JOINTS "C.J." AT 5'-0" o.c. MAX. AND EXPANSION JOINTS NOT TO EXCEED 30'-0" MAX. PROVIDE MEDIUM BROOM FINISH ON ALL WALKS.	
11. EXISTING CONCRETE WALK TO REMAIN		K. ALL BUILDING AND ROOM NAMES INDICATED ON THESE CONSTRUCTION DOCUMENTS ARE "NOT" THE ACTUAL BUILDING/ ROOM SIGNAGE DESIGNATION. THE GENERAL CONTRACTOR SHALL FURNISH, INSTALL AND COORDINATE ALL REQUIRED SIGNAGE WITH THE OWNER/ARCHITECT PRIOR TO STARTING CONSTRUCTION.	
12. EXISTING 20' WIDE FIRE TRUCK ACCESS LANE		L. GENERAL CONTRACTOR WILL BE RESPONSIBLE TO COORDINATE RELOCATABLE BUILDING DELIVERY DATES TO THE SCHOOL SITE WITH THE MFG.	
13. NOT USED		M. THE GENERAL CONTRACTOR SHALL CONSTRUCT ALL NEW RELOCATABLE BUILDING FOUNDATIONS AS PER THE RELOCATABLE BUILDING MANUFACTURER'S DRAWINGS AND SPECIFICATIONS.	
14. EXISTING FIRE HYDRANT TO REMAIN		N. THE GENERAL CONTRACTOR SHALL BE RESPONSIBLE TO PROVIDE ALL HOOK-UPS TO THE RELOCATABLE BUILDINGS AFTER INSTALLATION HAS BEEN COMPLETED BY THE MANUFACTURER.	
15. EXISTING SITE ENTRANCE SIGN PER DSA APP #03-113549		O. 5'-0" DEEP x 5'-0" WIDE MINIMUM LANDINGS AT DOORWAYS SHALL BE AS DETAILED AND SHALL HAVE SLOPES (IN ANY DIRECTION) OF NOT GREATER THAN 1/4 IN 12 SLOPE. SLOPES SHALL BE AWAY FROM DOORWAYS.	
16. EXISTING ACCESSIBLE RESTROOM DIRECTIONAL SIGN PER DSA APP #03-115335		P. GENERAL/SITE CONTRACTOR SHALL FIELD VERIFY THAT EXISTING PATH OF TRAVEL (P.O.T.) IS A MINIMUM OF 4'-0" WIDE AND IS SLIP RESISTANT. IF IT IS NOT, THEN THE CONTRACTOR SHALL NOTIFY THE ARCHITECT OF RECORD AND A REMEDY OR ALTERNATE P.O.T. WILL BE PROVIDED.	
17. (E) ACCESSIBLE BOYS RESTROOM PER #03-113549		Q. THE MAXIMUM DROP BETWEEN EXISTING FINISHED GRADES AND THE TOP OF THE P.O.T. SHOULD NOT EXCEED 4". IF IT DOES, PROVIDE THE NECESSARY WARNING CURB PER CBC SEC. 11B-303.5.	
18. (E) ACCESSIBLE MENS RESTROOM PER #03-113549			
19. (E) ACCESSIBLE WOMENS RESTROOM PER #03-113549			
20. (E) ACCESSIBLE GIRLS RESTROOM PER #03-113549			
21. EXISTING RAMP PER DSA APP #51927 w/ EXISTING HANDRAIL PER DSA APP #03-113549			
22. EXISTING ACCESSIBLE RAMP PER DSA APP #03-113549			
23. EXISTING DRINKING FOUNTAIN PER DSA APP #51927			
24. EXISTING HI-LOW ACCESSIBLE DRINKING FOUNTAIN PER DSA APP #03-115335			
25. SAFE DISPERSAL AREA			
26. PROPOSED 20' WIDE FIRE TRUCK ACCESS LANE			
SAFE DISPERSAL		ACCESSIBILITY NOTES	
TEMP CLASSROOM 1 CLASSROOM @ 960 S.F.		ARCHITECT HAS INSPECTED THE PATH OF TRAVEL (P.O.T.) AS INDICATED ON THE PLANS AND HAS FOUND IT TO BE, OR HAS INDICATED ON THE PLANS REMEDIAL WORK WHICH WOULD CAUSE IT TO BE, A BARRIER-FREE ACCESSIBLE ROUTE:	
960 S.F. / 20 S.F. PER OCCUPANT = 48 OCCUPANTS		• AT LEAST 48" IN WIDTH; OR AS APPROVED BY CODE	
48 OCCUPANTS x 5 S.F. / OCCUPANT = 240 S.F. REQ'D		• FREE OF ABRUPT LEVEL CHANGES EXCEEDING 1/4" IF BEVELED AT 1:2 MAX SLOPE, OR VERTICAL LEVEL CHANGES EXCEEDING 3/4"	
256 S.F. PROVIDED = 40 OK		• WITH A FIRM, STABLE, AND SLIP RESISTANT WALKING SURFACE	
PARKING LOT		• WITH A RUNNING SLOPE OF 1:20 (5%) OR LESS AND WITH A CROSS SLOPE OF 1:50 (2%) OR LESS OR A RAMP WITH A RUNNING SLOPE OF 1:12 (8.33%) AND A CROSS SLOPE OF 1:50 (2%) WITH APPROPRIATE REQUIREMENTS AS DETAILED WITHIN THIS SET OF DOCUMENTS.	
TOTAL STALLS PROVIDED: 52		• IS FREE OF OVERHEAD OBSTRUCTIONS WITHIN 80" ABOVE THE WALKING SURFACE	
ACCESSIBLE STALLS REQUIRED PER CBC TABLE 11B-208.2: 3		• IS FREE OF OBJECTS WHICH PROTRUDE MORE THAN 4" BETWEEN THE HEIGHTS OF 27" AND 80" ABOVE THE WALKING SURFACE	
VAN SPACES REQUIRED (1 PER 6 ADA): 1			
ACCESSIBLE STALLS PROVIDED: 2 REGULAR, 1 VAN, 3 TOTAL			
LOCAL FIRE AUTHORITY REVIEW		LEGEND	
<p>BAKERSFIELD LOCAL FIRE AUTHORITY REVIEW</p> <p>School District: BAKERSFIELD CITY SCHOOL DISTRICT Project address: PIONEER ELEMENTARY 4404 PIONEER DRIVE, BAKERSFIELD, CA 93306</p> <p>Local Fire Authority to examine Sections 1-7 as applicable to this project, and any other applicable sections of the Building Code, the Local Fire Authority approves the use of stairways for emergency egress and related equipment.</p> <p>SEAL: YES* Complies with LFA Requirements. NO** Not applicable to this project. *** LFA allows not to seal. No checks mark = not approved. Complete Section 7.</p> <p>YES: N/A. NO: []</p> <p>When all fire alarm devices meet minimum emergency egress code, per CBC California Building Code, the Local Fire Authority approves the use of stairways for emergency egress and related equipment.</p> <p>Access Route: [] Access Route, Fire Lane Meetings, egress and Gas Egress are in accordance with Title 24, Code of Regulations, & 2019 California Fire Code, Chapter 7.</p> <p>Fire Alarm: [] Fire Alarm location and distribution complies with 2019 CFC, 2019 NFPA 1142 (Standard for when fire is detected, CFA can only verify on-site water storage in an alternate source. Signature of the School District Official is required to acknowledge use of NFPA 1142 as LFA alternate means.</p> <p>SIGNATURE OF SCHOOL DISTRICT OFFICIAL: (Sign and Print name and Title) []</p> <p>Automatic Fire Sprinkler System: []</p> <p>Location of the proposed Pull Station: Valve and Fire Dept. Connection meet the requirements of the jurisdiction: []</p> <p>The location of the Detector Check Valve Assembly meet the requirements of the jurisdiction: []</p> <p>In-situ tested in a tested fire alarm zone: 2019 CFC, Chapter 7A, Section 704.3.1: []</p> <p>Fire Alarm Control Panel (FACP) Type (check one): Manual [] High [] Very High [] WFA [] (Print or check one box to indicate type of device used for testing purposes.)</p> <p>7. COMMENTS: None Defined.</p>		<p>INDICATES EXISTING BUILDING TO REMAIN (NO WORK)</p> <p>INDICATES NEW TEMPORARY BUILDING UNDER THIS APPLICATION</p> <p>INDICATES FIRE TRUCK ACCESS OVER AC PAVING</p> <p>HALF-TONE DASHED LINE INDICATES ACCESSIBLE PATH OF TRAVEL</p>	
<p>LOCAL FIRE AUTHORITY INFORMATION:</p> <p>AGENCY NAME (Print): Kern County Fire Department ADDRESS (Print): 5542 Victor St. CITY/STATE/ZIP (Print): Bakersfield, CA 93308</p> <p>PHONE NUMBER (Print): (805) 391-7000 www.DBUCK@CO.KERN.CA.US</p> <p>Completion of this 7.0 inspection report represents agreement that the LFA representative and LFA engineer have verified that the Local Fire Authority has reviewed the final plans for this project. Plans not checked or marked "NO" will not be reviewed by the LFA. Note: Only after the DSA #18 when issued onto the site plan. Losses from our records to DSA.</p> <p>REVIEWED BY: DARRELL BUCK (Signature) 4-14-14 FAN TITLE (Print): FIRE INSPECTOR</p>		<p>AGENCY APPROVAL STAMP</p> <p>IDENTIFICATION STAMP DIV. OF THE STATE ARCHITECT</p> <p>APPROX 115740 ARCHITECT'S SEAL DATE MAY 14 2014</p> <p>Stamp(s):</p> <p>Job No.: 5117</p> <p>Sheet No.: A1.01</p> <p>Release - LFA</p>	
<p>Ownership of Documents: This document, the ideas and designs incorporated herein, as an instrument of Professional Service is the property of Integrated Designs by SOMAM, Inc. and is not to be used, in whole or in part for any other project without written authorization. © COPYRIGHT 2014</p> <p>integrated designs by SOMAM, Inc. ARCHITECTURE • ENGINEERING • INTERIOR DESIGN • CONSTRUCTION MANAGEMENT 6011 N. Fresno, Suite 130 Fresno, CA 93710 Phone (559) 438-0881 Fax (559) 438-0887 E-Mail: design@somam.com www.integrateddesigns.com</p>			