

BILL OF MATERIALS				
MARK	QTY.	SIZE OR MODEL NO.	DESCRIPTION	REMARKS

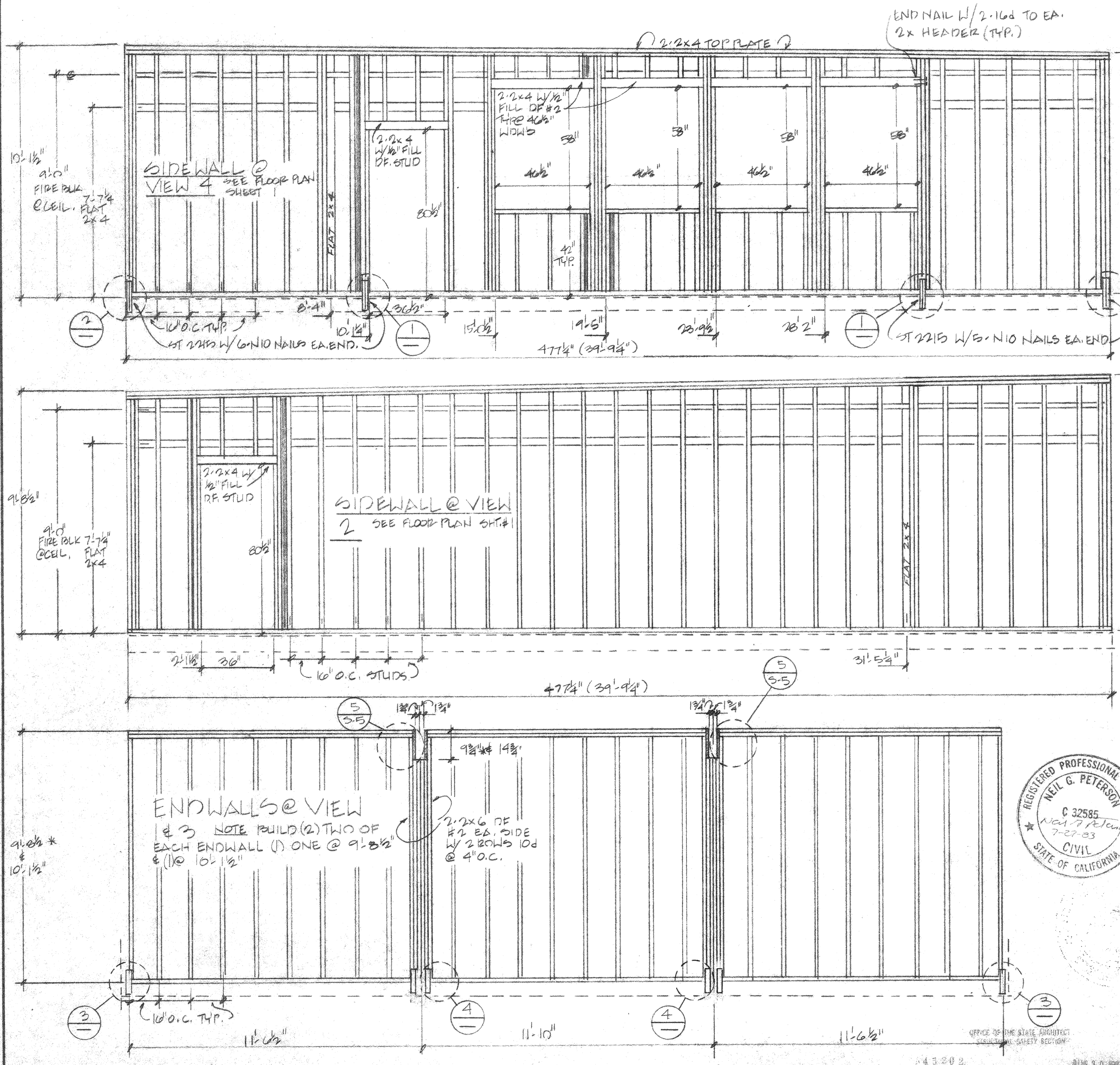

- NOTES:
1. FASTEN MULTI-STUDS W/ 12d @ 10" O.C. EXCEPT WHERE NOTED.
 2. FASTEN HEADERS TOGETHER W/ 12d @ 8" O.C. STAGGERED.
 3. FASTEN DOUBLE TOP PLATE W/ 16d @ 10" ON CENTER. MIN. 4'-0" LAP W/ 16d @ 3" O.C. @ SPLICE LAP
 4. END NAIL ALL STUDS TO PLATES W/ 2-16d
 5. FASTEN ENDWALLS TO SIDE WALLS W/ 16d @ 6" O.C.
 6. ALL PLYWOOD EDGES TO BE BLOCKED
 7. NAIL WALLS TO FLOOR W/ 8d NAIL @ 8" O.C.
 8. ALL WALL FRAMING IS 2x4 @ 16" O.C. DF. CONST. GRADE OR BTR.
 9. SEE WALL PLANS FOR REQ'D STUDS EA. SIDE OF OPENINGS.
 10. ALL SILLS ARE 2x4 STUD FLAT. END NAIL TO STUDS W/ 2-16d
 11. EXTERIOR PLYWOOD (M.P.S.O.) TO STUDS W/ 8d BOX NAILS @ 6" O.C. EDGES & 12" O.C. FIELD. MACHINE NAILING TO BE DONE IN A HORIZONTAL POSITION ONLY. NAILS TO BE HOT DIPPED GAL. OR EQUAL

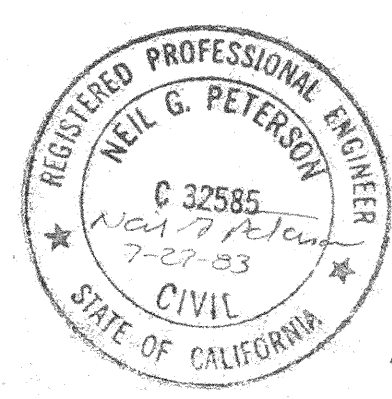
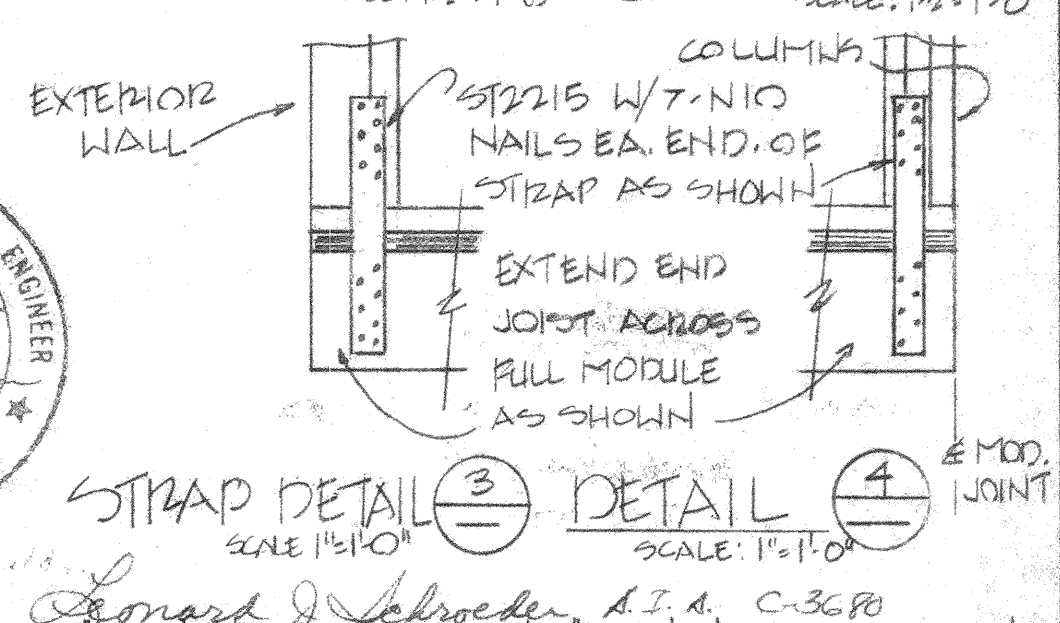
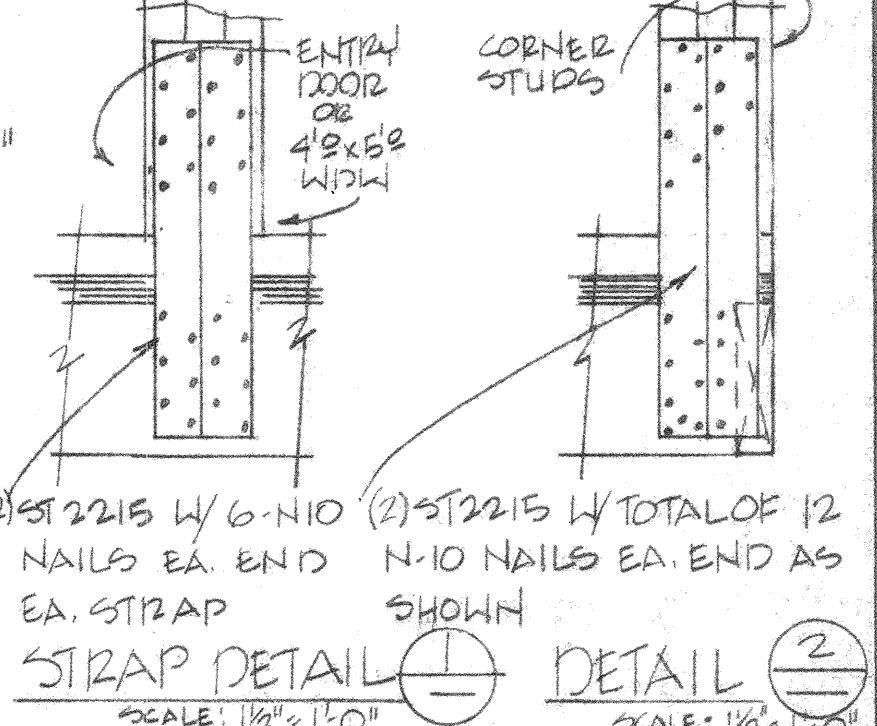

Date	By	No.	Date	By	No.
REVISIONS					
Project: BAKERSFIELD CITY SCHOOL DIST.					
Title: WALL FRAMING (KINDERGARTEN)					
Scale: 3/8" = 1'-0"					
Date: 7-25-83					
Dwn. By: CTM.					
Ckd. By:					
Project: TELLUS CORPORATION					
7340 FRENCH ROAD SACRAMENTO CA.					
PLANT					
COLTON, CA. SACRAMENTO, CA. SALEM, ORG. BOISE, IDAHO					