

**NOTES**

1. MODULE UNIT MFC SHALL FURNISH & INSTALL ALL REQ'D. BRUSH IN MFC'S INCLUDING BUT NOT NECESSARILY LIMITED TO THE FOLLOWING: ALL VENT PIPING, CLEANINGS IN WALLS, PUMP PIPING, WASTE PIPING, ETC. AS MAY BE INDICATED ON DRAWINGS & NOT IN LOCATIONS AS TO FACILITATE THE CONNECTION OF FINISH PLUMBING (FINISH PLUMBING BY OTHERS). NO PIPING SHALL BE EXPOSED IN BUILDING. MODULE UNIT MFC SHALL STRIP OUT OF BUILDING AT POINTS ACCESSIBLE TO THE SCHOOL DISTRICT FOR FINAL CONNECTIONS.
2. EVAPORATIVE COOLERS SHALL BE FURNISHED & INSTALLED BY THE MODULE UNIT MFC - COMPLETE WITH REMOTE CONTROL. LABELLED WITH THE FOLLOWING: PUMP-VENT-COOL-OFF. THERE SHALL ALSO BE INSTALLED ONE (1) SHUT-OFF VALVE LOCATED IN CONVENIENT LOCATION ALONG WITH THE PUMP STRIPS UP THRU ROOF TO EA. EVAPORATIVE COOLER. COOLERS SHALL BE COMPLETE WITH PUMP MOTORS, BELTS, BELTS & PUMPS. REFER TO SHT A-2 FOR LOCATIONS.
3. GAS UNIT HEATERS SHALL BE FURNISHED & INSTALLED BY THE MODULE UNIT MFC - COMPLETE WITH ALL NECESSARY EQUIPMENT TO PLACE IN OPERATION, INCLUDING STRIP OUT OF BUILDINGS WITH GAS PIPING, FOR FINAL CONNECTION BY SCHOOL DISTRICT.
4. ALL FINISH PLUMBING SUCH AS WATER CLOSETS, LAVS, SINKS, TRAPS, SUPPLIES & FAUCETS ETC. SHALL BE FURNISHED & INSTALLED BY THE SCHOOL DISTRICT.

**NOTE:**

1. ELECTRIC - CONNECT NEW MODULES TO THE NEAREST AVAILABLE ELECTRICAL SOURCE ON SITE - FIELD VERIFY FOR EXACT LOCATIONS & VOLTAGE (N.I.C.)
2. PLUMBING - CONNECT NEW MODULES TO NEAREST AVAILABLE SEWER, GAS, & WATER - VERIFY FOR EXACT LOCATIONS & SIZES (N.I.C.)
3. HEATING UNIT - REMOVE VENTURON & EXH - SERIES GAS FIREP UNIT HEATER - SUSPENDED FROM CEILING EXPOSED IN ROOM - OUTSIDE VENTED & ENERGY EFFICIENT - USE BRONZE OR BRUAL, BY MODULE UNIT MFC - TO INCLUDE THERMOSTAT
4. EVAPORATIVE COOLER - MCGRAW, EPISON - REMV HEATP EVAPORATIVE COOLER - BASE CALCULATIONS ON A 2 1/2 MIN AIR CHANGE - EXH TOP MOUNTED UNIT MCGRAW EPISON OR BRUAL, BY MODULE UNIT MFC
5. EXHAUST FANS - MUST BE CAPABLE OF EXHAUSTING ONE COMPLETE AIR CHANGE EVERY 2 MIN - INTERLOCK TO LT SWITCH, FURNISHED & INSTALLED BY MODULE UNIT MFC

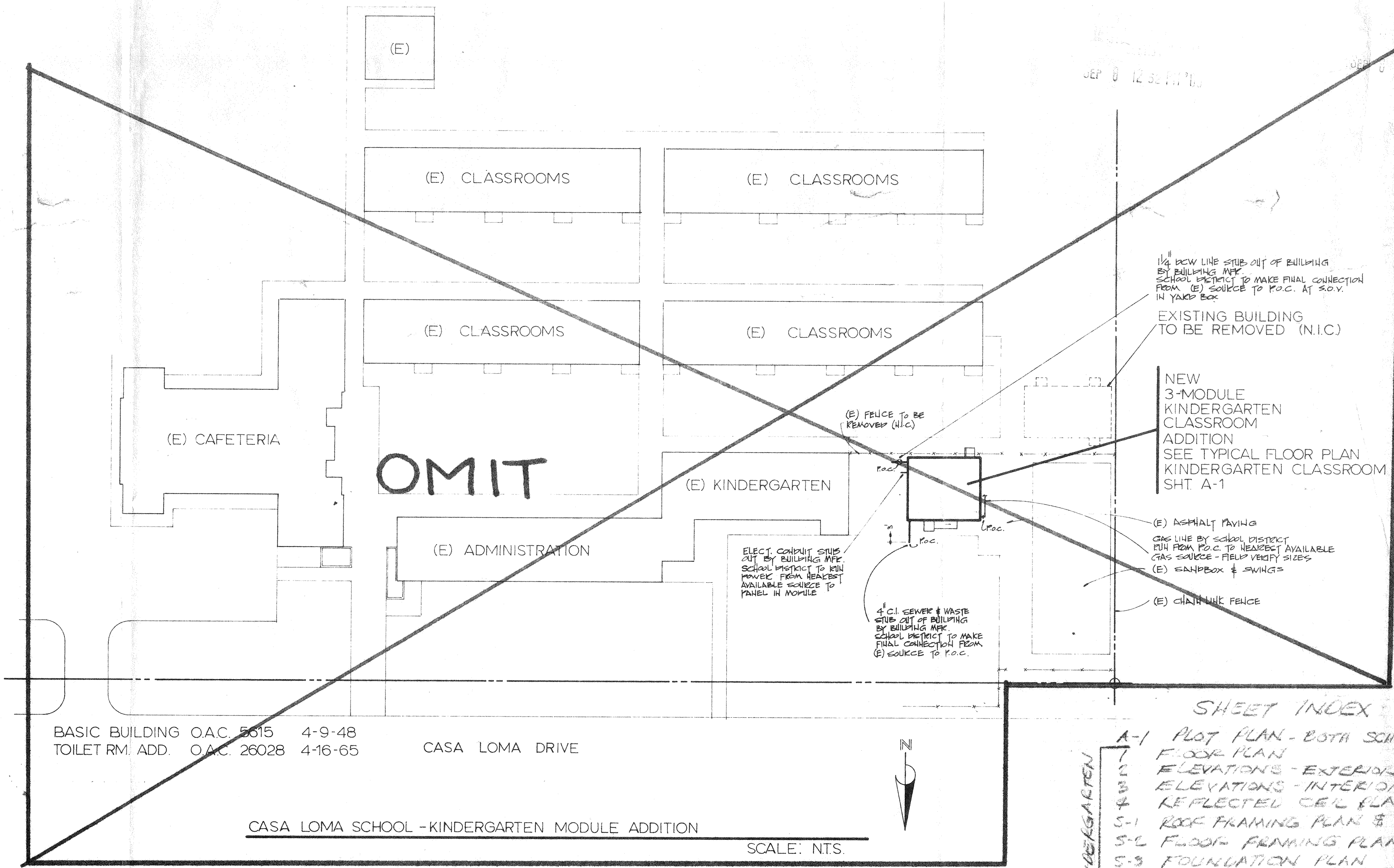

BASIC BUILDING O.A.C. 5615 4-9-48  
TOILET RM. ADD. O.A.C. 26028 4-16-65  
CASA LOMA DRIVE

CASA LOMA SCHOOL - KINDERGARTEN MODULE ADDITION

SCALE: N.T.S.

**SHEET INDEX**

<b>A-1</b>	<b>PLOT PLAN - BOTH SCHOOLS</b>
<b>FLOOR PLAN</b>	
<b>ELEVATIONS - EXTERIOR</b>	
<b>ELEVATIONS - INTERIOR</b>	
<b>REFLECTED CEILING PLAN</b>	
<b>S-1</b>	<b>ROOF FRAMING PLAN &amp; DETAILS</b>
<b>S-2</b>	<b>FLOOR FRAMING PLAN</b>
<b>S-3</b>	<b>FOUNDATION PLAN</b>
<b>S-4</b>	<b>WALL FRAMING</b>
<b>S-5</b>	<b>DETAILS</b>
<b>S-6</b>	<b>RAMP PLANS &amp; DETAILS</b>

**NEW 5 MODULE CLASSROOMS**  
SEE TYPICAL CLASSROOM SHT A-1 (TYP FOR 5)

**NOTE:**  
FOR CLOSURE PANELS BETWEEN BUILDING MODULES, SEE BUILDING SHT A-1 FOR MFC.

**NOTE:**  
GAS LINES BY SCHOOL DISTRICT RUN FROM P.O.C. TO NEAREST AVAILABLE GAS SOURCE - FIELD VERIFY FOR SIZES

**NOTE:**  
1/4" NEW LINE STRIP OUT OF BUILDING BY BUILDING MFC - SCHOOL DISTRICT TO MAKE FINAL CONNECTION FROM (E) SOURCE TO P.O.C. AT S.O.V. IN YARD BOX

**NOTE:**  
1/4" NEW LINE STRIP OUT OF BUILDING BY BUILDING MFC - SCHOOL DISTRICT TO MAKE FINAL CONNECTION FROM (E) SOURCE TO P.O.C. AT S.O.V. IN YARD BOX

**NOTE:**  
WRITE FRAMES IN UNITS & REND TO BACK TO UNIT NUMBER 1 PANEL BY MODULE UNIT MFC - SCHOOL DISTRICT WILL PICK UP AT STRIP OUT & RUN TO NEAREST AVAILABLE SOURCE

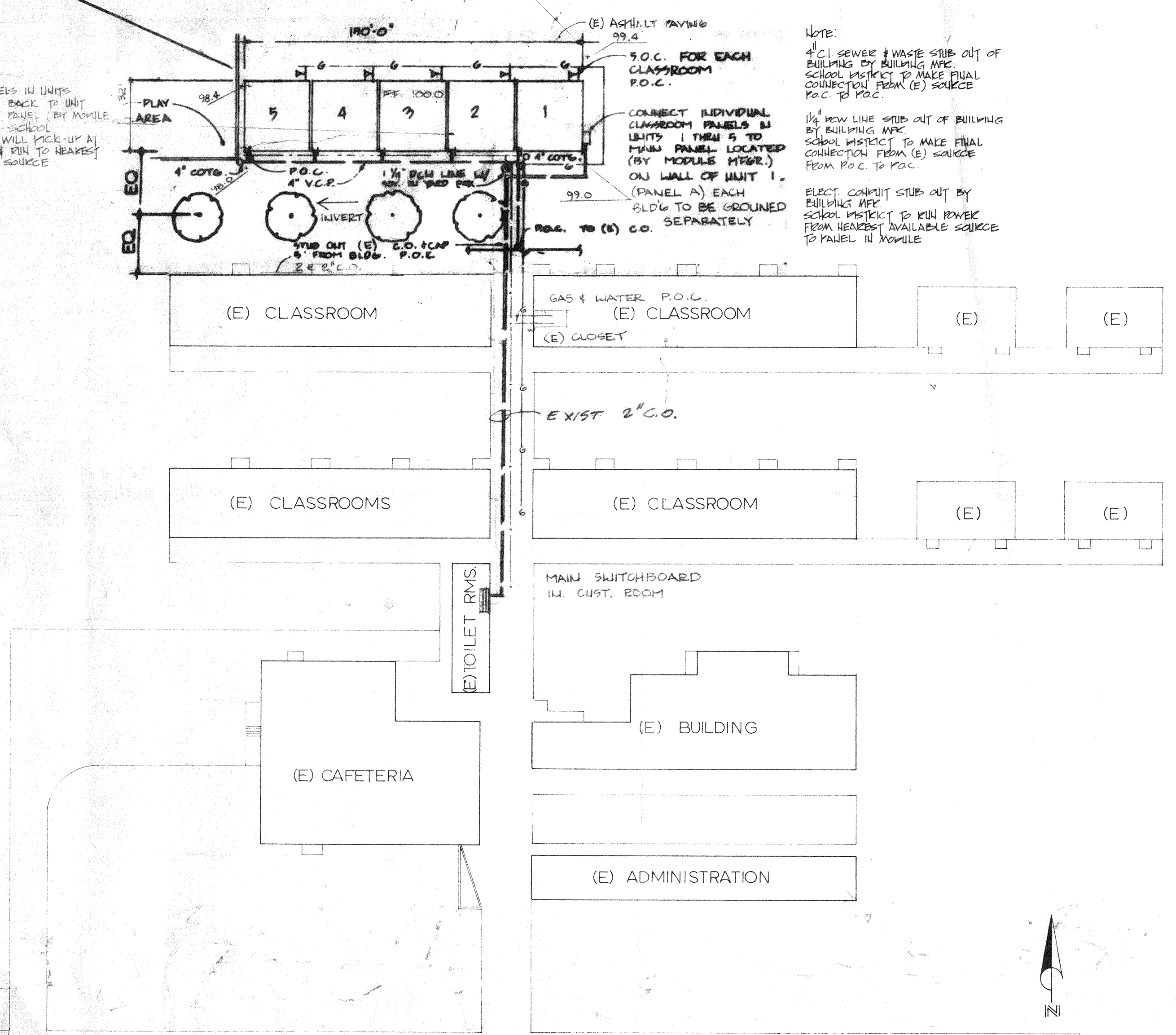

BASIC BUILDING O.A.C. 5743 7-22-48  
ADDITION TO ADMIN. O.A.C. 33074 5-21-81  
O.A.C. A43986 12-3-81

PIONEER SCHOOL - 5 MODULAR CLASSROOM ADDITIONS

SCALE: N.T.S.

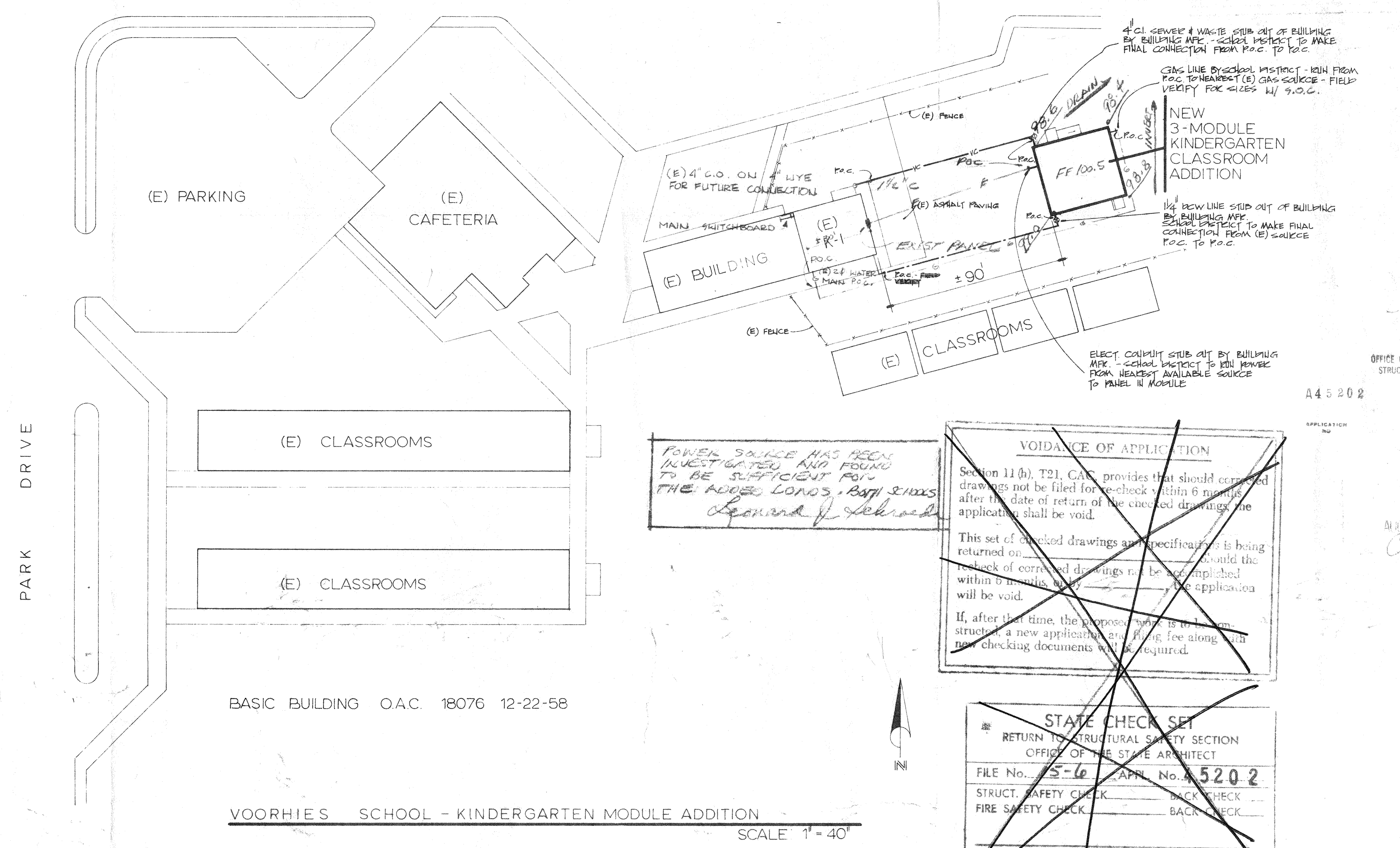

BASIC BUILDING O.A.C. 18076 12-22-58

VOORHIES SCHOOL - KINDERGARTEN MODULE ADDITION

SCALE: 1" = 40'

**POWER SOURCE HAS BEEN DETERMINED AND FOUND TO BE SUFFICIENT FOR THE ABOVE LOADS. BUT RINGS**  
*Leonard J. Schroeder*

**VOIDANCE OF APPLICATION**  
Section 11 (b), T21, C.A.S. provides that should corrected drawings not be filed for re-check within 6 months after the date of return of the corrected drawings, the application shall be void.  
This set of corrected drawings and specifications is being returned to the applicant. If the applicant does not return the corrected drawings and specifications within 6 months, the application will be void.  
If, after that time, the applicant desires to re-submit a new application, a new fee along with new checking documents will be required.

**STATE CHECK SET**  
RETURN TO STRUCTURAL SAFETY SECTION  
OFFICE OF THE STATE ARCHITECT

FILE No. **5-16** APR. No. **5202**

STRUCT. SAFETY CHECK \_\_\_\_\_ CHECK  
FIRE SAFETY CHECK \_\_\_\_\_ CHECK

**STRUCTURAL FIRE MARSHAL**

**APPROVED SHEET \***

**LEONARD J. SCHROEDER ARCHITECT A.I.A.**  
221 South Main Street, Suite A  
Bakersfield, California  
(805) 832-0734  
93509

**ARCHITECT A.I.A.**

**MODULE CLASSROOM ADDITION FOR:**  
CASA LOMA, VOORHIES & PIONEER SCHOOLS  
BAKERSFIELD CITY SCHOOL DISTRICT

**PLOT PLANS**

**JOB DATE 5-4-83**  
DRN D.WILLIS  
REV.

**SHEET**  
A-1  
OF 2 SHEETS