

PLUMBING PLOT PLAN

1/40

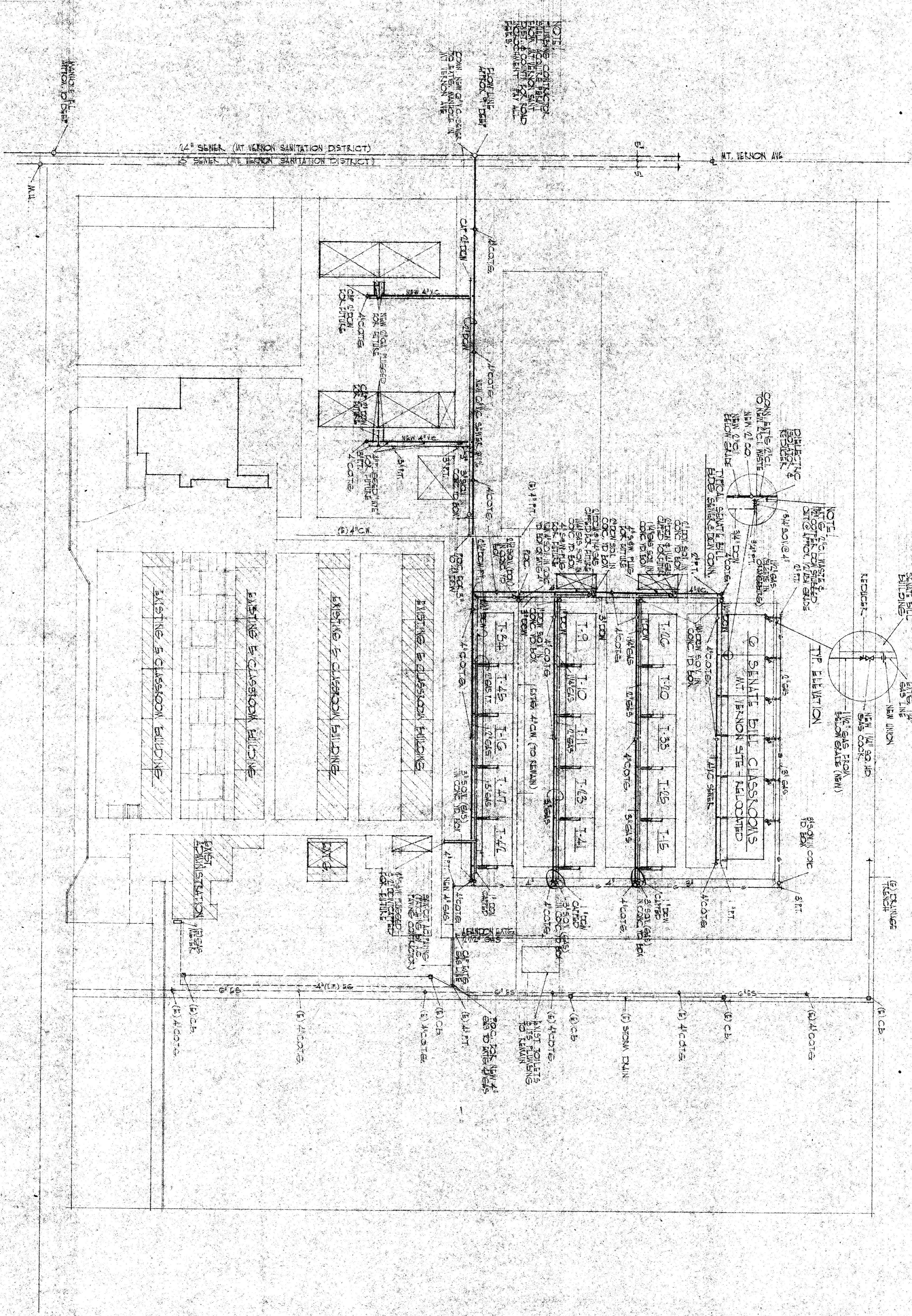

PLUMBING PLOT PLAN

MT. VERNON SCHOOL REHABILITATION  
 MT. VERNON & POTOMAC AVENUES  
 BAKERSFIELD CITY SCHOOL DISTRICT  
 BAKERSFIELD CALIFORNIA

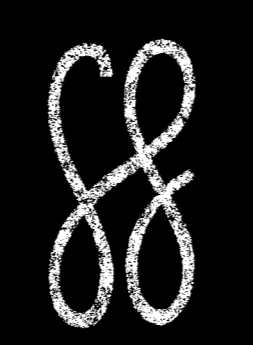

**FRAPWELL AND GHEZZI**  
**ARCHITECTS A.I.A.**

P. O. BOX 2022 PHONE 324-3441  
 1717 - 28th STREET BAKERSFIELD, CALIF. 93303

DRAWN  
 B.N. McILCOCK

DATE

CHECK AND VERIFY ALL DIMENSIONS AND CONDITIONS AT THE JOB SITE BEFORE PROCEEDING WITH THE WORK. REPORT ANY DISCREPANCIES TO THE ARCHITECT

APPROVED BY  
 BOARD OF EDUCATION  
 BAKERSFIELD CITY SCHOOL DISTRICT

DATE JUN 30 1993

E. H. WILKERSON - Mechanical Engr. and ASSOCIATES  
 12 Monterey St. 327-2544  
 Bakersfield, California 93305

*E.H. Wilkerson* ME 3927

JOB NO.

OF 1 SHEETS

SHEET 1