

SITE LEGEND

	PROPOSED RELOCATABLE BUILDING		AC PAVING, SEE CIVIL DWS'S
	NO WORK SCHEDULE FOR THIS BUILDING		(E) AC OVERLAY, SEE CIVIL DWS'S
	CHAIN-LINK FENCE		SIGNAGE, SEE DTL.
	(E) CHAIN-LINK FENCE		(E) SANDBOX

MARK	DATE	REVISIONS

CHECK AND VERIFY ALL DIMENSIONS BEFORE PROCEEDING WITH THE WORK. REPORT DISCREPANCIES TO THE ARCHITECT. ALL CONSTRUCTION SHALL CONFORM TO THE C.B.C.

SITE IMPROVEMENTS FOR 1-24'x40' MODULAR CLASSROOM AT:
HORACE MANN ELEMENTARY SCHOOL
 2710 NILES STREET, BAKERSFIELD, CA, 93306
 FOR BAKERSFIELD CITY SCHOOL DISTRICT
 BAKERSFIELD, KERN COUNTY, CALIFORNIA, 93305

IDENTIFICATION STAMP
 DIV. OF THE STATE ARCHITECT
 OFFICE OF REGULATION SERVICES
 APR 03 - 119 917
 FILE 15-6
 DATE APR 8 2019
 PTN : 63321-332

ARCHITECT

 1601 NEW STINE ROAD, SUITE 280
 BAKERSFIELD, CA 93309
 PH: (661) 397-4377
 FAX: (661) 397-4378
 WWW.SCARCHITECT.COM

STEPHEN J. CORBIN, NCA(ARB), AIA, LEED - AP BD+C

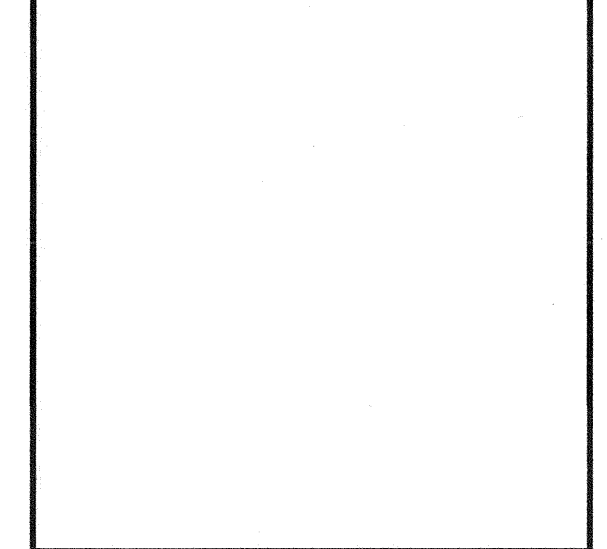

'B'-PARTIAL SITE

JOB NO. 1266
 DRAWN: SMV
 CHECKED: SJC
 DATE: 11/19/18

1.1
 2 OF 3 SHEETS

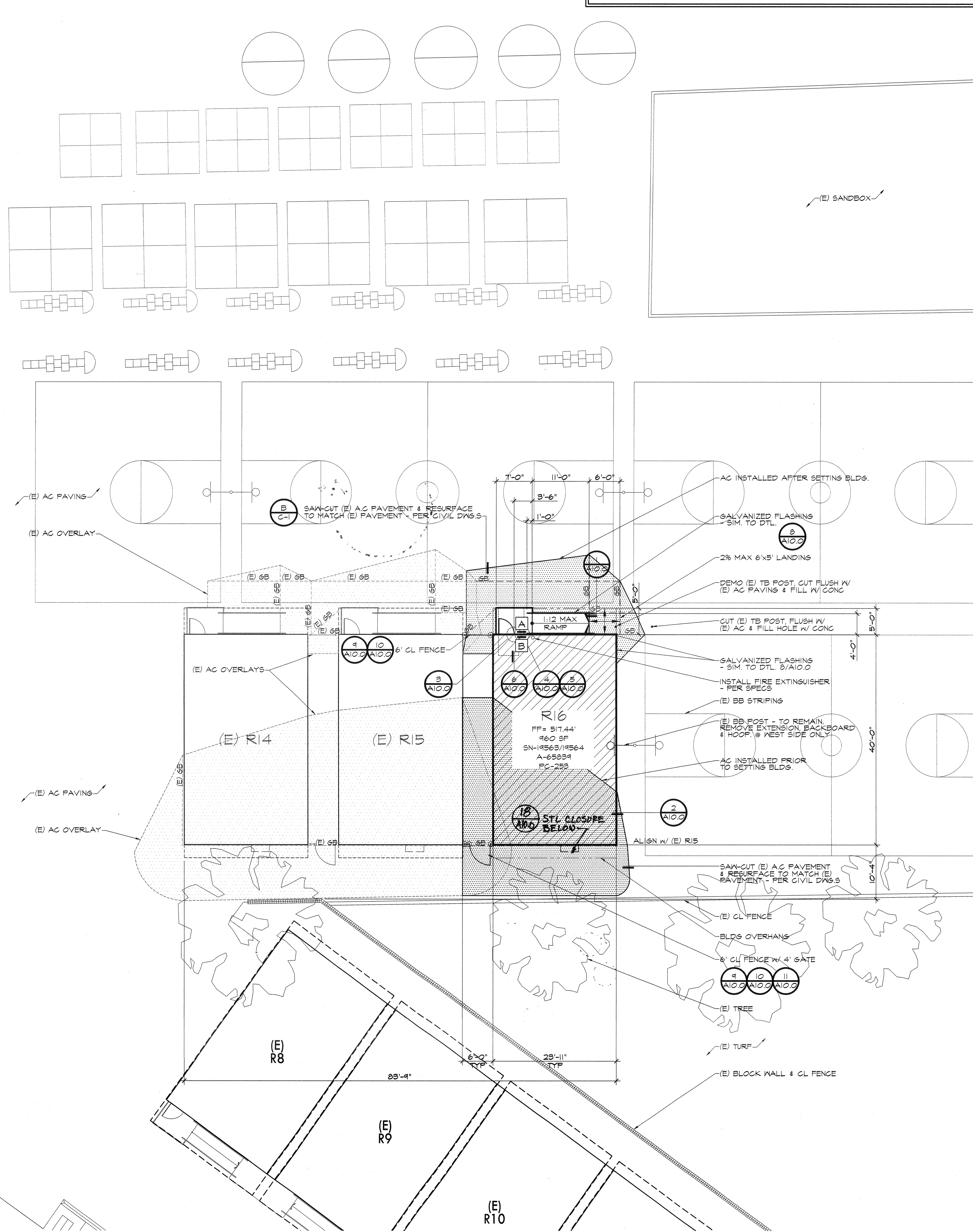

B PARTIAL SITE PLAN

SCALE: 1" = 10'-0"

X:\2018\1266\1266.dwg (11/19/18) 11:10:00 AM