

MARK	DATE	REVISIONS
△		
△		
△		

CHECK AND VERIFY ALL DIMENSIONS BEFORE PROCEEDING WITH THE WORK. REPORT DISCREPANCIES TO THE ARCHITECT. ALL CONSTRUCTION SHALL CONFORM TO THE C.B.C.

HORACE MANN ELEMENTARY SCHOOL
SITE IMPROVEMENTS FOR (4) MODULAR CLASSROOMS
 2710 NILES STREET
 FOR
 BAKERSFIELD SCHOOL DISTRICT
 BAKERSFIELD, KERN COUNTY, CALIFORNIA

IDENTIFICATION STAMP
 DIV. OF THE STATE ARCHITECT
 OFFICE OF REGULATION SERVICES
 Appl. 03-116978
 FILE 15-6
 DATE MAY 8 2018
 PTN : 63321-206

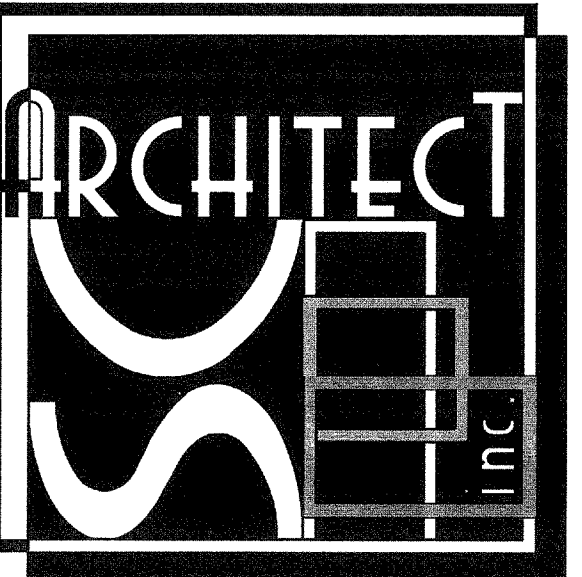

1601 NEW STINE ROAD, SUITE 280
 BAKERSFIELD, CA 93309
 PH: (661) 397-4377
 FAX: (661) 397-4378
 WWW.SCARCHITECT.COM

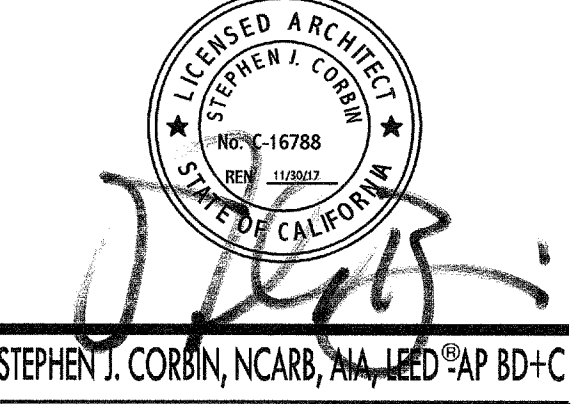

Rose Sing and Associates, Inc.
 Electrical Consultants
 131 S. Dunworth - (559)733-2671
 Visalia, California 93292-6705

SITE ELECTRICAL PLAN - OVERALL

JOB NO.
 1218
 DRAWN:
 CS
 CHECKED:
 DS
 DATE:
 04-26-16

2.1
 OF SHEETS

- NOTES (THIS SHEET ONLY):**
- BORE UNDER OR SAWCUT AND PATCH EXISTING PAVED AREA AS REQUIRED TO UNDERGROUND CONDUITS AS SHOWN.
 - FEEDER PER ONE LINE DIAGRAM #E4.1.
 - NEW PULL BOXES PER DETAIL #E5.1. TYPICAL, U.O.N.
 - ACCESS AS REQUIRED TO CONNECT NEW FEEDER CONDUCTORS AND NEW CIRCUIT BREAKER AS REQUIRED.
 - PROVIDE A NEW 36" SQ x 12" D, NEMA 3R SCREEN COVER ENCLOSURE HIGH UP ON EXTERIOR WALL ABOVE HEIGHT OF INTERIOR OF BUILDING ACCESSIBLE ATTIC SPACE. SEE DETAIL #E5.1.
 - PROVIDE THREE 1 1/2" STUBS INTO ACCESSIBLE ATTIC SPACE FOR OWNER'S USE.
 - RUN ONE 2" C FROM M.D.F. UP WALL INTO ACCESSIBLE ATTIC SPACE THEN CONCEALED IN ACCESSIBLE ATTIC SPACE TO EXTERIOR WALL. THEN PENETRATE THROUGH EXTERIOR WALL INTO BACK OF NEW PULL ENCLOSURE AT KEYNOTE #5.
 - THREE 1 1/2" AND ONE 1 1/4" - ONE "SFA" CABLE AND TWO "FS" CABLES.
 - 1 1/4" - ONE "SFA" CABLE AND TWO "FS" CABLES. ONE SPARE 1" C.
 - EXISTING FEEDER TO REMAIN. SEE KEYNOTES #16 AND #17.
 - TO REMAIN IN USE. PROVIDE NEW CIRCUIT BREAKER. PER ONE LINE DIAGRAM #E4.1.
 - TO REMAIN IN USE. NO WORK REQUIRED.
 - ACCESS AS REQUIRED TO DO NEW WORK AS NOTED.
 - TO REMAIN IN USE. RECONNECT TO NEW "F.A.C.P." PER FIRE ALARM RISER DIAGRAM #E3.2.
 - PER FIRE ALARM SYSTEM EQUIPMENT SPECIFICATIONS ON SHEET #E3.1.
 - EXISTING 4" C. PULL OUT EXISTING FEEDER CONDUCTORS FROM MAIN SWITCHBOARD BACK TO EXISTING PULL BOX #2 AND COIL UP THERE FOR RECONNECTION. PULL IN NEW FEEDER CONDUCTORS PER ONE LINE DIAGRAM #E4.1.
 - PROVIDE W.P. SPLICE KITS (AS REQUIRED) TO SPLICE NEW FEEDER CONDUCTORS (COMING FROM MAIN SWITCHBOARD) TO EXISTING CONDUCTORS THAT SUPPLY EXISTING PANEL "D".

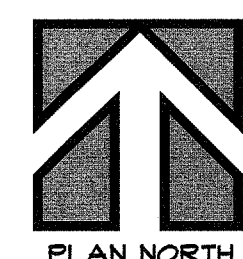
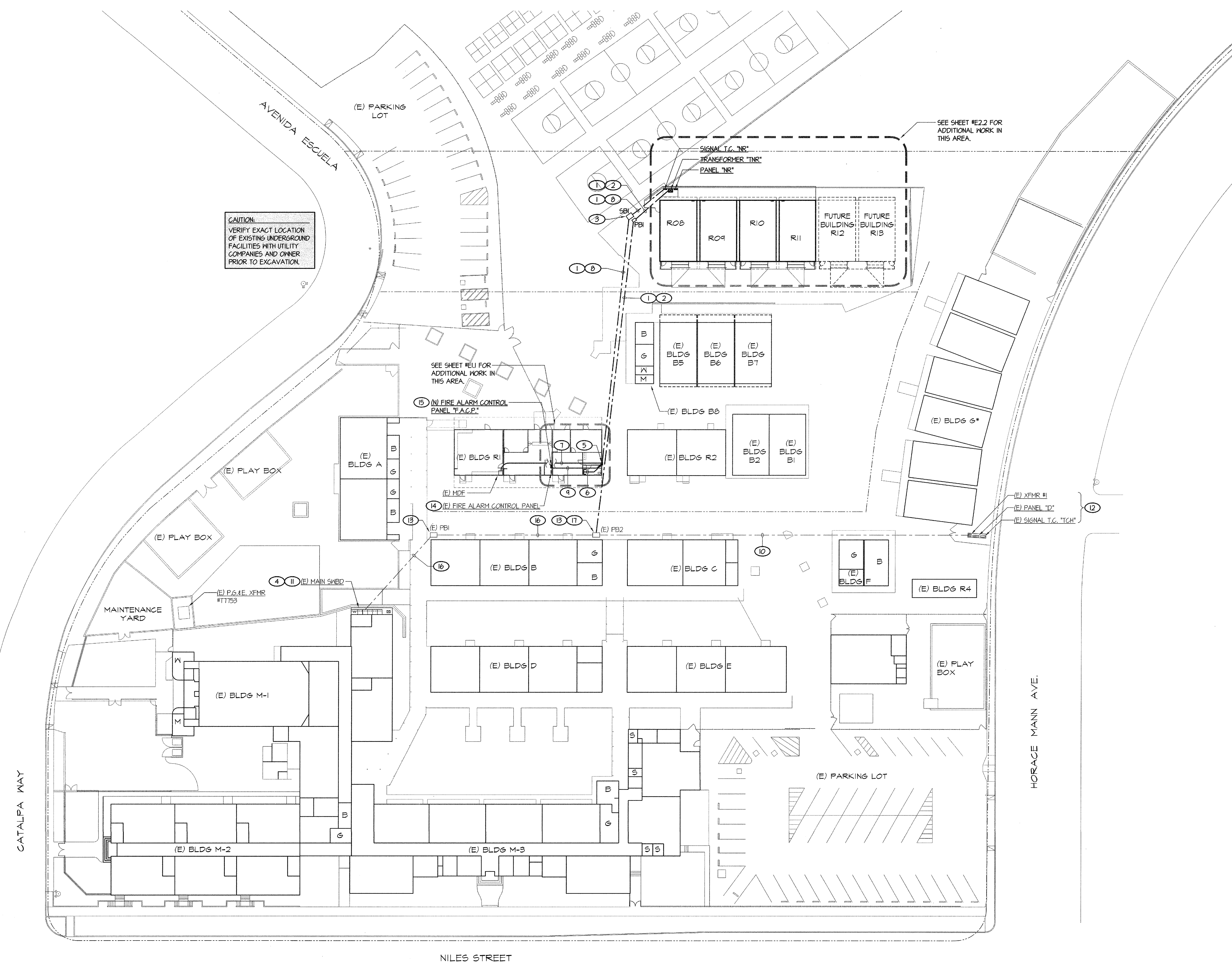

(E) SITE ELECTRICAL PLAN - OVERALL

SCALE: 1" = 30'-0"

COMPLETE AUTOMATIC FIRE ALARM SYSTEM PLAN SUBMITTAL

THE FIRE ALARM SYSTEM SHOWN ON THESE PLANS HAS BEEN SUBMITTED AND APPROVED BY THE DIVISION OF THE STATE ARCHITECT. ANY SUBSTITUTION OF THE FIRE ALARM SYSTEM SHALL BE RESUBMITTED TO THE ARCHITECT FOR REVIEW AND APPROVAL. THE CONTRACTOR SHALL PAY ANY ADDITIONAL FEES THAT ARE INCURRED DUE TO THIS SUBSTITUTION.

THE FIRE ALARM SYSTEM SHALL BE A TOTAL (COMPLETE) AUTOMATIC HEAT AND SMOKE DETECTION SYSTEM PER C.F.C. SECTION 901.2.3.6, AND SHALL COVER EVERY ROOM AND/OR AREA. UPON THE ACTIVATION OF ANY INITIATION DEVICE THE FIRE ALARM SYSTEM SHALL ALERT ALL OCCUPANTS AND TRANSMIT THE ALARM, SUPERVISORY, AND TROUBLE SIGNALS TO AN APPROVED SUPERVISING STATION (C.F.C. SECTION 901.2.3.5).

Z:\working\luba\USA\CD\0303\BPFIELD\Bakersfield City Schools\Horace Mann\EA1.dwg DATE: 03/24/16 DATE PLOTTED: 04/25/16 BY: Casey Job # 15095-JJ