

- NOTES (THIS SHEET ONLY):
- TO REMAIN IN USE. NO WORK REQUIRED.
  - ACCESS AS REQUIRED TO DO NEW WORK AS NOTED PER PLANS.
  - PER FIRE ALARM SYSTEM EQUIPMENT SPECIFICATIONS ON SHEET #E31.
  - PROVIDE PROGRAMMING AS REQUIRED FOR THE NEW DEVICES AT THE NEW RELOCATABLE BUILDINGS.

MARK	DATE	REVISIONS
△		
△		
△		

CHECK AND VERIFY ALL DIMENSIONS BEFORE PROCEEDING WITH THE WORK. REPORT DISCREPANCIES TO THE ARCHITECT. ALL CONSTRUCTION SHALL CONFORM TO THE C.B.C.

SITE IMPROVEMENTS FOR (2) MODULAR CLASSROOMS AT:  
**HORACE MANN ELEMENTARY SCHOOL**  
 2770 NILES STREET, BAKERSFIELD, CA., 93306  
 FOR  
**BAKERSFIELD CITY SCHOOL DISTRICT**  
 BAKERSFIELD, KERN COUNTY, CALIFORNIA, 93305

IDENTIFICATION STAMP	
DIV. OF THE STATE ARCHITECT	
OFFICE OF REGULATION SERVICES	
APPL. 03-17315	
FILE 15-6	
AC	FLS SS
DATE JUL 27 2016	
PTN : 63321-223	



1601 NEW STINE ROAD, SUITE 280  
 BAKERSFIELD, CA 93309  
 PH: (661) 397-4377  
 FAX: (661) 397-4378  
 WWW.SCARCHITECT.COM



Rose Sing and Associates, Inc.  
 Electrical Consultants  
 131 S. Dunwoorth - (559)733-2671  
 Visalia, California 93292-6705

**SITE ELECTRICAL PLAN - OVERALL**

JOB NO.	1225
DRAWN:	TW
CHECKED:	DS
DATE:	05-25-16

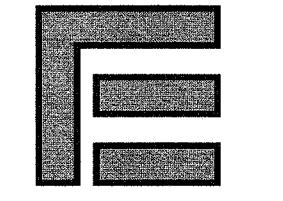

2.1  
 OF SHEETS

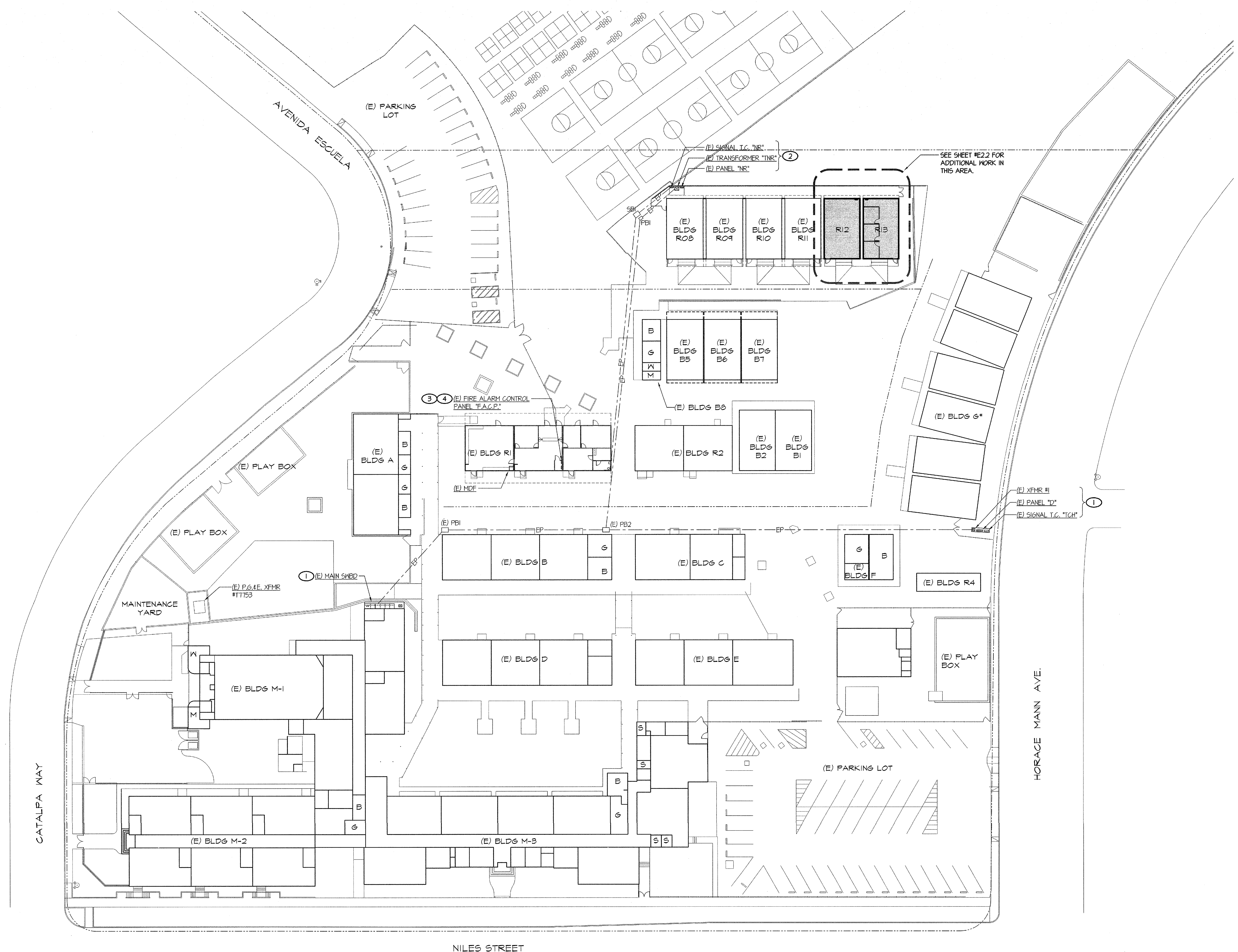

**E SITE ELECTRICAL PLAN - OVERALL**

SCALE: 1" = 30'-0"

**COMPLETE AUTOMATIC FIRE ALARM SYSTEM PLAN SUBMITTAL**

THE FIRE ALARM SYSTEM SHOWN ON THESE PLANS HAS BEEN SUBMITTED AND APPROVED BY THE DIVISION OF THE STATE ARCHITECT. ANY SUBSTITUTION OF THE FIRE ALARM SYSTEM SHALL BE RESUBMITTED TO THE ARCHITECT FOR REVIEW AND APPROVAL. THE CONTRACTOR SHALL PAY ANY ADDITIONAL FEES THAT ARE INCURRED DUE TO THIS SUBSTITUTION.

THE FIRE ALARM SYSTEM SHALL BE A TOTAL (COMPLETE) AUTOMATIC HEAT AND SMOKE DETECTION SYSTEM PER C.F.C. SECTION 901.2.3.6, AND SHALL COVER EVERY ROOM AND/OR AREA. UPON THE ACTIVATION OF ANY INITIATION DEVICE THE FIRE ALARM SYSTEM SHALL ALERT ALL OCCUPANTS AND TRANSMIT THE ALARM SUPERVISORY, AND TROUBLE SIGNALS TO AN APPROVED SUPERVISING STATION (C.F.C. SECTION 901.2.3.5).

P:\Drawing\Jobs\USA\SCHOOLS\BKFELD\Bakersfield City Schools\Horace Mann - Two Rectangles.dwg DATE: 05/25/16 DATE PLOTTED: 06/02/16 BY: Casey Job # 15-096101-JJ