

LIGHTING FLOOR PLAN

SCALE: 1/8"=1'-0"

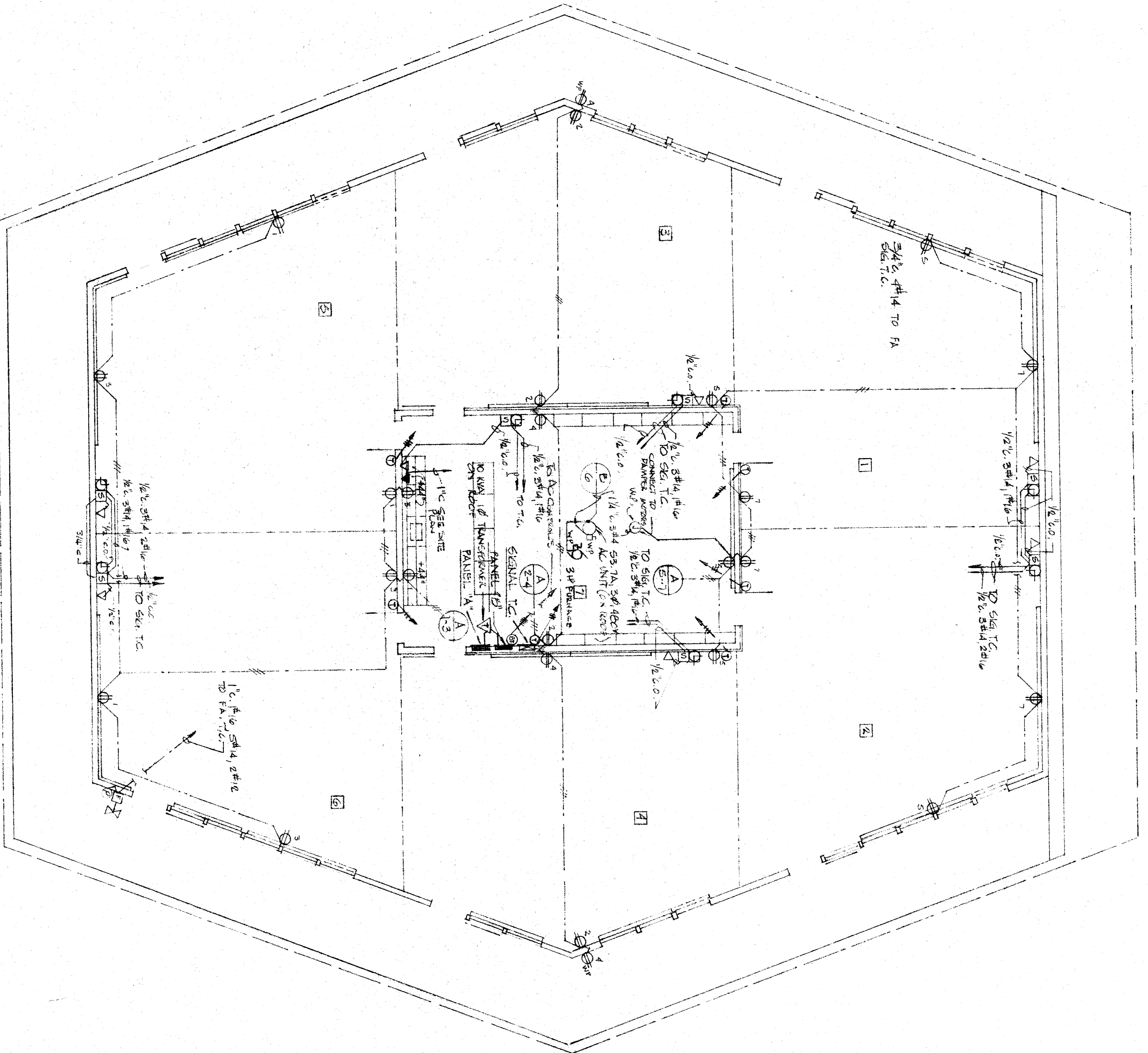

POWER and SIGNAL FLOOR PLAN

SCALE: 1/8"=1'-0"



<p>DATE: 11/11/83 30 0 637 4800000 11/11/83 11/11/83</p>	<p>CHICK AND VERRY ALL ENGINEERS BEFORE PROCEEDING WITH THE WORK. REPORT DISCREPANCIES TO THE ARCHITECT.</p>	<p>BAKERSFIELD CITY SCHOOL DISTRICT Approved APR 8 1983</p>	<p>ROBERT F. STUHR ARCHITECT</p>	<p>ELECTRICAL, LIGHTING, POWER and SIGNAL FLOOR PLAN</p>
<p>3111 CALIFORNIA AVE. BAKERSFIELD CALIFORNIA 93311</p>	<p>FRANCIS E. FISHER & ASSOCIATES CONSULTING ELECTRICAL ENGINEERS 2000 W. 1ST ST. BAKERSFIELD, CALIF. 93311</p>	<p>JOB NO. 67652 DRAWN: DZL, JES CHECKED: G.W. DATE: 11/11/83</p>	<p>6 CLASSROOM BLDG. ADDITION TO FREMONT SCHOOL BAKERSFIELD CITY SCHOOL DISTRICT BAKERSFIELD, KERN COUNTY CALIFORNIA</p>	<p>DETAIL NO. SEE SPEC SECT. II</p>