

PARTITION CONNECTION AT CONG FLOOR SCALE: 3/4\"/>

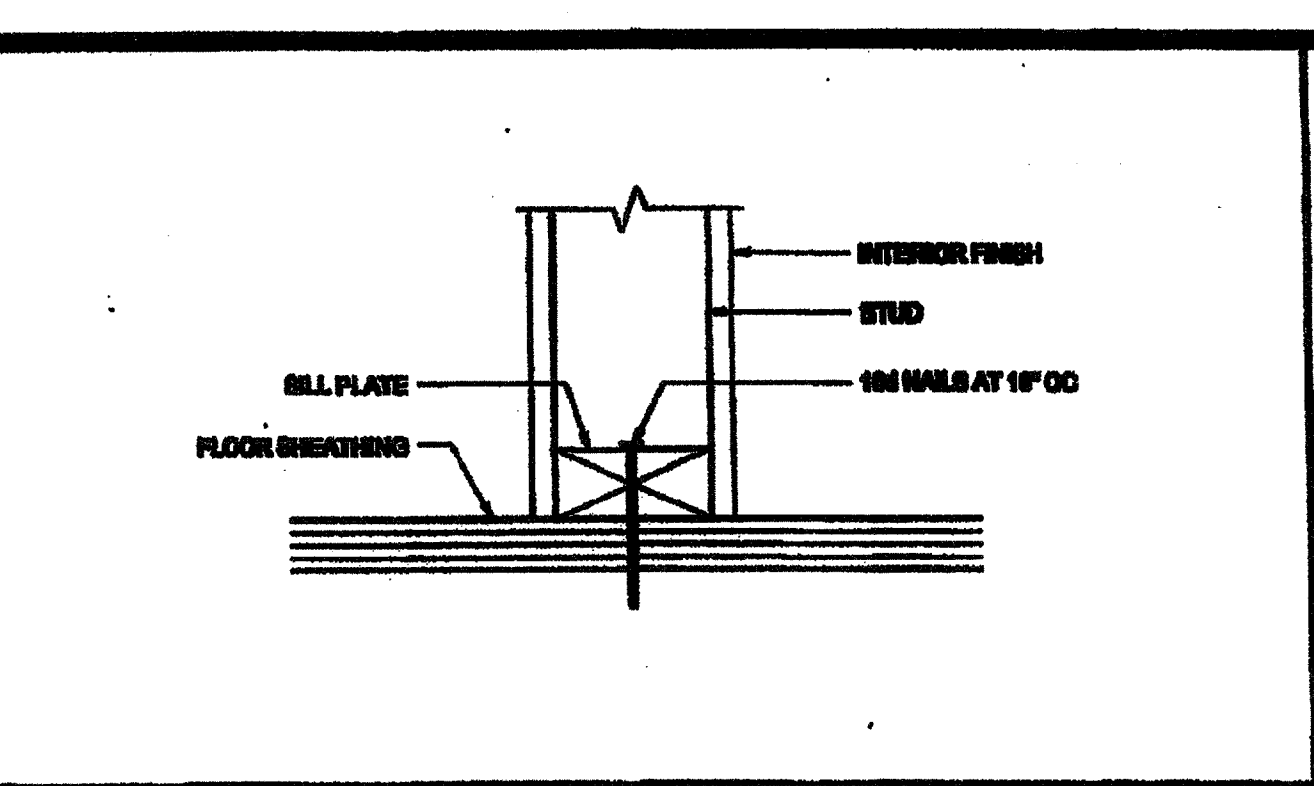

PARTITION CONNECTION AT WOOD FLOOR SCALE: 3/4\"/>

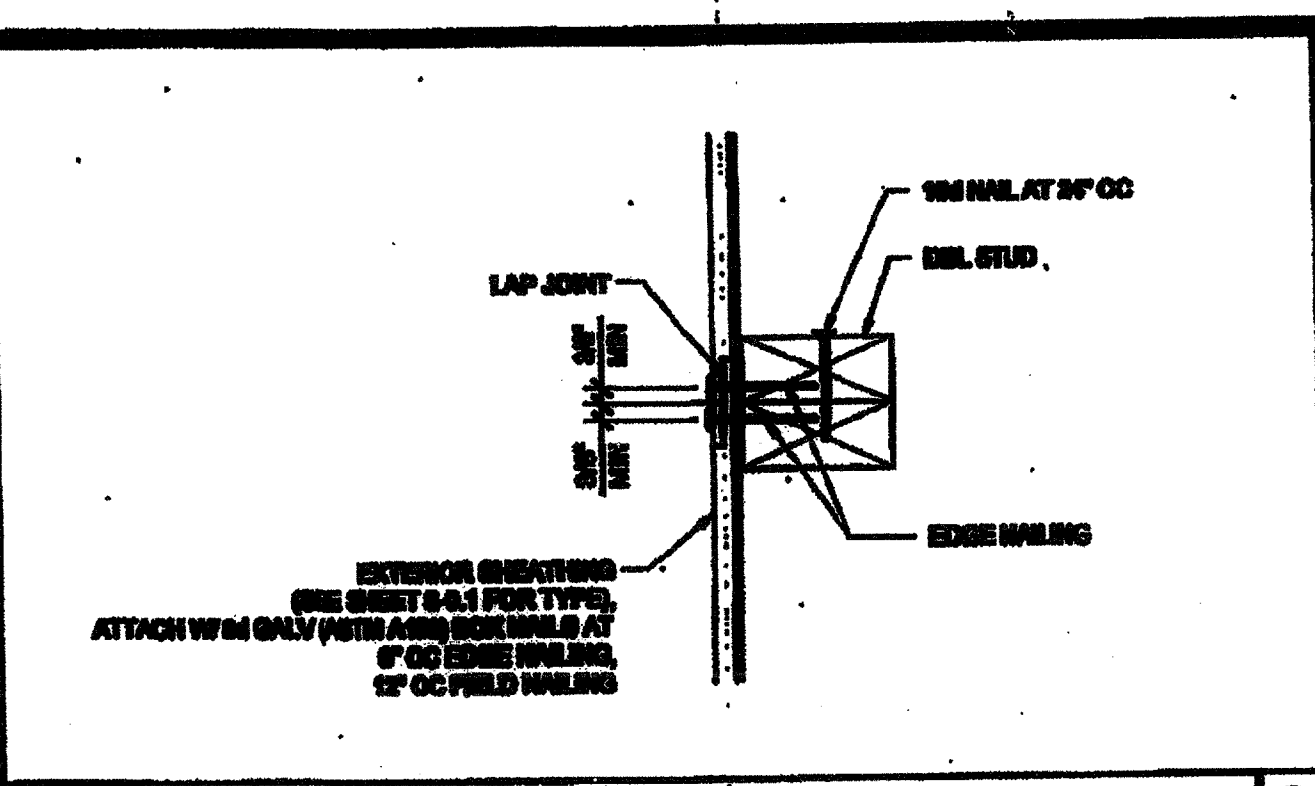

VERTICAL SHEATHING LAP JOINT SCALE: 3/4\"/>

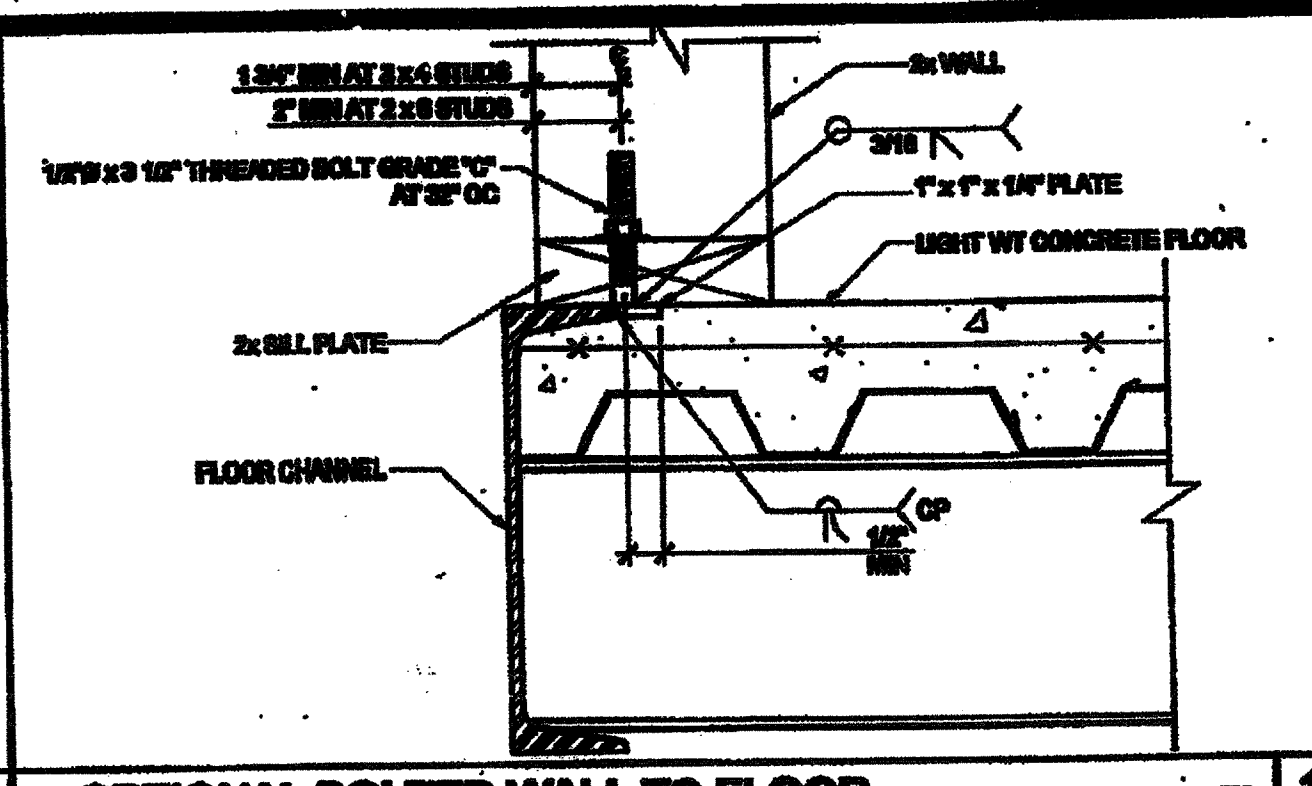

OPTIONAL BOLTED WALL TO FLOOR SCALE: INT 1

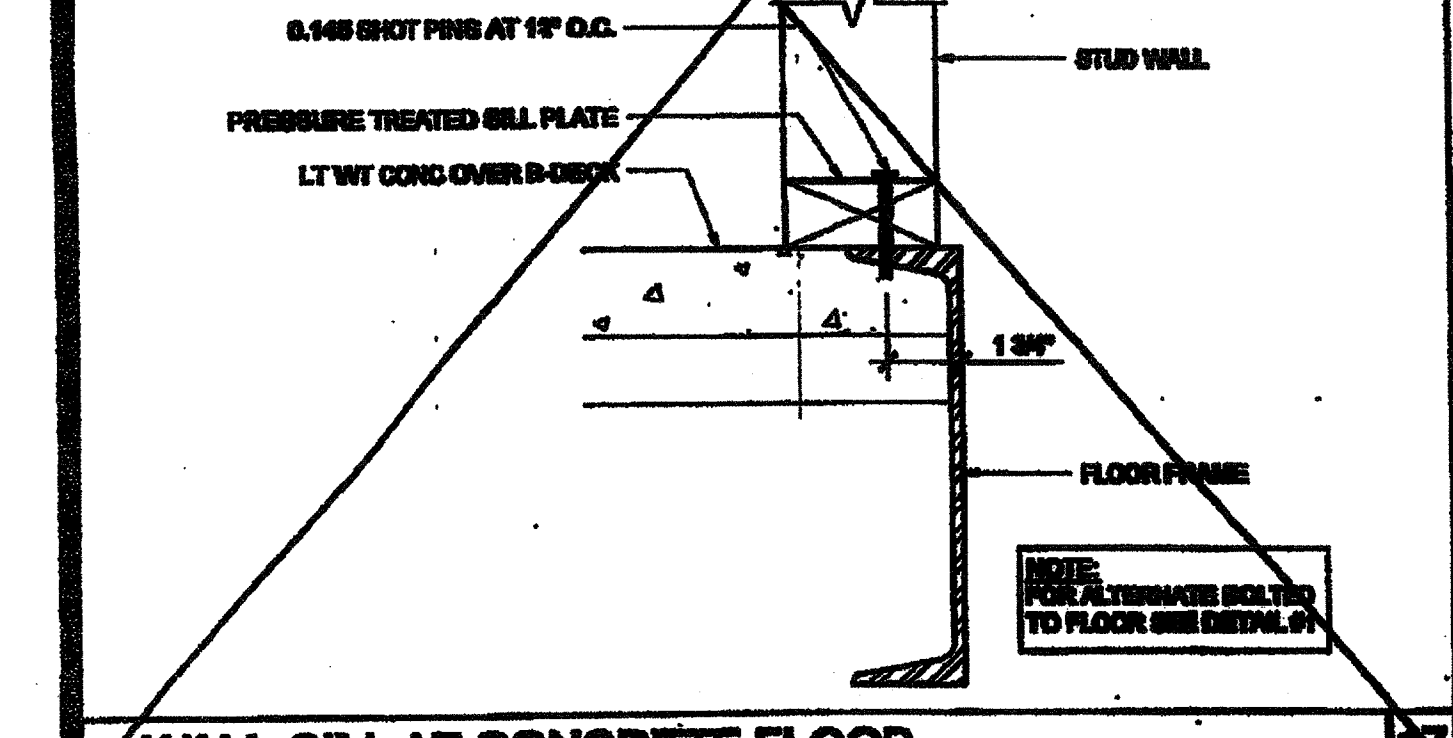

WALL SILL AT CONCRETE FLOOR SCALE: 3/4\"/>

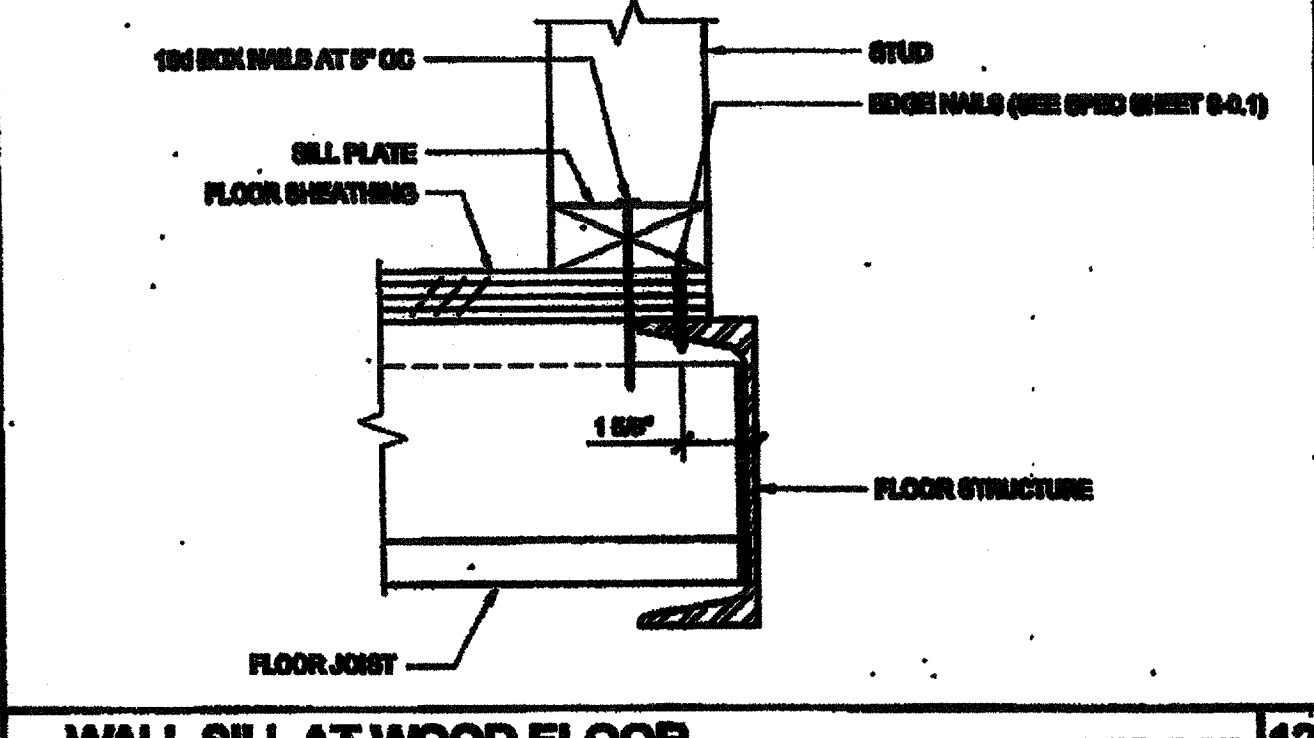

WALL SILL AT WOOD FLOOR SCALE: 3/4\"/>

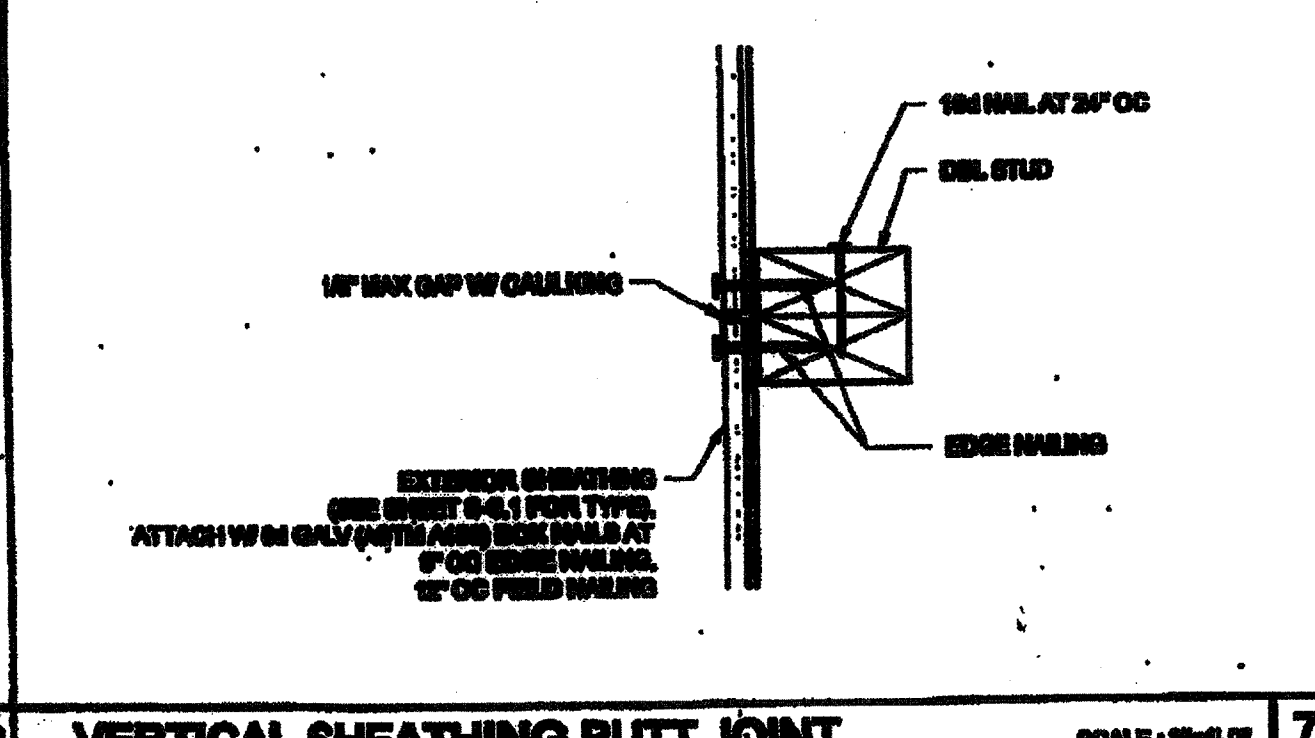

VERTICAL SHEATHING BUTT JOINT SCALE: 3/4\"/>

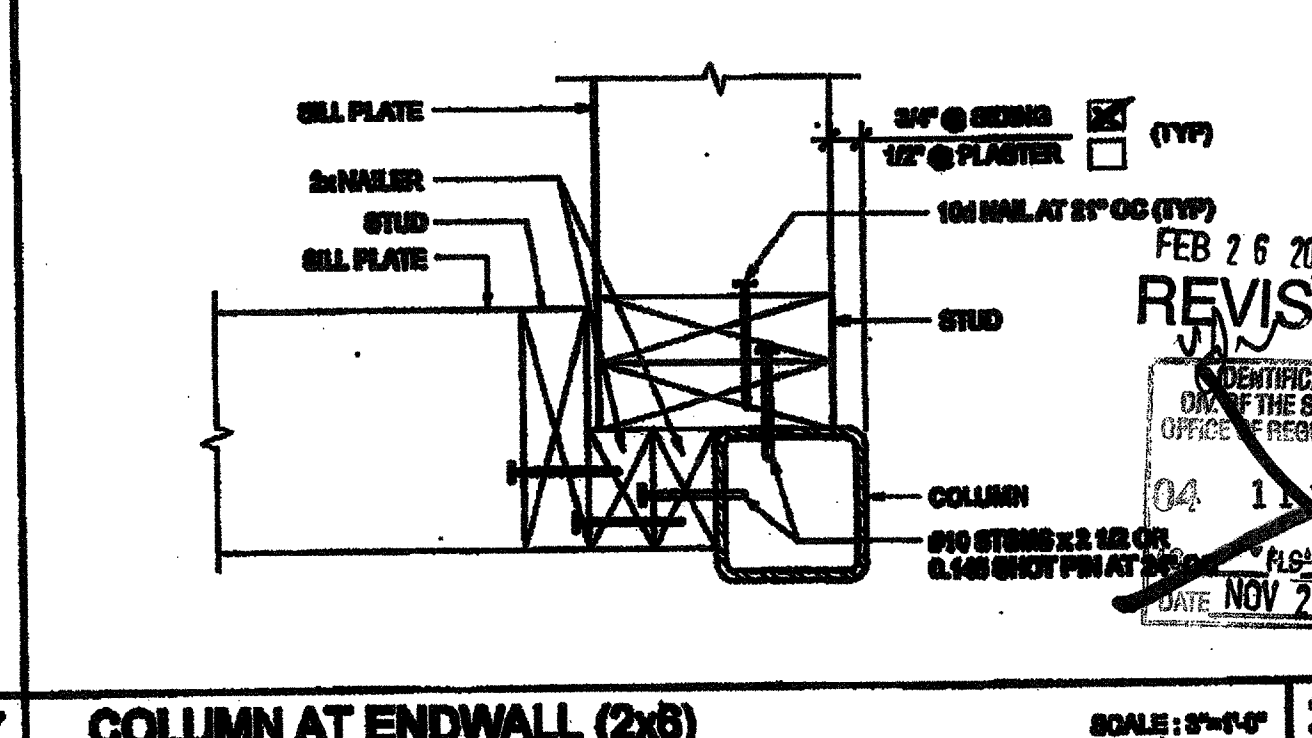

COLUMN AT ENDWALL (2x8) SCALE: 3/4\"/>

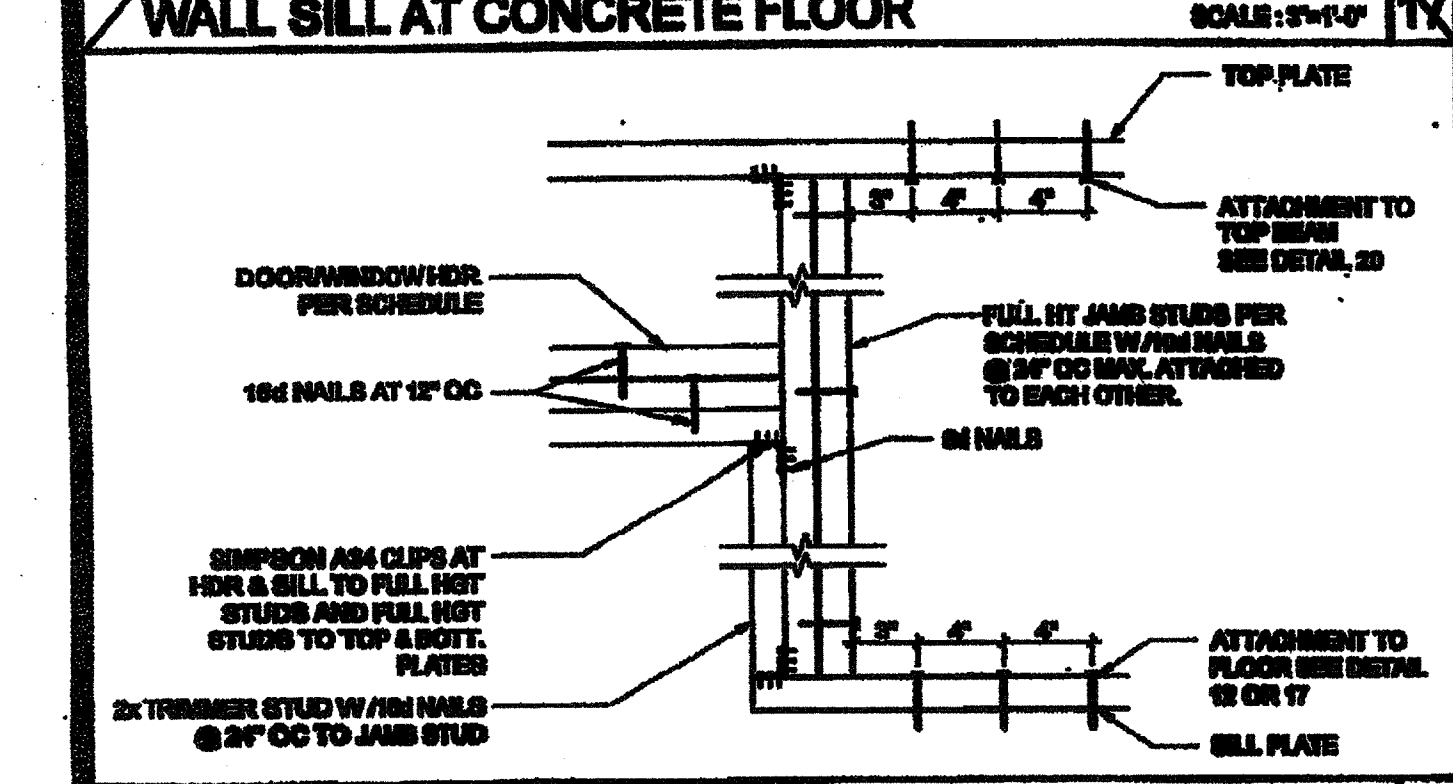

DOOR/WINDOW HEADER AND JAMB SCALE: 1 1/2\"/>

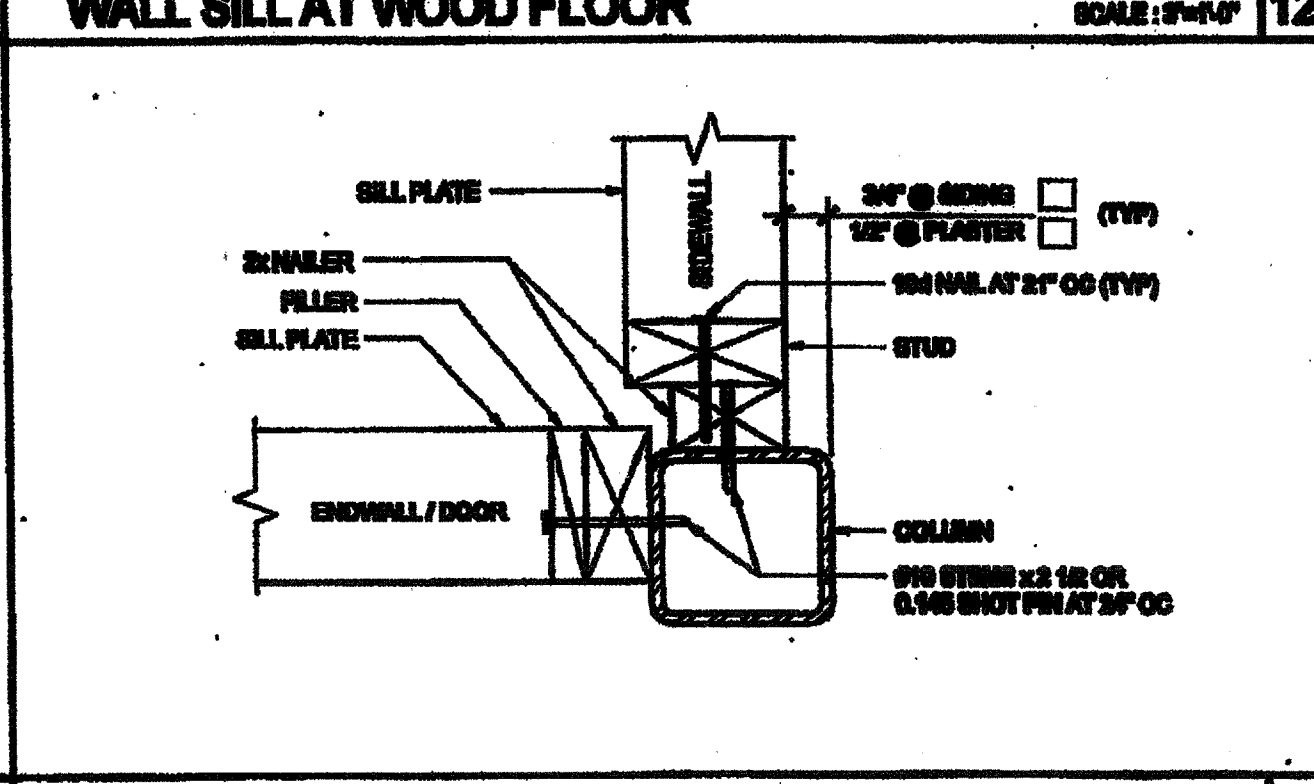

COLUMN AT ENDWALL SCALE: 3/4\"/>

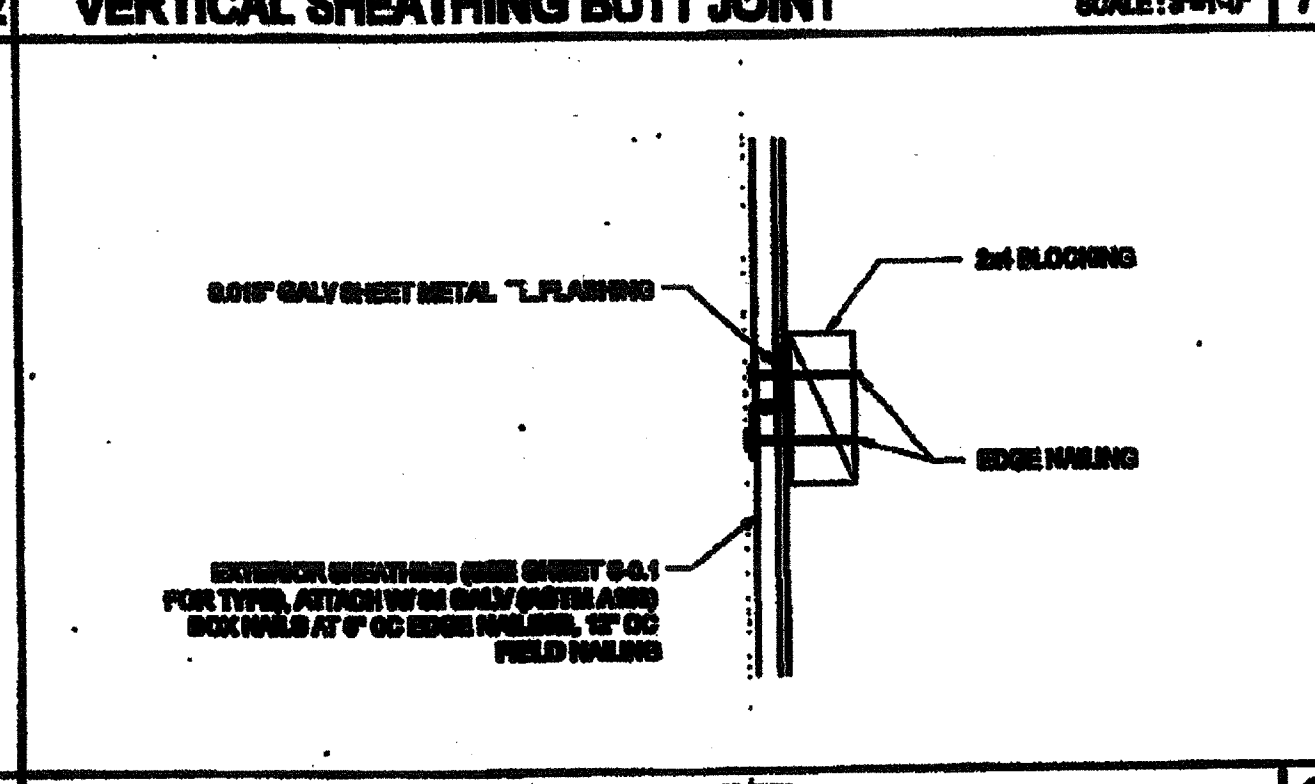

HORIZONTAL SHEATHING JOINT SCALE: 3/4\"/>

COLUMN HEIGHT	OPENING SIZE	LET FINISH	HINDER				GILL				FULL HEIGHT WOOD STUD			
			NUMBER	SIZE	TYPE	OC	NUMBER	SIZE	TYPE	OC	NUMBER	SIZE	TYPE	OC
LESS THAN 9'-0"	0-0	NO PLASTER	(1)	2x4	HF	24"	(1)	2x4	HF	24"	(3)	2x4	HF	24"
			WFLASER (1)	2x4	HF	24"	WFLASER (1)	2x4	HF	24"	WFLASER (1)	2x4	HF	24"
			WFLASER (1)	2x4	HF	24"	WFLASER (1)	2x4	HF	24"	WFLASER (1)	2x4	HF	24"
			WFLASER (1)	2x4	HF	24"	WFLASER (1)	2x4	HF	24"	WFLASER (1)	2x4	HF	24"
			WFLASER (1)	2x4	HF	24"	WFLASER (1)	2x4	HF	24"	WFLASER (1)	2x4	HF	24"
			WFLASER (1)	2x4	HF	24"	WFLASER (1)	2x4	HF	24"	WFLASER (1)	2x4	HF	24"
9'-0" TO 10'-0"	0-0	NO PLASTER	(1)	2x4	HF	24"	(1)	2x4	HF	24"	(3)	2x4	HF	24"
			WFLASER (1)	2x4	HF	24"	WFLASER (1)	2x4	HF	24"	WFLASER (1)	2x4	HF	24"
			WFLASER (1)	2x4	HF	24"	WFLASER (1)	2x4	HF	24"	WFLASER (1)	2x4	HF	24"
			WFLASER (1)	2x4	HF	24"	WFLASER (1)	2x4	HF	24"	WFLASER (1)	2x4	HF	24"
			WFLASER (1)	2x4	HF	24"	WFLASER (1)	2x4	HF	24"	WFLASER (1)	2x4	HF	24"
			WFLASER (1)	2x4	HF	24"	WFLASER (1)	2x4	HF	24"	WFLASER (1)	2x4	HF	24"

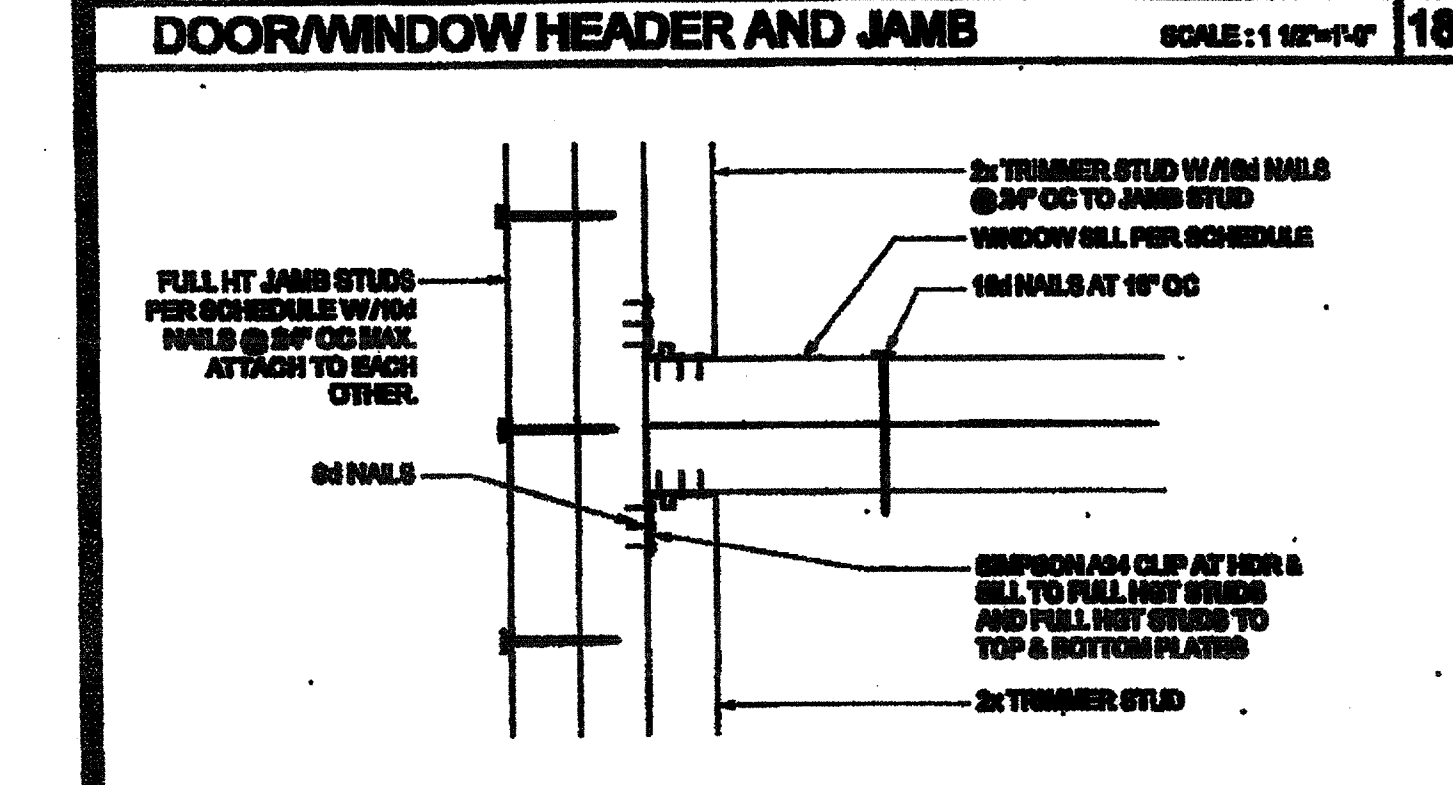

WINDOW SILL AND JAMB SCALE: 3/4\"/>

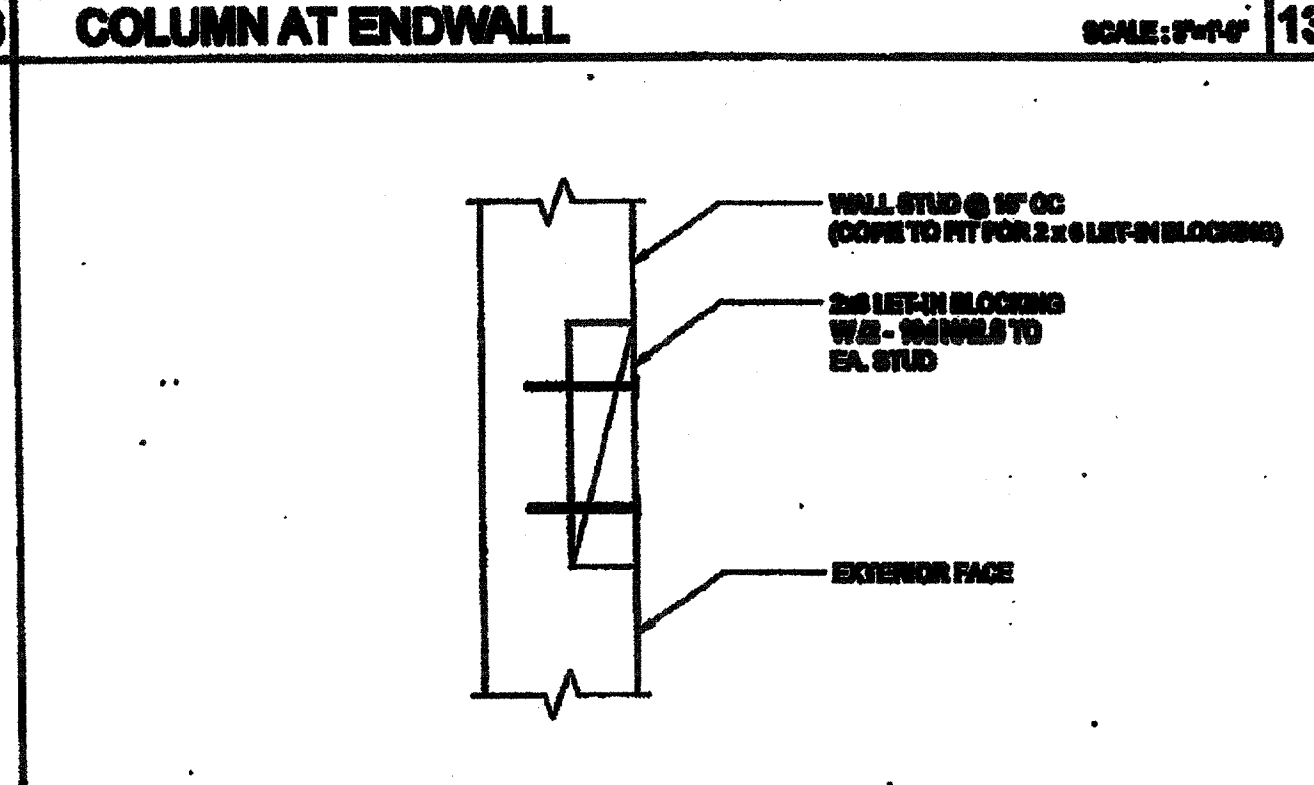

LET-IN BLOCK ATTACHMENT SCALE: 3/4\"/>

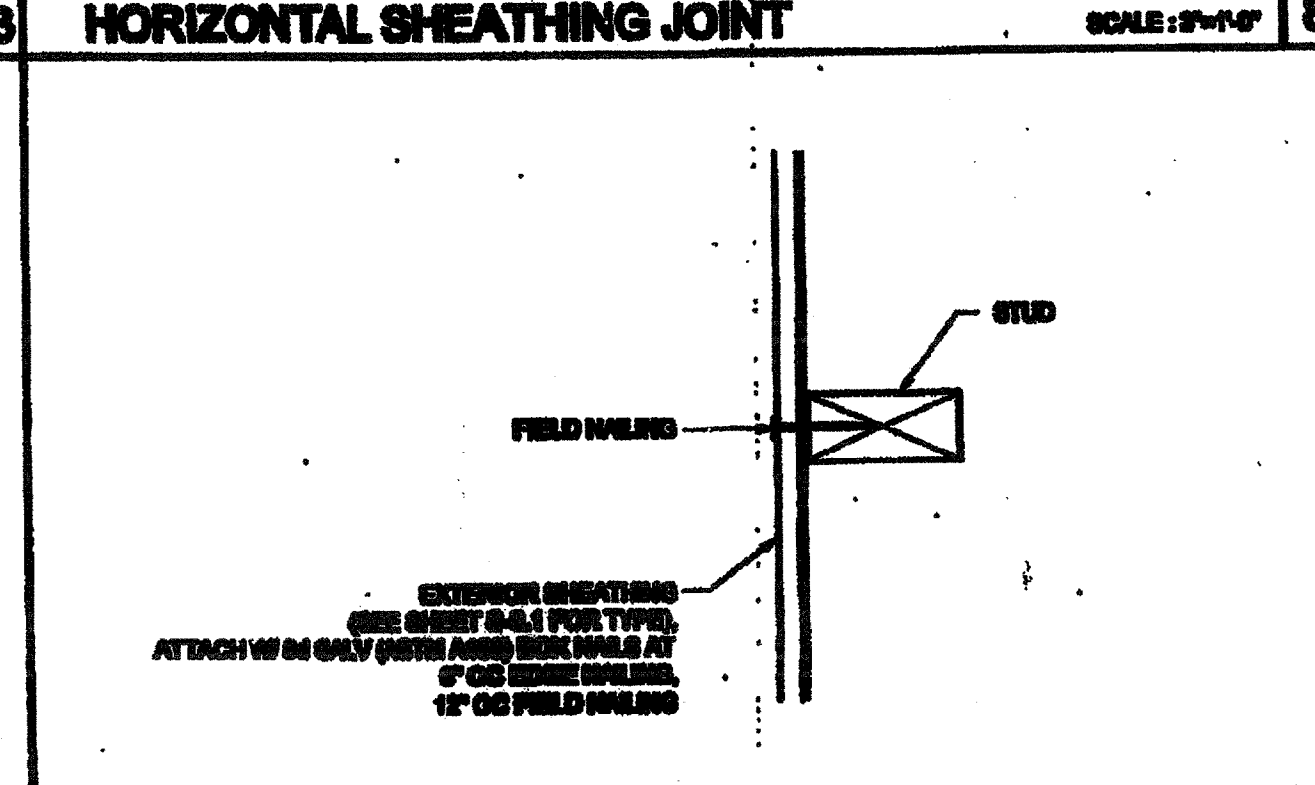

SECTION AT SHEATHING TO STUD ATTACHMENT SCALE: 1 1/2\"/>

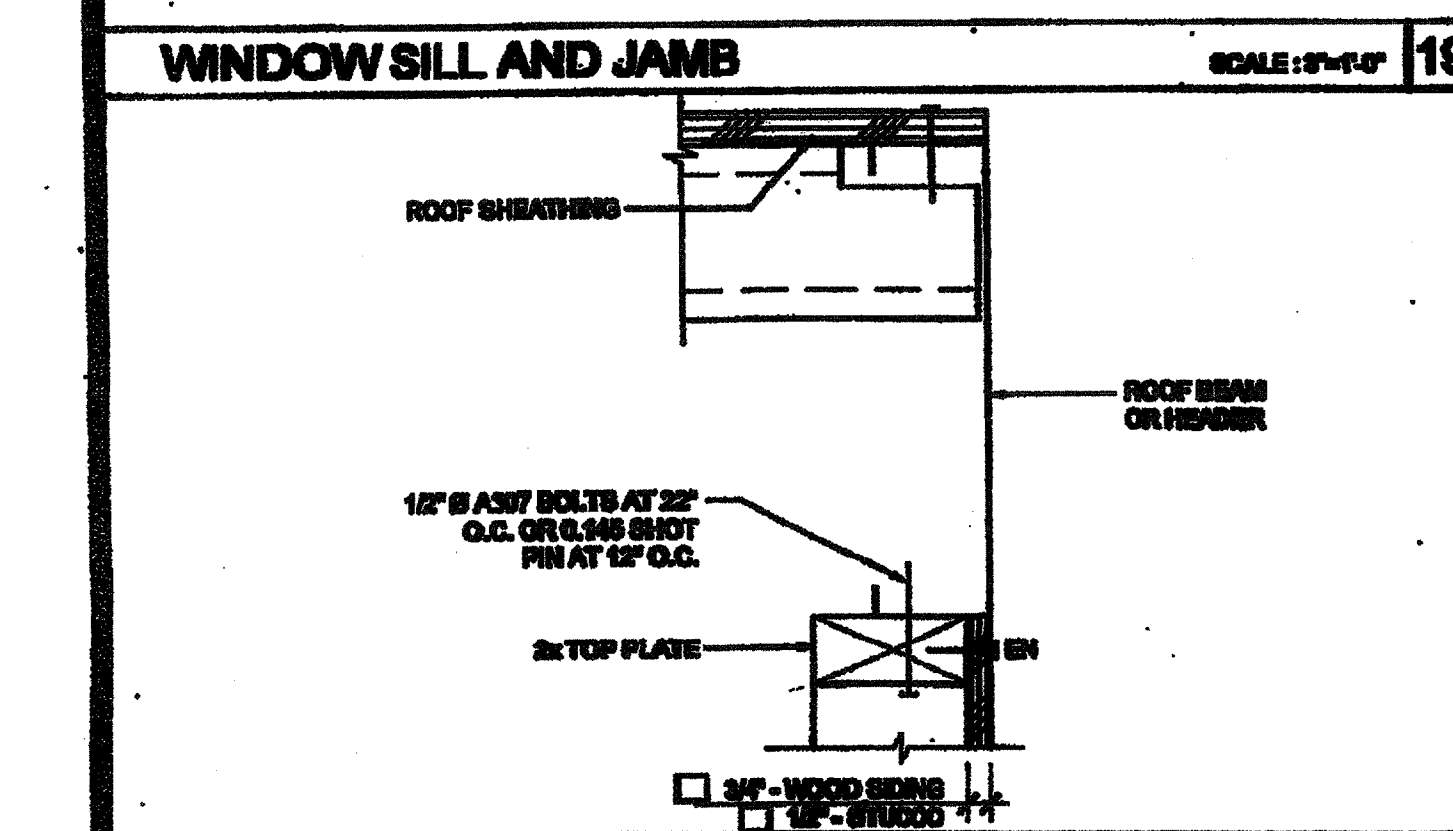

TOP PLATE AT ROOF BEAM SCALE: 3/4\"/>

DOOR	WINDOW	STANDARD	WELDED FRAME
200	24"	24"	24 1/4"
300	30"	30"	30 1/4"
400	36"	36"	36 1/4"
500	42"	42"	42 1/4"
600	48"	48"	48 1/4"
700	54"	54"	54 1/4"
800	60"	60"	60 1/4"
900	66"	66"	66 1/4"
1000	72"	72"	72 1/4"
1100	78"	78"	78 1/4"
1200	84"	84"	84 1/4"

ROUGH OPENING SCHEDULE

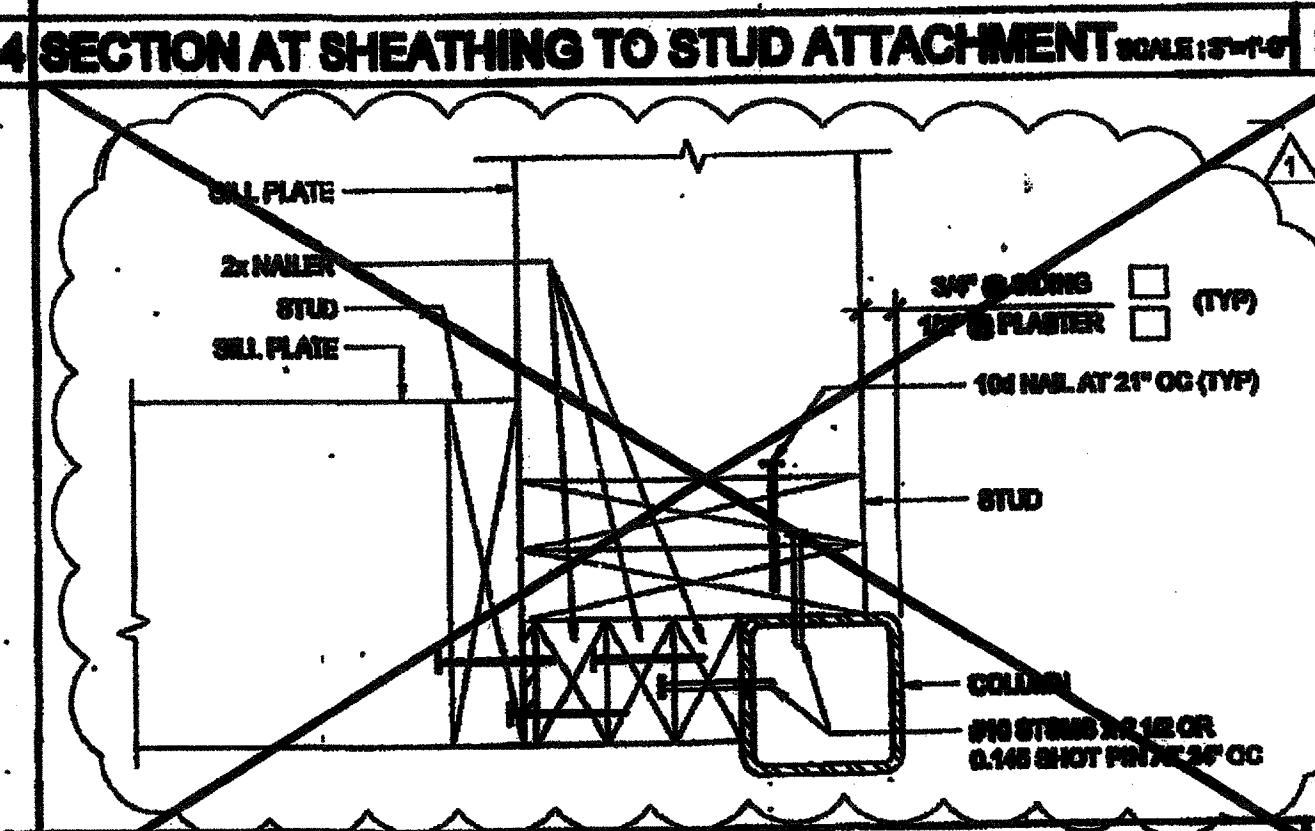

COLUMN AT ENDWALL (2x8) SCALE: 3/4\"/>

COLUMN HEIGHT	OPENING SIZE	LET FINISH	WOOD WALL FINISHING				CORNER OF WOOD WALL FINISHING (CORNER)			
			NUMBER	SIZE	TYPE	OC	NUMBER	SIZE	TYPE	OC
LESS THAN 9'-0"	0-0	NO PLASTER	(1)	2x4	HF	24"	(1)	2x4	HF	24"
			WFLASER (1)	2x4	HF	24"	WFLASER (1)	2x4	HF	24"
			WFLASER (1)	2x4	HF	24"	WFLASER (1)	2x4	HF	24"
			WFLASER (1)	2x4	HF	24"	WFLASER (1)	2x4	HF	24"
			WFLASER (1)	2x4	HF	24"	WFLASER (1)	2x4	HF	24"
			WFLASER (1)	2x4	HF	24"	WFLASER (1)	2x4	HF	24"
9'-0" TO 10'-0"	0-0	NO PLASTER	(1)	2x4	HF	24"	(1)	2x4	HF	24"
			WFLASER (1)	2x4	HF	24"	WFLASER (1)	2x4	HF	24"
			WFLASER (1)	2x4	HF	24"	WFLASER (1)	2x4	HF	24"
			WFLASER (1)	2x4	HF	24"	WFLASER (1)	2x4	HF	24"
			WFLASER (1)	2x4	HF	24"	WFLASER (1)	2x4	HF	24"
			WFLASER (1)	2x4	HF	24"	WFLASER (1)	2x4	HF	24"

OPENING STUDS SCHEDULE - 100 MPH

TOP PLATE AT ROOF BEAM SCALE: 3/4\"/>

ROUGH OPENING SCHEDULE

COLUMN AT ENDWALL (2x8) SCALE: 3/4\"/>

WALL FRAMING SCHEDULE - 100 MPH

THESE DRAWINGS AND ALL MATERIAL CONTAINED HEREIN ARE THE PROPERTY OF SILVER CREEK INDUSTRIES, INC. AND SHALL NOT BE REPRODUCED, COPIED OR OTHERWISE DISSEMINATED IN ANY MANNER WITHOUT THE WRITTEN CONSENT OF SILVER CREEK INDUSTRIES, INC. FOR THE PURPOSES OF PERFORMING ANY WORK UNDER THE TERMS OF ANY CONTRACT, PERMIT, APPROVAL OR OTHER DOCUMENT WITHOUT THE FULL, UNREVOKED AND WRITTEN CONSENT OF SILVER CREEK INDUSTRIES, INC. ALL PERMITTED MATERIAL CONTAINED HEREIN AND CONTAINED WITHIN OR ON IT SHALL BE THE PROPERTY OF SILVER CREEK INDUSTRIES, INC.

**SILVER CREEK INDUSTRIES, INC.**  
BUILDING FOR THE NEXT GENERATION  
**SILVER CREEK**  
190 BAY HARBOR FERRIS, CALIFORNIA 94711  
PHONE: 925-426-2200 FAX: 925-426-2211  
PROJECT NAME

**CLASS LEASING CLASSROOM BLDG'S**

FEB 26 2015  
**REVISED**  
IDENTIFICATION STAMP  
DIV. OF THE STATE ARCHITECT  
OFFICE OF REGULATION SERVICES  
04 11 92  
DATE NOV 27 2011

**STAVAREE**  
REGISTERED ARCHITECT  
NO. 5838  
EXPIRES 06/30/2014  
SEP 1 2012  
ARCHITECT OF RECORD  
DIV. OF THE STATE ARCHITECT  
OFFICE OF REGULATION SERVICES  
04 11 92  
DATE AUG 28 2010

PROJECT SPECIFIC STATE AGENCY APPROVAL  
IDENTIFICATION STAMP  
DIV. OF THE STATE ARCHITECT  
OFFICE OF REGULATION SERVICES  
04 11 92  
DATE APR 04 2014

ORIGINAL PC STATE AGENCY APPROVAL  
IDENTIFICATION STAMP  
DIV. OF THE STATE ARCHITECT  
OFFICE OF REGULATION SERVICES  
PC 07/2012  
DATE JAN 09 2013  
**REVISED**

REVISIONS  
PC REVISION 07/24/2012

SILVER CREEK INDUSTRIES, INC.  
37240 PC  
PROJECT NO:  
DRAWN BY:  
SCALE: AS NOTED  
DATE: 12-09-11  
P.C. SHEET NUMBER  
**S-5.10**  
STKP 126

SEE 20/S-5.11  
IDENTIFICATION STAMP  
DIV. OF THE STATE ARCHITECT  
AP03 11 97 8  
AC FLS SS  
DATE APR 1 8 2016