

**RESTROOM BUILDINGS  
 AND RELOCATABLE CLASSROOMS  
 FOR FREMONT AND MT. VERNON ELEMENTARY SCHOOLS**  
 BAKERSFIELD CITY SCHOOL DISTRICT  
 BAKERSFIELD, KERN COUNTY, CALIFORNIA

**TOPO SITE  
 PLANS**

CHECK AND VERIFY ALL DIMENSIONS  
 BEFORE PROCEEDING WITH THE  
 WORK. REPORT DISCREPANCIES  
 TO THE ARCHITECT. ALL  
 CONSTRUCTION SHALL CONFORM  
 TO THE C.S.C.C.

MARK	DATE	REVISIONS

**TP**  
 JOB NO. 475  
 DRAWN: [Signature]  
 CHECKED: [Signature]  
 DATE: 01/21/00  
**20**  
 OF SHEETS

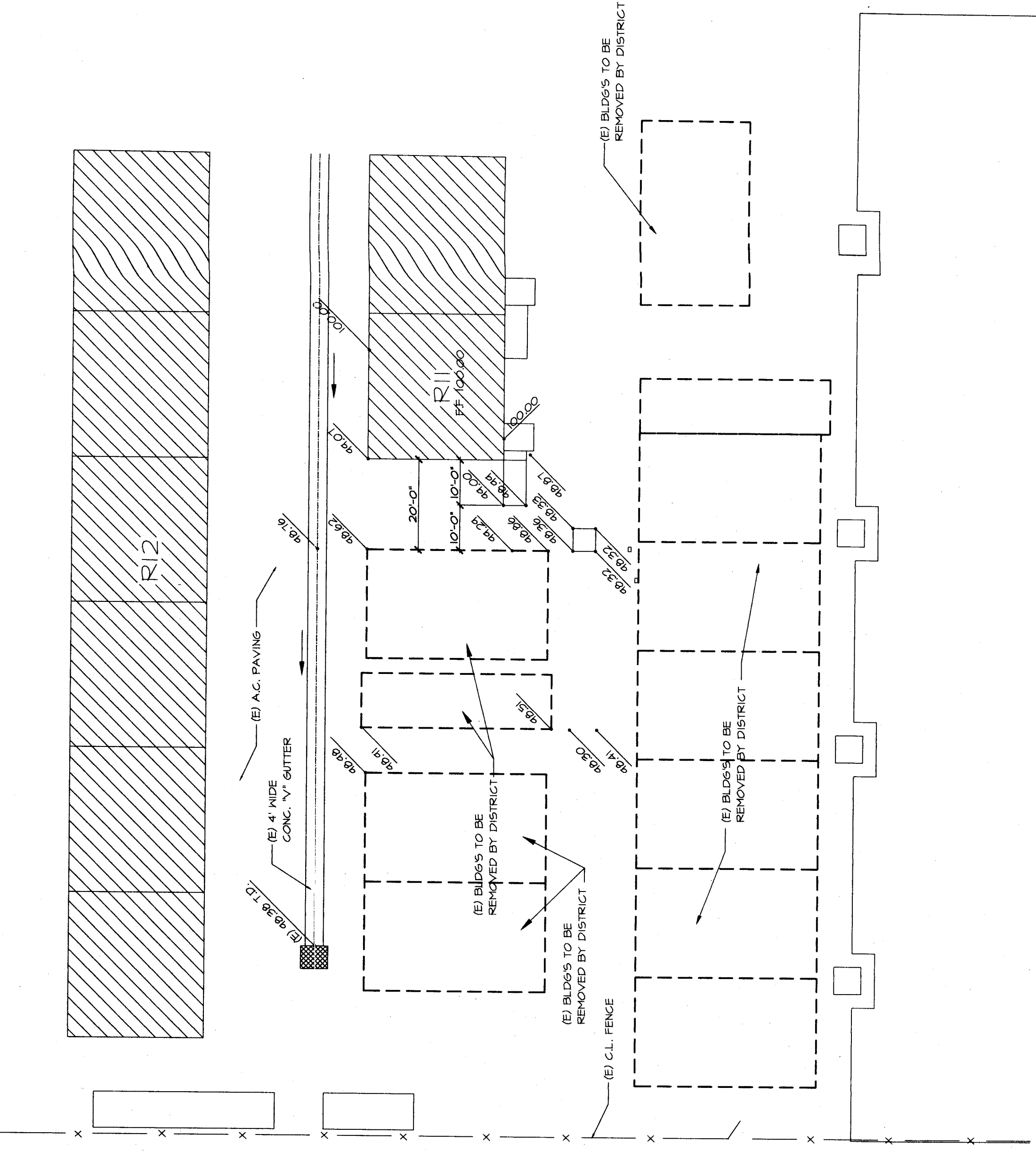

**EXISTING TOPO PLAN - MT. VERNON**  
 SCALE: 1" = 20'-0"  
 PLAN NORTH



**EXISTING TOPO PLAN - FREMONT**  
 SCALE: 1" = 20'-0"  
 PLAN NORTH

**LEGEND**  
 [Hatched Box] BLDGS NOT PART OF THIS CONTRACT  
 [Dashed Box] REJ BLDGS TO BE REMOVED BY DISTRICT  
 [Line with 'x'] REJ CHAIN LINK FENCE

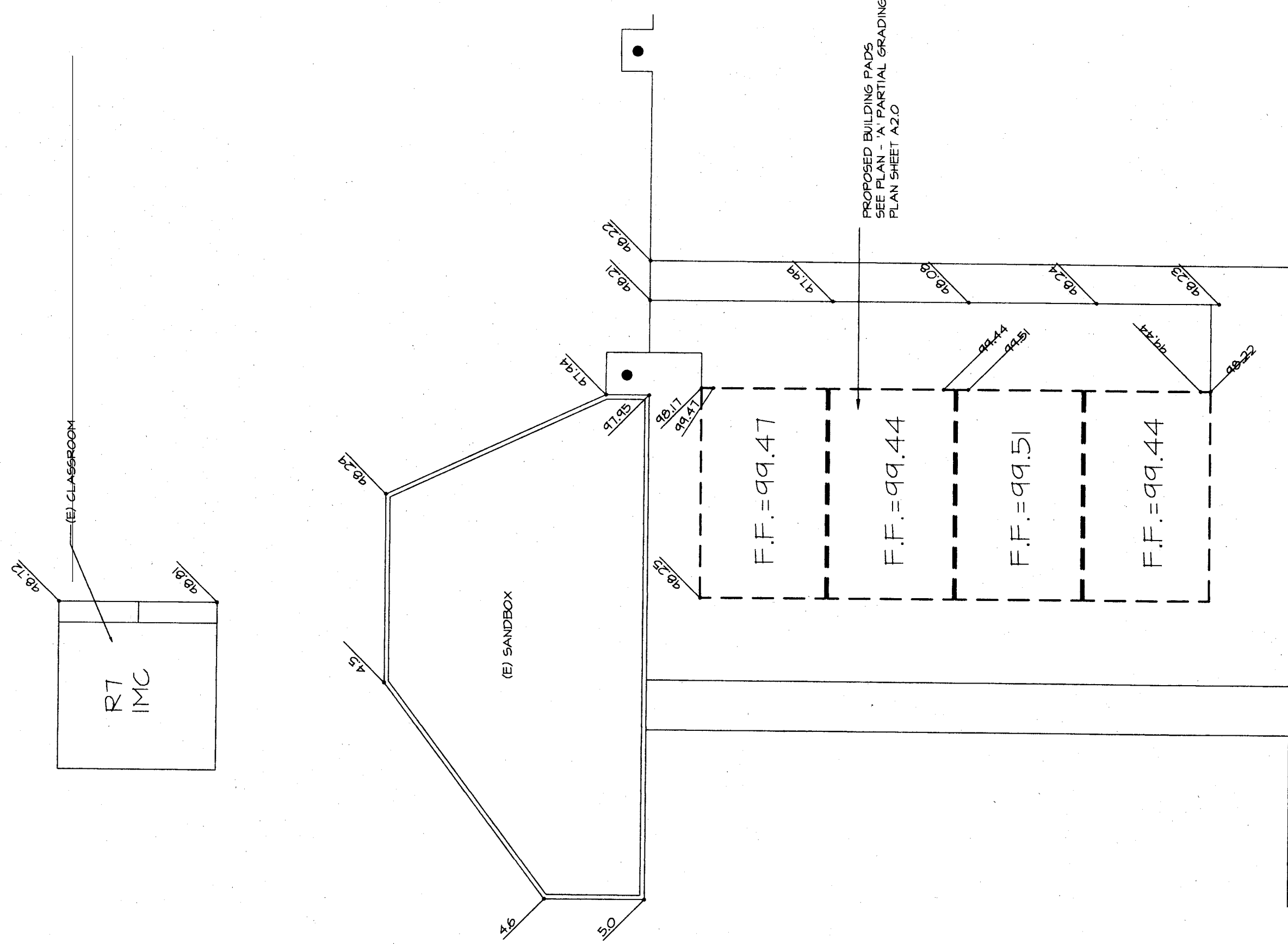

**EXISTING TOPO PLAN - FREMONT**  
 SCALE: 1" = 10'-0"  
 PLAN NORTH