

SCA Architect, Inc.
1301 L Street
Bakersfield, CA 93301
(805) 837-1832

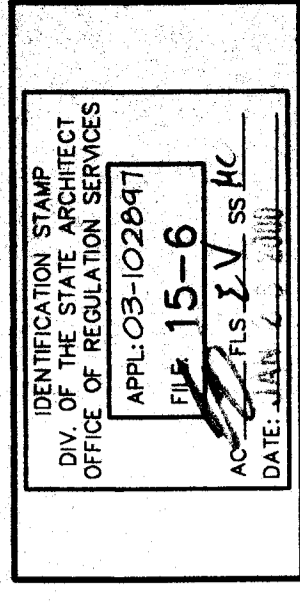
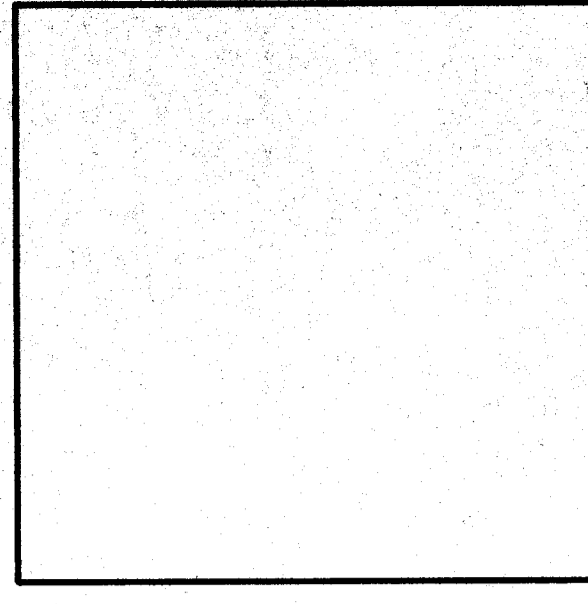

**RESTROOM BUILDINGS
AND RELOCATABLE CLASSROOMS**
FOR
BAKERSFIELD CITY SCHOOL DISTRICT
BAKERSFIELD, KERN COUNTY, CALIFORNIA

**TOPO SITE
PLAN
MT. VERNON**

CHECK AND VERIFY ALL DIMENSIONS
BEFORE PROCEEDING WITH THE
WORK. REPORT DISCREPANCIES
TO THE ARCHITECT. ALL
CONSTRUCTION SHALL CONFORM
TO THE C.S.C.

MARK	DATE	REVISIONS
△		
△		
△		
△		

JOB NO.	412
DRAWN	MB
CHECKED	MB
DATE	07/20/00

TTP
1.0
OF SHEETS

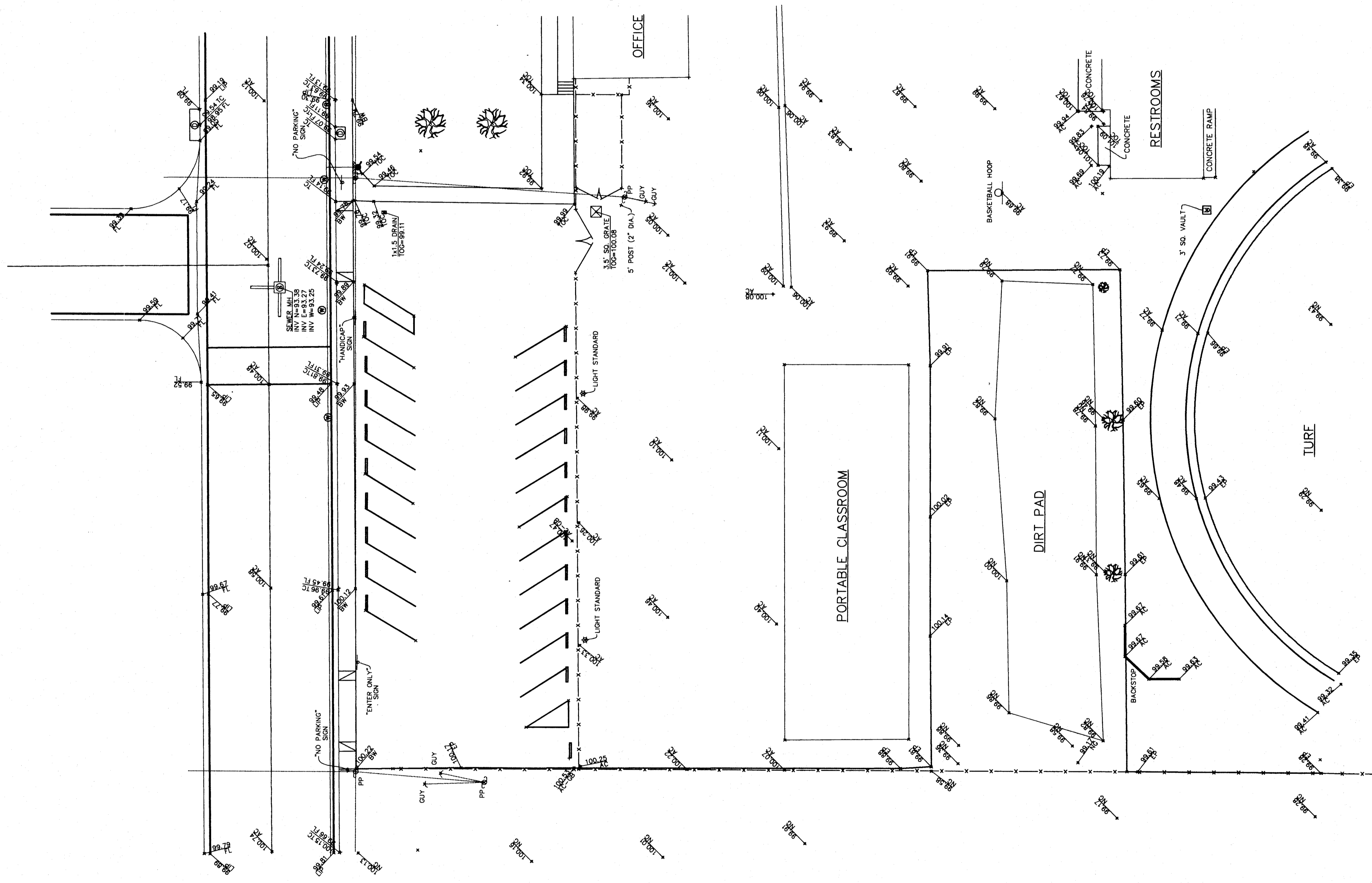

- LEGEND**
- x — x — EXISTING CHAIN LINK FENCE
 - — — — — EXISTING EDGE OF PAVEMENT
 - — — — — POWER POLE
 - TO, FROM
 - EXISTING ELEVATION (SHOWN HAFTED TYP.)
 - NATURAL GROUND ELEVATION
 - EDGE OF PAVEMENT ELEVATION
 - TOP OF PAVEMENT ELEVATION
 - BACK OF SIDEWALK ELEVATION
 - FLOWLINE ELEVATION
 - TOP OF CURB ELEVATION
 - TOP OF CONCRETE ELEVATION
 - LIP OF GUTTER ELEVATION
 - EXISTING TREE
 - 12" GAS LD
 - 12" WATER LD

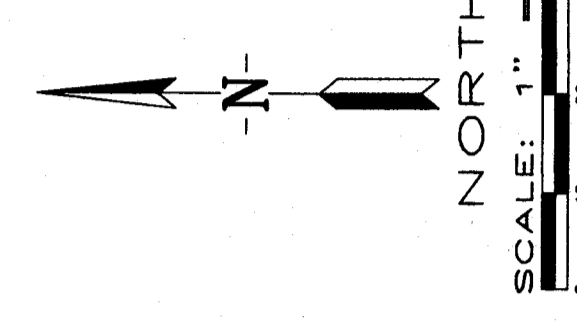

TOPO SITE PLAN - MT. VERNON ELEMENTARY