

MINIMUM SECTION DIMENSIONS
 A_{gross} = 848 in²
 I_x = 2277 in⁴ (EFFICIENT)
 S_x = 1407 in³ (EFFICIENT)
 JOIST SHALL BE UNFINISHED.
 F_y (min) = 50,000 PSI
 5/8\"/>

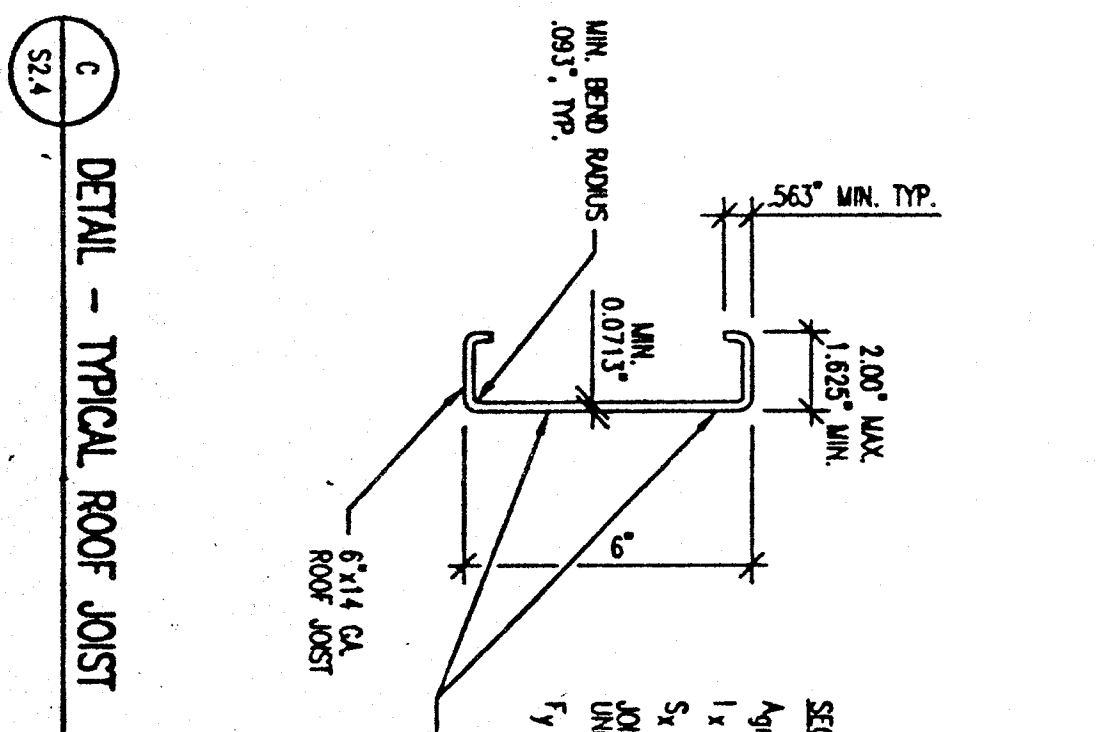

MINIMUM SECTION DIMENSIONS
 A_{gross} = 1,204 in²
 I_x = 3,598 in⁴ (EFFICIENT)
 S_x = 1,199 in³ (EFFICIENT)
 JOIST SHALL BE UNFINISHED.
 F_y (min) = 50,000 PSI
 5/8\"/>

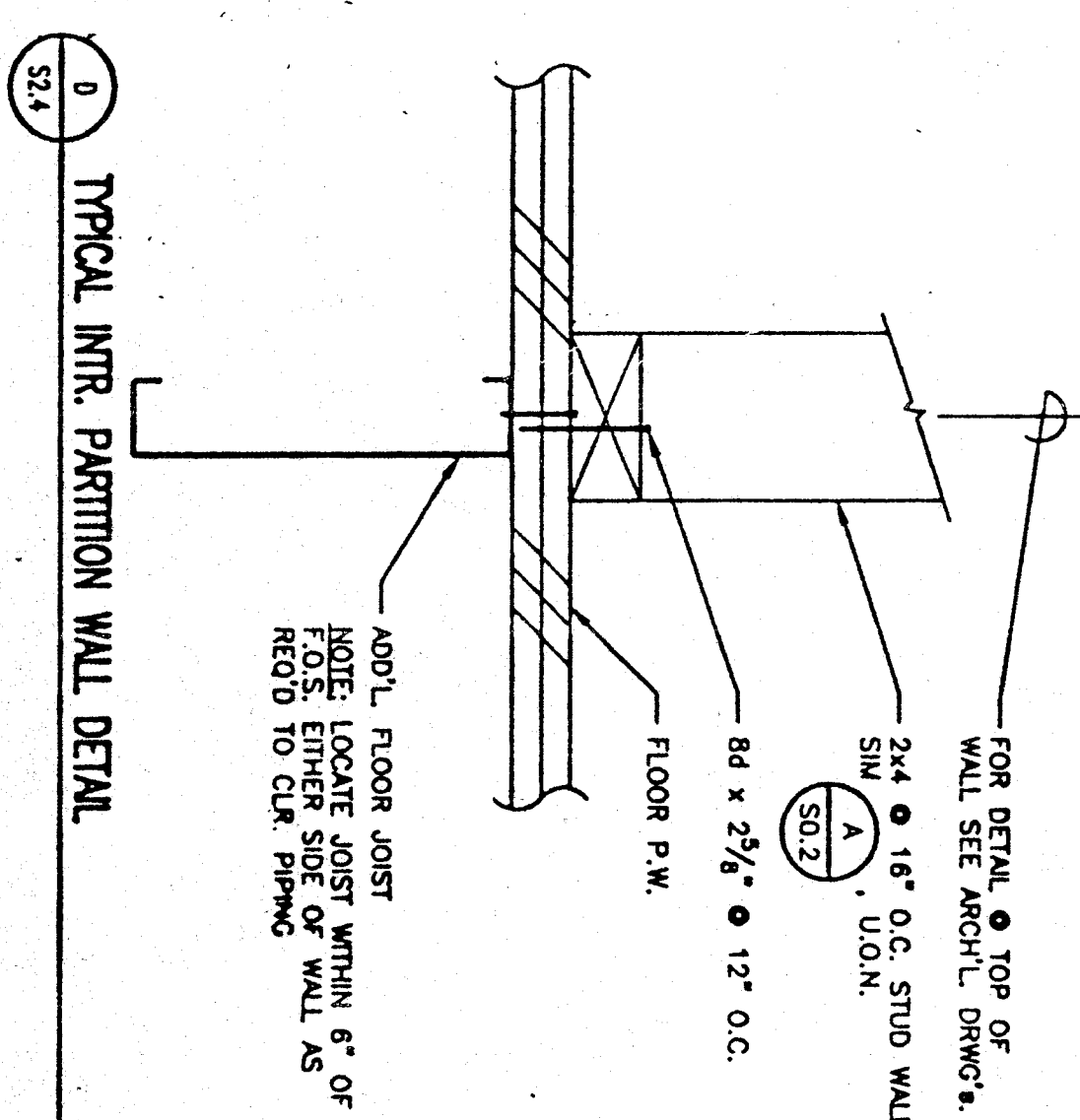

FOR DETAIL, TOP OF WALL SEE ARCHIT. DRAWING.
 2x4 @ 16\"/>

1. TYP. FLOOR PLAN - SIDE WALL MODULE
 SCALE: 1/4\"/>

2. TYP. ROOF PLAN - SIDEWALL MODULE
 SCALE: 1/4\"/>

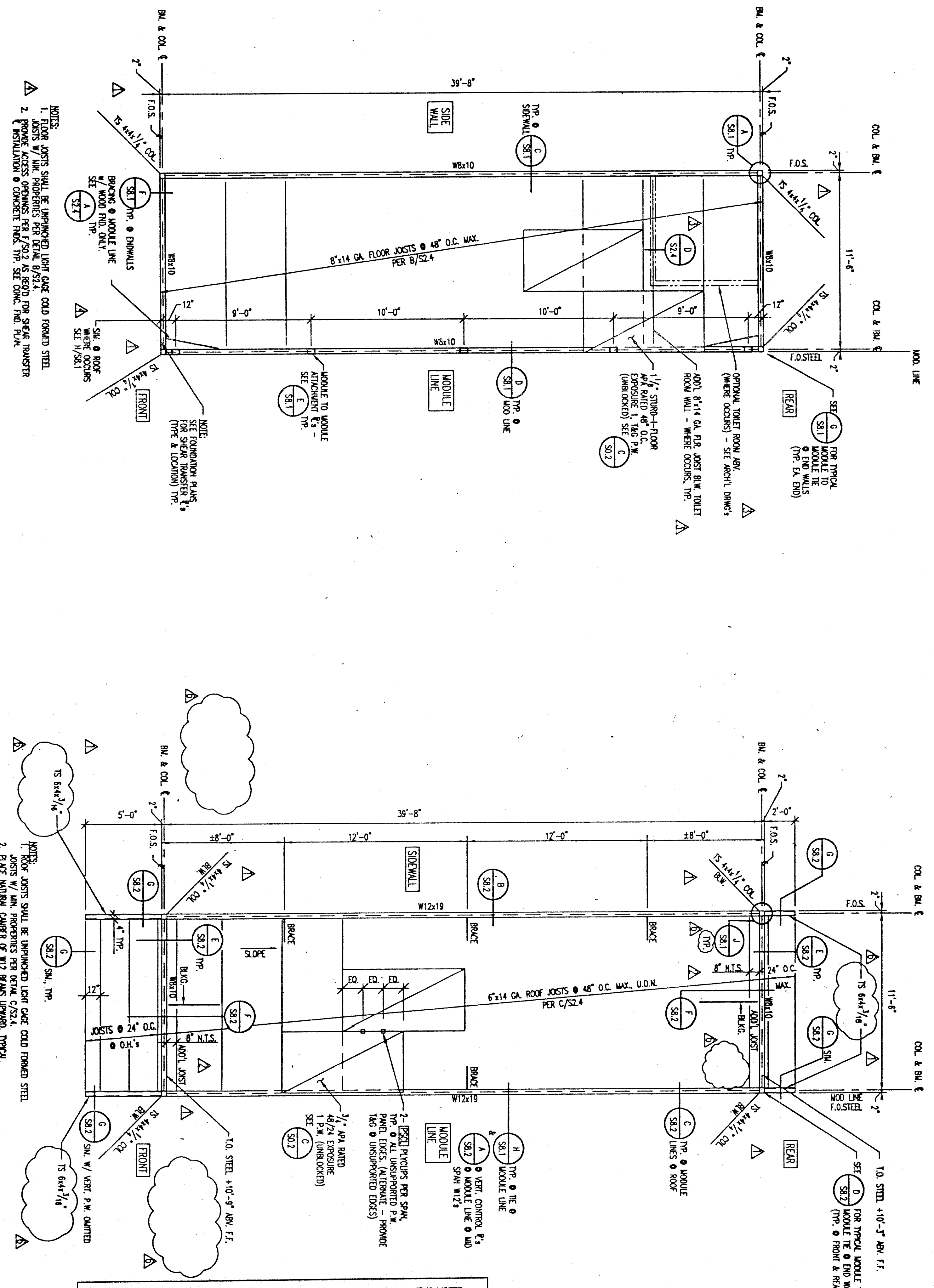

NOTES:
 1. ROOF JOIST SHALL BE UNFINISHED LIGHT GAUGE COIL ROLLED STEEL JOISTS WITH PROPERTIES PER 7/92.2 AS REFERRED TO IN SPECIFICATIONS.
 2. PROVIDE ACCESS OPENINGS PER 7/92.2 AS REFERRED TO IN SPECIFICATIONS.
 3. INSTALLATION OF CONCRETE FLOOR, TYP. SEE CONCR. PLAN FLOOR.

MINIMUM SECTION DIMENSIONS
 A_{gross} = 848 in²
 I_x = 2277 in⁴ (EFFICIENT)
 S_x = 1407 in³ (EFFICIENT)
 JOIST SHALL BE UNFINISHED.
 F_y (min) = 50,000 PSI
 5/8\"/>

NOTE: SEE S0.3 & S8.3 TYP. FOR METAL STUD WALL ALTERNATE

THESE DRAWINGS AND / OR SPECIFICATIONS AND / OR CALCULATIONS FOR THE ITEMS LISTED BELOW HAVE BEEN PREPARED BY OTHER DESIGN PROFESSIONALS WHO ARE LICENSED AND AUTHORIZED TO PREPARE SUCH DRAWINGS IN THIS STATE. THESE DOCUMENTS HAVE BEEN EXAMINED BY ME AND HAVE BEEN FOUND TO MEET THE APPROPRIATE REQUIREMENTS OF TITLE 24, CALIFORNIA CODE OF REGULATIONS AND THE PROJECT SPECIFICATIONS PREPARED BY THE CLIENT. THE DESIGNER'S RESPONSIBILITY IS LIMITED TO THE PORTION OF THE PROJECT FOR WHICH I AM THE INDIVIDUAL DESIGNATED TO BE IN GENERAL RESPONSIBLE (OR FOR WHICH I HAVE BEEN DELEGATED RESPONSIBILITY FOR THIS PORTION OF THE PROJECT). I HAVE NOT REVIEWED OR ACCEPTED (FOR DRAWINGS, LIST OF ALL ACCEPTED DRAWINGS ARE TO BE ATTACHED).

REGISTERED ARCHITECT
 STATE OF CALIFORNIA
 LICENSE # C-15700
 EXP. DATE 11/30/98
 DATE: OCT 18 1995

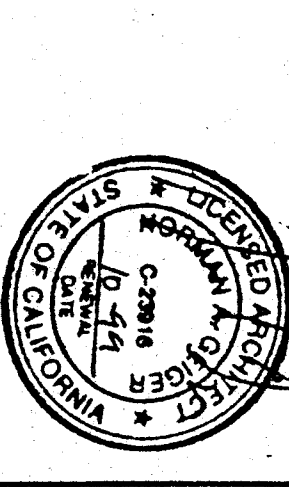

DESIGNED BY: S. S. S. S. S.
 DRAWN BY: J. S. S. S. S.
 DATE: 10/14/95

REVISIONS
 5-22-97
 6-30-97
 7-28-97
 8-27-97
 10-14-97

PC-330
 97007_PSP1
 SHEET S2.4

ANDERSON & DOIG
 STRUCTURAL ENGINEERS
 A CALIFORNIA CORPORATION
 10308 PLACE LANE, STE 100, SACRAMENTO, CA 95827-2515
 (916) 346-9622

REGISTERED PROFESSIONAL ENGINEER
 STATE OF CALIFORNIA
 LICENSE NO. 4494
 EXPIRES 10/31/97

PACESETTER INDUSTRIES, INC.
 P.O. BOX 1131, MODESTO, CA 95353 (209) 521-1600

24x40 RELOCATABLE BUILDING
 TYPICAL FLOOR & ROOF PLANS & DETAILS - SIDEWALL MODULES

NO.	DATE	DESCRIPTION	BY
1	5-22-97		BO
2	6-30-97		BO
3	7-28-97		BO
4	8-27-97		BO
5	10-14-97		BO