



Bakersfield City School District
Maintenance, Operations and Facilities Department
1501 Feliz Drive
Bakersfield, California 93307
Office (661) 631-5883 Fax (661) 834-9986

Jason Sitton, Director I sittonj@bcسد.com
Leonard Zasoski Jr., Assistant Director II zasoskil@bcسد.com
Daniel Wastafarro, Assistant Director II wastafarro@bcسد.com
Juan Montelongo, Assistant Director II montelongo@bcسد.com

April 01, 2026

To: All Bidders
Re: Abatement Projects: Williams Elementary School Abatement, Flooring & Painting – Addendum No. 01

1. Bid Date Change:
 - Original Bid Date – Thursday, April 9th at 10:00 a.m.
 - **NEW BID DATE – Friday, April 10th at 10:00 a.m.**
2. RFI Date Change:
 - Original RFI Date – Thursday, April 02, 2026
 - **NEW RFI DATE – Monday, April 06, 2026**
3. This addendum adds the Abatement Scope of Work to this project. The attached Abatement reports are hereby incorporated into the contract documents.

Please note that each project must be bid separately and submitted in its own individual sealed envelope. This process ensures that each project is evaluated independently and in accordance with our bid requirements. Please make sure the project name and number are clearly labeled on the outside of each sealed envelope.

Please date, sign and return this form via email to Brenda Orozco at orozcob@bcسد.com.

Date Print Name Signature

Print Company Name

Sincerely,

Leonard Zasoski, Jr.
Assistant Director II
Maintenance, Operations and Facilities
Bakersfield City School District



ASBESTOS ABATEMENT SCOPE OF WORK

Site Information:

Williams ES – Classrooms 14-17 & 19-22
1201 Williams Street, Bakersfield, CA 93305



Prepared for:

Bakersfield City School District
1300 Baker Street, Bakersfield, CA 93305
(661) 631-4600

Prepared by:

Kristy Yowell, CAC 09-4500 / CDPH LRC-4640
YES Environmental, Inc. (YES, Inc.)
Project Number 26YES-36
March 2026



1201 24th Street, Suite B110-377, Bakersfield, CA 93301 / (661) 527-0820

ASBESTOS FLOORING ABATEMENT SCOPE OF WORK Williams ES – Flooring Abatement Project in Rooms 14-17 & 19-22

PURPOSE OF PROJECT

In order for Bakersfield City School District to renovate interior Classrooms 14-17 & 19-22, asbestos-containing flooring and baseboards materials (ACM) and associated adhesives, must be abated. In some rooms, the ACM is concealed beneath or behind non-ACM newer materials; which also must be removed.

The contractor is responsible for field verifying their own measurements for bidding, notification, waste characterization, or any other purpose. This Scope of Work should be used in conjunction with all Federal, State and local codes.

SEQUENCE OF WORK

1. The contractor shall start and complete all of the work described in this SOW in classrooms 19-22.
2. Following the completion of work in 19-22, the contractor shall commence with work in classrooms 14-17.

IMPORTANT DATES

Project Start Date – Wednesday, June 3, 2026

Abatement Completion Date – Friday, June 19, 2026

Clearance Air Sample Collection Date – No later than Saturday, June 20, 2026

Clearance Air Sample Results Expected to be Received Date – No later than Monday, June 22, 2026

Containment Removal Date – No later than Tuesday, June 23, 2026

WORK PERIOD

The remediation contractor shall have fifteen days (15) days to complete the abatement portion of this project. No work will be permitted on Sundays. Clearance air samples will be collected the next day following completion of abatement. Removal of containment shall occur the next business day immediately following the receipt of passing clearance air samples.

DEFINITIONS

Asbestos-Containing: material containing any detectable amount of asbestos. Acronym ACM.

Abatement Activities: precleaning of jobsite, setup of containment/regulated area, removal or disturbance of asbestos-containing materials and final cleaning inside containment/regulated area in preparation for post abatement clearance air sampling or completion of work visual.

Contractor: Remediation contractor, abatement contractor or any trade qualified to conduct the work described in this Scope of Work.

Consultant: YES Environmental, Inc. representative.



YES Environmental, Inc.

1201 24th Street, Suite B110-377, Bakersfield, CA 93301 / (661) 527-0820

Client: Bakersfield City School District

YES Project No.: 25YES-94

Site: Williams ES - CRs 1-4, 10-12, 14-17, & 19-22

Date of Inspection: 11/26/2025

Asbestos Inspection Report by Room

Building: E (CRs 13-14)	Room Name: CR 14	Rm Ft²: 1,024
	Room Dimensions: L=32 W=32 H=10	

Component	HMR #	Sample #	Material Description	Substrate	Asbestos	
					Y/N	Friable Y/N
Floor	3	03C	Carpet - red/grey/black multi & clear glue NOTE: East half of room 75%	ACM Floor Tile	N	N
Floor	10		Sheet flooring - cream/pink/blue mosaic & tan glue NOTE: West half of room 25%	ACM Floor Tile	N	N
Floor	14		9" Floor tile - tan with red streaks & black mastic NOTE: Floor tile =3% CH & black mastic=1-3% CH - Previous inspection 25YES-18 list this material on HMRS 2 & 3.	concrete	Y	N
Baseboard	4	04E	4" Baseboard red, tan glue, & brown glue	ACM BB & tackboards	N	N
Baseboard	9		Concealed 4" baseboard black with brown glue NOTE: Baseboard=3% CH & brown glue=ND		Y	N
Walls	5		Vinyl jacketed tackboard Material not inspected or sampled for asbestos as it was not included in the work order. However, this material is confirmed to be installed over asbestos-containing baseboard remnants.	wood walls	N	n/a
Walls	n/a		Wood walls contaminated at the base of the wall by ACM baseboard remnants.		Y	N
Cabinetry	n/a		Cabinet toe-kicks are contaminated by ACM baseboard remnants.		Y	N
Ceiling	7		Lay-in ceiling panel - 2'x4' gouge pinhole pattern		N	n/a
Counter Top	8	08A	Brown faux wood-looking counter top material, green vapor barrier & glue		N	n/a

BCSD's scope is full interior survey.

RED=contains asbestos or assumed

BLACK=no asbestos detected or non-suspect

Friable condition=assessed at the time of inspection

Subject to change at any time



YES Environmental, Inc.

1201 24th Street, Suite B110-377, Bakersfield, CA 93301 / (661) 527-0820

Building: E (CRs 13-14)	Room Name: Storage	Rm Ft²: 144
Room between west RRS	Room Dimensions: L=9 W=16 H=10	

Component	HMR #	Sample #	Material Description	Substrate	Asbestos	
					Y/N	Friable Y/N
Floor	n/a		Concrete bare & exposed		n/a	n/a
BB	n/a		None.			

BCSD scope of work for this room is new flooring and repaint.

RED=contains asbestos or assumed

BLACK=no asbestos detected or non-suspect

Friable condition=assessed at the time of inspection

Subject to change at any time



YES Environmental, Inc.

1201 24th Street, Suite B110-377, Bakersfield, CA 93301 / (661) 527-0820

Client: Bakersfield City School District

YES Project No.: 25YES-94

Site: Williams ES - CRs 1-4, 10-12, 14-17, & 19-22

Date of Inspection: 11/26/2025

Asbestos Inspection Report by Room

Building: H (CRs 15-17)	Room Name: Psych Office	Rm Ft²: 200
Room Dimensions: L=10 W=20 H=8		

Component	HMR #	Sample #	Material Description	Substrate	Asbestos	
					Y/N	Friable Y/N
Floor	3	03G	Carpet - red/grey/black multi & clear glue	ACM Floor Tile	N	N
Floor	14		9" Floor tile - tan with red streaks & black mastic NOTE: Floor tile =3% CH & black mastic=1-3% CH - Previous inspection 25YES-18 list this material on HMRs 2 & 3.	concrete	Y	N
Baseboard	4	04G	4" Baseboard red, tan glue, & brown glue	ACM BB & tackboards	N	N
Baseboard	9		4" Baseboard black with brown glue NOTE: Baseboard=3% CH & brown glue=ND		Y	N
Walls	5		Vinyl jacketed tackboard Material not inspected or sampled for asbestos as it was not included in the work order. However, this material is confirmed to be installed over asbestos-containing baseboard remnants.	wood walls	N	n/a
Walls	n/a		Wood walls contaminated at the base of the wall by ACM baseboard remnants.		Y	N
Cabinetry	n/a		Cabinet toe-kicks are contaminated by ACM baseboard remnants.		Y	N

BCSD scope of work for this room is new flooring and repaint.

RED=contains asbestos or assumed

BLACK=no asbestos detected or non-suspect

Friable condition=assessed at the time of inspection

Subject to change at any time



YES Environmental, Inc.

1201 24th Street, Suite B110-377, Bakersfield, CA 93301 / (661) 527-0820

Building: H (CRs 15-17) Office to the north of the psych	Room Name: Psych A - Office	Rm Ft²: 200
	Room Dimensions: L=10 W=20 H=8	

Component	HMR #	Sample #	Material Description	Substrate	Asbestos	
					Y/N	Friable Y/N
Floor	3		Carpet - red/grey/black multi & clear glue	ACM Floor Tile	N	N
Floor	14		9" Floor tile - tan with red streaks & black mastic NOTE: Floor tile =3% CH & black mastic=1-3% CH - Previous inspection 25YES-18 list this material on HMRs 2 & 3.	concrete	Y	N
Baseboard	4	04G	4" Baseboard red, tan glue, & brown glue	ACM BB & tackboards	N	N
Baseboard	9		4" Baseboard black with brown glue NOTE: Baseboard=3% CH & brown glue=ND		Y	N
Walls	5		Vinyl jacketed tackboard Material not inspected or sampled for asbestos as it was not included in the work order. However, this material is confirmed to be installed over asbestos-containing baseboard remnants.	wood walls	N	n/a
Walls	n/a		Wood walls contaminated at the base of the wall by ACM baseboard remnants.		Y	N
Cabinetry	n/a		Cabinet toe-kicks are contaminated by ACM baseboard remnants.		Y	N

BCSD scope of work for this room is new flooring and repaint.

RED=contains asbestos or assumed

BLACK=no asbestos detected or non-suspect

Friable condition=assessed at the time of inspection

Subject to change at any time



YES Environmental, Inc.

1201 24th Street, Suite B110-377, Bakersfield, CA 93301 / (661) 527-0820

Building:	H (CRs 15-17)	Room Name:	CR 15	Rm Ft²:	1,024
		Room Dimensions:	L=32 W=32 H=10		

Component	HMR #	Sample #	Material Description	Substrate	Asbestos	
					Y/N	Friable Y/N
Floor	3	03C	Carpet - red/grey/black multi & clear glue NOTE: East half of room 75%	ACM Floor Tile	N	N
Floor	2	02B	Linoleum cream mosaic & glue	ACM Floor Tile	N	N
Floor	14		9" Floor tile - tan with red streaks & black mastic NOTE: Floor tile =3% CH & black mastic=1-3% CH - Previous inspection 25YES-18 list this material on HMRs 2 & 3.	concrete	Y	N
Baseboard	4	04F	4" Baseboard red, tan glue, & brown glue	ACM BB & tackboards	N	N
Baseboard	9	09B	Concealed 4" baseboard black with brown glue NOTE: Baseboard=3% CH & brown glue=ND		Y	N
Walls	5		Vinyl jacketed tackboard Material not inspected or sampled for asbestos as it was not included in the work order. However, this material is confirmed to be installed over asbestos-containing baseboard remnants.	wood walls	N	n/a
Walls	n/a		Wood walls contaminated at the base of the wall by ACM baseboard remnants.		Y	N
Cabinetry	n/a		Cabinet toe-kicks are contaminated by ACM baseboard remnants.		Y	N
Ceiling	7	07C	Lay-in ceiling panel - 2'x4' gouge pinhole pattern		N	n/a
Counter Top	8	08B	Brown faux wood-looking counter top material, green vapor barrier & glue		N	n/a

BCSD's scope is full interior survey.

RED=contains asbestos or assumed

BLACK=no asbestos detected or non-suspect

Friable condition=assessed at the time of inspection

Subject to change at any time



YES Environmental, Inc.

1201 24th Street, Suite B110-377, Bakersfield, CA 93301 / (661) 527-0820

Building:	H (CRs 15-17)	Room Name:	CR 16	Rm Ft²:	1,024
		Room Dimensions:	L=32 W=32 H=10		

Component	HMR #	Sample #	Material Description	Substrate	Asbestos	
					Y/N	Friable Y/N
Floor	3	03D	Carpet - red/grey/black multi & clear glue NOTE: East half of room 75%	ACM Floor Tile	N	N
Floor	10		Sheet flooring - cream/pink/blue mosaic & tan glue NOTE: West half of room 25%	ACM Floor Tile	N	N
Floor	14		9" Floor tile - tan with red streaks & black mastic NOTE: Floor tile =3% CH & black mastic=1-3% CH - Previous inspection 25YES-18 list this material on HMRs 2 & 3.	concrete	Y	N
Baseboard	4		4" Baseboard red, tan glue, & brown glue	ACM BB & tackboards	N	N
Baseboard	9		Concealed 4" baseboard black with brown glue NOTE: Baseboard=3% CH & brown glue=ND		Y	N
Walls	5	05C	Vinyl jacketed tackboard Material not inspected or sampled for asbestos as it was not included in the work order. However, this material is confirmed to be installed over asbestos-containing baseboard remnants.	wood walls	N	n/a
Walls	n/a		Wood walls contaminated at the base of the wall by ACM baseboard remnants.		Y	N
Cabinetry	n/a		Cabinet toe-kicks are contaminated by ACM baseboard remnants.		Y	N
Ceiling	7		Lay-in ceiling panel - 2'x4' gouge pinhole pattern		N	n/a

BCSD's scope is full interior survey.

RED=contains asbestos or assumed

BLACK=no asbestos detected or non-suspect

Friable condition=assessed at the time of inspection

Subject to change at any time



YES Environmental, Inc.

1201 24th Street, Suite B110-377, Bakersfield, CA 93301 / (661) 527-0820

Building:	H (CRs 15-17)	Room Name:	CR 17	Rm Ft²:	1,024
		Room Dimensions:	L=32 W=32 H=10		

Component	HMR #	Sample #	Material Description	Substrate	Asbestos	
					Y/N	Friable Y/N
Floor	3		Carpet - red/grey/black multi & clear glue NOTE: East half of room 75%	ACM Floor Tile	N	N
Floor	10		Sheet flooring - cream/pink/blue mosaic & tan glue NOTE: West half of room 25%	ACM Floor Tile	N	N
Floor	14		9" Floor tile - tan with red streaks & black mastic NOTE: Floor tile =3% CH & black mastic=1-3% CH - Previous inspection 25YES-18 list this material on HMRs 2 & 3.	concrete	Y	N
Baseboard	4	04G	4" Baseboard red, tan glue, & brown glue	ACM BB & tackboards	N	N
Baseboard	9	09A	Concealed 4" baseboard black with brown glue NOTE: Baseboard=3% CH & brown glue=ND		Y	N
Walls	5		Vinyl jacketed tackboard Material not inspected or sampled for asbestos as it was not included in the work order. However, this material is confirmed to be installed over asbestos-containing baseboard remnants.	wood walls	N	n/a
Walls	n/a		Wood walls contaminated at the base of the wall by ACM baseboard remnants.		Y	N
Cabinetry	n/a		Cabinet toe-kicks are contaminated by ACM baseboard remnants.		Y	N
Ceiling	7		Lay-in ceiling panel - 2'x4' gouge pinhole pattern		N	n/a
Counter Top	6	06C	Grey faux wood-looking counter top material & glue		N	n/a

BCSD's scope is full interior survey.

RED=contains asbestos or assumed

BLACK=no asbestos detected or non-suspect

Friable condition=assessed at the time of inspection

Subject to change at any time



YES Environmental, Inc.

1201 24th Street, Suite B110-377, Bakersfield, CA 93301 / (661) 527-0820

Client: Bakersfield City School District

YES Project No.: 25YES-94

Site: Williams ES - CRs 1-4, 10-12, 14-17, & 19-22

Date of Inspection: 11/26/2025

Asbestos Inspection Report by Room

Building: D (CRs 18-19)	Room Name: CR 19	Rm Ft²: 1,024
	Room Dimensions: L=32 W=32 H=10	

Component	HMR #	Sample #	Material Description	Substrate	Asbestos	
					Y/N	Friable Y/N
Floor	3	03A	Carpet - red/grey/black multi & clear glue NOTE: East half of room 75%	ACM Floor Tile	N	N
Floor	10		Sheet flooring - cream/pink/blue mosaic & tan glue NOTE: West half of room 25%	ACM Floor Tile	N	N
Floor	14		9" Floor tile - tan with red streaks & black mastic NOTE: Floor tile =3% CH & black mastic=1-3% CH - Previous inspection 25YES-18 list this material on HMRs 2 & 3.	concrete	Y	N
Baseboard	4	04A	4" Baseboard red, tan glue, & brown glue	ACM BB & tackboards	N	N
Baseboard	9		Concealed 4" baseboard black with brown glue NOTE: Baseboard=3% CH & brown glue=ND		Y	N
Walls	5	05A	Vinyl jacketed tackboard Material not inspected or sampled for asbestos as it was not included in the work order. However, this material is confirmed to be installed over asbestos-containing baseboard remnants.	wood walls	N	n/a
Walls	n/a		Wood walls contaminated at the base of the wall by ACM baseboard remnants.		Y	N
Cabinetry	n/a		Cabinet toe-kicks are contaminated by ACM baseboard remnants.		Y	N
Ceiling	7	07A	Lay-in ceiling panel - 2'x4' gouge pinhole pattern		N	n/a
Counter Top	6	06A	Grey faux wood-looking counter top material & glue		N	n/a

BCSD's scope is full interior survey.

RED=contains asbestos or assumed

BLACK=no asbestos detected or non-suspect

Friable condition=assessed at the time of inspection

Subject to change at any time



YES Environmental, Inc.

1201 24th Street, Suite B110-377, Bakersfield, CA 93301 / (661) 527-0820

Building: D (CRs 18-19) Room between west RRS	Room Name: Storage	Rm Ft²: 144
	Room Dimensions: L=9 W=16 H=10	

Component	HMR #	Sample #	Material Description	Substrate	Asbestos	
					Y/N	Friable Y/N
Floor	n/a		Concrete bare & exposed		n/a	n/a
BB	n/a		None.			

BCSD scope of work for this room is new flooring and repaint.

RED=contains asbestos or assumed
BLACK=no asbestos detected or non-suspect

Friable condition=assessed at the time of inspection
Subject to change at any time



YES Environmental, Inc.

1201 24th Street, Suite B110-377, Bakersfield, CA 93301 / (661) 527-0820

Client: Bakersfield City School District

YES Project No.: 25YES-94

Site: Williams ES - CRs 1-4, 10-12, 14-17, & 19-22

Date of Inspection: 11/26/2025

Asbestos Inspection Report by Room

Building: G (CRs 20-22)	Room Name: ELP Office	Rm Ft²: 320
	Room Dimensions: L=20 W=16 H=8	

Component	HMR #	Sample #	Material Description	Substrate	Asbestos	
					Y/N	Friable Y/N
Floor	12	12A	Carpet - blue/red/yellow multi & clear glue	concrete	N	n/a
Baseboard	13	13A	4" Blue baseboard & tan glue		N	n/a
Walls	n/a		Wood sheets		n/a	n/a

BCSD scope of work for this room is new flooring and repaint.

Building: G (CRs 20-22)	Room Name: Ball Room	Rm Ft²: 320
	Room Dimensions: L=20 W=16 H=8	

Component	HMR #	Sample #	Material Description	Substrate	Asbestos	
					Y/N	Friable Y/N
Floor	14		9" Floor tile - tan with red streaks & black mastic NOTE: Floor tile =3% CH & black mastic=1-3% CH - Previous inspection 25YES-18 list this material on HMRs 2 & 3.	concrete	Y	N
Baseboard	9	09C	4" Baseboard black with brown glue NOTE: Baseboard=3% CH & brown glue=ND		Y	N
Walls	n/a		Wood sheets contaminated at the base of the wall by ACM baseboard remnants.		Y	N

BCSD scope of work for this room is new flooring and repaint.

RED=contains asbestos or assumed
BLACK=no asbestos detected or non-suspect

Friable condition=assessed at the time of inspection
Subject to change at any time



YES Environmental, Inc.

1201 24th Street, Suite B110-377, Bakersfield, CA 93301 / (661) 527-0820

Building:	G (CRs 20-22)	Room Name:	CR 20	Rm Ft²:	1,024
		Room Dimensions:	L=32 W=32 H=10		

Component	HMR #	Sample #	Material Description	Substrate	Asbestos	
					Y/N	Friable Y/N
Floor	3	03C	Carpet - red/grey/black multi & clear glue NOTE: East half of room 75%	ACM Floor Tile	N	N
Floor	2	02A	Linoleum cream mosaic & glue	ACM Floor Tile	N	N
Floor	14		9" Floor tile - tan with red streaks & black mastic NOTE: Floor tile =3% CH & black mastic=1-3% CH - Previous inspection 25YES-18 list this material on HMRs 2 & 3.	concrete	Y	N
Baseboard	4	04C	4" Baseboard red, tan glue, & brown glue	ACM BB & tackboards	N	N
Baseboard	9		Concealed 4" baseboard black with brown glue NOTE: Baseboard=3% CH & brown glue=ND		Y	N
Walls	5		Vinyl jacketed tackboard Material not inspected or sampled for asbestos as it was not included in the work order. However, this material is confirmed to be installed over asbestos-containing baseboard remnants.	wood walls	N	n/a
Walls	n/a		Wood walls contaminated at the base of the wall by ACM baseboard remnants.		Y	N
Cabinetry	n/a		Cabinet toe-kicks are contaminated by ACM baseboard remnants.		Y	N
Ceiling	7		Lay-in ceiling panel - 2'x4' gouge pinhole pattern		N	n/a
Counter Top	6	06B	Grey faux wood-looking counter top material & glue		N	n/a

BCSD's scope is full interior survey.

RED=contains asbestos or assumed

BLACK=no asbestos detected or non-suspect

Friable condition=assessed at the time of inspection

Subject to change at any time



YES Environmental, Inc.

1201 24th Street, Suite B110-377, Bakersfield, CA 93301 / (661) 527-0820

Building:	G (CRs 20-22)	Room Name:	CR 21	Rm Ft²:	1,024
		Room Dimensions:	L=32 W=32 H=10		

Component	HMR #	Sample #	Material Description	Substrate	Asbestos	
					Y/N	Friable Y/N
Floor	3		Carpet - red/grey/black multi & clear glue NOTE: East half of room 75%	ACM Floor Tile	N	N
Floor	1	01A	Floor tile 12" - cream w/ brown streaks, yellow glue, & black mastic	ACM Floor Tile	N	n/a
Floor	14		9" Floor tile - tan with red streaks & black mastic NOTE: Floor tile =3% CH & black mastic=1-3% CH - Previous inspection 25YES-18 list this material on HMRs 2 & 3.	concrete	Y	N
Baseboard	4	04B	4" Baseboard red, tan glue, & brown glue	ACM BB & tackboards	N	N
Baseboard	9		Concealed 4" baseboard black with brown glue NOTE: Baseboard=3% CH & brown glue=ND		Y	N
Walls	5	05B	Vinyl jacketed tackboard Material not inspected or sampled for asbestos as it was not included in the work order. However, this material is confirmed to be installed over asbestos-containing baseboard remnants.	wood walls	N	n/a
Walls	n/a		Wood walls contaminated at the base of the wall by ACM baseboard remnants.		Y	N
Cabinetry	n/a		Cabinet toe-kicks are contaminated by ACM baseboard remnants.		Y	N
Ceiling	7	07B	Lay-in ceiling panel - 2'x4' gouge pinhole pattern		N	n/a

BCSD's scope is full interior survey.

RED=contains asbestos or assumed

BLACK=no asbestos detected or non-suspect

Friable condition=assessed at the time of inspection

Subject to change at any time



YES Environmental, Inc.

1201 24th Street, Suite B110-377, Bakersfield, CA 93301 / (661) 527-0820

Building: G (CRs 20-22)	Room Name: CR 22	Rm Ft²: 1,024
Room Dimensions: L=32 W=32 H=10		

Component	HMR #	Sample #	Material Description	Substrate	Asbestos	
					Y/N	Friable Y/N
Floor	3	03B	Carpet - red/grey/black multi & clear glue NOTE: East half of room 75%	ACM Floor Tile	N	N
Floor	10		Sheet flooring - cream/pink/blue mosaic & tan glue NOTE: West half of room 25%	ACM Floor Tile	N	N
Floor	14		9" Floor tile - tan with red streaks & black mastic NOTE: Floor tile =3% CH & black mastic=1-3% CH - Previous inspection 25YES-18 list this material on HMRs 2 & 3.	concrete	Y	N
Baseboard	4	04D	4" Baseboard red, tan glue, & brown glue	ACM BB & tackboards	N	N
Baseboard	9		Concealed 4" baseboard black with brown glue NOTE: Baseboard=3% CH & brown glue=ND		Y	N
Walls	5		Vinyl jacketed tackboard Material not inspected or sampled for asbestos as it was not included in the work order. However, this material is confirmed to be installed over asbestos-containing baseboard remnants.	wood walls	N	n/a
Walls	n/a		Wood walls contaminated at the base of the wall by ACM baseboard remnants.		Y	N
Cabinetry	n/a		Cabinet toe-kicks are contaminated by ACM baseboard remnants.		Y	N
Ceiling	7		Lay-in ceiling panel - 2'x4' gouge pinhole pattern		N	n/a

BCSD's scope is full interior survey.

RED=contains asbestos or assumed

BLACK=no asbestos detected or non-suspect

Friable condition=assessed at the time of inspection

Subject to change at any time



NOTIFICATIONS

The contractor shall be responsible for the submission of an asbestos notification and renovation permit form to San Joaquin Valley Air Pollution Control District, Cal/OSHA and all other notifications triggered by asbestos removal. Contractor shall pay any associated fee based on measurements and material quantification as determined by the contractor.

SUPERVISOR & WORKER TRAINING REQUIRED

Workers and supervisors disturbing asbestos shall have AHERA accredited training as asbestos workers or contractor supervisors.

PRE-JOB SUBMITTAL REQUIREMENTS

A hard copy of the contractor's pre-job submittal packet shall be submitted to YES, Inc. and:

1. Include all of the items listed in the attached Submittal Requirements;
2. Be provided to and approved by YES, Inc. prior to the start of work by the contractor.
3. Manifests shall be submitted to the project manager on the first day of the project for review, and also for final approval prior to waste removal from the job site.
4. Double sided copies are not acceptable.
5. Delays in providing the required submittals may affect the start of the project.
6. Electronic submittals will not be accepted.

OTHER CONSIDERATIONS

Item	District Provided	Contractor Must Provide	Not Applicable / Required
Water	X		
Power	X		
Removal of Items to be saved	X		
Removal & Disposal of Items Remaining in Work Area		X	
Safety & Security of Equipment		X	
Challenge testing of HEPA filtered equipment to have been performed within 5 calendar days of the start of the project		X	

ALLOWABLE FORMS OF COMMUNICATION

The contractor shall establish a means of communication between the supervisor and workers inside the containment/regulated area which includes two-way radios or equivalent. At no time will yelling, whistling or banging on containment, walls or on the decontamination chambers be allowed as a form of communication.

OCCUPANCY

These buildings will be unoccupied in the areas where abatement is occurring. Other areas on campus, but outside of the abatement containment, may be occupied by staff, students, and other trades conducting work at this site.

WASTE BIN/CONTAINERS

All bins/containers brought on-site to deposit waste into must be lockable or securable. Bins shall be secured at the end of every shift. Plywood shall be placed under the wheels of each bin to protect the existing surface. Bins must be double lined with 6-mil poly prior to waste being deposited. Containers must have the appropriate labels affixed on them as soon as any asbestos-contaminated debris is deposited.



ASBESTOS CONTAINMENT/REGULATED AREA SETUP REQUIREMENTS

Containment setup requirements for all containments/regulated areas:

1. Classroom 14 shall be set up as a single containment.
2. Classrooms 15-17 and west adjacent ancillary offices, shall be set up as a single containment, using an exterior poly tunnel to connect classrooms or using wire reinforced exhaust flex tubing between rooms to create shared air space.
3. Classroom 19 shall be set up as a single containment.
4. Classrooms 20-22 and west adjacent ancillary offices, shall be set up as a single containment, using an exterior poly tunnel to connect classrooms or using wire reinforced exhaust flex tubing between rooms to create shared air space.
5. At no time shall the contractor secure their exterior tunnel system, by any means to the roof of the buildings.
6. Thresholds shall be removed carefully without being damaged and saved for the District to reuse.
7. All poly used on this project shall be a minimum of 6-mil thickness and flame retardant (FR). All critical barriers shall be sealed prior to any installation of poly on the walls or false ceiling with at least one layer of 6-mil FR poly.
8. Contractor shall attach poly walls and ceiling to the upper window sills of the classrooms.
9. Contractor shall exhaust the negative air unit exhaust hoses through the uppermost windows of the classrooms. Contractor SHALL NOT exhaust through lower windows.
10. The walls shall be covered with at least a single-layer of 6-mil FR poly. In addition, a four-foot poly splash guard shall be installed.
11. The false poly ceiling shall be installed using at least a single-layer of 6-mil FR poly.
12. All containments shall be built to accommodate the proper opening/closing function of the doors leading to each classroom. This includes ensuring the poly is installed in such a fashion it is not torn during the operation of the doors at the beginning and end of shifts.
13. The containment shall have, at a minimum, a two-stage decontamination chamber setup which meets the following conditions:
 - o Must be adjacent to the regulated area/containment for the decontamination of employees and their equipment used inside the regulated area/containment;
 - o The chamber farthest away from the regulated area/containment shall be designed for employees to don PPE before entering the regulated area/containment; to don street clothes upon exiting the regulation area/containment; and storage of other necessary items of the employees which cannot enter the regulated area/containment. This chamber shall be built large enough to accommodate all workers donning PPE without being able to be seen by staff, students, or anyone else walking by.
 - o The chamber most adjacent to the regulated area/containment shall be designed for the person exiting the regulated area/containment to use clean water, soap, and towels to decontaminate any part of their bodies and PPE such as their respirator.
 - o Both chambers shall be of sufficient size to accommodate cleaning of equipment and removing personal protective equipment without the spreading of contamination beyond the area (as determined by visual accumulations).
14. All those entering the containments must sign in on an entry/exit log that documents their entrance and exit times. This record is to also include lunch times and other breaks.
15. The consultant must give final approval for containment setups before abatement commences.
16. As work continues, the contractor shall assure that any additional critical barriers discovered are sealed immediately.
17. The contractor shall continually inspect the containments for deficiencies or breaches. If any are discovered, all abatement activities shall halt immediately until the deficiencies are fixed or repaired satisfactorily. These incidents shall be reported to the on-site consultant immediately.
18. The contractor shall exercise caution to ensure setup of containment does not damage in any way data cabling, electrical conduits, tackboards, smart-boards, etc.
19. If the setup of the containments requires questionable installation, the District and Consultant shall be asked in writing and approval must be given in writing prior to work being performed.



20. The District does not intend to repaint the exteriors of these rooms. Therefore, the contractor shall exercise care during the construction and deconstruction of the containment and decontamination chambers. If products used to set up the containments leave a residue, the contractor shall be responsible for the removal of the residue immediately following receipt of the passing clearance air sampling results.

NEGATIVE PRESSURE & HEPA FILTERED EQUIPMENT REQUIREMENTS

1. Challenge testing is required on equipment using HEPA filters (see Other Considerations above). Units arriving dirty or appearing to be contaminated shall be removed from the project site. Units must be positioned in the standard upright manner in which the manufacturer designed the equipment to operate.
2. The contractor shall ensure that sufficient negative air units are used to create a minimum air pressure differential of -0.030" and recorded on a manometer. Negative air units shall run continuously until clearance has been achieved. All air filtration devices shall remain sealed when not functioning. All units shall discharge to the exterior of the building during abatement activities.
3. At the end of each shift, if containment cannot be secured while exhausting to the exterior of the building, the contractor shall put the negative air units in scrub mode overnight. At the beginning of each shift, the contractor shall re-establish negative pressure in each containment.

WORKER PROTECTION

The contractor shall provide respiratory protection as outlined in current Cal/OSHA regulations. However, at a minimum:

1. During the removal and detail cleaning, workers shall wear a half-face negative-pressure respirator with P-100 (HEPA) cartridges, and dual charcoal/HEPA cartridges shall be utilized during mastic removal.
2. Disposable coveralls and eye protection shall be worn by all workers during all abatement activities, and detail cleaning phases of this project.
3. Should personal air monitoring results not be received the Monday immediately following week after being collected, the asbestos consultant reserves the right to require the workers to don PAPRs until personal air monitoring results are received.

ASBESTOS ABATEMENT PROCEDURES

Abatement procedures for all ACM on this project:

1. The carpet and 12" floor tile may only be removed after containment is completed, negative pressure is established and the onsite consultant has given verbal approval for removal to commence.
2. The tackboard shall be cut no higher than 5" above the finished floor to gain access to ACM baseboard and associated adhesives. The contractor may choose to cut the contaminated wood wall to remove the ACM entirely.
3. The ACM baseboards and associated adhesives shall be removed in a manner that remove all of the three-dimensional ACM at the base of cabinetry. Staining from the mastic may remain provided, no three-dimensional debris remain.
4. Where ACM flooring materials exists under walls that will remain, the contractor shall break the ACM flooring materials flush to the wall. Remove the ACM adhesives flush to the wall.
5. Wet all ACM with an amended water solution using equipment capable of providing a fine spray mist, in order to reduce airborne-fiber concentrations when the material is disturbed.
6. The contractor shall use the following product to remove the asbestos-containing black mastic: CHEMSAFE CLEAR. See attached Safety Data Sheet for product.
7. The ACM must be double bagged in poly bags. An acceptable alternative is disposal of ACM into a single poly bag which is placed into a leak-tight drum for disposal.
8. Bags should be securely sealed to prevent accidental opening and leakage by tying tops of bags in an overhand knot or by taping in gooseneck fashion.
9. Contractor shall generate only as much debris as they can bag and deposit into a waste bin at the end of an 8-hour shift.



10. After completion of all stripping work, surfaces from which asbestos-containing materials have been removed shall be wet-wiped or cleaned by some equivalent method to remove all visible residue.
11. Asbestos-contaminated waste that has been containerized shall be transported out of the work area through the worker decontamination enclosure or through an approved pass-out arrangement.
12. Should hydro-blasting be used to remove asbestos-containing materials, the waste water captured shall be filtered on-site during the monitoring of the consultant. The consultant reserves the right to review the procedures of this process and equipment – before, during and at the end of abatement ensuring it is done properly and safely.
13. The consultant also reserves the right to reject any means and methods of removal should they fail to meet the standards set for in federal, state, local laws and the requirements in this Scope of Work.

PROHIBITED WORK PRACTICES

1. Uncontrolled releases. This is cause for stopping the project until modified work practices and containment that prevent these releases from occurring are designed and implemented.
2. Dry removal or dry disturbance of any kind.
3. Mechanical tools without HEPA vacuum attachment and HEPA vacuum properly attached according to manufacturer recommendation.
4. No brooms are allowed inside containment.
5. Bead blasting.
6. No bulk loading.

COMPLETION OF ABATEMENT & CLEARANCE AIR SAMPLES

1. After final cleaning of any interior containment of a building intended to be reoccupied has been completed, a visual clearance inspection shall be performed by the consultant. Contractor personnel shall be present and available to address any deficiencies in cleaning. On the business day following visual clearance of the containment, a set of five clearance air samples shall be collected to be analyzed by Transmission Electron Microscopy (TEM) or Phase Contrast Microscopy (PCM).
2. Where TEM clearance criteria is used, final clearance for re-occupancy shall be contingent upon meeting AHERA criteria for response action completion of an average of 70 structures per square millimeter (70 s/mm²) or less for the 5 samples collected inside the containment (40 CFR 763, Appendix A). In the event clearance air samples do not meet this re-occupancy criteria, the contractor shall be responsible for re-cleaning failed areas, and for costs associated with collection and rush analysis of additional clearance air samples (\$2,450/per set of clearances) in accordance with the sampling protocol described above.
3. Where PCM clearance criteria is used, final clearance for re-occupancy shall be contingent upon meeting AHERA criteria for response action completion when the results of the samples collected show that the concentration of fibers for each of the five samples is less than or equal to a limit of quantitation for PCM (0.01 fibers per cubic centimeter (0.01 f/cm³) of air). In the event clearance air samples do not meet this re-occupancy criteria, the contractor shall be responsible for re-cleaning failed areas, and for costs associated with collection and rush analysis of additional clearance air samples (\$1,500/per set of clearances) in accordance with the sampling protocol described above.

PERSONAL AIR MONITORING RESULTS FOR WORKERS

The contractor shall promptly post and provide a copy of worker personal air monitoring results in within 5 calendar days of the them being collected on the worker. No more than two working days shall pass between results being received and posted on-site or provided to YES, Inc. as part of the close-out documentation for this project.



1201 24th Street, Suite B110-377, Bakersfield, CA 93301 / (661) 527-0820

DISPOSAL

Any baseboards, tackboards, carpet or 12" floor tile which is able to be removed from containment before any asbestos-containing materials are disturbed can be discarded as construction debris.

Any asbestos-containing materials removed by manual methods shall be considered non-friable, non-hazardous, asbestos-containing waste, manifested and disposed of accordingly.

Asbestos-containing materials removed by mechanical means shall be considered hazardous, asbestos-containing waste, manifested and disposed of accordingly.

Attachments:

- A. Campus Map
- B. Submittal Requirements
- C. SDS for ChemSafe Clear Mastic Solvent



1201 24th Street, Suite B110-377, Bakersfield, CA 93301 / (661) 527-0820

Attachment A - Campus Map

- ELECTRICAL SHUT OFF
MAIN CAMPUS - ELECTRICAL
ROOM AT MULTI-PURPOSE /
SOUTH RELOS - NORTH OF
ROOM 5 / HVAC - AT EAST
SIDE BY ROOM 12
- GAS SHUT OFF
NORTH OF KITCHEN
- WATER SHUT OFF
EAST SIDE BY ROOM 12
- TOOLS
IN CUSTODIAL ROOM
WEST OF ROOM 10
- FIRE ALARM PANEL - FRONT
OFFICE IN HALLWAY CLOSET

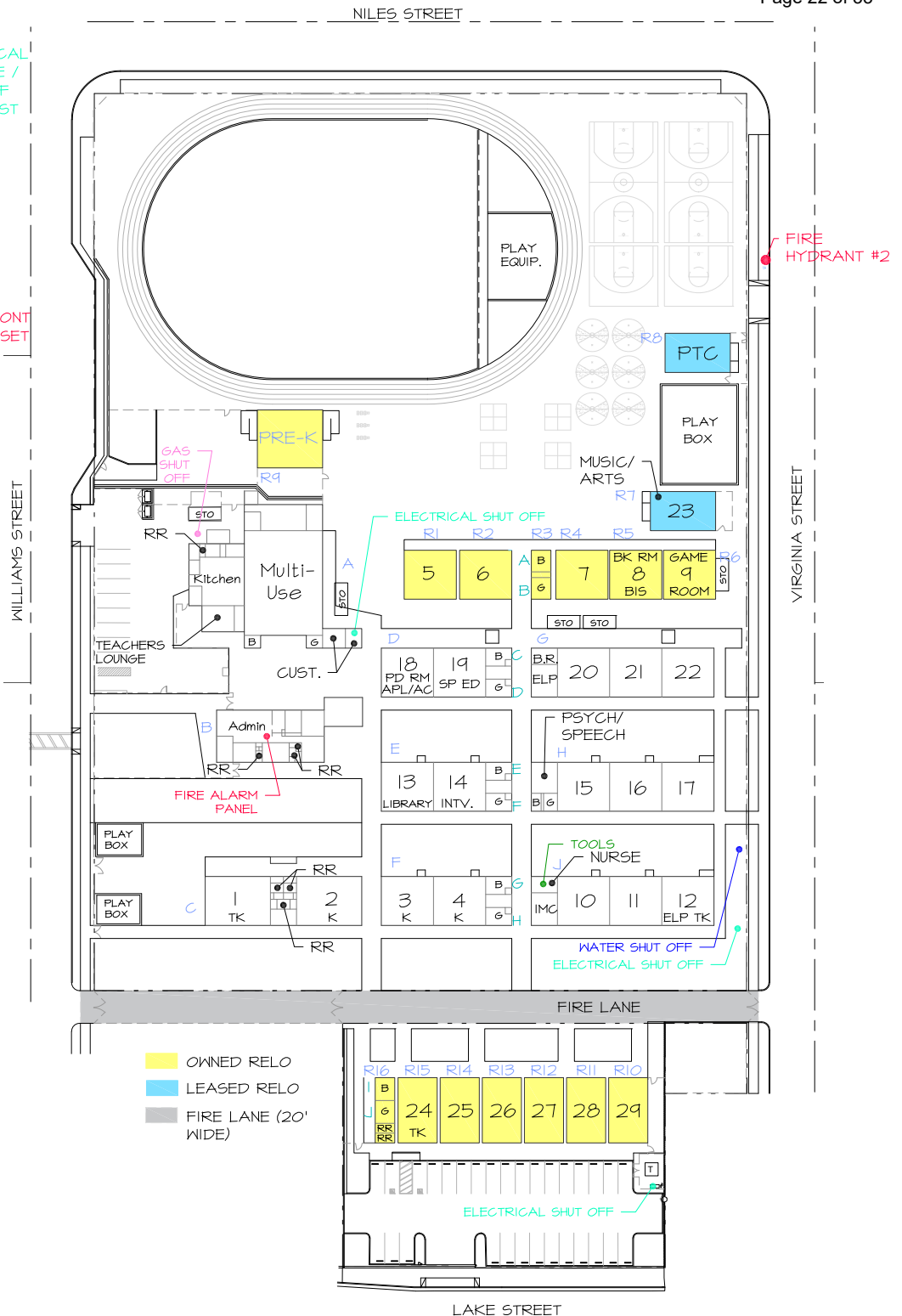

WILLIAMS ELEMENTARY
1201 WILLIAMS STREET
631-5840

AREA = 258,050 SQ. FT.
OR 5.92 ACRES

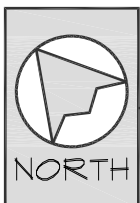

SITE PLAN

11-05-25

SCALE: 1"=100'



1201 24th Street, Suite B110-377, Bakersfield, CA 93301 / (661) 527-0820

Attachment B – Submittal Requirements



Asbestos Submittal Requirements

Note: not all of the items listed below are applicable for every project. Only the items applicable are required to be included in the submittal packet.

Prestart Submittals

1. Contractor's license(s)
 - a. CSLB license with asbestos certification
2. DOSH registration
3. Notifications
 - a. Appropriate local EPA enforcement agency for the job site location.
 - b. Cal/OSHA asbestos notification
 - c. Equipment rented
 - i. Proof the rental company has been made aware the rented equipment will be used for asbestos and/or lead related work.
4. Site specific safety/emergency plan
 - a. This must include, but is not limited to, the nearest hospital's phone number and address;
 - b. Local police department phone number and address;
 - c. Title, name and phone number of the contractor's contact whom should be contacted in the event of an emergency.
5. Contractor worker documentation for all workers on-site
 - a. Proof of AHERA training
 - b. Proof of Medical approval to wear a respirator
 - c. Respirator fit test
6. Contractor's respiratory protection program
7. Challenge testing certificates
8. Negative exposure assessment (if requesting to don lesser PPE than specified in the SOW)
9. Safety data sheets all hazardous materials (as defined by Cal/OSHA)
10. Waste Disposal
 - a. Paperwork for landfill proving the landfill will accept the waste
 - b. Proof of licensed waste hauler and company for hazardous waste
 - c. Waste characterization of lead waste
 - d. Manifest for all types of waste to be generated

Submittals Required During the Project

1. Daily copies
 - a. Safety meeting (if held daily)
 - b. Worker roster of all employees onsite – regardless of training
 - c. Entry/exit log for employees entering/exiting containment/regulated area
2. Weekly
 - a. Safety meeting
 - b. Worker personal air monitoring
 - c. Area air monitoring

Submittals Required at the Conclusion of the Project

1. Contractor air monitoring & laboratory results (refer to the SOW for required frequency)
2. Any other paperwork as requested by the Consultant or Building Owner



Attachment C - SDS for Chemsafe Clear

SAFETY DATA SHEET**TRADE NAME: CHEMSAFE CLEAR**

PAGE 1 OF 8

ISSUE DATE: 1/15/1990

REVISION DATE: 4/15/2015

1. PRODUCT AND COMPANY IDENTIFICATION**GHS PRODUCT IDENTIFIER:**

TRADE NAME; CHEMSAFE CLEAR (CARB COMPLIANT)

OTHER MEANS OF IDENTIFICATION:**RECOMMENDED USE OF THE CHEMICAL AND RESTRICTIONS ON USE:**

RECOMMENDED USE: Mastic Removal

SUPPLIER'S DETAILS:

1480 GRANDVIEW AVE.
THOROFARE, NJ 08086
(800)767-6933

EMERGENCY PHONE NUMBER:

COMPANY PHONE NUMBER: (800)767-6933

(24HR) EMERGENCY NUMBER: CHEM-TREC (800)424-9300

2. HAZARD IDENTIFICATION**GHS CLASSIFICATION:**

GHS CLASSIFICATION SCALE: 1=SEVERE HAZARD, 4=SLIGHT HAZARD)

ASPIRATION HAZARD
SERIOUS EYE DAMAGE IRRITATION

CATEGORY 1
CATEGORY 2A

LABEL ELEMENTS:**SIGNAL WORD: DANGER****HAZARD STATEMENTS:**

Causes serious eye irritation
May be fatal if swallowed and enters airways

SAFETY DATA SHEET**TRADE NAME: CHEMSAFE CLEAR**

PAGE 2 OF 8

HAZARD SYMBOLS:**PRECAUTIONARY STATEMENTS:**

Keep out of reach of children
 Wash hands, face and all exposed skin areas after handling.
 Wear protective gloves/protective clothing/eye protection/face protection

PRECAUTIONARY STATEMENTS (RESPONSE):

IF SWALLOWED: Immediately call a poison center or doctor or physician. Do not induce vomiting.

IF IN EYES: Rinse cautiously with water for several minutes. Remove contact lenses if easy to do. Continue rinsing. If eye irritation persists, get medical advice/attention.

PRECAUTIONARY STATEMENTS (STORAGE):

Store locked up.

PRECAUTIONARY STATEMENTS (DISPOSAL):

Dispose of contents/container to an approved waste disposal plant in accordance with applicable local/regional/national and international regulations and product characteristics at time of disposal.

OTHER HAZARDS:

Repeated or prolonged exposure can cause skin dryness or cracking.

3. COMPOSITION INFORMATION ON INGREDIENTS

INGREDIENT IDENTITY	CAS NUMBER	PERCENTAGE
DISTILLATES, PETROLEUM HYDROTREATED, LIGHT	64742-47-8	PROPRIETARY
BUTOXYDIGLYCOL	112-34-5	PROPRIETARY

REMAINING INGREDIENTS ARE NOT REPORTABLE UNDER OSHA/SDS GUIDELINES. THE EXACT PERCENTAGES OF SOME INGREDIENTS HAVE BEEN WITHHELD AS (CBI) CONFIDENTIAL BUSINESS INFORMATION TRADE SECRET.

4. FIRST AID MEASURES

INGESTION: If swallowed, wash out mouth with water. Do not induce vomiting, this product is an aspiration hazard. If spontaneous vomiting occurs, keep head below hips to prevent aspiration of liquid into the lung. Never give anything by mouth to an unconscious person.

SKIN CONTACT: Remove contaminated clothing. Wash with soap and plenty of water for 15 minutes. Wash contaminated clothing before reuse. If irritation occurs get medical advice.

INHALATION: Move individual away from exposure and into fresh air. If breathing is irregular or stopped, administer artificial respiration. In case of shortness of breath, give oxygen. Call a physician immediately.

EYE CONTACT: Rinse cautiously with water for several minutes. Remove contact lenses if easy to do. Continue rinsing. If eye irritation persists, get medical attention/advice.

Most Important Symptoms and Effects, Acute and Delayed

INGESTION: Symptoms may include diarrhea, gastric pain, and vomiting.

SKIN CONTACT: Symptoms may include redness, dryness and cracking of skin.

INHALATION: Not expected; however, symptoms may include irritation of respiratory tract and/or CNS symptoms such as dizziness, confusion, drowsiness or fatigue.

EYE CONTACT: Symptoms may include stinging, tearing, redness and blurred vision.

Indication of immediate medical attention and special treatment needed, if necessary.

Treat Symptomatically.

5. FIRE FIGHTING MEASURES

Suitable extinguishing media: Use fire extinguishers suitable for surrounding fire, possibly consisting of water spray, dry chemical, carbon dioxide, or foam.

Unsuitable extinguishing media- Do not use water jet.

Specific hazards arising from the chemical: In a fire or if heated, a pressure increase will occur and the container may burst. Material will burn in a fire. Flash point is over 200F. Material will emulsify and not directly float with water spray and emulsion could aid in not exacerbating fire.

Hazardous thermal decomposition products: carbon monoxide and CO₂

Special protective actions for fire-fighters: Keep product containers and surrounding areas cool with water spray. No action shall be taken involving any personal risk or without suitable training.

Special protective equipment for fire-fighters: Fire fighters should wear appropriate protective equipment and self-contained breathing apparatus (SCBA) with a full face-piece operated in positive pressure mode.

6. ACCIDENTAL RELEASE MEASURES

Personal precautions, protective equipment and emergency procedures:

For non-emergency personnel: No action shall be taken involving any personal risk or without suitable training. Evacuate surrounding areas. Keep unnecessary and unprotected personnel from entering. Do not touch or walk through spilled material. Provide adequate ventilation. Avoid breathing vapor or mists. Put on appropriate personal protective equipment. Wear appropriate respirator when ventilation is inadequate.

For emergency responders: If specialized clothing is required to deal with the spillage, take note of information in section 8 for further information. See also information in non-emergency personnel above.

Environmental precautions: Avoid dispersal of spilled material with soil, waterways, drains and sewers. See section 12 for additional ecological information.

Methods and materials for containment and cleaning up.

Small spill: Stop leak if without risk. Move containers from the spill area. Absorb with an inert dry non combustible material such as diatomaceous earth or vermiculite and place in an appropriate waste disposal container. Mop any remaining residues with soap and water and dispose of wastes via a licensed waste disposal contractor according to federal, state and local regulations.

Large spill: Stop leak if without risk. Move containers from spill area. Prevent entry into sewers, drains, water courses and confined areas. Wash spillages into an effluent treatment plant or absorb with an inert dry non combustible material such as diatomaceous earth or vermiculite and place in a appropriate waste disposal containers. Mop any remaining residues with soap and water and dispose of wastes via a licensed waste disposal contractor according to federal, state and local regulations.

7. HANDLING AND STORAGE

Precautions for Safe Handling:

Safe Handling Advice: Utilize appropriate personal protective equipment when handling product. Do not swallow. Avoid contact with eyes, skin and clothing. Avoid breathing vapor or mists. Use only with adequate ventilation. Wear appropriate respirator when ventilation is inadequate. Do not enter storage areas and confined spaces unless adequately ventilated. Keep in the original container and tightly closed when not in use. Store and use away from heat, sparks, open flame or any other ignition source. No smoking. Wash face, hands and any exposed skin thoroughly after handling. Wear protective gloves/protective clothing/eye protection and face protection during use. Emptied containers can contain product residues and remain hazardous. Do not reuse, flame cut, braze or weld container and observe all sds information around empty containers and dispose of in accordance with federal, state and local regulations.

Advice on general occupational hygiene: Eating, drinking and smoking should be prohibited in areas where this material is handled, stored and processed. Workers should wash hands and face before eating, drinking and smoking. Remove contaminated clothing and protective equipment before entering eating areas. See also section 8 for additional hygiene information.

Conditions for safe storage including any incompatibilities:

Store in original container in a dry, cool and well ventilated area away from strong oxidizing agents (see section 10) and food and drink. Store locked up. Eliminate all ignition sources. Keep container tightly closed when not in use. Do not store in unlabeled containers.

8. EXPOSURE CONTROLS/ PERSONAL PROTECTION

Control Parameters	Occupational Exposure Limits			
	Ingredient Identity	ACGIH TLV	OSHA PEL	NIOSH IDLH
Butoxydiglycol	112-34-5	TWA 10ppm		

Distillates, Petroleum TWA:skin absorption 200mg/m³ (as total hydrocarbon vapor) 8 hours
Hydrotreated, Light 64742-47-8

Appropriate Engineering Controls

Engineering Controls: Use only with adequate ventilation. Use process enclosures, local exhaust ventilation or other engineering controls to keep worker exposure to airborne contaminants and air concentrations below occupational exposure standards.

Individual protection measures, such as personal protective equipment. (PPE)

Eye/Face Protection: Wear approved tightly sealed safety goggles

Skin & Body Protection: Wear chemical resistant, impervious gloves at all times when handling chemical products. Check during use that gloves are still retaining their impervious properties, as the time for breakthrough can change from different manufacturers and chemical mixtures cannot always be accurately measured. Appropriate footwear and suitable protective clothing should be worn for the degree and risk of exposure.

Respiratory Protection: If workplace exposure limits of product or any component is exceeded, utilize proper respiratory protection program guidelines (see OSHA 1910.134 and American National Standard ANSI Z88.2) Use a properly fitted NIOSH/MSHA air-purifying or air-fed respirator in compliance with the above mentioned standard if a risk assessment indicates this is necessary. Respirator selection must be based on known or anticipated exposure levels, the hazards of the product and the safe working limits of the selected respirator.

9. PHYSICAL AND CHEMICAL PROPERTIES

Appearance: clear liquid
 Odor: near odorless
 Odor threshold: not available
 pH: not applicable
 Melting Point/Freezing Point: -56F
 Initial Boiling Point/Range: 344F-473F
 Flash Pt: >200F lowest ingredient, does not sustain combustion
 Evaporation Rate: <1 (butyl acetate=1)
 Lower explosive limits: .6% Aliphatic Solvent
 Upper explosive limits: 5.5% Aliphatic Solvent
 Vapor Pressure: meets CARB guidelines
 Vapor Density: 4.5-5 (air=1)
 Relative Density: .84
 Solubility in water: Emulsifies
 Partition coefficient: not applicable
 Auto ignition temp: >428F
 Decomposition Temp: not available
 Viscosity: pourable liquid

10. STABILITY AND REACTIVITY

Reactivity: Stable in normal ambient temperature and pressure

Chemical Stability: Stable under recommended storage conditions.

Possibility of Hazardous Reactions: not under normal conditions of storage and use.

Conditions to Avoid: Open flames, sparks

Incompatible Materials: Oxidizing materials

Hazardous Decomposition Products: Carbon monoxide and Carbon Dioxide

11. TOXICOLOGICAL INFORMATION

Acute toxicity: Not classified,

Skin corrosion irritation: not classified,

Serious Eye damage: classified, Category 2, Causes serious eye irritation, Butoxydiglycol 112-34-5

Sensitization: Not classified,

Mutagenicity: Not classified,

Carcinogenicity: Not classified

Reproductive Toxicity: Not Classified

Teratogenicity: Not Available

Specific target Organ Toxicity (single exposure)

Not classified

Specific target Organ Toxicity (repeated exposure):

Not classified

Aspiration Hazard:

Distillate petroleum hydrotreated, light 64742-47-8 , Aspiration Hazard Category 1

SAFETY DATA SHEET**TRADE NAME: CHEMSAFE CLEAR**

PAGE 7 OF 8

Information on the likely routes of exposure:**Ingestion:** May be harmful if swallowed. May be fatal if swallowed and enters airways.**Inhalation:** Do not breathe vapors or mists.**Skin:** May be harmful in contact with skin.**Eye:** Causes serious eye irritation**Symptoms related to the physical, chemical and toxicological characteristics****Ingestion:** See section iv, most important symptoms and effects, acute and delayed.**Inhalation:** See section iv, most important symptoms and effects, acute and delayed.**Skin:** See section iv, most important symptoms and effects, acute and delayed.**Eye:** See section iv, most important symptoms and effects, acute and delayed.**Delayed and immediate effects and also chronic effects from short and long term exposure.**

General: Prolonged or repeated contact can defat the skin and lead to irritation, cracking and/or dermatitis

Carcinogenicity: no known significant effects or critical hazards. Not classifiable.

Numerical measures of Toxicity

Not Available

12. ECOLOGICAL INFORMATION**Toxicity:**

<u>Ingredient name</u>	<u>Result</u>	<u>Species</u>	<u>Exposure</u>
Distillate Petroleum, Hydrotreated, light	Chronic NOEL 0.48 mg/l	Daphnia	21 days

Persistence and degradability:Distillate Petroleum: Biodegradability-inherent
Hydrotreated

Butoxydiglycol 112-34-5: readily biodegradable

Bioaccumulation Potential:

Not expected to bioaccumulate

Mobility in Soil:

No data

Other adverse Effects:

No known significant effects or critical hazards

13. DISPOSAL CONSIDERATIONS

Dispose in accordance with applicable federal, state and local regulations.

SAFETY DATA SHEET**TRADE NAME: CHEMSAFE CLEAR**

PAGE 8 OF 8

14. TRANSPORTATION INFORMATION

DOT: NOT REGULATED
IATA: NOT REGULATED
IMDG: NOT REGULATED

15. REGULATORY INFORMATION

U.S. FEDERAL REGULATIONS: All ingredients are listed or exempted with TSCA.

SARA 302/304: no products were found.

SARA 311/312: acute health hazard

Ingredient	%	FIRE HAZARD	PRESSURE RELEASE	REACTIVE	IMMEDIATE ACUTE	DELAYED CHRONIC
Distillate Petroleum, Hydrotreated	80-95	YES	NO	NO	NO	NO
Butoxydiglycol 112-34-5	PROPRIETARY				YES	YES

SARA 313: butoxydiglycol, <12%

STATE REGULATIONS:

Ingredient	New York	New Jersey	Massachusetts	Pennsylvania
Distillate Petroleum Hydrotreated. 64742-47-8	No	No	No	No
Butoxydiglycol 112-34-5	No	Yes	Yes	yes

California Prop 65: none known

16. OTHER INFORMATION

HMIS RATING: HEALTH (1) FIRE (1) REACTIVITY (0)
 4=EXTREME, 3=HIGH, 2=MODERATE, 1=SLIGHT, 0=INSIGNIFICANT

NOTICE TO READER:

To the best of our knowledge, the information contained herein is accurate. However, neither the above-named supplier, nor any of its subsidiaries assumes any liability whatsoever for the accuracy or completeness of the information contained herein. The information on this sds was obtained from sources which we believe are reliable. However, the information is provided without any warranty, expressed or implied, regarding its correctness. Users are advised to confirm in advance of need, that information is current, applicable and suited to the circumstances of use. Vendor assumes no responsibility for injury to vendee or third persons proximately caused by the material if reasonable safety procedures are not adhered to as stipulated in the sds. Furthermore, vendor assumes no responsibility for injury caused by abnormal use of this material even if reasonable safety procedures are followed.