

ORDIZ MELBY
ARCHITECTS, INC.

5500 MING AVENUE SUITE 280
BAKERSFIELD, CALIFORNIA 93309
TELEPHONE (861) 832-5258
FACSIMILE (861) 832-4291



William J. Melby
DANNY E. ORDIZ, AIA
ARCHITECT C-14728
WILLIAM J. MELBY, AIA
ARCHITECT C-16836

IDENTIFICATION STAMP
DIVISION OF STATE ARCHITECT
OFFICE OF REGULATION SERVICES

APPL. # APP
FILE # #FILE
AC: FLS SS CAL
DATE SEP 25 2017
APN # #APN

MODERNIZATION AT MARSA
VOORHIES ELEMENTARY
SCHOOL
6001 PIONEER DRIVE
BAKERSFIELD, CA 93307
FOR:

BAKERSFIELD CITY
SCHOOL DISTRICT
1300 BAKER STREET
BAKERSFIELD CA 93305

PTN: 63321-186
KEY PLAN

MARK	DATE	DESCRIPTION
	12-09-15	DSA SUBMITTAL
△		
△		
△		

JOB NUMBER:
2015-1663
C/D DRAWING FILE

1663 VOORHIES MOD-Site Plan - CD18.pln

DRAWN BY:
CHECKED BY:

CHECK AND VERIFY ALL DIMENSIONS BEFORE
PROCEEDING WITH THE WORK.
REPORT DISCREPANCIES TO THE ARCHITECT.
THE DRAWINGS, IDEAS, AND DESIGNS
REPRESENTED ON THIS SHEET ARE THE
PROPERTY OF THE ARCHITECT.

COPYRIGHT
ORDIZ MELBY ARCHITECTS, INC. 2014

SHEET TITLE

FIRE WATER PLAN

SHEET IDENTIFICATION NUMBER

C-9

SHEET 9 OF 9

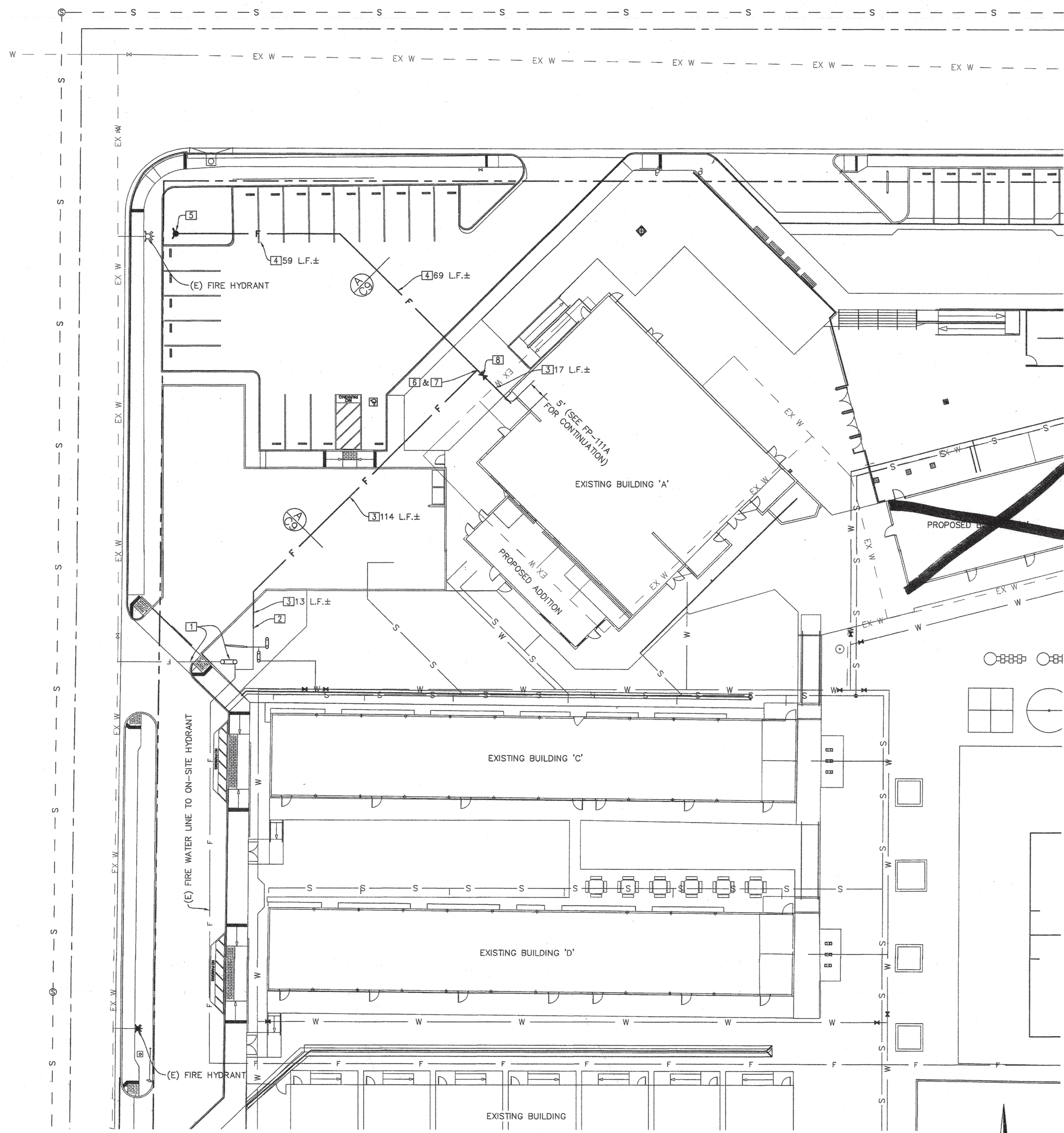

FIRE WATER CONSTRUCTION NOTES

- EXISTING 8" FIRE SERVICE AND DOUBLE DETECTOR CHECK BACKFLOW PREVENTER.
- TIE INTO EXISTING 8" FIRE WATER LINE.
- INSTALL 8" PVC (9000) FIRE WATER LINE TO 5' FROM BUILDING WITH THRUST BLOCKS PER DETAIL B ON THIS SHEET (DISTANCES SHOWN).
- INSTALL 4" PVC (9000) FIRE WATER LINE WITH THRUST BLOCKS PER DETAILS ON THIS SHEET (DISTANCES SHOWN).
- INSTALL FIRE DEPARTMENT CONNECTION PER COUNTY OF KERN FIRE DEPARTMENT STANDARDS. *SEE DETAIL D ON THIS SHEET.*
- INSTALL 8" TEE.
- INSTALL 4"x8" REDUCER.
- INSTALL MUELLER A-20806 ADJUSTABLE VERTICAL INDICATOR POST PER MANUFACTURER'S SPECIFICATIONS WITH THRUST BLOCKS PER DETAIL B ON THIS SHEET. *SEE DETAIL C ON THIS SHEET.*

- NOTES:**
- CONTRACTOR SHALL INSTALL ALL ELBOWS, TEES & APPURTENANCES AS NECESSARY TO FURNISH A COMPLETE PROJECT.
 - EXISTING UNDERGROUND UTILITIES HAVE BEEN SHOWN BASED ON AVAILABLE RECORDS PROVIDED BY THE OWNER. CONTRACTOR SHALL VERIFY LOCATION AND DEPTH OF UTILITIES PRIOR TO CONSTRUCTION AND NOTIFY ENGINEER OF ANY DISCREPANCIES.

LEGEND

- STREET CENTERLINE
- STREET RIGHT-OF-WAY
- OHE --- EXISTING OVERHEAD ELECTRIC
- S --- EXISTING SEWER LINE
- EX W --- EXISTING WATER LINE
- GAS --- EXISTING GAS LINE
- --- PROPOSED STORM DRAIN
- S --- PROPOSED SEWER
- W --- PROPOSED WATER
- F --- PROPOSED FIRE WATER

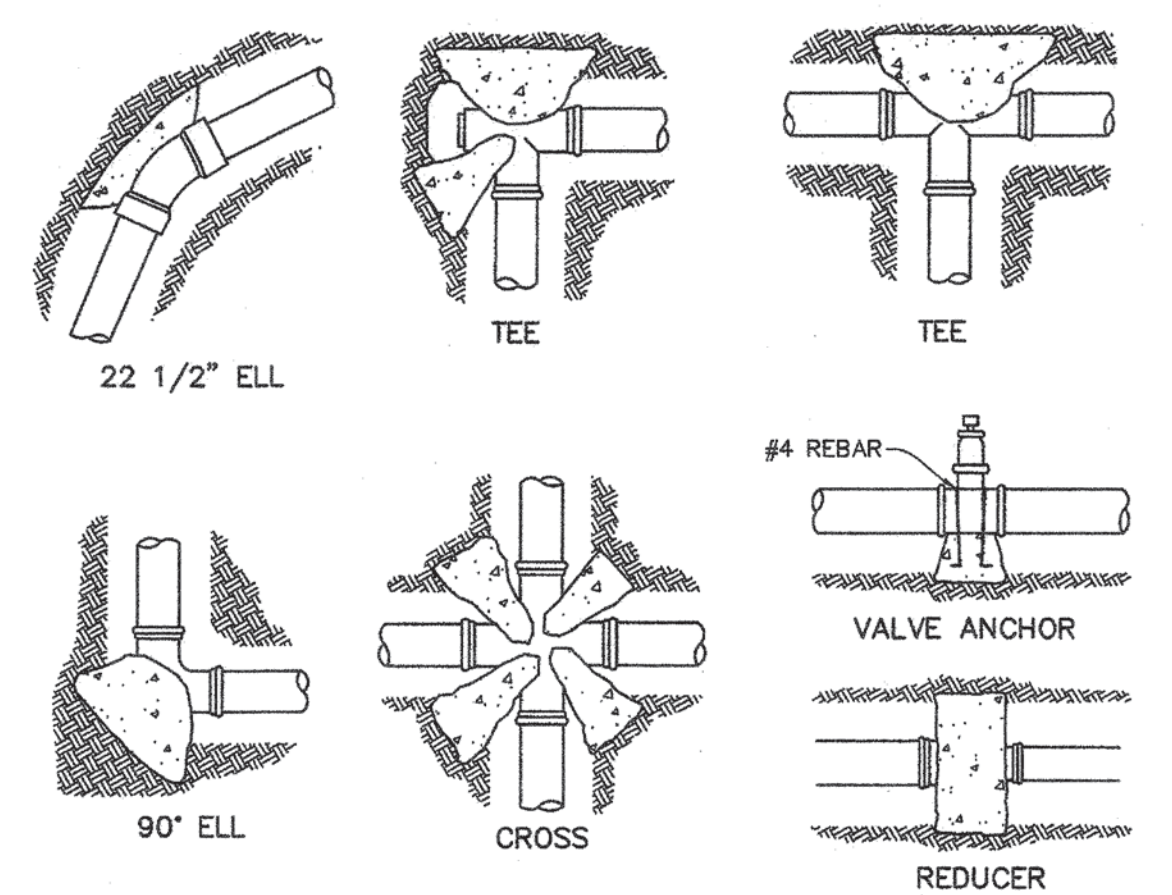

THRUST BLOCK SCHEDULE					
BEARING AREA IN SQUARE FEET					
PIPE SIZE	TEE OR PLUG	90° ELL	45° ELL	22 1/2" ELL	CROSS VALVE
4"	2	2	2	1	-
6"	3	4	2	2	1.5 EA. 3.0
8"	5	7	4	2	3.0 EA. 5.5
10"	8	11	6	3	4.5 EA. 9.0
12"	11	16	8	4	6.5 EA. 13.0
16"	16	23	13	7	9.0 EA. 18.0

- NOTES:**
- ALL VALVES, FITTINGS AND DIRECTIONAL CHANGES ARE TO BE HELD IN PLACE BY CONCRETE THRUST BLOCKS.
 - BEARING AREAS INDICATED ARE BASED ON ALLOWABLE SOIL PRESSURE OF 1500 PSF. **WATER PRESSURE 73 PSI**
 - CONCRETE IS NOT TO BEAR AGAINST PIPE. THRUST BLOCK TO ONLY BE IN CONTACT WITH FITTING.
 - THRUST BLOCKS SHALL BE POURED AGAINST UNDISTURBED SOIL.
 - JOINT SHALL BE KEPT CLEAR OF CONCRETE.
 - CONCRETE SHALL HAVE A MINIMUM COMPRESSIVE STRENGTH OF 2500 PSI AT 28 DAYS. CONCRETE MIX SHALL NOT BE LEANER ONE PART CEMENT, TWO & ONE-HALF PART SAND, AND FIVE PARTS STONE PER NFPA 13 10.8.2.2.

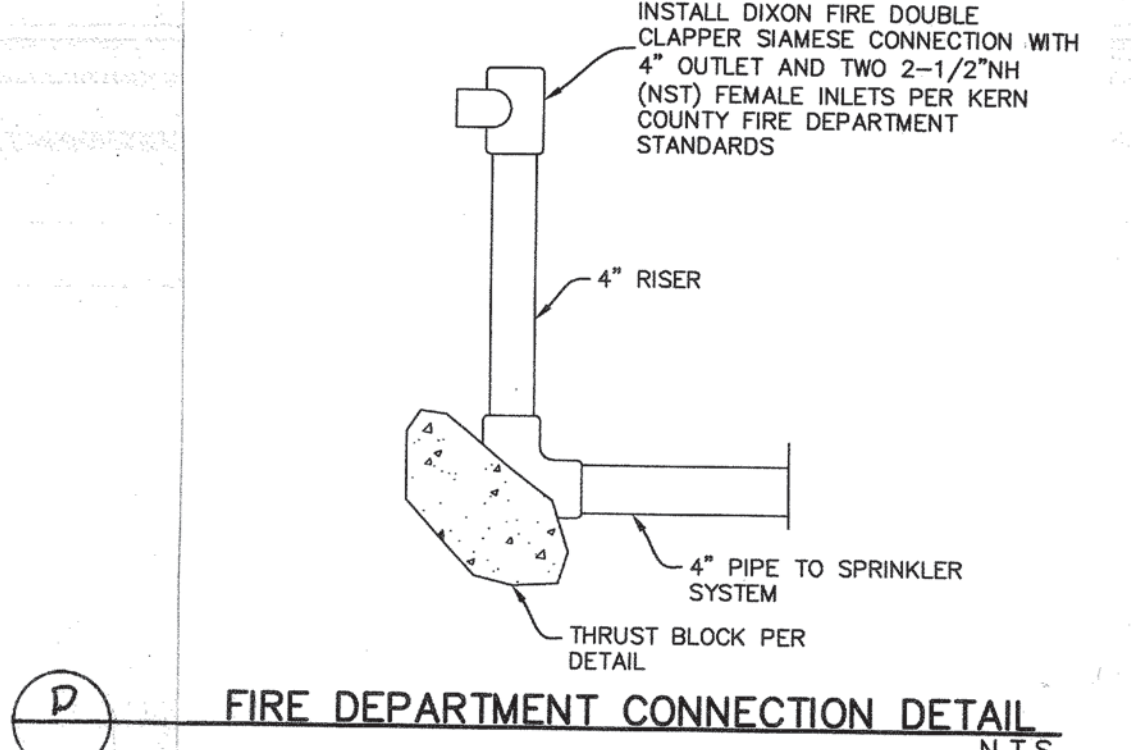

FIRE DEPARTMENT CONNECTION DETAIL
N.T.S.

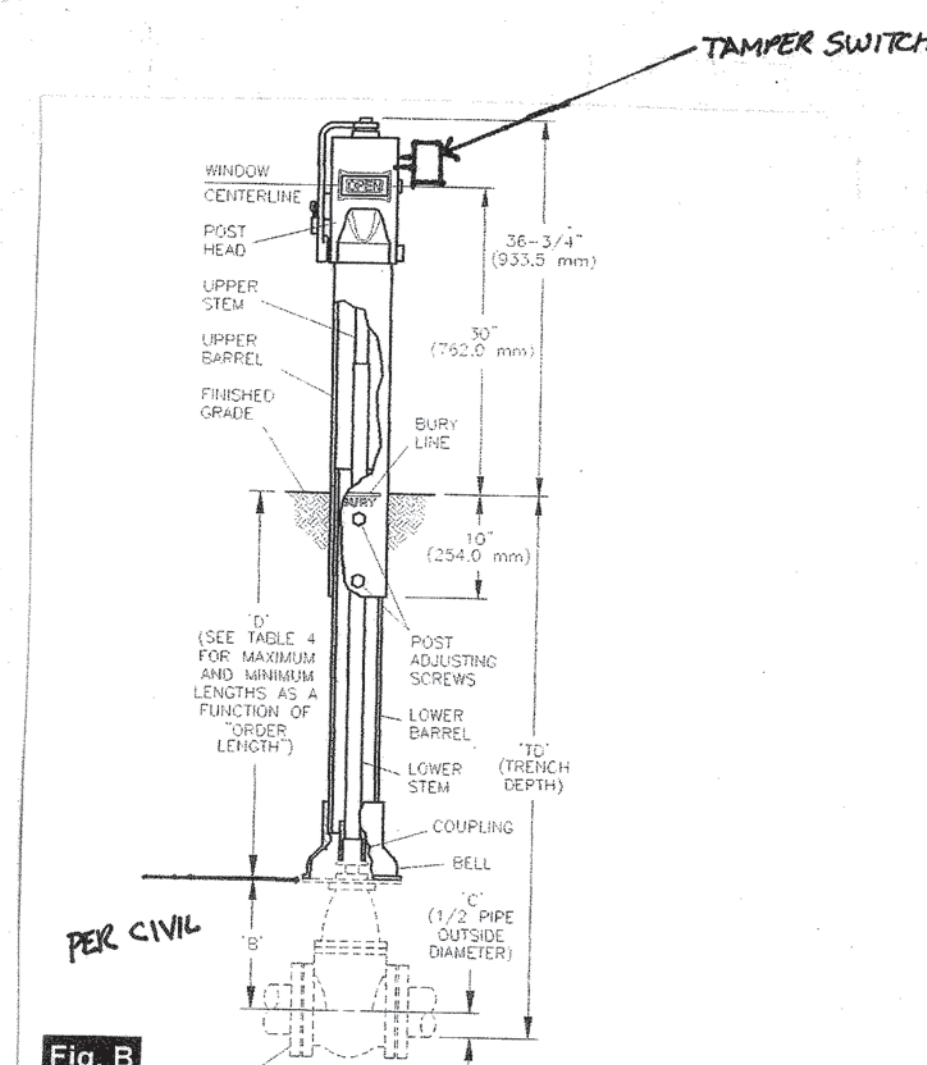

POST INDICATOR VALVE
N.T.S.

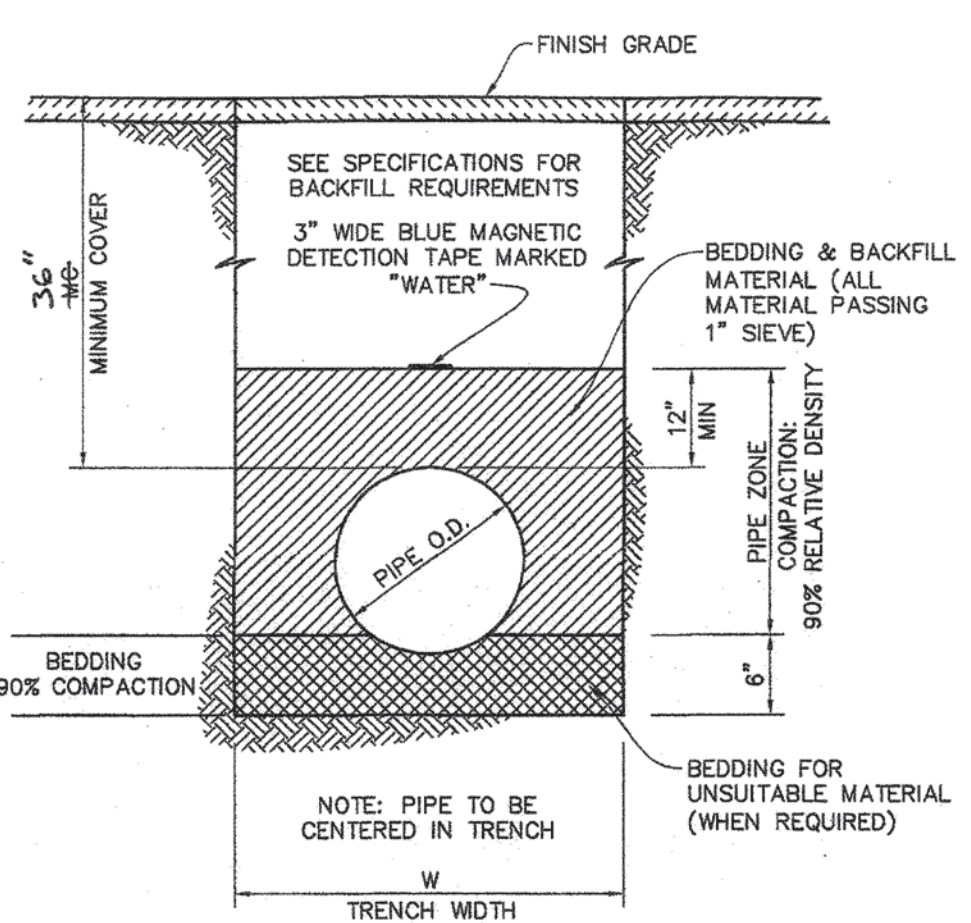

TRENCH DIMENSIONS		
PIPE SIZE	W	MC
4"	22"	30"
6"	24"	30"
8"	30"	30"
10", 12"	36"	36"

TYPICAL PVC PIPE TRENCH SECTION
N.T.S.

TYPICAL THRUST BLOCK DETAILS
N.T.S.

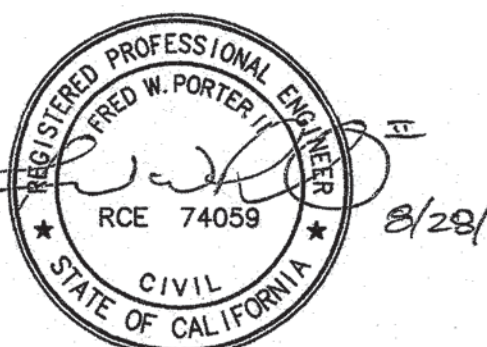
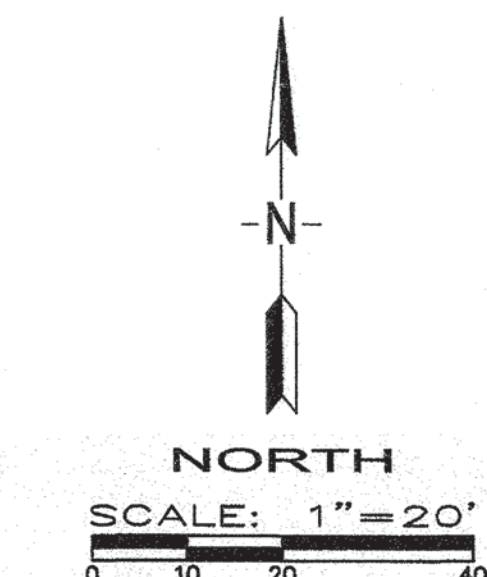

PORTER & ASSOCIATES, INC.
ENGINEERING & SURVEYING
1200 21st Street, Bakersfield, California 93301
861.327.0362 FAX 861.327.1065

P:\DRAWING\2015\1663\1663-CD18.pln
 1663 VOORHIES MOD-Site Plan - CD18.pln
 8/29/17
 RCE 74059
 CIVIL
 STATE OF CALIFORNIA