

SECTION	WIDTH	TRANSVERSE SPACING
1.0	4.0	4.0
2.0	4.0	4.0
3.0	4.0	4.0
4.0	4.0	4.0
5.0	4.0	4.0

PAD	SIZE	QUANTITY
A	14'-0" x 10'-0"	3
B	4'-0" x 4'-0"	6
C	4'-0" x 4'-0"	6
D	4'-0" x 4'-0"	6
E	4'-0" x 4'-0"	6
F	4'-0" x 4'-0"	6
G	4'-0" x 4'-0"	6
H	4'-0" x 4'-0"	6
I	4'-0" x 4'-0"	6
J	4'-0" x 4'-0"	6
K	4'-0" x 4'-0"	6
L	4'-0" x 4'-0"	6
M	4'-0" x 4'-0"	6
N	4'-0" x 4'-0"	6
O	4'-0" x 4'-0"	6
P	4'-0" x 4'-0"	6
Q	4'-0" x 4'-0"	6
R	4'-0" x 4'-0"	6
S	4'-0" x 4'-0"	6
T	4'-0" x 4'-0"	6
U	4'-0" x 4'-0"	6
V	4'-0" x 4'-0"	6
W	4'-0" x 4'-0"	6
X	4'-0" x 4'-0"	6
Y	4'-0" x 4'-0"	6
Z	4'-0" x 4'-0"	6

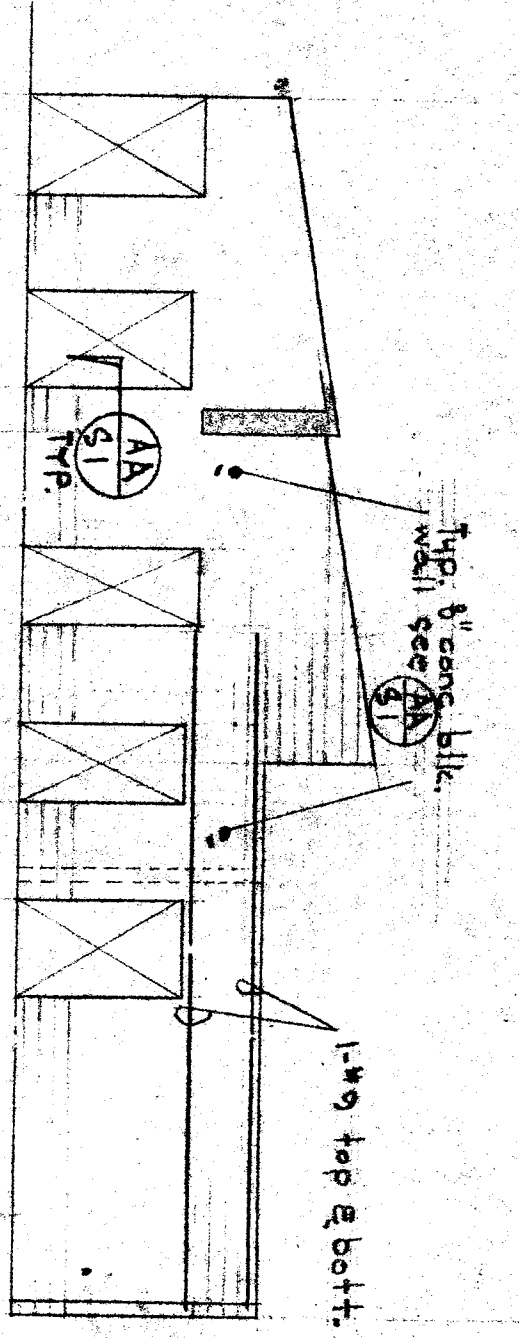

ELEVATION A

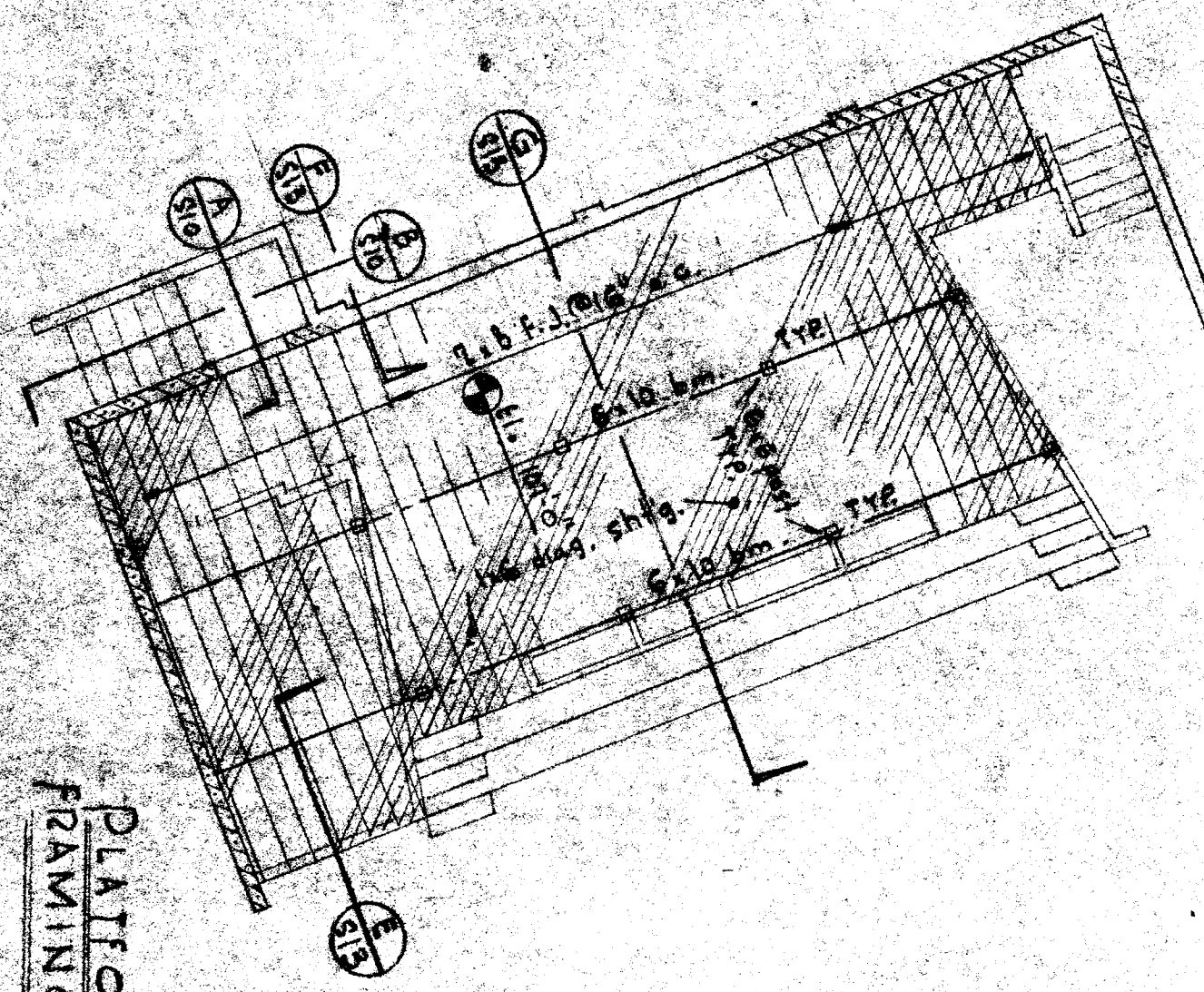
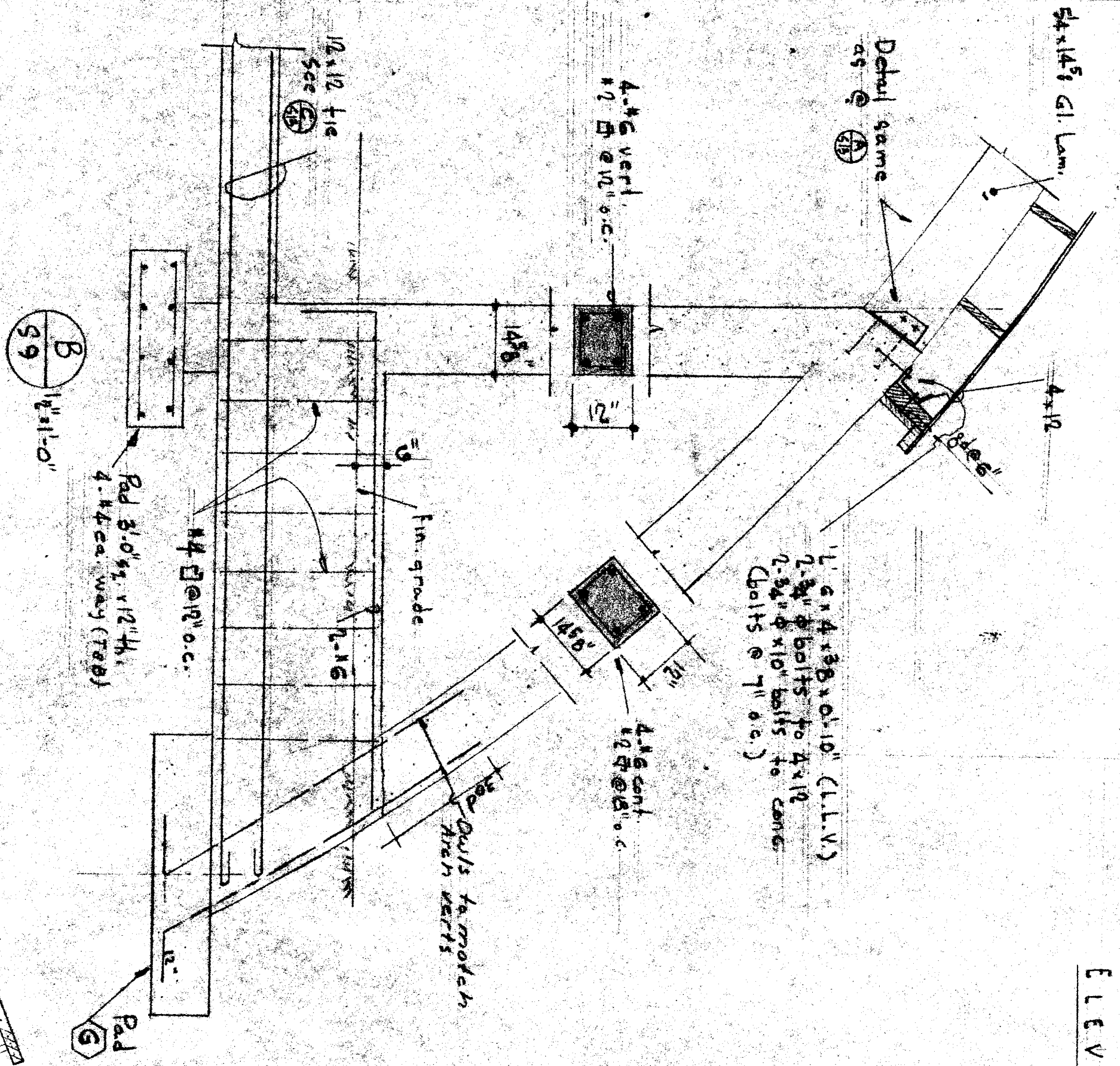

PLATFORM FRAMING PLAN

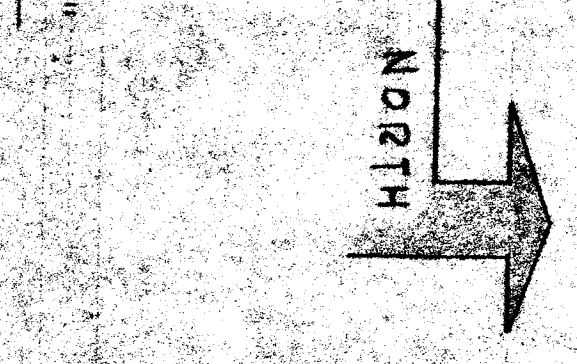

FOUNDATION PLAN

Notes:
 1. Check with local building department for all requirements.
 2. All dimensions are in feet and inches.
 3. All steel reinforcement is to be furnished with 60,000 psi yield strength.
 4. All steel reinforcement is to be furnished with 100% lap splicing.
 5. All steel reinforcement is to be furnished with 100% lap splicing.
 6. All steel reinforcement is to be furnished with 100% lap splicing.
 7. All steel reinforcement is to be furnished with 100% lap splicing.
 8. All steel reinforcement is to be furnished with 100% lap splicing.
 9. All steel reinforcement is to be furnished with 100% lap splicing.
 10. All steel reinforcement is to be furnished with 100% lap splicing.

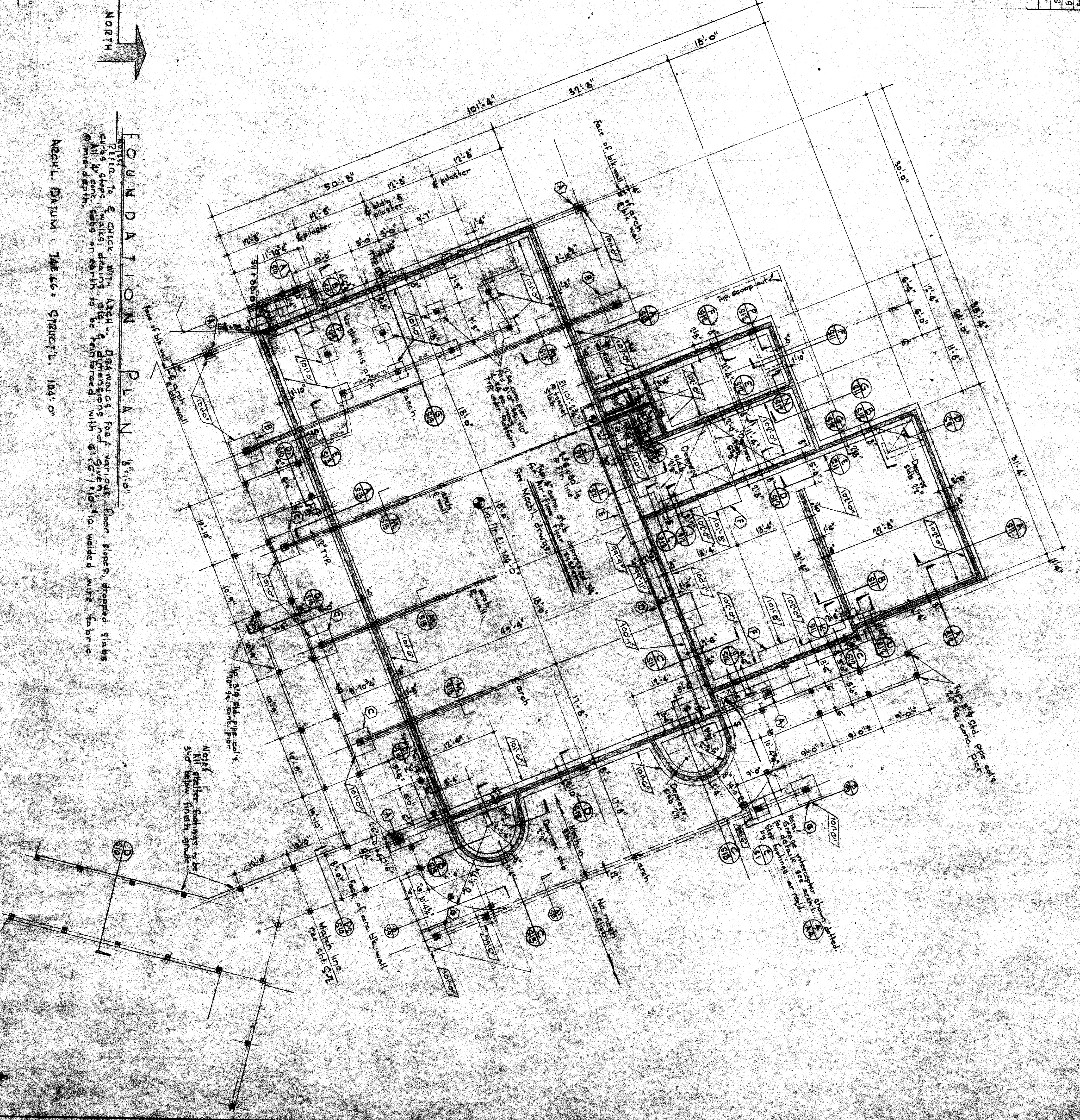

OFFICE OF SUPERINTENDENT OF SCHOOLS
 APPROVED

STATE OF CALIFORNIA
 DEPARTMENT OF PUBLIC WORKS
 DIVISION OF ARCHITECTURE

DATE: 2021

San Diego City School District
 San Diego, California
 Board of Education

PROJECT: SECTION 15 SCHOOL

ARCHITECT: HILLMAN & NOWELL
 STRUCTURAL ENGINEERS

DATE: 2021

SECTION 15 SCHOOL

WINDUPT 9-1 RUCEDDI ME
 CALIFORNIA