

KEYNOTES

- NOTE: KEYNOTES IN THIS LIST MAY NOT NECESSARILY OCCUR ON THIS SHEET.
- 201 PROVIDE PLUMBING FIXTURE. REFER TO PLUMBING DRAWINGS.
 - 202 (E) FENCE TO REMAIN.
 - 203 LINE 0" (E) ROOF ASBCE.
 - 204 ELIMINATE PORTION OF (E) CASEWORK. REFER TO INTERIOR ELEVATIONS.
 - 205 PROVIDE CASEWORK SHOWN HATCHED. REFER TO INTERIOR ELEVATIONS.
 - 206 REMOVE COUNTERTOPS SHOWN HATCHED. REFER TO INTERIOR ELEVATIONS.
 - 207 PROVIDE COUNTERTOPS SHOWN HATCHED.
 - 208 REMOVE WHEELCHAIR LIFT.
 - 209 REFERENCE HANGERS REFER TO DETAIL 13/A10.01.
 - 210 (E) CONCRETE PUMP TO REMAIN.
 - 211 REPAIR ALL (E) WINDOWS.
 - 212 REMOVE AND REPLACE EXISTING WITH OBSCURE GLAZING NOT USED.
 - 213 (E) FIRE EXTINGUISHER/CABINET TO REMAIN.
 - 214 (E) OBSERVATION WINDOW AND INFILL THE OPENING.
 - 215 REMOVE (E) OBSERVATION WINDOW AND INFILL THE OPENING. PATCH AND REPAIR TO MATCH THE ADJACENT WALL.
 - 216 REMOVE (E) OBSERVATION WINDOW AND INFILL THE OPENING. PATCH AND REPAIR TO MATCH THE ADJACENT WALL.
 - 217 PROVIDE 2" CONTRASTING COLORSTRIP AT TOP AND BOTTOM TREADS.
 - 218 REMOVE 2" OF (E) CABINET. PROVIDE CLOSURE PANEL W/ FINISH TO MATCH (E) ADJACENT CABINET.
 - 220 REMOVE 2" OF (E) CABINET. PROVIDE CLOSURE PANEL W/ FINISH TO MATCH (E) ADJACENT CABINET.
 - 221 DOOR SCHEDULE.

CEILING LEGEND

NOTE: ALL ITEMS INDICATED ON THIS LIST MAY NOT NECESSARILY OCCUR ON THIS SHEET.

RM #	ROOM NAME	CEILING HEIGHT	CEILING HEIGHT
X-2	(E) CEILING FINISH TO REMAIN (GYP/SUB BOARD JOINTS, PATCH AND PAINT TYP. FIN.)	CEILING HEIGHT	CEILING / SOFT
X-2	"HEAVY DUTY" 2X4 SUSPENDED ACoustICAL CEILING SYSTEM	CEILING HEIGHT	ADHERED ACoustICAL CEILING TILE
<input type="checkbox"/>	RECESSED LIGHT FIXTURE SEE ELECTRICAL DRAWINGS FOR ADDITIONAL INFORMATION		
<input type="checkbox"/>	SURFACE MOUNTED LIGHT FIXTURE SEE ELECTRICAL DRAWINGS FOR ADDITIONAL INFORMATION		
<input checked="" type="checkbox"/>	AIR TERMINAL. SEE MECHANICAL DRAWINGS FOR ADDITIONAL INFORMATION		

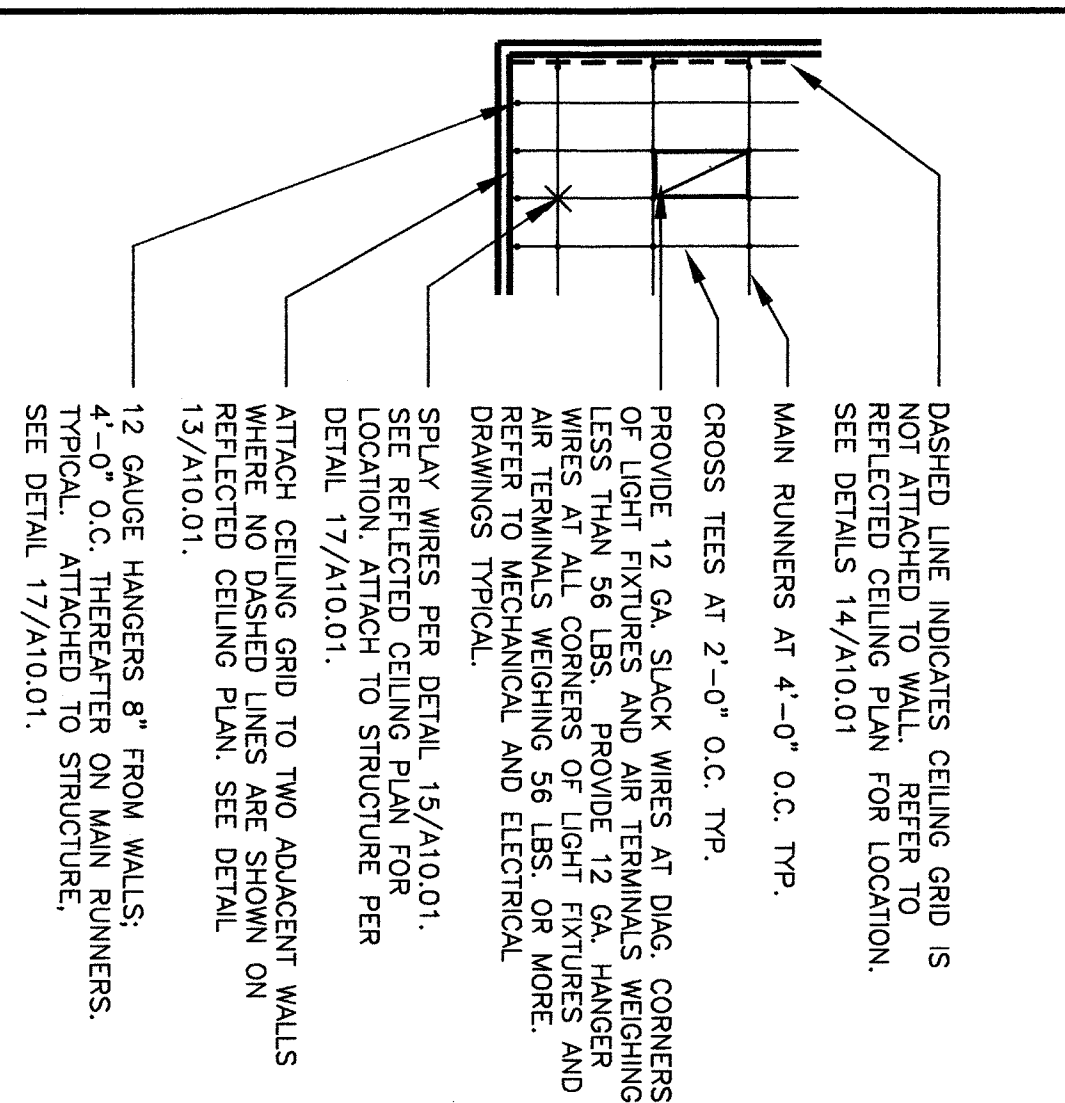

KEY PLAN

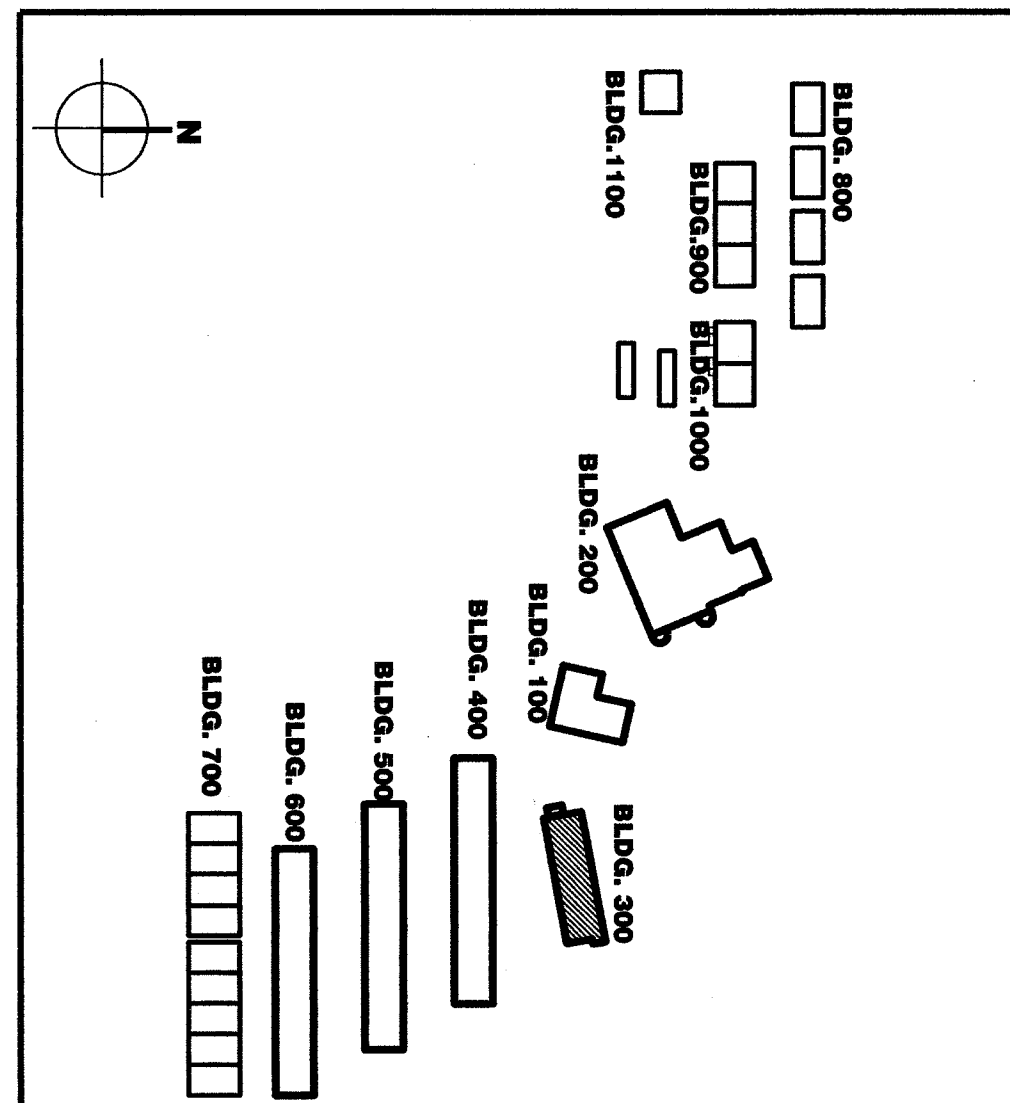

Item (9) Refer to Architectural Drawings, Sheet A2.31 - Building 300 Floor Plans. REMOVE replacement of existing window glazing (Reynolds 212) for windows on north side of Kindergartens (301 and 302) from the scope of work for this project.

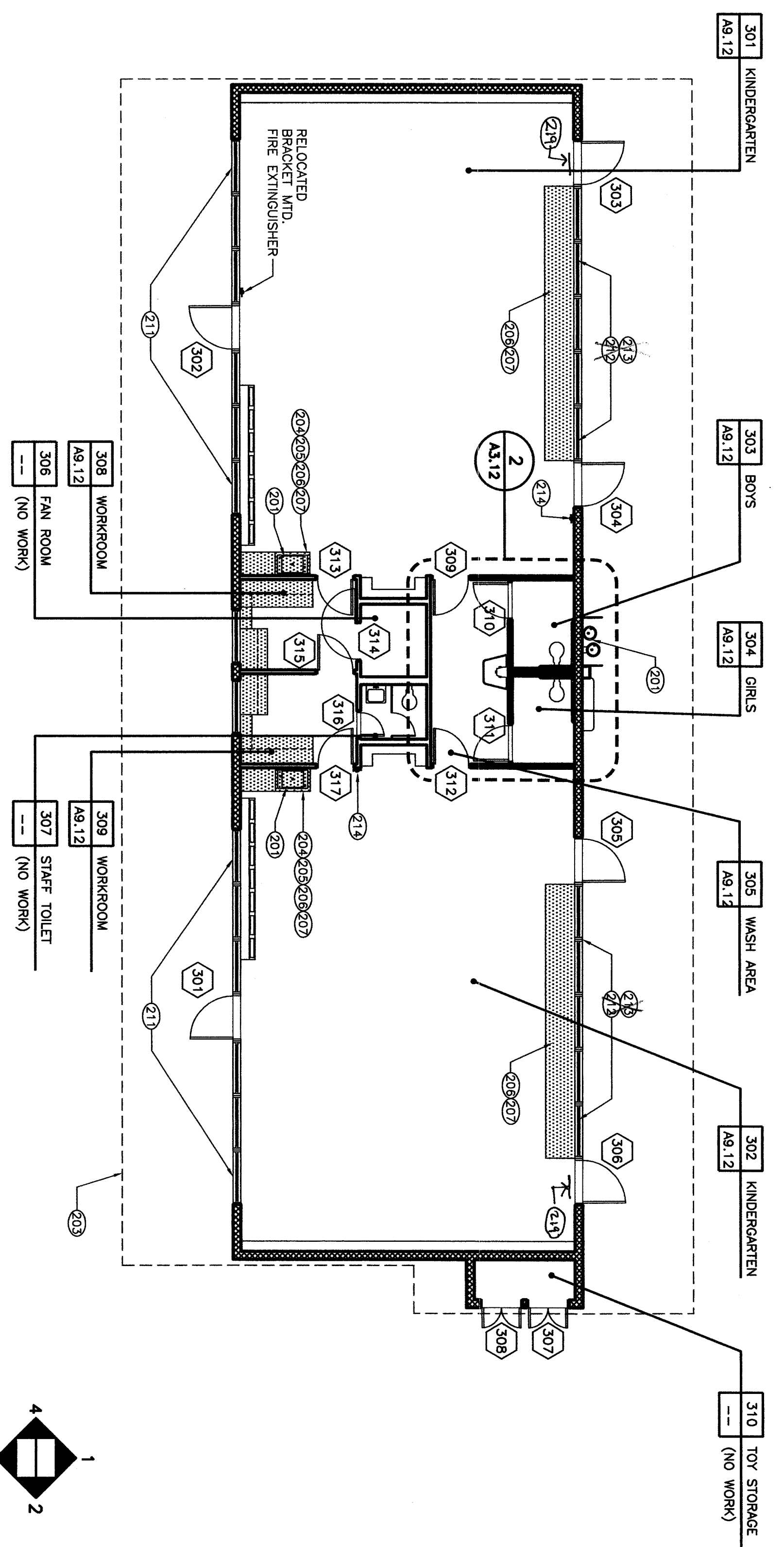

Item (9) Refer to Architectural Drawings, Sheet A2.31 - Building 300 Floor Plans. CLARIFY layout of floor materials (carpet and VCT) in Kindergarten (301) and Kindergarten (302) as shown on attached Drawing A21-01, dated 11/27/07.

BUILDING 300 FLOOR PLAN

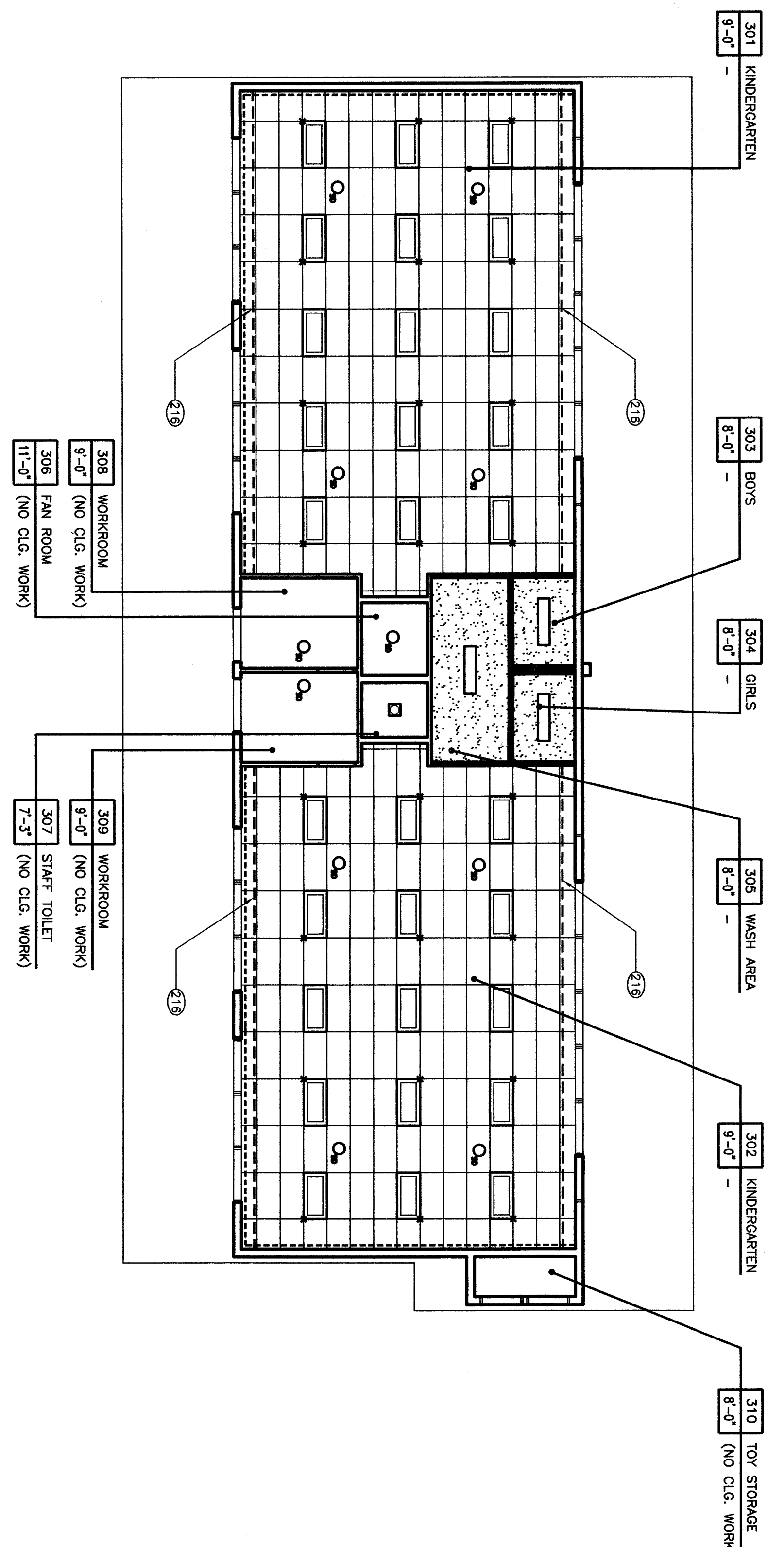

BUILDING 300 REFLECTED CEILING PLAN

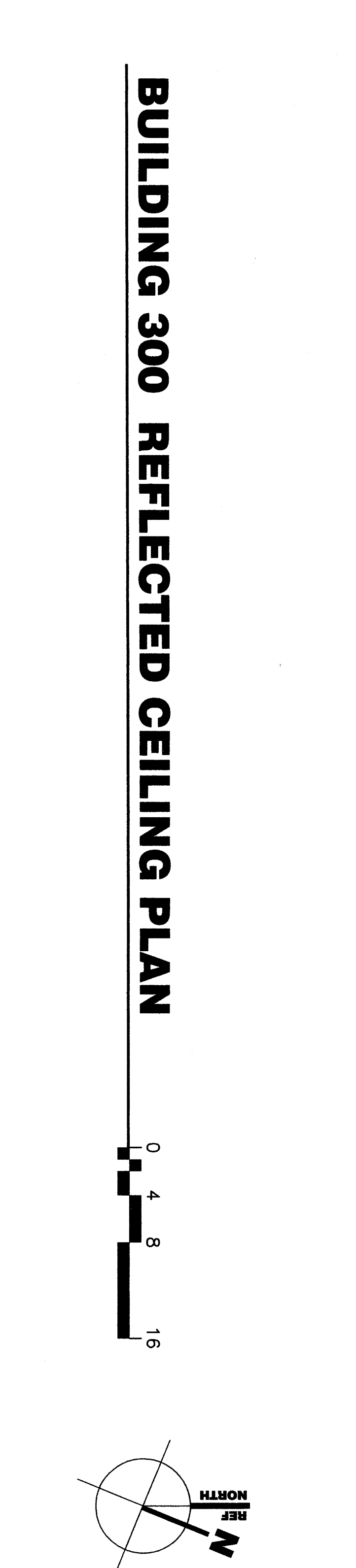

bfgc
Architecture

Bakersfield
5500 23rd Avenue, suite 450, Bakersfield, CA 93309
661.838.4300 fax 661.838.4311

San Jose
150 south first st., suite 200
san jose, california 95113
for 408.824.8444

San Luis Obispo
1715 westside street, suite 200
san luis obispo, ca 93401
805.546.6433
for 805.546.6094

Oakland
300 rock zone plaza, suite 300
oakland, california 94612
510.881.8714
for 510.881.8714

Principal Architects
1000 S. Orange Ave., Suite 1000
San Bernardino, CA 92415
C-10855
for 909.392.1100
for 909.392.1100

FILE NO.: 15-B
IMPRESSION STAMP
DIV. OF THE STATE ARCHITECT
PART NO.:
03-108664
ACT. BY: R. TROST
DATE: 8-26-03

MODERNIZATION
FOR
COLONEL HOWARD NICHOLS SCHOOL
3401 RENEGADE AVE.
BAKERSFIELD, CA. 93306
BAKERSFIELD CITY SCHOOL DISTRICT

BUILDING 300 FLOOR PLAN AND REFLECTED CEILING PLAN

Version Date: 02-11-27
Job no.: B-26-03
date: 8-26-03
drawn by: DESN
CHK'd by: R. TROST
©copyright 2002

Version Title:
2.31