

- CEILING NOTES**
- 1) 2" x 4" wood joists spaced 24" on center to support 4" x 8" edge blocking.
 - 2) 1/2" plaster board over edge blocking, stagger joints 6" to 8" at the length of the wall and the window or door at the perimeter of the ceiling.
 - 3) Provide recessed or other supplementary support members at deductions as required at all ceiling beams, walls of adjacent rooms, columns and walls that are open to the ceiling.
 - 4) Ceiling grid systems shall be attached to and span over a minimum of two joists, with the grid system spaced 16" on center.
 - 5) As the perimeter of the ceiling area where walls of adjacent rooms are not at the full height to permit better circulation, a metal strip 1/2" x 1/8" thick shall be installed at the top of the wall and the ceiling shall be finished with the same material as the ceiling.
 - 6) Provide edge of 4" x 8" at all deductions which are not finished with plaster.
 - 7) Provide wood blocking, one inch wide of every stud at a spacing not more than 48" on center.
 - 8) For wood blocking, one inch wide of every stud at a spacing not more than 48" on center.
 - 9) Provide wood blocking, one inch wide of every stud at a spacing not more than 48" on center.
 - 10) Provide wood blocking, one inch wide of every stud at a spacing not more than 48" on center.
 - 11) Provide wood blocking, one inch wide of every stud at a spacing not more than 48" on center.
 - 12) Provide wood blocking, one inch wide of every stud at a spacing not more than 48" on center.
 - 13) Provide wood blocking, one inch wide of every stud at a spacing not more than 48" on center.
 - 14) Provide wood blocking, one inch wide of every stud at a spacing not more than 48" on center.
 - 15) Provide wood blocking, one inch wide of every stud at a spacing not more than 48" on center.
 - 16) Provide wood blocking, one inch wide of every stud at a spacing not more than 48" on center.
 - 17) Provide wood blocking, one inch wide of every stud at a spacing not more than 48" on center.
 - 18) Provide wood blocking, one inch wide of every stud at a spacing not more than 48" on center.
 - 19) Provide wood blocking, one inch wide of every stud at a spacing not more than 48" on center.
 - 20) Provide wood blocking, one inch wide of every stud at a spacing not more than 48" on center.
 - 21) Provide wood blocking, one inch wide of every stud at a spacing not more than 48" on center.
 - 22) Provide wood blocking, one inch wide of every stud at a spacing not more than 48" on center.
 - 23) Provide wood blocking, one inch wide of every stud at a spacing not more than 48" on center.
 - 24) Provide wood blocking, one inch wide of every stud at a spacing not more than 48" on center.
 - 25) Provide wood blocking, one inch wide of every stud at a spacing not more than 48" on center.
 - 26) Provide wood blocking, one inch wide of every stud at a spacing not more than 48" on center.
 - 27) Provide wood blocking, one inch wide of every stud at a spacing not more than 48" on center.
 - 28) Provide wood blocking, one inch wide of every stud at a spacing not more than 48" on center.
 - 29) Provide wood blocking, one inch wide of every stud at a spacing not more than 48" on center.
 - 30) Provide wood blocking, one inch wide of every stud at a spacing not more than 48" on center.
 - 31) Provide wood blocking, one inch wide of every stud at a spacing not more than 48" on center.
 - 32) Provide wood blocking, one inch wide of every stud at a spacing not more than 48" on center.
 - 33) Provide wood blocking, one inch wide of every stud at a spacing not more than 48" on center.
 - 34) Provide wood blocking, one inch wide of every stud at a spacing not more than 48" on center.
 - 35) Provide wood blocking, one inch wide of every stud at a spacing not more than 48" on center.
 - 36) Provide wood blocking, one inch wide of every stud at a spacing not more than 48" on center.
 - 37) Provide wood blocking, one inch wide of every stud at a spacing not more than 48" on center.
 - 38) Provide wood blocking, one inch wide of every stud at a spacing not more than 48" on center.
 - 39) Provide wood blocking, one inch wide of every stud at a spacing not more than 48" on center.
 - 40) Provide wood blocking, one inch wide of every stud at a spacing not more than 48" on center.
 - 41) Provide wood blocking, one inch wide of every stud at a spacing not more than 48" on center.
 - 42) Provide wood blocking, one inch wide of every stud at a spacing not more than 48" on center.
 - 43) Provide wood blocking, one inch wide of every stud at a spacing not more than 48" on center.
 - 44) Provide wood blocking, one inch wide of every stud at a spacing not more than 48" on center.
 - 45) Provide wood blocking, one inch wide of every stud at a spacing not more than 48" on center.
 - 46) Provide wood blocking, one inch wide of every stud at a spacing not more than 48" on center.
 - 47) Provide wood blocking, one inch wide of every stud at a spacing not more than 48" on center.
 - 48) Provide wood blocking, one inch wide of every stud at a spacing not more than 48" on center.
 - 49) Provide wood blocking, one inch wide of every stud at a spacing not more than 48" on center.

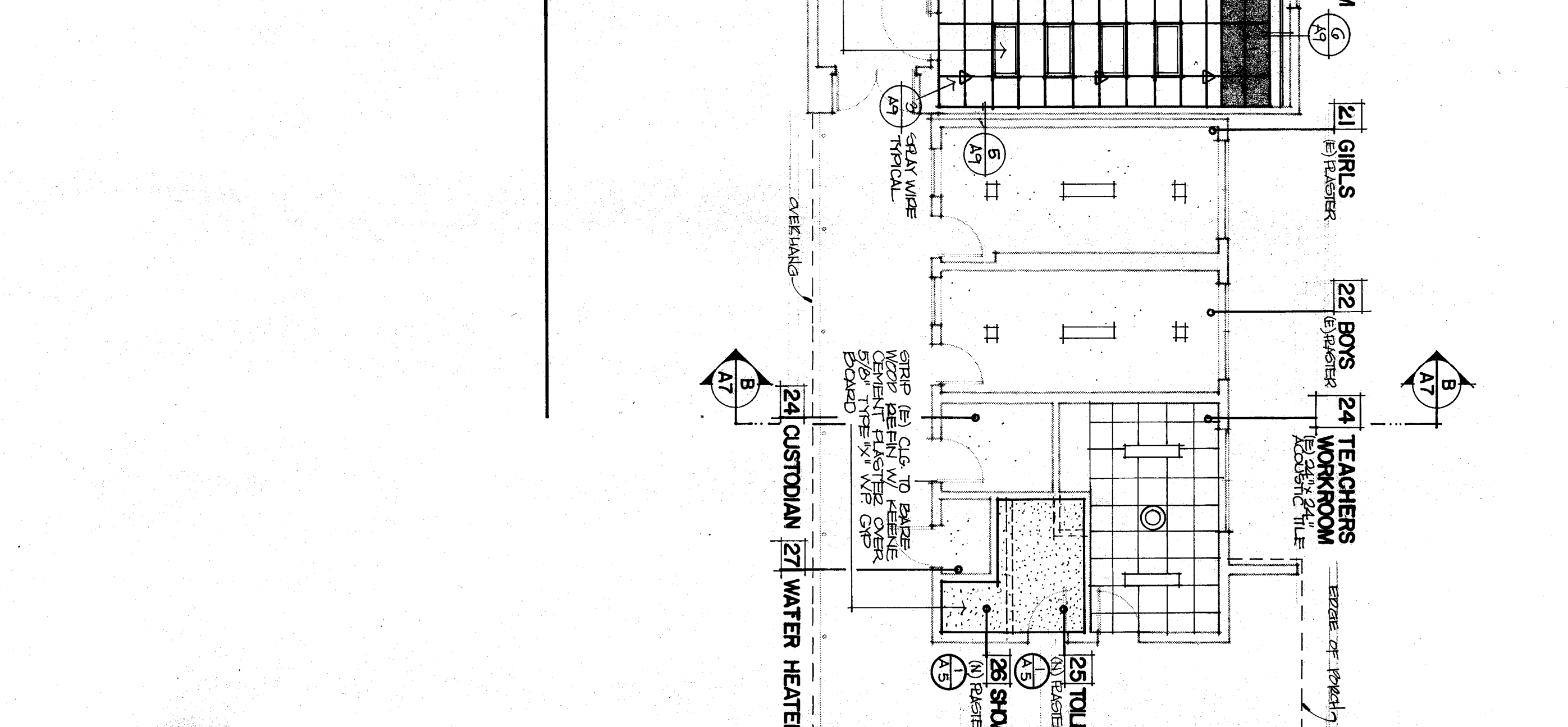

REFLECTED CEILING PLANS

RAFER JOHNSON SCHOOL
1001 10TH. ST., BAKERSFIELD, CA.

BAKERSFIELD CITY SCHOOL DISTRICT
KERN COUNTY, CALIFORNIA

IDENTIFICATION SYMBOL
Department of General Services
Office of the State Architect
ANG 2.4.15-3
Stamping Sheet System
ANG 2.4.15-3
5/3/88
DATE

3121 CALIFORNIA AVE.
BAKERSFIELD, CA
93304
(805) 327-1632

ROBERT F. STUHR ARCHITECT INC.
C-1610
WILLIAM JIMBLEY AIA
DANNY E. ORDZ AIA
C-16835
C-14728

ROBERT F. STUHR AIA
WILLIAM JIMBLEY AIA
DANNY E. ORDZ AIA

MARK	DATE	REVISIONS
▲		
▲		
▲		

JOB NO. 644
DRAWN: E.V.C.
CHECKED:
DATE: 5/3/88

CHECK AND VERIFY ALL DIMENSIONS BEFORE PROCEEDING WITH THE WORK. REPORT ALL DISCREPANCIES TO THE ARCHITECT IMMEDIATELY. ALL CONSTRUCTION SHALL CONFORM TO USC 88, TITLE 21.24

OF 9 SHEETS