

SYMBOL SCHEDULE

SYMBOL	DESCRIPTION
○	INCANDESCENT LIGHT, CEILING
□	INCANDESCENT LIGHT, RECESSED
◇	FLUORESCENT LIGHT
⊕	SINGLE POLE TOGGLE SWITCH
⊖	THREE WAY TOGGLE SWITCH
⊙	MOTORIZED RECEPTACLE
⊚	DUPLICATE
⊛	JUNCTION BOX
⊜	TELEPHONE OUTLET
■	PANEL BOARD
—	BEHIND CIRCUIT CONCEALED IN CEILING OR WALL
---	BEHIND CIRCUIT CONCEALED UNDER LUGGER STUD
---	HOME RUN TO PANEL OR RESPECTIVE TERMINAL
---	SIZES AS NOTED
---	NOT WEATHER PROOF
---	DISCONNECT SWITCH SIZES AS REQUIRED
---	TIME SWITCH

PANEL A

TYPE: NQC 36-BL225, FLUSH MTD. (WITH RELAY & TIME SWITCH - SEE DETAIL)

LOAD	WIRE	S/N	TERMINAL	LOAD
RECP.TS.	10/2	10/2	10/2	PLUGBOARD
LIGHTS	10/2	10/2	10/2	REF. #2
TEL RECP.TS.	10/2	10/2	10/2	LIGHTS
FORCING LIGHTS	10/2	10/2	10/2	PARKING LIGHTS
WATER HEATER	10/2	10/2	10/2	RECEPTS
DOOR OPERATOR	10/2	10/2	10/2	DETRINKING FOUNTAIN
RECP.TS.	10/2	10/2	10/2	EXIT LITE'S
TEMP. CONT. BLD.	10/2	10/2	10/2	

FLOOR PLAN

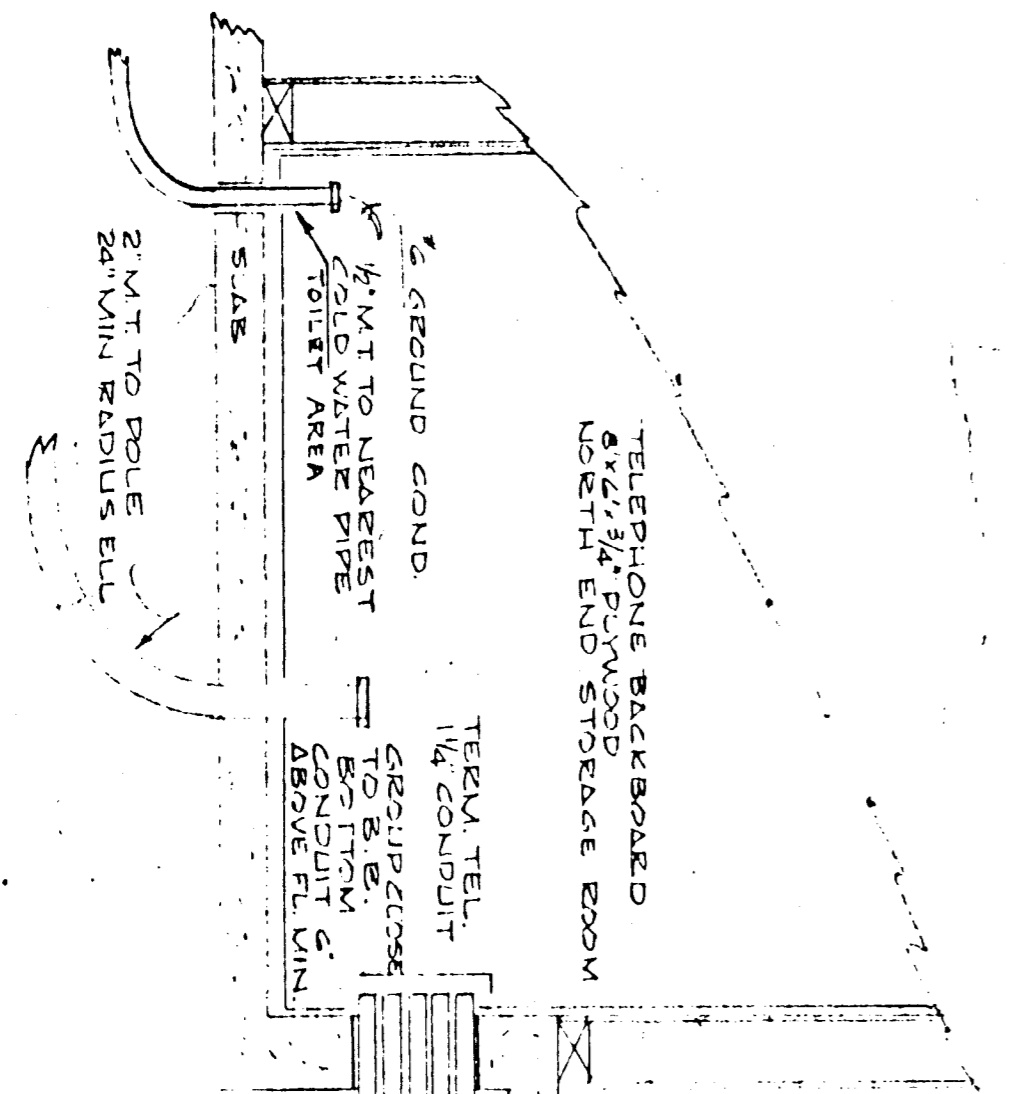

TELEPHONE TERMINAL DETAIL

ONE LINE DIAGRAM

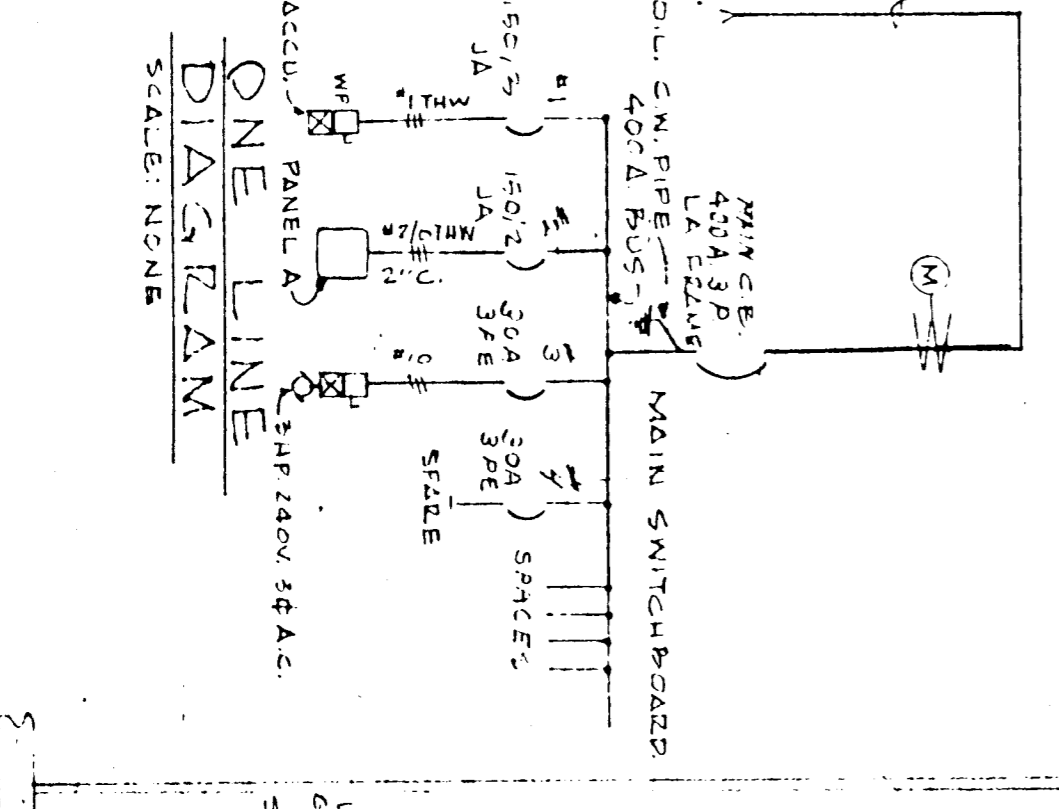

PANEL A DETAIL

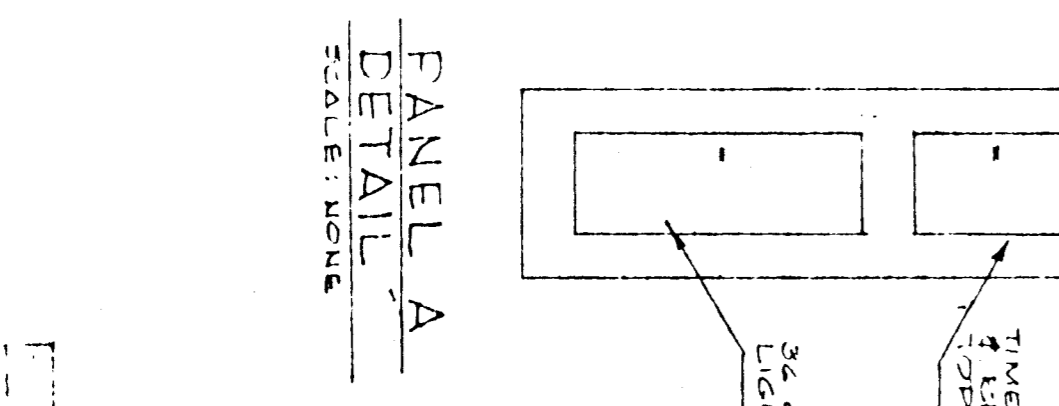

MAIN SWITCHBOARD DETAIL

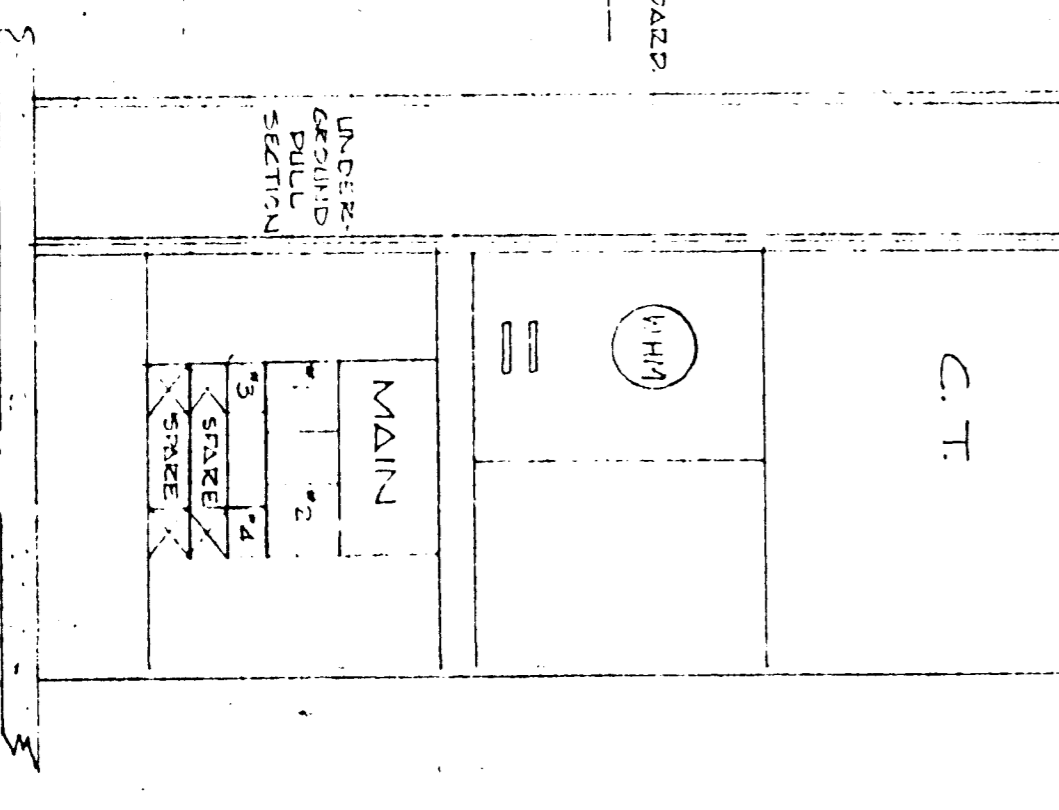

NOTE: SEE MECHANICAL PLAN FOR CONTROL WIRING DIAGRAM PROVIDE NYLON PULL CORD IN ALL EMPTY CONDUITS.

PLANT WORK CENTER

THE PACIFIC TELEPHONE & TELEGRAPH CO.

ENGINEERING DEPARTMENT

2729 EYE ST., SACRAMENTO, CALIFORNIA

NO.	REVISED TO	AS-BUILT	DATE
1	REVISED TO AS-BUILT		1/15/52

PACIFIC TELEPHONE

CLAY OR S&D CLASS 8500 TYPE

Bakerfield, 3900 Jewett Ave. 36F108-7-7136-64D1-E2 SWITCH BOARD 1/64